

Connection Cables - Sensor and Signal

M8 A-coded Cable to Pigtail

Features

- Industry-standard axial and right-angle M8 screw-lock connectors with open leads
- Cables listed can be used with patch cables
- 1.5m [4.9 ft], 2m [6.5 ft], 5m [16.4 ft], 7m [23 ft], and 10m [32.8 ft] cable lengths
- PVC (polyvinyl chloride) jacketed cable for general use and chemical washdown applications, ex. food & beverage industry
- PUR (polyurethane) jacketed cable for applications with exposure to oil and dynamic applications requiring more flexibility
- PP (polypropylene) wire insulation for low temperature applications



Dimensions

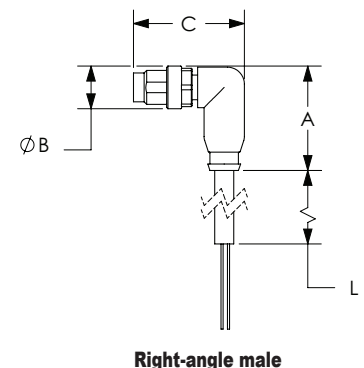
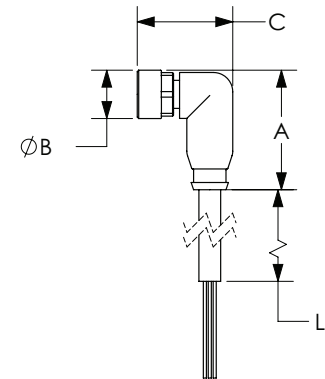
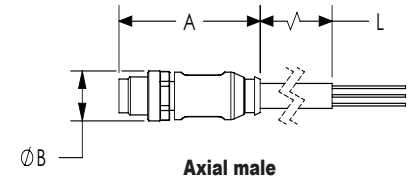
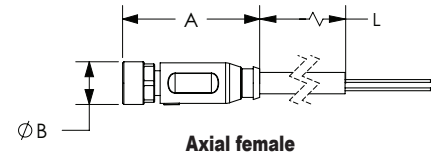

M8 A-coded Cable to Pigtail													
Part Number	Price	Number of Wires	Connector	Cable Jacket/ Wire Insulation Material	Jacket Color	Dimensions							
						A	B	C	L				
						mm			m [ft]				
CD08-0A-020-A1	\$11.00	3	Axial female	PVC/PVC	Gray	32	10	-	2				
CD08-0A-020-C1	\$11.00		Right-angle female			25	10	20	[6.5]				
CD08-0A-050-A1	\$14.00		Axial female	PUR/PP	Black	32	10	-	5 [16.4]				
CD08-0A-050-C1	\$14.00		Right-angle female			25	10	20					
CD08-0C-050-A1-A	\$14.00		Axial female	PUR/PVC	Gray	32	10	-	7 [23]				
CD08-0C-050-C1	\$14.50		Right-angle female	PUR/PP		25	10	20					
CD08-0C-050-C1-A	\$14.00		Right-angle female	PUR/PP	25	10	20						
CD08-0A-070-A1	\$18.00		Axial female	PVC/PVC	Gray	32	10	-	7 [23]				
CD08-0A-070-C1	\$18.00		Right-angle female			25	10	20					
7000-08001-0200200	\$9.50		Axial male	PUR/PVC	Yellow	Gray	39	10	-	2 [6.5]			
7000-08001-0300200	\$10.00		Axial male	PUR/PP			39	10	-				
7000-08021-0200200	\$9.50		Right-angle male	PUR/PVC			25	10	26				
7000-08021-0300200	\$10.00		Right-angle male	PUR/PP			25	10	26				
7000-08001-0300500	\$11.00		Axial male	PUR/PP			39	10	-		5 [16.4]		
7000-08021-0200500	\$10.50		Right-angle male	PUR/PVC			25	10	26				
7000-08021-0300500	\$11.00		Right-angle male	PUR/PP			25	10	26				
7000-08001-0201000	\$18.50		Axial male	PUR/PVC			39	10	-		10 [32.8]		
7000-08001-0301000	\$19.00		Axial male	PUR/PP			39	10	-				
7000-08021-0201000	\$18.50		Right-angle male	PUR/PVC			25	10	26				
7000-08021-0301000	\$19.00		Right-angle male	PUR/PP			25	10	26				
7000-08001-2100200	\$7.50		Axial male	PVC/PVC			Gray	39	10		-	2 [6.5]	
7000-08021-2100200	\$7.50		Right-angle male					25	10		26		
7000-08001-2100500	\$8.75		Axial male	PVC/PVC			Gray	39	10		-	5 [16.4]	
7000-08021-2100500	\$8.75		Right-angle male					25	10		26		
7000-08001-2101000	\$14.00	Axial male	PVC/PVC	Gray			39	10	-		10 [32.8]		
7000-08021-2101000	\$14.00	Right-angle male					25	10	26				
7000-08041-0300200	\$10.00	Axial female	PUR/PP	Gray			Gray	32	10		-	2 [6.5]	
7000-08081-0300200	\$10.00	Right-angle female	PUR/PP					25	10		20		
7000-08041-0300500	\$11.00	Axial female	PUR/PP					32	10		-		5 [16.4]
7000-08081-0200500	\$10.50	Right-angle female	PUR/PVC					25	10		20		
7000-08081-0300500	\$11.00	Right-angle female	PUR/PP					25	10		20		

Continued on next page.

See our website: www.AutomationDirect.com for complete engineering drawings.

Connection Cables - Sensor and Signal

M8 A-coded Cable to Pigtail (continued)

M8 A-coded Cable to Pigtail												
Part Number	Price	Number of Wires	Connector	Cable Jacket/Wire Insulation Material	Jacket Color	Dimensions						
						A	B	C	L			
						mm			m [ft]			
7000-08041-0200700	\$14.00	3	Axial female	PUR/PVC	Yellow	32	10	-	7 [22.9]			
7000-08041-0300700	\$15.00		Axial female	PUR/PP		32	10	-				
7000-08081-0200700	\$14.00		Right-angle female	PUR/PVC		25	10	20				
7000-08081-0300700	\$15.00		Right-angle female	PUR/PP	25	10	20					
7000-08041-2100500	\$8.75		Axial female	PVC/PVC	Gray	32	10	-	5 [16.4]			
7000-08081-2100500	\$8.75		Right-angle female			25	10	20				
7000-08061-0310200	\$10.00	4	Axial female	PUR/PP	Black	32	10	-	2 [6.5]			
7000-08101-0210200	\$9.75		Right-angle female	PUR-PVC/PVC		25	10	20				
7000-08101-0310200	\$10.00		Right-angle female	PUR/PP		25	10	20				
7000-08061-0210500	\$12.00		Axial female	PUR-PVC/PVC	PVC/PVC	Black	32	10	-	5 [16.4]		
7000-08061-0310500	\$13.00		Axial female	PUR/PP			32	10	-			
7000-08101-0210500	\$12.50		Right-angle female	PUR-PVC/PVC			25	10	20			
7000-08101-0310500	\$14.00		Right-angle female	PUR/PP		25	10	20				
7000-08061-0211000	\$19.00		Axial female	PUR-PVC/PVC		Gray	Black	32	10		-	10 [32.8]
7000-08061-0311000	\$20.00		Axial female	PUR/PP				32	10		-	
7000-08101-0211000	\$19.50		Right-angle female	PUR-PVC/PVC	25			10	20			
7000-08101-0311000	\$20.00		Right-angle female	PUR/PP	25		10	20				
CD08-0G-020-A1	\$11.50		Axial female	PVC/PVC	Black		Gray	32	10	-	2 [6.5]	
CD08-0W-020-C1	\$11.50		Right-angle female					25	10	20		
CD08-0G-050-A1	\$14.00		Axial female			32		10	-			
CD08-0W-050-C1	\$14.00		Right-angle female			25	10	20				
CD08-0G-100-A1	\$18.00		Axial female			32	10	-				
CD08-0W-100-C1	\$18.00		Right-angle female			25	10	20				
7000-08061-2110200	\$8.75		Axial female		PVC/PVC	Gray	Black	32	10	-	2 [6.5]	
7000-08101-2110200	\$8.75	Right-angle female	25					10	20			
7000-08061-2110500	\$10.50	Axial female	32					10	-			
7000-08101-2110500	\$10.50	Right-angle female	25			10	20					
7000-08061-2111000	\$14.50	Axial female	PUR/PP			Black	Black	32	10	-		5 [16.4]
7000-08101-2111000	\$14.50	Right-angle female						25	10	20		
7000-08941-6950150	\$10.50	Axial female			34			10	-			
7000-08951-6950150	\$10.50	Right-angle female			28	10	21					
7000-08941-6950500	\$19.00	Axial female			34	10	-					
7000-08951-6950500	\$19.50	Right-angle female			28	10	21					
7000-08941-6951000	\$30.50	Axial female	PUR/PP		Black	Black	34	10	-	10 [32.8]		
7000-08951-6951000	\$31.50	Right-angle female					28	10	21			

Dimensions

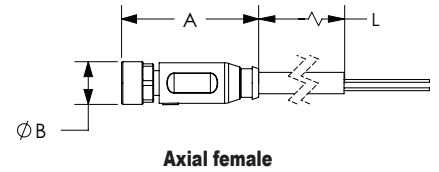

Axial female

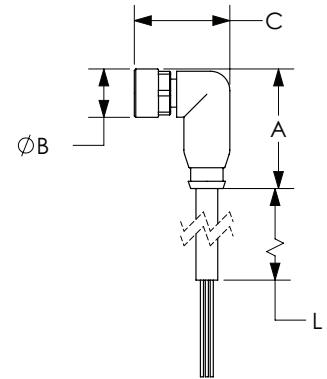

Right-angle female

See our website: www.AutomationDirect.com for complete engineering drawings.

Connection Cables - Sensor and Signal

M8 A-coded Cable to Pigtail Specifications					
Model	CD08 Series			7000 Series	
Type	3-Wire, 3-Pole	4-Wire, 4-Pole	3-Wire, 3-Pole	4-Wire, 4-Pole	5-Wire, 5-Pole
Max Voltage	50VAC / 60VDC				30 VAC/VDC
Max Voltage - UL Rating	N/A			30 VAC/VDC	
Max Current Per Contact	4A				3A
Protection Degree	IP65 / IP66K / IP67				IP67
Nut Material	Male threads are nickel plated brass; female threads are nickel plated die cast zinc				
Cable Jacket/Wire Insulation Material	PUR-PVC/PVC, PVC/PVC, PUR/PVC, or PUR/PP				PUR/PP
Contacts Material	Copper Alloy				
Tightening Torque	≤ 0.4 N·m [≤ 0.34 ft·lb]				
Conductors Cross Section	0.25 mm ² [24AWG]				
Ø Outer Cable For PUR/PVC or PVC/PVC or PUR-PVC/PVC	3-Wire 4.5 mm [0.18 in] / 4-Wire 4.8 mm [0.19 in]				
Ø Outer Cable For PUR/PP	3-Wire 4.1 mm [0.16 in] / 4-Wire 4.5 mm [0.18 in]			5-Wire 4.7 mm [0.19 in]	
Temperature Range - Stationary Use	PUR-PVC/PVC, PVC/PVC and PUR/PVC -30 to 80°C [-22 to 176°F]; PUR/PP -40 to 80°C [-40 to 176°F]				
Temperature Range - Flexible Use	PUR-PVC/PVC, PVC/PVC and PUR/PVC -5 to 80C [23 to 176F]; PUR/PP -25 to 80°C [-13 to 176°F]				
Min Bend Radius	Stationary use: 5 x cable diameter; Flexible use: 10 x cable diameter				
Approvals*	CE, cCSAus		cULus, CE, UKCA, cCSAus		cURus

*To obtain the most current agency approval information, see the Agency Compliance & Certifications Checklist section on the specific part number's web page.

Contact Diagrams

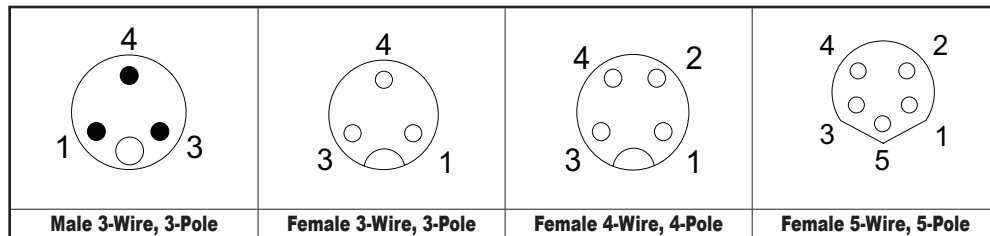

Wiring Diagrams

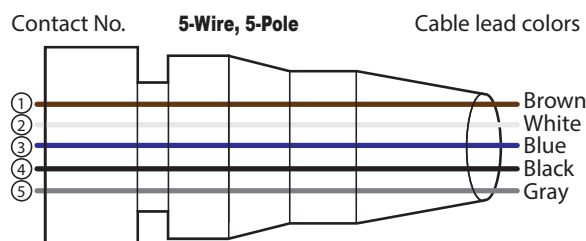
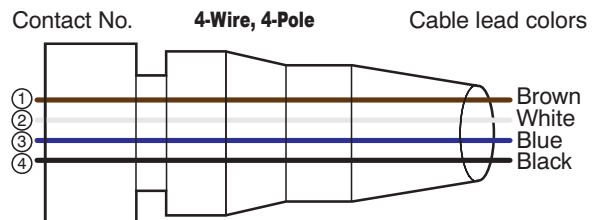
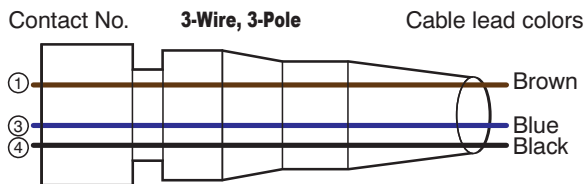

Connection Cables - Sensor and Signal

M12 A-coded Cable to Pigtail

Features

- Industry standard axial and right-angle M12 screw-lock connectors with open leads
- Cables listed can be used with patch cables
- 2m [6.5 ft], 3m [9.8 ft], 5m [16.4 ft], 7m [22.9ft], 10m [32.8 ft] and 15m [49.2 ft] cable lengths
- PVC (polyvinyl chloride) jacketed cable for general use and chemical washdown applications, ex. food & beverage industry
- PUR (polyurethane) jacketed cable for applications with exposure to oil and dynamic applications requiring more flexibility
- PP (polypropylene) wire insulation for low temperature applications
- TPE (thermoplastic elastomer) wire insulation for applications requiring high flexibility



Dimensions

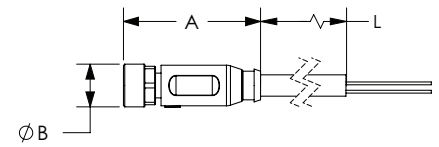

Axial female

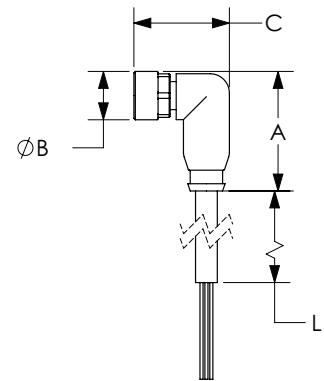

Right-angle female

See our website: www.AutomationDirect.com for complete engineering drawings.

M12 A-coded Cable to Pigtail										
Part Number	Price	Number of Wires	Connector	Cable Jacket/Wire Insulation Material	Jacket Color	Dimensions				
						A	B	C	L	
						mm		m [ft]		
CD12M-0B-050-A1*	\$14.00	3	Axial female	PVC/PVC	Black	38	15	-	5 [16.4]	
CD12M-0B-050-C1*	\$14.00		Right-angle female			39	15	28		
CD12M-0D-050-A1-A*	\$16.00		Axial female	PUR/PP		38	15	-		
CD12M-0D-050-C1*	\$16.50		Right-angle female	PUR/PVC		39	15	28		
CD12M-0D-050-C1-A*	\$16.00		Right-angle female	PUR/PP		39	15	28		
7000-12181-2130500*	\$8.75		Axial female	PVC/PVC		Gray	38	15		-
7000-12321-2130500*	\$8.75		Right-angle female				39	15		28
7000-12181-0330500*	\$13.00		Axial female	PUR/PP		Yellow	38	15		-
7000-12321-0330500*	\$13.00		Right-angle female	PUR/PP			39	15		28
CD12L-0B-020-A0	\$11.00		4	Axial female		PVC/PVC	Gray	38		15
CD12L-0B-020-C0	\$11.00	Right-angle female		39	15			28	7 [22.9]	
CD12M-0B-070-A1	\$18.00	Axial female		38	15			-	2 [6.5]	
CD12M-0B-070-C1	\$18.00	Right-angle female		39	15			28	7 [22.9]	
7000-12221-0340200	\$10.00	Axial female		PUR/PP	Yellow	38		15	-	2 [6.5]
7000-12341-0240200	\$9.00	Right-angle female		PUR-PVC/PVC		39		15	28	7 [22.9]
7000-12341-0340200	\$10.00	Right-angle female		PUR/PP		39		15	28	7 [22.9]
7000-12221-0340700	\$18.00	Axial female		PUR/PP		38		15	-	10 [32.8]
7000-12341-0240700	\$18.00	Right-angle female		PUR-PVC/PVC		39		15	28	15 [49.2]
7000-12341-0340700	\$18.00	Right-angle female		PUR/PP		39		15	28	10 [32.8]
7000-12221-0341000	\$22.00	Axial female	PUR/PP	PVC/PVC		Gray	38	15	-	10 [32.8]
7000-12341-0241000	Retired	Right-angle female	PUR-PVC/PVC				39	15	29	15 [49.2]
7000-12341-0341000	\$22.00	Right-angle female	PUR/PP				39	15	29	15 [49.2]
7000-12221-0241500	\$27.50	Axial female	PUR-PVC/PVC				38	15	-	10 [32.8]
7000-12221-0341500	\$30.00	Axial female	PUR/PP		38		15	-	15 [49.2]	
7000-12341-0341500	\$30.00	Right-angle female	PUR/PP		39		15	29	15 [49.2]	
7000-12221-2141000	\$21.00	4	Axial female	PVC/PVC	Gray	38	15	-	10 [32.8]	
7000-12341-2141000	\$21.00		Right-angle female			39	15	29	15 [49.2]	
7000-12221-2141500	\$27.00		Axial female			38	15	-	15 [49.2]	
7000-12341-2141500	\$27.00		Right-angle female			39	15	29	15 [49.2]	

* Note: Do not use with sensors that require 4-wires cables.
Continued on next page.

Connection Cables - Sensor and Signal

M12 A-coded Cable to Pigtail (continued)

M12 A-coded Cable to Pigtail											
Part Number	Price	Number of Wires	Connector	Cable Jacket/Wire Insulation Material	Jacket Color	Dimensions					
						A	B	C	L		
						mm			m [ft]		
7000-12241-0350300	\$14.00	5	Axial female	PUR/PP	Yellow	38	15	-	3		
7000-12361-0350300	\$14.00		Right-angle female	PUR/PP		39	15	28	[9.8]		
7000-12241-0250500	\$18.00		Axial female	PUR-PVC/PVC		38	15	-	5		
7000-12241-0350500	\$18.00		Axial female	PUR/PP		38	15	-			
7000-12361-0250500	\$18.00		Right-angle female	PUR-PVC/PVC		39	15	28	[16.4]		
7000-12361-0350500	\$18.00		Right-angle female	PUR/PP		39	15	28			
7000-12241-0251000	\$26.50		Axial female	PUR-PVC/PVC		38	15	-	10		
7000-12241-0351000	\$28.00		Axial female	PUR/PP		38	15	-			
7000-12361-0251000	\$26.50		Right-angle female	PUR-PVC/PVC		39	15	28	[32.8]		
7000-12361-0351000	\$28.00		Right-angle female	PUR/PP		39	15	28			
7000-12241-2150300	\$12.50		5	Axial female		PVC/PVC	Gray	38	15	-	3
7000-12361-2150300	\$12.50			Right-angle female				39	15	28	[9.8]
7000-12241-2150500	\$17.50	Axial female		38	15			-	5		
7000-12361-2150500	\$17.50	Right-angle female		39	15			28	[16.4]		
7000-12241-2151000	\$25.00	Axial female		38	15			-	10		
7000-12361-2151000	\$25.00	Right-angle female		39	15			28	[32.8]		
7000-17041-2920300	\$28.00	8	Axial female	PUR/PP	Gray	44.5	15	-	3		
7000-17061-2920300	\$28.00		Right-angle female			39	15	32	[9.8]		
7000-17041-2920500	\$36.50		Axial female			44.5	15	-	5		
7000-17061-2920500	\$36.50		Right-angle female			39	15	32	[16.4]		
7000-17041-2921000	\$55.00		Axial female			44.5	15	-	10		
7000-17061-2921000	\$55.00		Right-angle female			39	15	32	[32.8]		
7000-17041-2950300	\$29.50		Axial female			44.5	15	-	3		
7000-17061-2950300	\$29.50		Right-angle female			39	15	32	[9.8]		
7000-17041-2950500	\$37.00		Axial female			44.5	15	-	5		
7000-17061-2950500	\$37.00		Right-angle female			39	15	32	[16.4]		
7000-17041-2951000	\$58.00		Axial female			44.5	15	-	10		
7000-17061-2951000	\$58.00		Right-angle female			39	15	32	[32.8]		
7000-19041-7050300	\$47.00	12	Axial female	PUR/PP	Black	43.5	15	-	3		
7000-19061-7050300	\$47.00		Right-angle female	PUR/TPE		39	15	32	[9.8]		
7000-19041-7050500	\$56.00		Axial female	PUR/PP		43.5	15	-	5		
7000-19061-7050500	\$56.00		Right-angle female	PUR/TPE		39	15	32	[16.4]		
7000-19041-7051000	\$83.00		Axial female	PUR/PP		43.5	15	-	10		
7000-19061-7051000	\$83.00		Right-angle female	PUR/TPE		39	15	32	[32.8]		

Dimensions

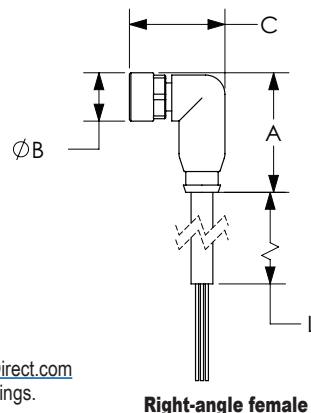
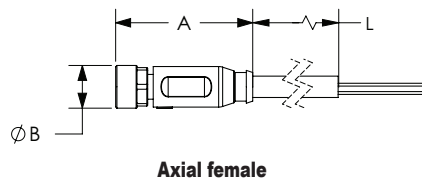

See our website: www.AutomationDirect.com
for complete engineering drawings.

Connection Cables - Sensor and Signal

M12 A-coded Cable to Pigtail Specifications							
Model	CD12 Series			7000 Series			
Type	3-Wire, 5-Pole	4-Wire, 5-Pole	3-Wire, 5-Pole	4-Wire, 5-Pole	5-Wire, 5-Pole	8-Wire, 8-Pole	12-Wire, 12-Pole
Max Voltage	250 VAC/VDC				125 VAC/VDC	30 VAC/VDC	
Max Voltage - UL Rating	N/A - not UL recognized			30 VAC/VDC			
Max Current Per Contact	4A				2A	1.5 A	
Protection Degree	IP65 / IP66K / IP67						
Nut Material	Female threads are nickel plated die cast zinc						
Cable Jacket/Wire Insulation Material	PUR/PP or PVC/PVC		PVC/PVC or PUR/PP or PUR/PVC			PUR/PP	PUR/PP or PUR/TPE
Contacts Material	Copper Alloy						
Tightening Torque	≤ 0.6 N·m [≤ 0.44 ft·lb]						
Conductors Cross Section	0.34 mm ² [22AWG]					0.25 mm ² [24AWG]	0.14 mm ² [26AWG]
Ø Outer Cable For PUR/PVC or PVC/PVC or PUR-PVC/PVC	4.6 mm [0.18 in]	5.0 mm [0.20 in]	PVC/PVC 4.6 mm [0.18 in] PUR/PVC 4.9 mm [0.19 in]	PVC/PVC 5.0 mm [0.20 in] PUR/PVC/PVC 5.2 mm [0.20 in]	PVC/PVC 5.2 mm [0.20 in] PUR-PVC/PVC 5.9 mm [0.23 in]	N/A	
Ø Outer Cable For PUR/PP or PUR/TPE	4.1 mm [0.16 in]	N/A	4.1 mm [0.16 in]	4.5mm [0.18 in]	4.8 mm [0.19 in]	5.8 mm [0.23 in]	6.0 mm [0.24 in]
Temperature Range - Stationary Use	PUR/PP -40 to 80°C [-40 to 176°F], PUR/PVC or PVC/PVC -30 to 80°C [-22 to 176°F]					PUR/PP -40 to 80C [-40 to 176F] PUR/TPE -25 to 80C [-13 to 176F]	
Temperature Range - Flexible Use	PUR/PP -25 to 80°C [-13 to 176°F]; PVC/PVC or PUR/PVC -5 to 80°C [23 to 176°F]					PUR/PP and PUR/TPE -25 to 80°C [-13 to 176°F]	
Min Bend Radius	Stationary use: 5 x cable diameter; Flexible use: 10 x cable diameter						
Approvals*	CE, cCSAus			cULus, UKCA, cCSAus			

*To obtain the most current agency approval information, see the Agency Compliance & Certifications Checklist section on the specific part number's web page.

Contact Diagrams

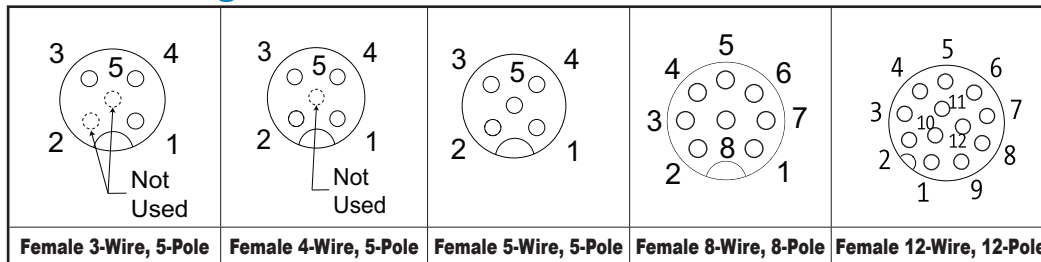

Wiring Diagrams

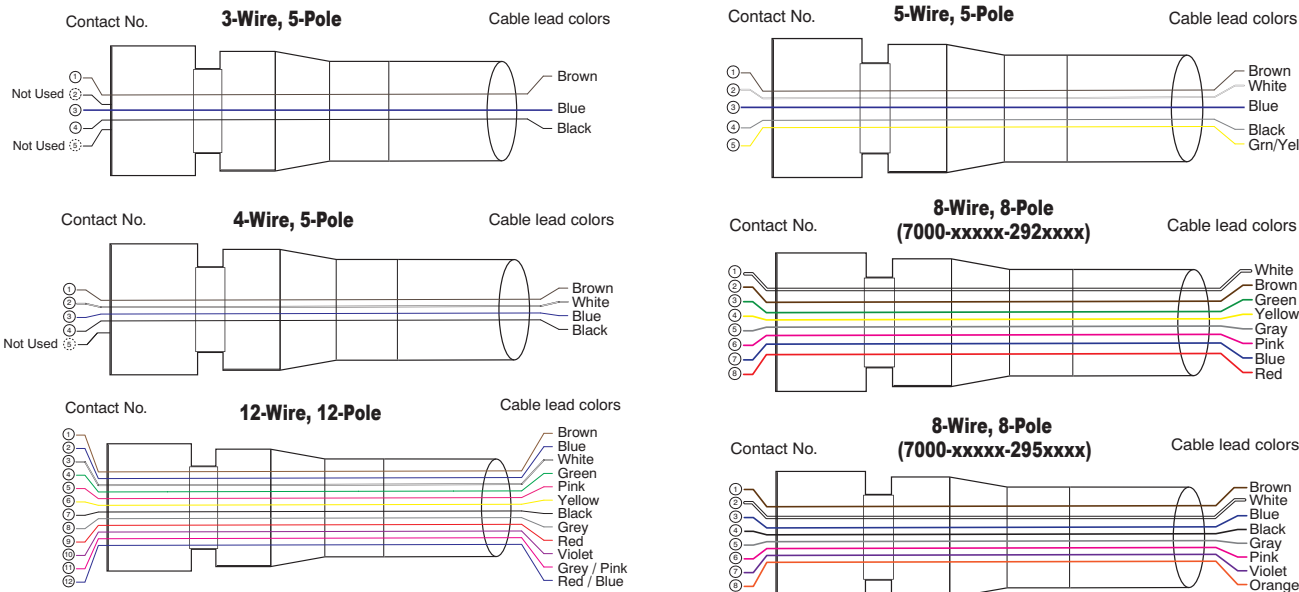

Connection Cables - Sensor and Signal

Shielded M12 A-coded Cable to Pigtail

Features

- Industry standard axial and right-angle M12 screw-lock connectors with open leads
- Braided shield located inside the cord jacket and connected to the coupling nut
- 5m [16.4 ft] and 10m [32.8 ft] cable lengths
- PVC (polyvinyl chloride) jacketed cable for general use and chemical wash-down applications, ex. food & beverage industry
- PUR (polyurethane) jacketed cable for applications with exposure to oil and dynamic applications requiring more flexibility



Shielded M12 A-coded Cable to Pigtail									
Part Number	Price	Number of Wires	Connector	Cable Jacket/Wire Insulation Material	Jacket Color	Dimensions			
						A	B	C	L
						mm			m [ft]
7000-13201-3310500	\$28.50	4	Axial female	PUR-PVC/ PVC	Gray	43.5	15	-	5
7000-13261-3310500	\$28.50		Right-angle female			39	15	32	[16.4]
7000-13201-3311000	\$44.00	Axial female	43.5			15	-	10	
7000-13261-3311000	\$44.00	Right-angle female	39			15	32	[32.8]	
7000-13221-3490500	\$32.50	5	Axial female			43.5	15	-	5
7000-13281-3490500	\$32.50		Right-angle female			39	15	32	[16.4]
7000-13221-3491000	\$51.00		Axial female			43.5	15	-	10
7000-13281-3491000	\$51.00		Right-angle female			39	15	32	[32.8]
7000-17121-2910500	\$50.00	8	Axial female	PUR/PP	Gray	44.5	15	-	5
7000-17141-2910500	\$50.00		Right-angle female			39	15	32	[16.4]
7000-17121-2911000	\$71.00		Axial female			44.5	15	-	10
7000-17141-2911000	\$73.00		Right-angle female			39	15	32	[32.8]
7000-17121-2940500	\$50.00		Axial female			44.5	15	-	5
7000-17141-2940500	\$50.00		Right-angle female			39	15	32	[16.4]
7000-17121-2941000	\$76.00		Axial female			44.5	15	-	10
7000-17141-2941000	\$76.00		Right-angle female			39	15	32	[32.8]

Dimensions

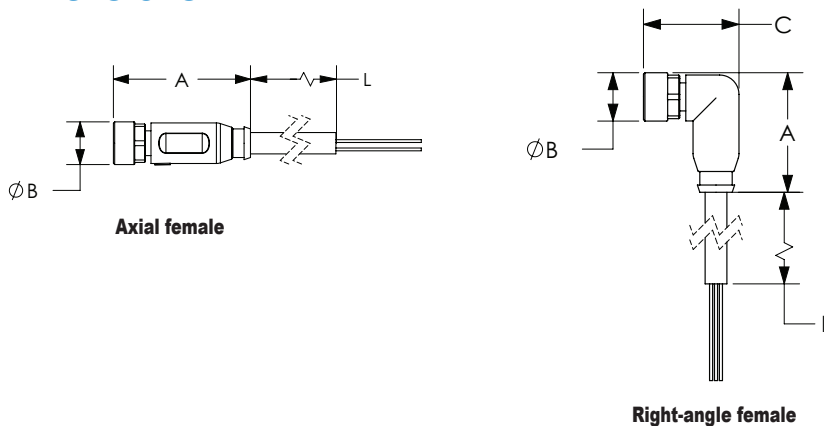

See our website: www.AutomationDirect.com for complete engineering drawings.

Connection Cables - Sensor and Signal

Shielded M12 A-coded Cable to Pigtail Specifications						
Model	13201	13261	13221	13281	17121	17141
Type	4-Wire, 5-Pole		5-Wire, 5-Pole		8-Wire, 8-Pole	
Max Voltage	60 VAC/VDC				30 VAC/VDC	
Max Voltage - UL Rating	30 VAC/VDC					
Max Current Per Contact	4A				2A	
Protection Degree	IP65 / IP66K / IP67					
Nut Material	Female threads are nickel plated die cast zinc					
Cable Jacket/Wire Insulation Material	PUR-PVC/PVC				PUR/PP	
Contacts Material	Copper Alloy					
Tightening Torque	0.6 N·m [0.44 ft·lb]					
Conductors Cross Section	0.34 mm ² [22AWG]				0.25 mm ² [24AWG]	
Ø Outer Cable	PUR-PVC/PVC 5.9 mm [0.23 in]				PUR/PP 7mm [0.28 in]	
Temperature Range - Stationary Use	-25 to 85°C [-13 to 185°F]			-40 to 80°C [-40 to 80°F]		
Temperature Range - Flexible Use	-5 to 70°C [23 to 158°F]				-25 to 80°C [-13 to 176°F]	
Min Bend Radius	Stationary use: 5 x cable diameter; Flexible use: 10 x cable diameter					
Approvals*	CE, UKCA, cCSAus				cULus, UKCA, cCSAus	

*To obtain the most current agency approval information, see the Agency Compliance & Certifications Checklist section on the specific part number's web page.

Contact Diagrams

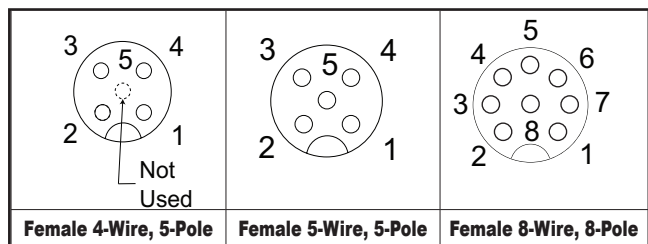

Wiring Diagrams

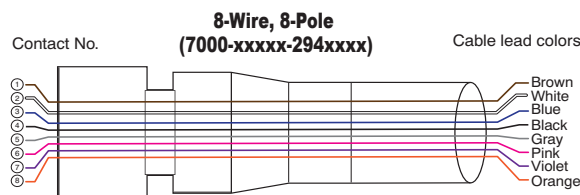
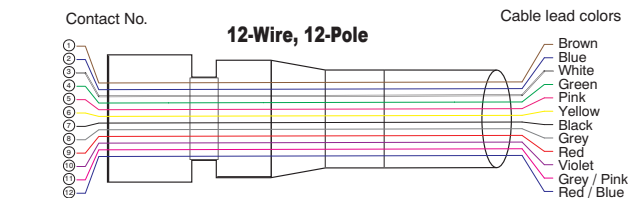
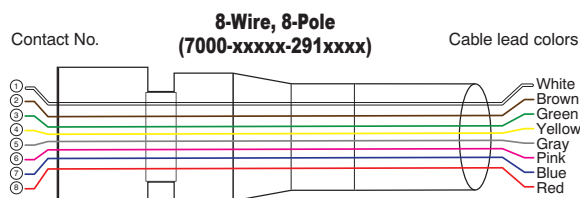
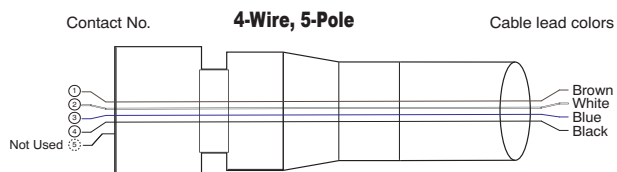
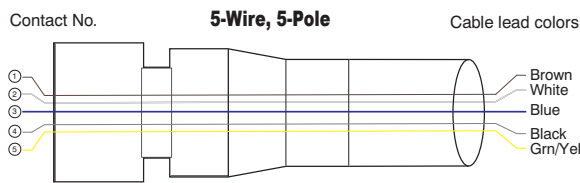
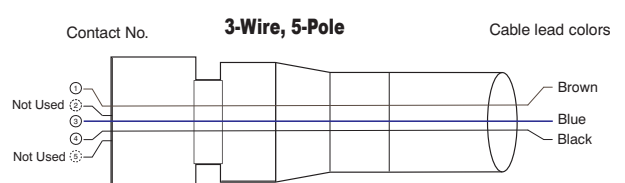

Connection Cables - Sensor and Signal

M12 A-coded Cable with LED Indication to Pigtail

Features

- Industry standard M12 right angle female plug with open leads
- Cables can be used with patch cables
- 2m [6.5 ft], 5m [16.4 ft] and 10m [32.8 ft] cable length
- LED indication for 10–36 VDC PNP sensors only
- PUR (polyurethane) jacketed cable for applications with exposure to oil and dynamic applications requiring more flexibility



M12 A-coded Cable with LED Indication to Pigtail

Part Number	Price	Length	Number of Wires	Connector	LED	Cable Jacket/Insulation Material
<u>EVC178*</u>	\$14.00	2m [6.5 ft]	4	Right-angle female	Yes	PUR
<u>EVC179*</u>	\$14.50	5m [16.4 ft]				
<u>EVC180*</u>	\$17.50	10m [32.8 ft]				

*Note: LED for 10–36 VDC PNP devices only.
 Do not use with NPN or analog output devices.
 Do not use when white wire (Pin 2) is used for selection of a sensor function.
 Do not use when emitter has check function.

M12 A-coded Cable with LED Indication to Pigtail Specifications

Operating Voltage	10-36 VDC	
Max Voltage - UL Rating	36VDC	
Max Current Per Contact	4A	
Protection Degree	IP65 / IP67 / IP68 / IP69K	
Nut Material	Nickel plated Brass	
Cable Jacket Insulation Material	Polyurethane (PUR)	
Contacts Material	Gold plated	
Tightening Torque	0.6 to 1.5 N·m [0.44 ft·lb to 1.1]	
Conductors Cross Section	0.34 mm ² [22AWG]	
Ø Outer Cable For PUR	4.3 mm [0.17 in]	
Temperature Range Stationary Use	-25 to 90°C [-13 to 194°F]	
Temperature Range Flexible Use	-25 to 90°C [-13 to 194°F]	
Min Bend Radius	Stationary use: 5 x cable diameter; Flexible use: 10 x cable diameter	
LED Current Loading	10V input Brown wire LED: 1.7 mA White and/or Black LED: 0.9 mA	36V input Brown wire LED: 7.3 mA White and/or Black LED: 4.7 mA
Switching Status LED	2 x Yellow	
Function Display Power LED	1 x Green	
Approvals *	cULus, CE, UKCA	

*To obtain the most current agency approval information, see the Agency Compliance & Certifications Checklist section on the specific part number's web page.

Wiring

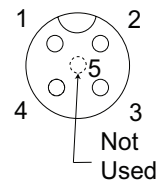
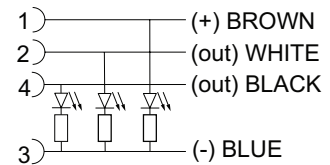

Dimensions

mm [inches]

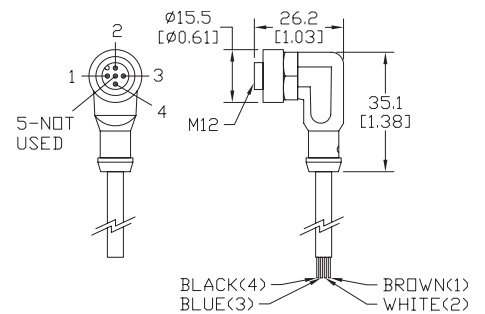

UL Reference

<u>EVC178</u>	ADOAH043MSS0002H04
<u>EVC179</u>	ADOAH043MSS0005H04
<u>EVC180</u>	ADOAH043MSS0010H04

Note: Shown in UL file under Mini-series Female Cord Connectors using catalog number

Connection Cables - Sensor and Signal

M12 A-coded Female with LED Indication to Male Cables

Features

- Right-angle M12 female plug with LED indication on one end and axial male plug on the other end
- PUR (polyurethane) jacketed cable for app with exposure to oil and dynamic applicati requiring more flexibility
- 0.3 m [0.98 ft], 0.6 m [1.97 ft], 1m [3.28 ft], 2m [6.5 ft], 5m [16.4 ft], and 10m [32.8 ft] cable lengths
- LED indication for 10–36 VDC PNP sensors only



M12 A-coded Female with LED Indication to Male Cables						
Part Number	Price	Length	Number of Wires	Connectors	LED	Cable Jacket Material
EVC322*	\$14.00	0.3 m [0.98 ft]	4	Right-angle female, axial male	Yes	PUR
EVC323*	\$15.50	0.6 m [1.97 ft]				
EVC324*	\$16.00	1m [3.28 ft]				
EVC325*	\$18.00	2m [6.5 ft]				
EVC326*	\$21.50	5m [16.4 ft]				
EVC327*	\$26.50	10m [32.8 ft]				

*Note: LED for 10–36 VDC PNP devices only.
 Do not use with NPN or analog output devices.
 Do not use when white wire (Pin 1) is used for selection of a sensor function.
 Do not use when emitter has check function.

Wiring

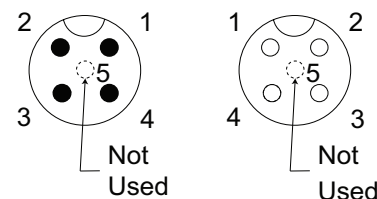
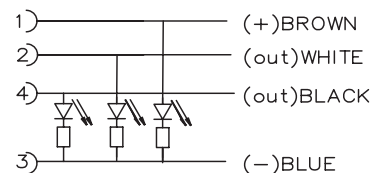

M12 A-coded Female with LED Indication to Male Cables Specifications	
Operating Voltage	10-36 VDC
Max Voltage - UL Rating	36VDC
Max Current Per Contact	4A
Protection Degree	IP65 / IP67 / IP68 / IP69K
Nut Material	Nickel plated Brass
Cable Jacket Insulation Material	Polyurethane (PUR)
Contacts Material	Gold plated
Tightening Torque	0.6 to 1.5 N·m [0.4 to 1.1 ft·lb]
Conductors Cross Section	0.34 mm ² [22AWG]
Ø Outer Cable For PUR	4.3 mm [0.17 in]
Temperature Range Stationary Use	-25 to 90°C [-13 to 194°F]
Temperature Range - Flexible Use	-25 to 90°C [-13 to 194°F]
Min Bend Radius	Stationary use: 5 x cable diameter; Flexible use: 10 x cable diameter
LED Current Loading	10V input Brown wire LED: 1.7 mA White and/or Black LED: 0.9 mA 36V input Brown wire LED: 7.3 mA White and/or Black LED: 4.7 mA
Switching Status LED	2 x Yellow
Function Display Power LED	1 x Green
Approvals*	cULus, CE, UKCA

Dimensions

mm [inches]

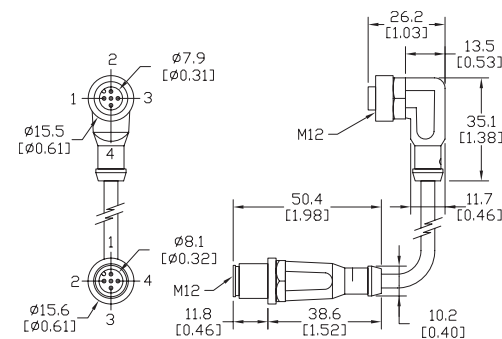

*To obtain the most current agency approval information, see the Agency Compliance & Certifications Checklist section on the specific part number's web page.

UL Reference	
EVC322	VDOAH043MSS00.3H04STGH040MSS
EVC323	VDOAH043MSS00.6H04STGH040MSS
EVC324	VDOAH043MSS0001H04STGH040MSS
EVC325	VDOAH043MSS0002H04STGH040MSS
EVC326	VDOAH043MSS0005H04STGH040MSS
EVC327	VDOAH043MSS0010H04STGH040MSS

Connection Cables - Sensor and Signal

M8 A-coded Male to Female Cables

Features

- Industry standard M8 screw-lock connectors
- One male and one female connector
- Axial and right-angle connector models
- 1m [3.28 ft] and 3m [9.84 ft] cable lengths
- PVC (polyvinyl chloride) jacketed cable for general use and chemical washdown applications, ex. food & beverage industry
- PUR (polyurethane) jacketed cable for applications with exposure to oil and dynamic applications requiring more flexibility
- PP (polypropylene) wire insulation for low temperature applications



M8 A-Coded Male to Female Cables										
Part Number	Price	Number of Wires	Connectors	Cable Jacket/ Wire Insulation Material	Jacket Color	Dimensions				
						A	B	C	D	L
						mm				m [ft]
CDP08-0A-010-AA	\$11.00	3	Axial male, axial female	PVC/PVC	Gray	39	32	10	–	1 [3.28]
CDP08-0A-010-BB	\$11.00		Right-angle male, right-angle female			26	20	10	25	
CDP08-0A-030-AA	\$12.50		Axial male, axial female			39	32	10	–	3 [9.84]
CDP08-0A-030-BB	\$11.00		Right-angle male, right-angle female			26	20	10	25	
7000-88001-0200100	\$10.50		Axial male, axial female	PUR/PVC	Yellow	39	32	10	–	1 [3.28]
7000-88001-0300100	\$11.00		Axial male, axial female	PUR/PP		39	32	10	–	
7000-88081-0300100	\$11.00		Right-angle male, right-angle female	PUR/PP		26	20	10	25	
7000-88001-0300300	\$13.00		Axial male, axial female	PUR/PP		39	32	10	–	3 [9.84]
7000-88081-0200300	\$12.00		Right-angle male, right-angle female	PUR/PVC		26	20	10	25	
7000-88081-0300300	\$13.00		Right-angle male, right-angle female	PUR/PP		26	20	10	25	

Dimensions

2 Axial - 1 male to 1 female

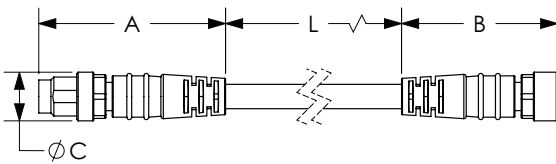

2 Right-angle - 1 male to 1 female

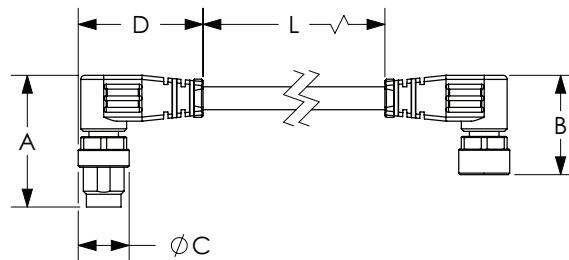

See our website: www.AutomationDirect.com for complete engineering drawings.

Connection Cables - Sensor and Signal

M8 A-coded Male to Female Cables Specifications		
Model	CDP08 Series	7000 Series
Type	3-Wire, 3-Pole	3-Wire, 3-Pole
Max Voltage	50VAC / 60VDC	
Max Voltage - UL Rating	30 VAC/VDC	
Max Current	4A	
Protection Degree	IP65 / IP66K / IP67	
Nut Material	Nickel plated Zinc	
Cable Jacket/Wire Insulation Material	PVC/PVC	PUR/PVC or PUR/PP
Contacts Material	Copper Alloy	
Tightening Torque	≤ 0.4 N·m [≤ 0.34 ft-lb]	
Conductors Cross Section	0.25 mm ² [24AWG]	
Ø Outer Cable For PUR/PVC or PVC/PVC	4.5 mm [0.18 in]	
Ø Outer Cable For PUR/PP	N/A	4.1 mm [0.16 in]
Temperature Range - Stationary Use	PUR/PP -40 to 80°C [-40 to 176°F], PVC/PVC or PUR/PVC -25 to 80°C [-13 to 176°F]	
Temperature Range - Flexible Use	PUR/PP -25 to 80°C [-13 to 176°F], PVC/PVC or PUR/PVC -5C to 80°C [23 to 176°F]	
Min Bend Radius	Stationary use: 5 x cable diameter; Flexible use: 10 x cable diameter	
Approvals*	CE, cCSAus	cULus, CE, UKCA, cCSAus

*To obtain the most current agency approval information, see the Agency Compliance & Certifications Checklist section on the specific part number's web page.

Contact Diagram

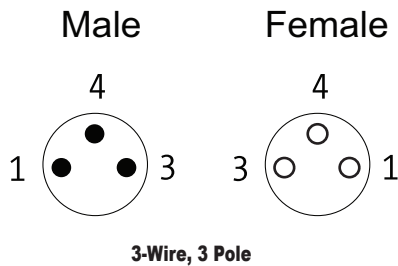

Wiring Diagram

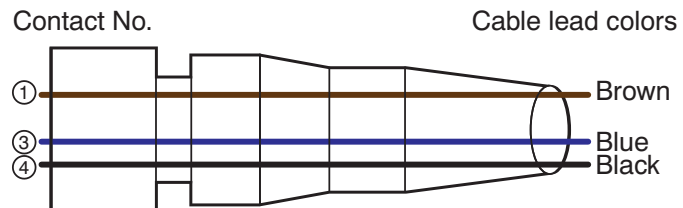

Connection Cables - Sensor and Signal

M12 A-coded Male to Female Cables

Features

- Industry standard M12 screw-lock connectors
- One male and one female connector
- Axial and right-angle connector models
- 1m [3.28 ft] and 3m [9.84 ft] cable lengths
- PVC (polyvinyl chloride) jacketed cable for general use and chemical washdown applications, ex. food & beverage industry
- PUR (polyurethane) jacketed cable for applications with exposure to oil and dynamic applications requiring more flexibility
- PP (polypropylene) wire insulation for low temperature applications



M12 A-coded Male to Female Cables										
Part Number	Price	Number of Wires	Connectors	Cable Jacket/ Wire Insulation Material	Jacket Color	Dimensions				
						A	B	C	D	L
						mm				m [ft]
CDP12-0B-010-AA	\$11.00	4	Axial male, axial female	PVC/PVC	Gray	41	38	15	-	1 [3.3]
CDP12-0B-010-BB	\$11.00		Right-angle male, right-angle female			31	28	15	39	
CDP12-0B-030-AA	\$11.00		Axial male, axial female			41	38	15	-	3 [9.8]
CDP12-0B-030-BB	\$12.50		Right-angle male, right-angle female			31	28	15	39	
7000-40021-0340100	\$10.00	4	Axial male, axial female	PUR/PP	Gray	41	38	15	-	1 [3.3]
7000-40261-0340100	\$13.00		Right-angle male, right-angle female			31	28	15	39	
7000-40021-0340300	\$14.00		Axial male, axial female			41	38	15	-	3 [9.8]
7000-40261-0340300	\$16.00		Right-angle male, right-angle female			31	28	15	39	
7000-40041-0350100	\$17.00	5	Axial male, axial female	PUR/PP	Gray	41	38	15	-	1 [3.3]
7000-40041-0350300	\$21.00		Axial male, axial female			41	38	15	-	3 [9.8]
7000-40041-2150100	\$16.50		Axial male, axial female	PUR/PVC		41	38	15	-	1 [3.3]
7000-40041-2150300	\$20.50		Axial male, axial female			41	38	15	-	3 [9.8]

Dimensions

2 Axial - 1 male to 1 female

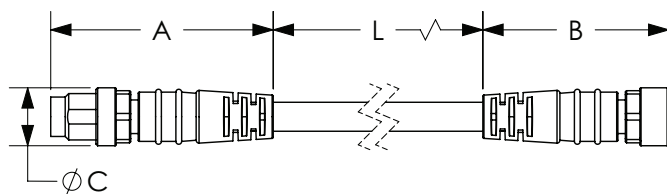

2 Right-angle - 1 male to 1 female

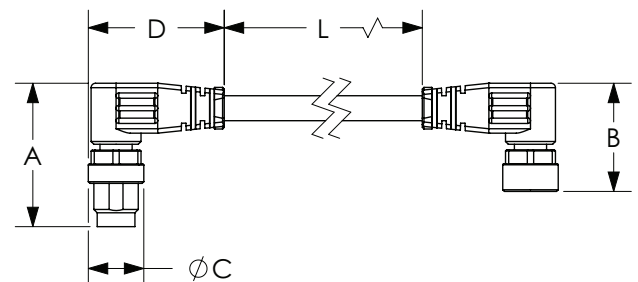

See our website: www.AutomationDirect.com for complete engineering drawings.

Connection Cables - Sensor and Signal

M12 A-coded Male to Female Cables Specifications			
Model	CDP12 Series	7000 Series	
Type	4-Wire, 5-Pole	4-Wire, 5-Pole	5-Wire, 5-Pole
Max Voltage	250 VAC/VDC		125 VAC/VDC
Max Voltage - UL Rating	30 VAC/VDC		
Max Current	4A		
Protection Degree	IP65 / IP66K / IP67		IP67
Nut Material	Male threads are nickel plated brass; Female threads are nickel plated die cast zinc		
Jacket/Wire Insulation Material	PVC/PVC	PVC/PVC or PUR-PVC/PVC or PUR/PP or PUR/PVC	
Contacts Material	Copper Alloy		
Tightening Torque	≤ 0.6 N·m [≤ 0.44 ft·lbs]		
Conductors Cross Section	0.34 mm ² [22AWG]		
Ø Outer Cable For PUR-PVC/PVC or PUR/PVC or PVC/PVC	5.0 mm [0.20 in]	5.2 mm [0.20 in]	PUR-PVC/PVC 5.9 mm [0.23 in] PVC/PVC 5.2 mm [0.20 in]
Ø Outer Cable For PUR/PP	N/A	4.5 mm [0.18 in]	4.8 mm [0.19 in]
Temperature Range - Stationary Use	PUR/PP -40 to 80°C [-40 to 176°F], PVC/PVC or PUR-PVC/PVC -25 to 80°C [-13 to 176°F]		
Temperature Range - Flexible Use	PUR/PP -25 to 80°C [-13 to 176°F], PVC/PVC or PUR/PVC -5 to 80°C [23 to 176°F]		
Min Bend Radius	Stationary use: 5 x cable diameter; Flexible use: 10 x cable diameter		
Approvals*	CE, cCSAus	cULus, CE, UKCA, cCSAus	

*To obtain the most current agency approval information, see the Agency Compliance & Certifications Checklist section on the specific part number's web page.

Contact Diagrams

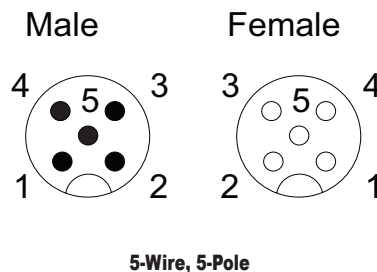
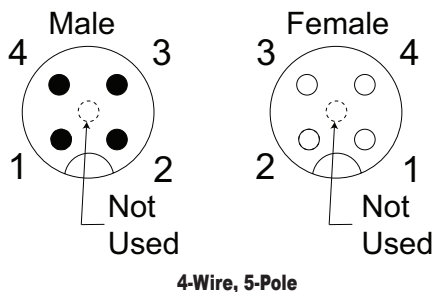

Wiring Diagrams

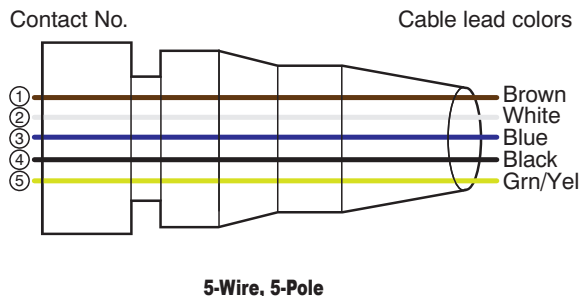
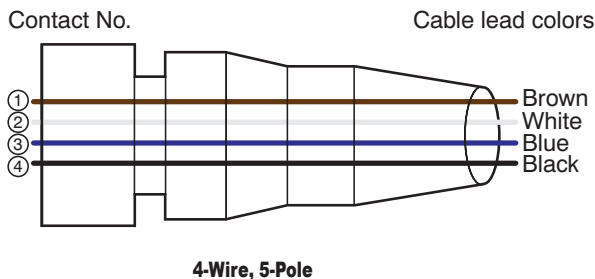

Connection Cables - Sensor and Signal

M8 A-coded Cables to Pigtail - IP69K

Features

- Industry standard axial and right-angle M8 connectors with open leads
- Available in 2m [6.56 ft], 5m [16.4 ft], and 10m [32.81] cable lengths
- IP69K rating, suitable for food and beverage industrial applications
- 316L stainless steel coupling nut
- EPDM O-ring
- PVC (polyvinyl chloride) jacketed cable for general use and chemical washdown applications, ex. food & beverage industry



M8 A-coded Cables to Pigtail - IP69K							
Part Number	Price	Number of Wires	Connectors	Cable Jacket Material	Jacket Color	Length m [ft]	Drawing Link
EVT421	\$12.50	4	Axial female	PVC	Orange	2 [6.56]	PDF
EVT422	\$16.50					5 [16.4]	PDF
EVT423	\$22.50					10 [32.81]	PDF
EVT424	\$12.50		Right-angle female			2 [6.56]	PDF
EVT425	\$16.50					5 [16.4]	PDF
EVT426	\$22.50					10 [32.81]	PDF

M8 A-coded Male to Female Cables - IP69K

Features

- Industry standard M8 screw-lock connectors
- Axial and right-angle connector models
- 0.6 m [1.97 ft], 1m [3.28], 2m [6.56] and 5m [16.4] cable lengths
- IP69K rating, suitable for food and beverage industrial applications
- 316L stainless steel coupling nut
- EPDM O-ring
- PVC (polyvinyl chloride) jacketed cable for general use and chemical washdown applications, ex. food & beverage industry

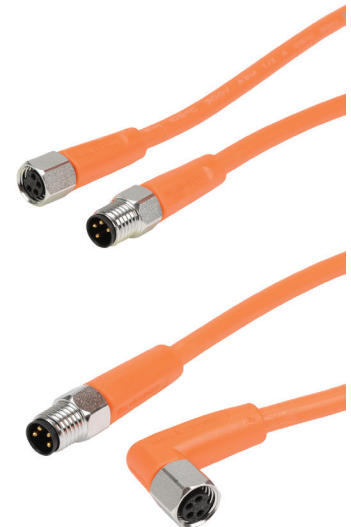

M8 A-coded Male to Female Cables - IP69K (Euro, Micro DC-Single Key)							
Part Number	Price	Number of Wires	Connectors	Cable Jacket Material	Jacket Color	Length m [ft]	Drawing Link
EVT428	\$19.00	4	Axial male to axial female	PVC	Orange	0.6 [1.97]	PDF
EVT429	\$20.50					1 [3.28]	PDF
EVT430	\$25.00					2 [6.56]	PDF
EVT431	\$28.00					5 [16.4]	PDF
EVT433	\$19.00		Axial male to right-angle female			0.6 [1.97]	PDF
EVT434	\$20.50					1 [3.28]	PDF
EVT435	\$25.00					2 [6.56]	PDF
EVT436	\$28.00					5 [16.4]	PDF

Connection Cables - Sensor and Signal

Cable Specifications	
Type	4-Wire, 4-Pole
Max Voltage	50VAC / 60VDC
Max Current Per Contact	3A
Protection Degree	IP65 / IP67 / IP68 / IP69K
Nut Material	316L stainless steel
Cable Jacket Material	Polyvinyl chloride (PVC)
Contacts Material	Gold plated
Tightening Torque	0.3 to 0.5 N·m [0.2 to 0.3 lb·ft]
Conductors Cross Section	0.34mm ² [22AWG]
Ø Outer Cable	4.9 mm [0.19 in]
Temperature Range - Stationary Use	-25 to 80°C [-13 to 176°F]
Temperature Range - Flexible Use	5 to 80°C [41 to 176°F]
Min Bend Radius	Stationary use: 5 x cable diameter; Flexible use: 10 x cable diameter
Approvals*	cULus, CE, UKCA

UL Reference	
Part Number	UL Catalog Number
EVT421	ADOGF040VAS0002E04
EVT422	ADOGF040VAS0005E04
EVT423	ADOGF040VAS0010E04
EVT424	ADOAF040VAS0002E04
EVT425	ADOAF040VAS0005E04
EVT426	ADOAF040VAS0010E04
EVT428	VDOGF040VAS00.6E04STGF040VAS
EVT429	VDOGF040VAS0001E04STGF040VAS
EVT430	VDOGF040VAS0002E04STGF040VAS
EVT431	VDOGF040VAS0005E04STGF040VAS
EVT433	VDOAF040VAS00.6E04STGF040VAS
EVT434	VDOAF040VAS0001E04STGF040VAS
EVT435	VDOAF040VAS0002E04STGF040VAS
EVT436	VDOAF040VAS0005E04STGF040VAS

* To obtain the most current agency approval information, see the Agency Compliance & Certifications Checklist section on the specific part number's web page.

Contact Diagrams

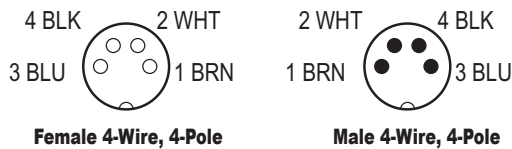

Wiring Diagram



M8 Cables Mounting Instructions

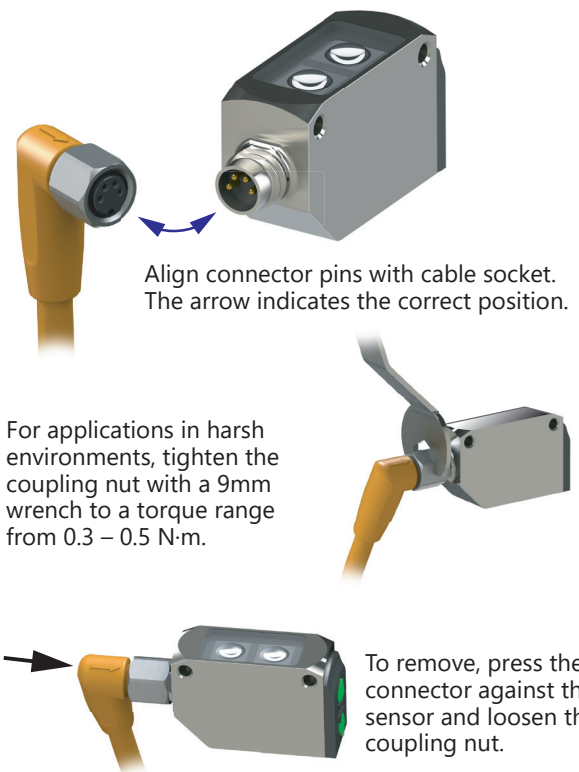

Connection Cables - Sensor and Signal

M12 A-coded Cables to Pigtail -IP69K

Features

- Industry standard axial and right-angle M12 or 1/2" micro connectors with open leads
- 5m [16.4 ft] and 10m [32.8 ft] cable lengths
- IP69K rated for food and beverage industrial applications
- 316L stainless steel coupling nut
- EPDM o-ring
- PVC (polyvinyl chloride) jacket for food and beverage industrial applications

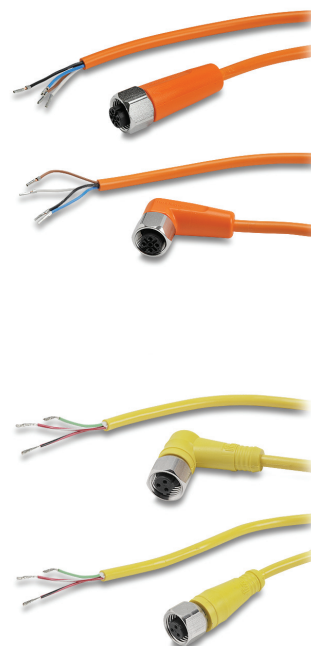

M12 A-coded Cables to Pigtail - IP69K (Euro, Micro DC-Single Key)								
Part Number	Price	Number of Wires	Connector	LED	Cable Jacket Material	Jacket Color	Length m [ft]	Drawing Link
M12 Quick-Disconnects								
EVT221	\$16.00	4	Axial female	No	PVC	Orange	5 [16.4]	PDF
EVT222	\$16.00		Right-angle female					PDF
EVT223	\$22.00		Axial female				10 [32.8]	PDF
EVT224	\$22.00		Right-angle female					PDF
Micro AC 1/2 Inch - 20UNF Cables								
1/2" Quick-Disconnects								
E18446	\$26.50	3	Axial female	No	PVC	Yellow	5 [16.4]	PDF
E18447	\$33.00		Right-angle female					PDF
E18448	\$26.50		Axial female				10 [32.8]	PDF
E18449	\$33.00		Right-angle female					PDF

M12 A-coded Female to Male Cables - IP69K

Features

- Industry standard M12 screw-lock connectors
- Axial and right-angle connector models
- 0.3m [0.98 ft], 0.6m [1.97 ft], 1m [3.3 ft], 2m [6.6 ft] and 5m [16.4 ft] cable lengths
- IP69K rating, suitable for food and beverage industrial applications
- 316L stainless steel coupling nut
- EPDM o-ring
- PVC (polyvinyl chloride) jacket for food and beverage industrial applications



M12 A-coded Female to Male Cables - IP69K (Euro, Micro DC-Single Key)							
Part Number	Price	Number of Wires	Connectors	Cable Jacket Material	Jacket Color	Length m [ft]	Drawing Link
M12 Quick-Disconnect Patch Cables							
EVT225	\$20.00	4	Axial female to axial male	PVC	Orange	0.3 [0.98]	PDF
EVT226	\$21.00		Right-angle female to axial male				PDF
EVT227	\$21.50		Axial female to axial male			0.6 [1.97]	PDF
EVT228	\$23.00		Right-angle female to axial male				PDF
EVT229	\$26.00		Axial female to axial male			1 [3.3]	PDF
EVT230	\$20.00		Right-angle female to axial male				PDF
EVT231	\$21.00		Axial female to axial male			2 [6.6]	PDF
EVT232	\$21.50		Right-angle female to axial male				PDF
EVT233	\$23.00		Axial female to axial male			5 [16.4]	PDF
EVT234	\$26.00		Right-angle female to axial male				PDF

Connection Cables - Sensor and Signal

Cable Specifications			
Specification	M12 Quick-Disconnects	1/2" Quick-Disconnects	M12 Quick-Disconnect Patch Cables
Type	4-Wire, 5-Pole	3-Wire, 3-Pole	4-Wire, 5-Pole
Max Voltage	250VAC / 300VDC	300 VAC/VDC	250VAC / 300VDC
Max Current Per Contact	4A		
Protection Degree	IP65 / IP67/ IP68 / IP69K	IP68	IP65 / IP67/ IP68 / IP69K
Nut Material	316L Stainless steel		
Cable Jacket Material	PolyVinyl Chloride (PVC)		
Contacts Material	Gold plated		
Tightening Torque	0.6 to 1.5 N·m [0.44 to 1.1 ft·lb]		
Conductors Cross Section	0.34 mm ² [22AWG]		
Ø Outer Cable	4.9 mm [0.19 in]	4.5 mm	4.9 mm [0.19 in]
Temperature Range - Stationary Use	-25 to 100°C [-13 to 212°F]	-10 to 100°C [14 to 212°F]	-25 to 100°C [-13 to 212°F]
Temperature Range - Flexible Use	5 to 80°C [41 to 176°F]	5 to 80°C [41 to 176°F]	-5 to 100°C [-23 to 212°F]
Min Bend Radius	Stationary use: 5 x cable diameter; Flexible use: 10 x cable diameter		
Approvals*	cULus, CE, UKCA	cULus,	cULus, CE, UKCA

*To obtain the most current agency approval information, see the Agency Compliance & Certifications Checklist section on the specific part number's web page.

Contact Diagrams M12 DC

EVT221, EVT222, EVT223, EVT224

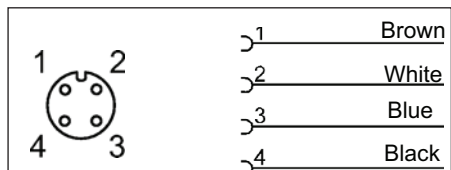

EVT225, EVT226, EVT227, EVT228, EVT229, EVT230, EVT231, EVT232, EVT233, EVT234

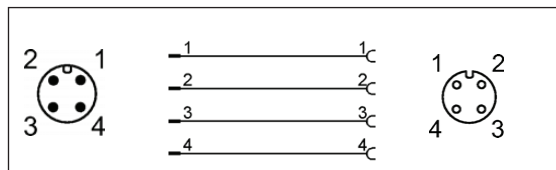

UL Reference	
Part Number	UL Catalog Number
EVT221	ADOGH040VAS0005E04
EVT222	ADOAH040VAS0005E04
EVT223	ADOGH040VAS0010E04
EVT224	ADOAH040VAS0010E04
EVT225	VDOGH040VAS00.3E04STGH040VAS
EVT226	VDOAH040VAS00.3E04STGH040VAS
EVT227	VDOGH040VAS00.6E04STGH040VAS
EVT228	VDOAH040VAS00.6E04STGH040VAS
EVT229	VDOGH040VAS0001E04STGH040VAS
EVT230	VDOAH040VAS0001E04STGH040VAS
EVT231	VDOGH040VAS0002E04STGH040VAS
EVT232	VDOAH040VAS0002E04STGH040VAS
EVT233	VDOGH040VAS0005E04STGH040VAS
EVT234	VDOAH040VAS0005E04STGH040VAS

Contact Diagram- 1/2" Micro AC

E18446, E18447, E18448, E18449

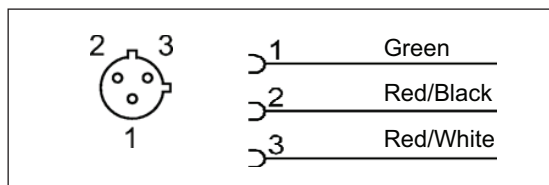



stay connected

Connection Cables - Sensor and Signal

FDA Compliant M12 A-coded Cable to Pigtail

Features

- Industry standard axial and right-angle M12 connectors with open leads
- 2m [6.5 ft], 3m [9.8 ft], 5m [16.4 ft], 7m [22.9 ft], 10m [32.8 ft], 15m [49.2 ft], 20m [65.6 ft] and 25m [82ft] cable lengths
- IP69K rated to withstand high pressure, high temperature wash-down applications
- Food grade TPE-S (Styrene-Butadiene Thermoplastic Elastomer) jacket for food and beverage industrial applications

M12 A-Coded Cable to Pigtail									
Part Number	Price	Number of Wires	Connector	Cable Jacket/ Wire Insulation Material	Jacket Color	Dimensions (mm [in])			
						A	B	C	L (m [ft])
7024-12181-3150500	\$19.50	3	Axial female	TPE-S/PP	Ice blue	39 [1.5]	15 [0.6]	n/a	5 [16.4]
7024-12221-3210200	\$16.00	4							2 [6.5]
7024-12221-3210300	\$18.50								3 [9.8]
7024-12221-3210500	\$20.50								5 [16.4]
7024-12221-3210700	\$25.00								7 [22.9]
7024-12221-3211000	\$29.50								10 [32.8]
7024-12221-3211500	\$37.50								15 [49.2]
7024-12221-3212000	\$47.00								20 [65.6]
7024-12221-3212500	\$56.00								25 [82]
7024-12241-3390200	\$20.50	5							2 [6.5]
7024-12241-3390300	\$22.00								3 [9.8]
7024-12241-3390500	\$25.00								5 [16.4]
7024-12241-3390700	\$29.50								7 [22.9]
7024-12241-3391000	\$34.50								10 [32.8]
7024-12241-3391500	\$45.50								15 [49.2]
7024-12241-3392000	\$55.00								20 [65.6]
7024-12241-3392500	\$63.00		25 [82]						
7024-12321-3150500	\$19.50	3	Right-angle female	TPE-S/PP	Ice blue	37 [1.46]	15 [0.6]	29 [1.1]	5 [16.4]
7024-12341-3210200	\$16.00	4							2 [6.5]
7024-12341-3210300	\$18.50								3 [9.8]
7024-12341-3210500	\$20.50								5 [16.4]
7024-12341-3210700	\$25.00								7 [22.9]
7024-12341-3211000	\$29.50								10 [32.8]
7024-12341-3211500	\$37.50								15 [49.2]
7024-12341-3212000	\$47.00								20 [65.6]
7024-12341-3212500	\$56.00								25 [82]
7024-12361-3390200	\$20.50	5							2 [6.5]
7024-12361-3390300	\$22.00								3 [9.8]
7024-12361-3390500	\$25.00								5 [16.4]
7024-12361-3390700	\$29.50								7 [22.9]
7024-12361-3391000	\$34.50								10 [32.8]
7024-12361-3391500	\$45.50								15 [49.2]
7024-12361-3392000	\$55.00								20 [65.6]
7024-12361-3392500	\$63.00		25 [82]						

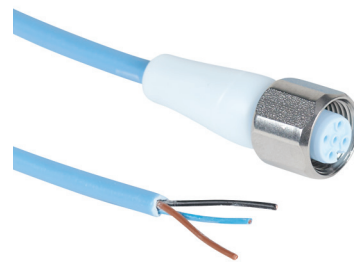

[7024-12181-3150500](#)

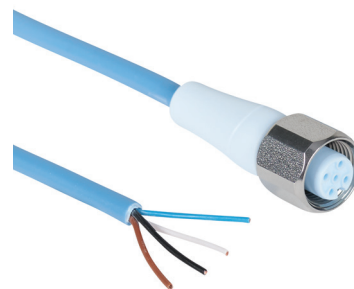

[7024-12221-3210200](#)

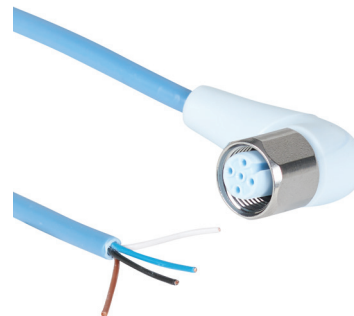

[7024-12341-3210200](#)

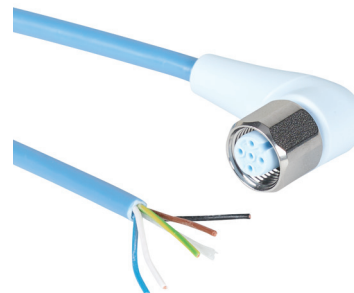

[7024-12361-3390300](#)

Connection Cables - Sensor and Signal

M12 A-coded Cable to Pigtail Specifications			
Model	7024 Series		
Type	3-Wire, 5-Pole	4-Wire, 5-Pole	5-Wire, 5-Pole
Max Voltage	250 VAC/VDC		125 VAC/VDC
Max Voltage - UL Rating	30 VAC/VDC		
Max contact Per Contact	4A		
Protection Degree	IP65 / IP68 / IP69K		
Nut Material	Stainless steel		
Cable Jacket/Wire Insulation Material	TPE-S/PP		
Contacts Material	Copper-Tin alloy		
Tightening Torque	0.6 N·m [0.44 ft-lb]		
Conductors Cross Section	0.34 mm ² [22AWG]		
Ø Outer Cable	4.3 mm [0.17 in]	4.7 mm [0.18 in]	5.0 mm [0.20 in]
Temperature Range - Stationary Use	-40 to 105°C [-40 to 221°F]		
Temperature Range - Flexible Use	-25 to 105°C [-13 to 221°F]		
Min Bend Radius	Stationary use: 5 x cable diameter; Flexible use: 10 x cable diameter		
Approvals*	cULus		

* To obtain the most current agency approval information, see the Agency Compliance & Certifications Checklist section on the specific part number's web page.

Dimensions

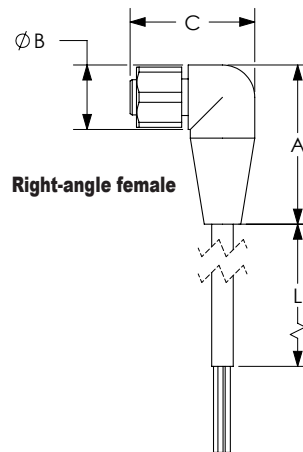
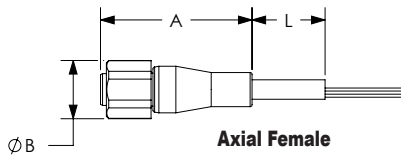

Contact Diagrams

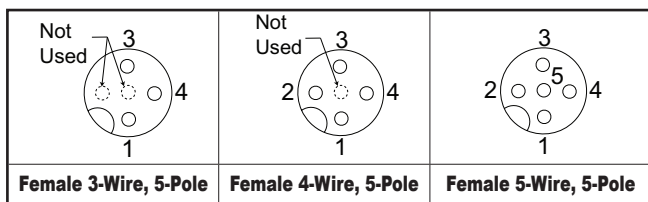

Wiring Diagrams

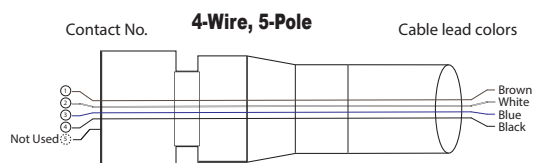
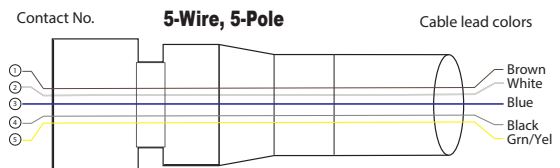
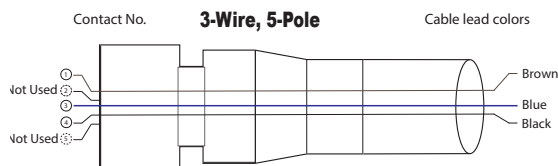



stay connected

Connection Cables - Sensor and Signal

FDA Compliant M12 A-Coded Male to Female Cables

Features

- Available patch cables include:
 - Industry standard M12 screw-lock connectors
 - One male and one female connector
 - Axial and right-angle connector models
 - 1m [3.2 ft], 3m [9.8 ft] and 5m [16.4 ft] cable lengths
- IP69K rating, suitable for food and beverage industrial applications
- TPE-S (Styrene-Butadiene Thermoplastic Elastomer) jacket for food and beverage industrial applications



7024-40021-3210100



7024-40261-3210100

M12 A-coded Male to Female Cables (Euro, Micro DC-Single Key)										
Part Number	Price	Number of Wires	Connectors	Cable Jacket/ Wire Insulation Material	Jacket Color	Dimensions (mm [in])				
						A	B	C	D	L (m [ft])
7024-40021-3210100	\$23.50	4	Axial male to axial female	TPE-S /PP	Ice Blue	42	39	15	n/a	1 [3.2]
7024-40021-3210300	\$27.00					[1.65]	[1.5]	[0.6]	n/a	3 [9.8]
7024-40021-3210500	\$30.50									5 [16.4]
7024-40261-3210100	\$26.00		Right-angle male to right-angle female			32	29	15	37	1 [3.2]
7024-40261-3210300	\$29.50					[1.26]	[1.1]	[0.6]	[1.46]	3 [9.8]
7024-40261-3210500	\$33.50									5 [16.4]
7024-40041-3390100	\$27.00	5	Axial male to axial female					1 [3.2]		
7024-40041-3390300	\$30.50			42	39	15	n/a	3 [9.8]		
7024-40041-3390500	\$33.50			[1.65]	[1.5]	[0.6]	n/a	5 [16.4]		

M12 A-coded Male to Female Cables Specifications		
Model	7024 Series	
Type	4-Wire, 5-Pole	5-Wire, 5-Pole
Max Voltage	250 VAC/VDC	125 VAC/VDC
Max Voltage - UL Rating	30 VAC/VDC	
Max Current Per Contact	4A	
Protection Degree	IP65 / IP68 / IP69K	
Nut Material	Stainless steel	
Cable Jacket/Wire Insulation Material	TPE-S/PP	
Contact Material	Copper-Tin Alloy	
Tightening Torque	0.6 N·m [0.44 ft-lb]	
Conductors Cross Section	0.34 mm ² [22AWG]	
Ø Outer Cable	4.7 mm [0.18 in]	5.0 mm [0.20 in]
Temperature Range - Stationary Use	-40 to 105°C [-40 to 221°F]	
Temperature Range - Flexible Use	-25 to 105°C [-13 to 221°F]	
Min Bend Radius	Stationary use: 5 x cable diameter; Flexible use: 10 x cable diameter	
Approvals*	cULus	

* To obtain the most current agency approval information, see the Agency Compliance & Certifications Checklist section on the specific part number's web page.

Connection Cables - Sensor and Signal

Dimensions

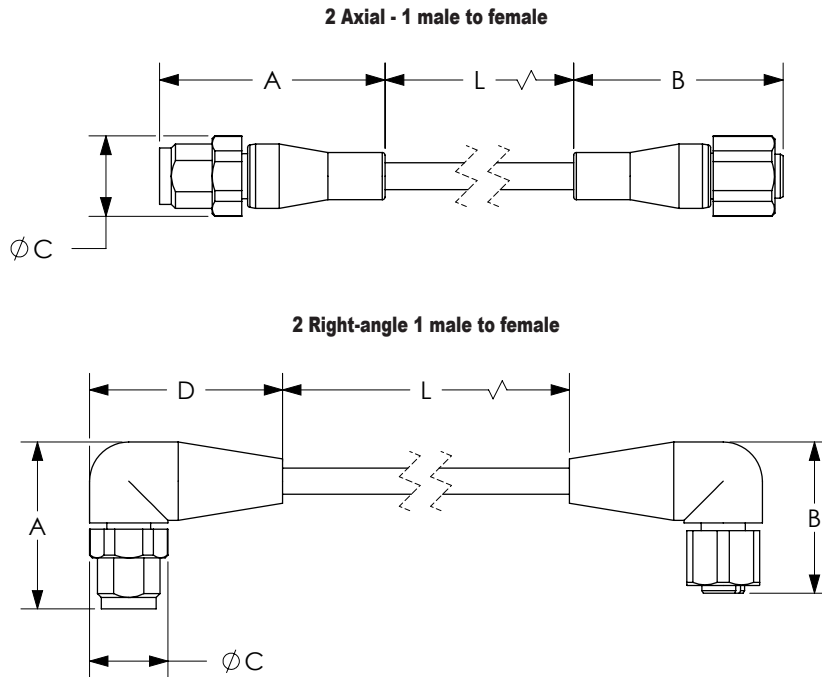

Contact Diagrams

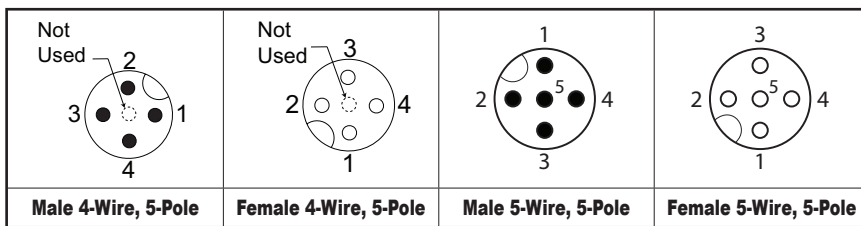

Wiring Diagrams

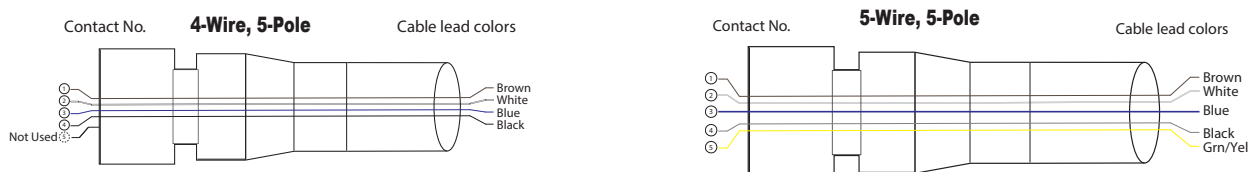



stay connected

Connection Cables - Sensor and Signal

M8 and M12 Insulation Displacement (IDC) Connectors



Features

- IDC (insulation displacement connection) allows quick termination without stripping conductors
- Various cable gauges and diameters accepted
- M8 and M12 connector types available

Field Wireable M8 Insulation Displacement (IDC) Connectors						
Part Number	Price	Number of Wires	Connector Type	Conductor Wire	Housing Material	Outside Cable Ø
7000-08331-0000000	\$12.50	3	Axial male, A-coded	26 to 22 AWG [0.14 to 0.34 mm ²]	Polyamide (PA)	2.5 to 5.1 mm [0.098 to 0.20 in]
7000-08351-0000000	\$12.50	4				
7000-08371-0000000	\$12.50	3	Axial female, A-coded			
7000-08391-0000000	\$14.00	4				

Field Wireable M12 Insulation Displacement (IDC) Connectors						
Part Number	Price	Number of Wires	Connection Type	Conductor Wire	Housing Material	Outside Cable Ø
7000-12481-0000000	\$10.50	4	Axial male, A-coded	24 to 20 AWG [0.25 to 0.5 mm ²]	Thermoplastic polyester elastomer (TPE- E)	4 to 5.1 mm [0.157 to 0.20 in]
7000-12601-0000000	\$12.00		Axial female, A-coded	26 to 22 AWG [0.14 to 0.34 mm ²]	Polyamide (PA)	2.9 to 5.1 mm [0.114 to 0.20 in]
7000-12491-0000000	\$12.00		Axial male, A-coded			
7000-12611-0000000	\$14.00		Axial female, A-coded	24 to 20 AWG [0.25 to 0.5 mm ²]	Thermoplastic polyester elastomer (TPE- E)	4 to 5.1 mm [0.157 to 0.20 in]
7000-12561-0000000	\$15.00		Right-angle male, A-coded			
7000-12681-0000000	\$16.50		Right-angle female, A-coded			
Shielded						
7000-14521-0000000	\$35.50	4	Axial male, D-coded	26 to 22 AWG [0.14 to 0.34 mm ²]	Polypropylene (PP)	4.5 to 8.8 mm [0.18 to 0.35 in]
7000-14621-0000000	\$41.00		Axial female, D-coded			

M8 and M12 Insulation Displacement (IDC) Connector Specifications				
Model	M8		M12	
Type	3-Wire, 3-Pole A-coded	4-Wire, 4-Pole A-coded	4-Wire, 5-Pole A-coded	4-Wire, 5-Pole D-coded
Outside Cable Ø	2.5 to 5.1 mm	2.5 to 5.1 mm	2.9 to 5.1 mm	4 to 5.1 mm 4.5 to 8.8 mm
Max Voltage	32 VAC/VDC			50 VAC/VDC
Max Current per Contact	4A			
Temperature Range	-25 to 85°C [-13 to 185°F]			
Protection Degree	IP67		IP65 / IP67	
Isolation Materials	(Recommended conductor insulation) PVC/PP/TPE PolyVinyl Chloride/Polypropylene/Thermoplastic Elastomer			PVC, PE (Polyvinyl Chloride, Polyethylene)
Wire Diameter	1.2 to 1.6 mm [0.047 to 0.063 in]	1.0 to 1.6 mm [0.039 to 0.063 in]	1.2 to 1.6 mm [0.047 to 0.063 in]	1.2 to 2.0 mm [0.047 to 0.079 in]
Weight	0.03 oz [0.85 g]	0.04 oz [1.13 g]	0.05 oz [1.42 g]	0.06 oz [1.7 g]
Approvals*	cURus			

* To obtain the most current agency approval information, see the Agency Compliance & Certifications Checklist section on the specific part number's web page.

Contact Diagrams

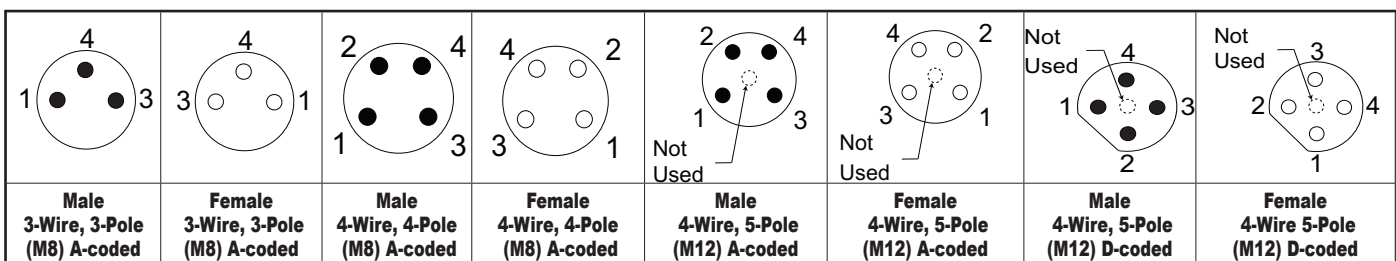

Field Wireable Connectors

M8 IDC Connectors Dimensions and Wiring

Wiring Diagrams

3-Wire, 3-Pole Male Connector

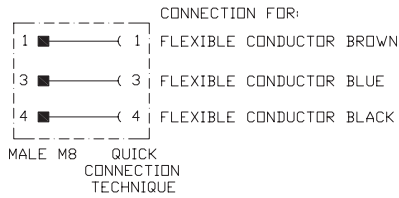

4-Wire, 4-Pole Male Connector

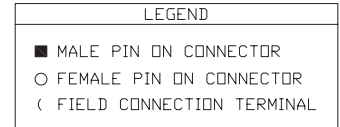
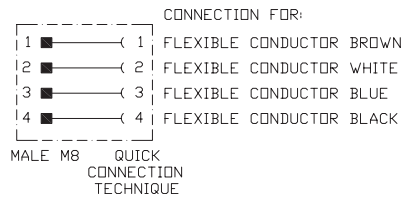

3-Wire, 3-Pole Female Connector

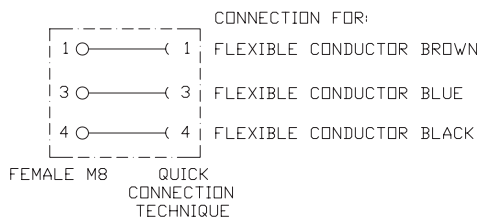

4-Wire, 4-Pole Female Connector

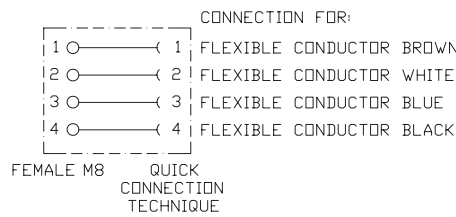

Dimensions

mm [inches]

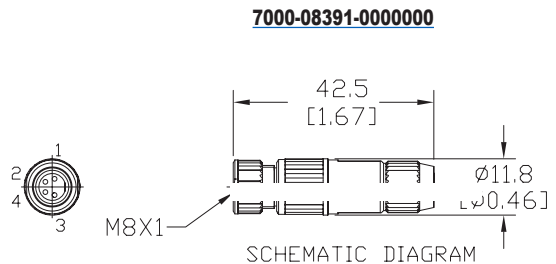
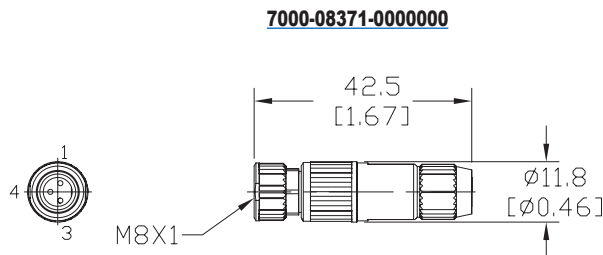
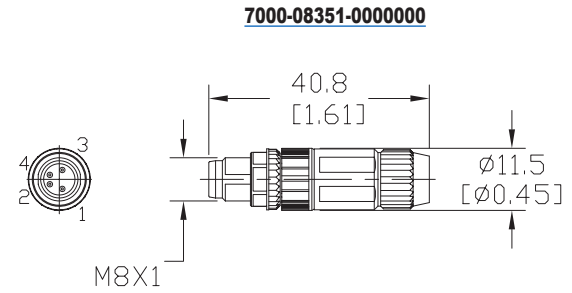
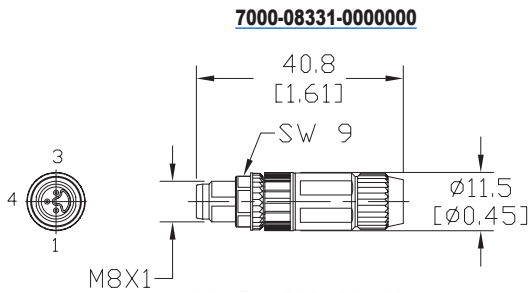

Field Wireable Connectors

M12 IDC Connectors Dimensions and Wiring

Wiring Diagrams

4-Wire, 5-Pole Female Connector

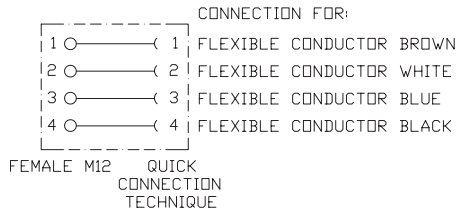

4-Wire, 5-Pole Male Connector

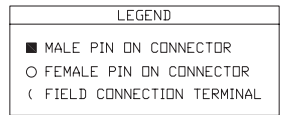
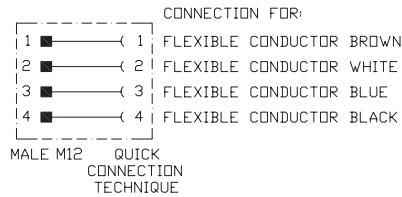

Dimensions

mm [inches]

7000-12481-0000000

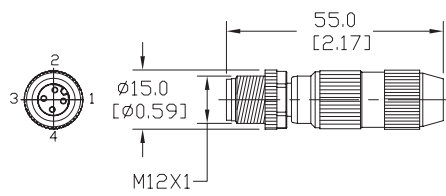

7000-12601-0000000

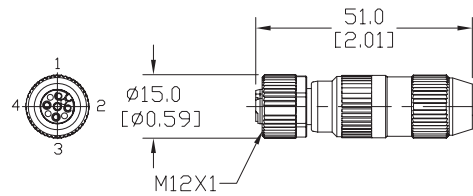

7000-12491-0000000

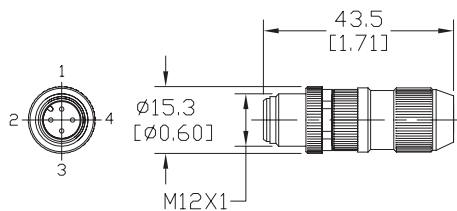

7000-12611-0000000

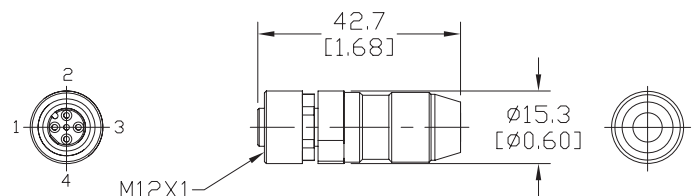

7000-12561-0000000

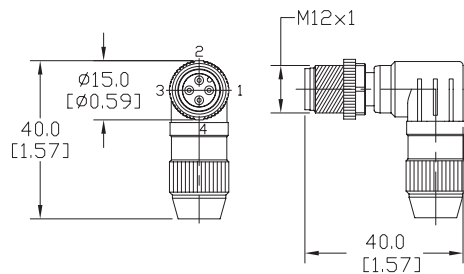

7000-12681-0000000

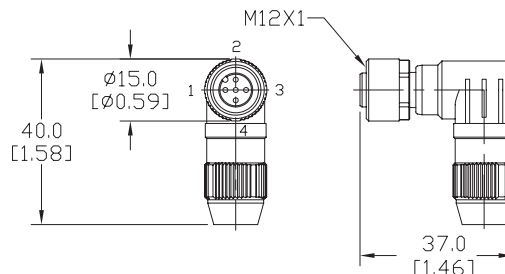

7000-14521-0000000

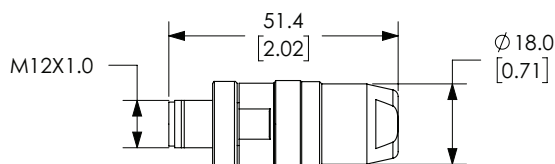

7000-14621-0000000

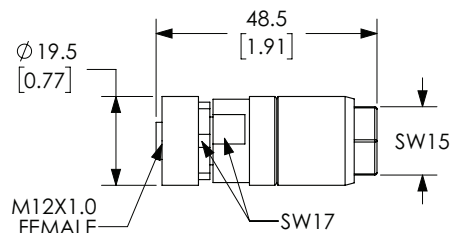



stay connected

Field Wireable Connectors

M12 Field Wireable Screw Connectors



Features

- IP67 rated once properly assembled
- Various cable gauges and diameters accepted
- Plastic housings with good resistance against chemicals and oils

Field Wireable M12 Screw Connectors								
Part Number	Price	Number of Wires	Connection Type	Conductor Wire	Housing Material	Outside Cable Ø		
7000-12701-0000000	\$9.75	4	Axial male, A-coded	18AWG [0.75 mm ²] max	Polyamide (PA)	4 to 6 mm [0.157 to 0.236 in]		
7000-12721-0000000	\$12.00	5						
7000-12901-0000000	\$9.75	4	Axial female, A-coded					
7000-12921-0000000	\$12.00	5						
7000-12741-0000000	\$9.75	4	Axial male, A-coded			6 to 8 mm [0.236 to 0.315 in]		
7000-12761-0000000	\$12.00	5						
7000-12941-0000000	\$9.75	4	Axial female, A-coded					
7000-12961-0000000	\$12.00	5						
7000-12821-0000000	\$9.75	4	Right-angle male, A-coded			20AWG [0.5 mm ²] max	PUR	4 to 6 mm [0.157 to 0.236 in]
7000-12981-0000000	\$9.75		Right-angle female, A-coded					
7000-13041-0000000	\$12.00	5	Axial male, A-coded	6 to 8 mm [0.236 to 0.315 in]				
7000-17301-0000000	\$27.00	8			Right-angle male, A-coded			
7000-17311-0000000	\$27.00				Axial female, A-coded			
7000-17321-0000000	\$27.00				Right-angle female, A-coded			
7000-17331-0000000	\$27.00							
Shielded								
7000-14581-0000000	\$29.50	4	Right-angle male, D-coded	18AWG [0.75 mm ²] max	CuZn Nickel Plated	6 to 8 mm [0.236 to 0.315 in]		
7000-13321-0000000	\$25.00	5	Axial male, A-coded					
7000-13361-0000000	\$32.50		Right-angle male, A-coded					
7000-17341-0000000	\$32.50	8	Axial male, A-coded	20AWG [0.5 mm ²] max				

M12 Field Wireable Screw Connectors Specifications					
Type	4-Wire, 5-Pole	5-Wire, 5-Pole	4-Wire, 5-Pole	5-Wire, 5-Pole	8-Wire, 8-Pole
Outer Cable Ø	4 to 6 mm [0.157 to 0.236 in]		6 to 8 mm [0.236 to 0.315 in]		
Max Voltage	250 VAC/VDC	60 VAC/VDC	250 VAC/VDC	60 VAC/VDC	30 VAC/VDC
Max Current Per Contact	4A				2A
Protection Degree	IP67				
Temperature Range	-25 to 85°C [13 to 185°F]				
Wire Diameter	max 18AWG [0.75 mm ²]				max 20AWG [0.5mm ²]
Weight	0.05 oz [1.42 g]		0.06 oz [1.7 g]		
Approvals*	cURus				

*To obtain the most current agency approval information, see the Agency Compliance & Certifications Checklist section on the specific part number's web page.

Contact Diagrams

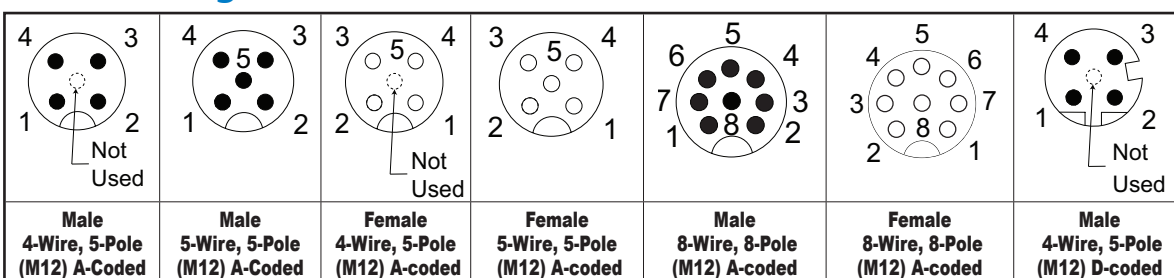

Field Wireable Connectors

M12 Screw Connectors Dimensions and Wiring

Wiring Diagrams

Screw Connection Technique

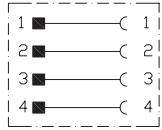
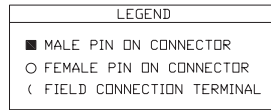

4-Wire, 5-Pole

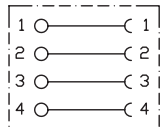
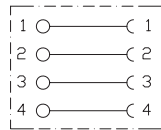

5-Wire, 5-Pole

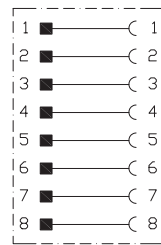
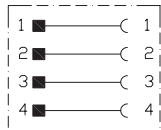

8-Wire, 8-Pole

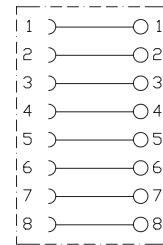

Dimensions

mm [inches]

7000-12701-0000000

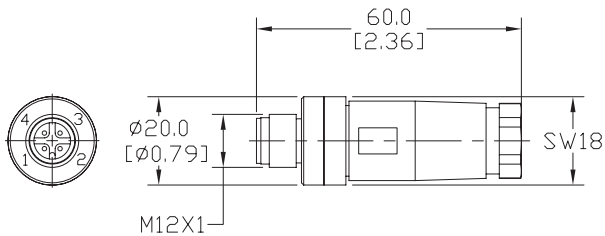

7000-12721-0000000

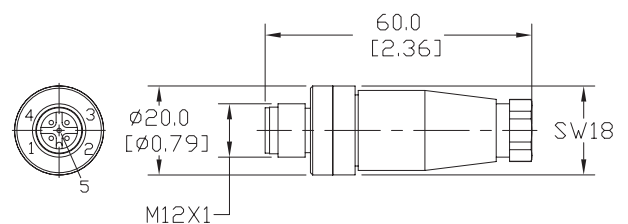

7000-12901-0000000

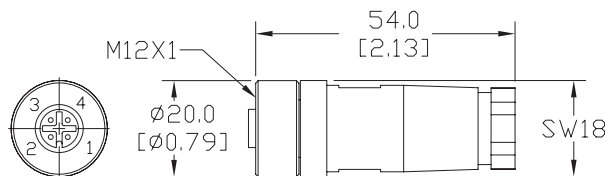

7000-12921-0000000

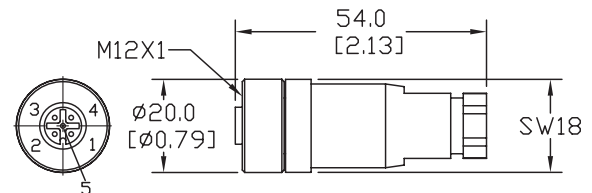

7000-12741-0000000

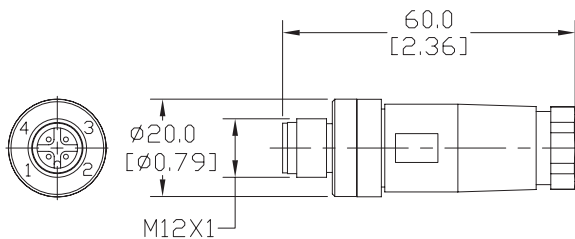

7000-12761-0000000

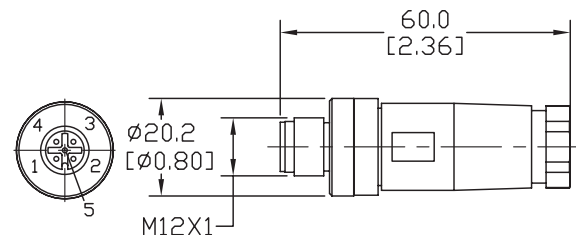

7000-12941-0000000

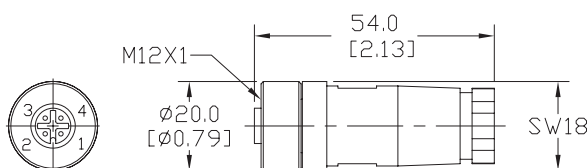

7000-12961-0000000

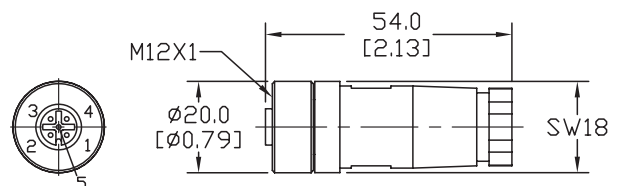

Field Wireable Connectors

M12 Screw Connectors Dimensions and Wiring

Dimensions

mm [inches]

7000-12821-0000000

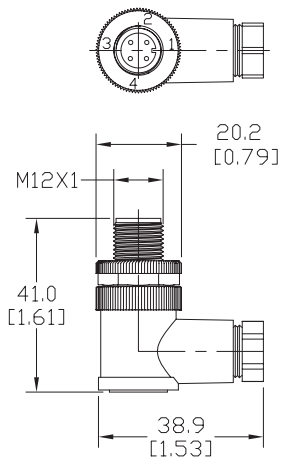

7000-12981-0000000

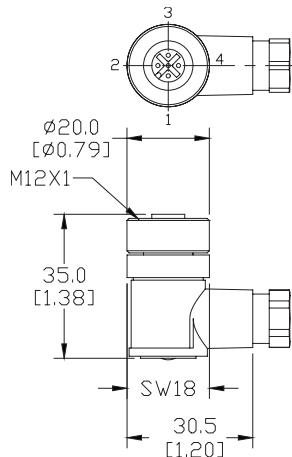

7000-13041-0000000

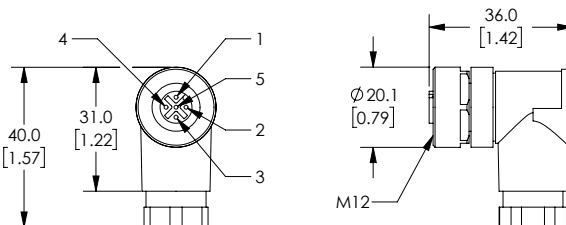

7000-13321-0000000

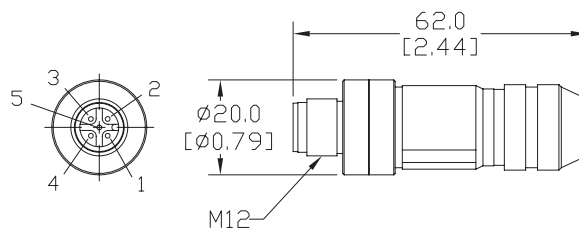

7000-13361-0000000

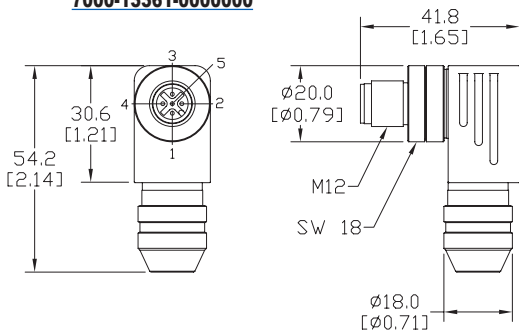

7000-17301-0000000

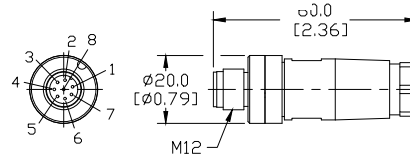

7000-17311-0000000

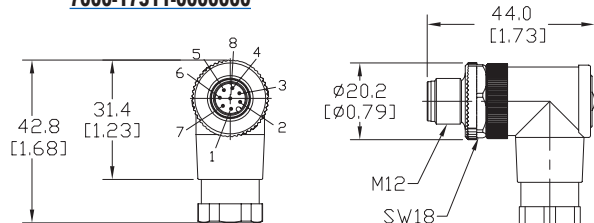

7000-17321-0000000

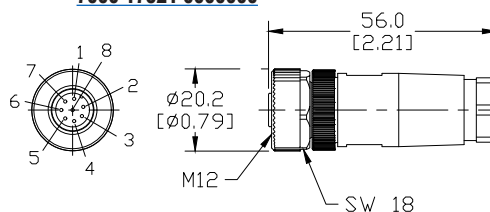

7000-17331-0000000

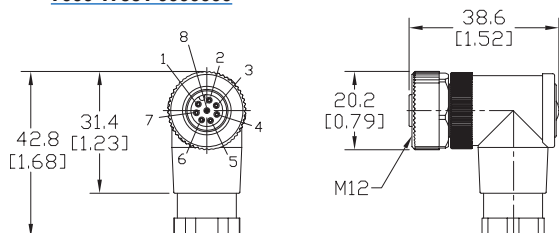

7000-17341-0000000

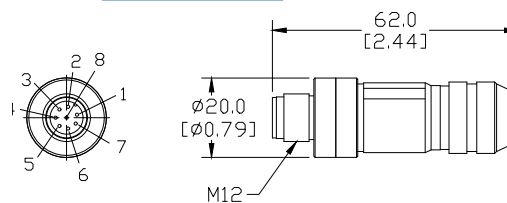

T-Couplers

T-Couplers

Features



- Molded T-Couplers allow for various wire splitting
- Standard M12 or M8 connections available
- Uses include splitting power to multiple devices or bringing multiple device signals into a wiring block
- Made of molded polyurethane

T-Couplers						
Part Number	Price	Trunk Connection	Number of Trunk Wires	Branch Connection	Number of Branch Wires	Drawing Link
7000-41121-0000000	\$18.50	1 M12 male	5	2 M12 female	4	PDF
7000-41141-0000000	\$18.50				5	PDF
7000-41181-0000000	\$18.50		4	2 M8 female	3	PDF
7000-41201-0000000	\$18.50		4	2 M8 female	3	PDF

T-Couplers Specifications				
Model	41121	41141	41181	41201
Type	Trunk 5-Wire, 5-Pole Branch 4-Wire, 5-Pole	Trunk 5-Wire, 5-Pole Branch 5-Wire, 5-Pole	Trunk 5-Wire, 5-Pole Branch 4-Wire, 5-Pole	Trunk 4-Wire, 4-Pole Branch 3-Wire, 3-Pole
Max Voltage	60 VAC/VDC			50 VAC / 60 VDC
Max Voltage - UL Rating	30 VAC/VDC			
Max Current Per Contact	4A			
Temperature Range	-25 to 85°C [13 to 185°F]			
Protection Degree	IP67			
Nut Material	Male threads are nickel plated brass; Female threads are nickel plated die cast zinc			
Housing Material	Polyurethane (PUR)			
Tightening Torque	≤ 0.6 N·m [≤ 0.44 ft·lb]			
Weight	0.06 oz [27.21 g]			0.05 oz [22.68 g]
Approvals*	cULus			

*To obtain the most current agency approval information, see the Agency Compliance & Certifications Checklist section on the specific part number's web page.

Wiring Diagrams

7000-41121-0000000

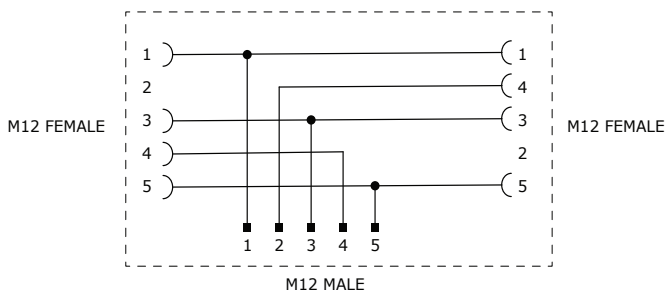

7000-41141-0000000

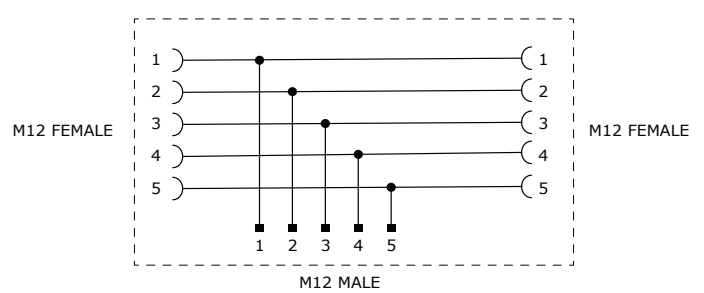

7000-41181-0000000

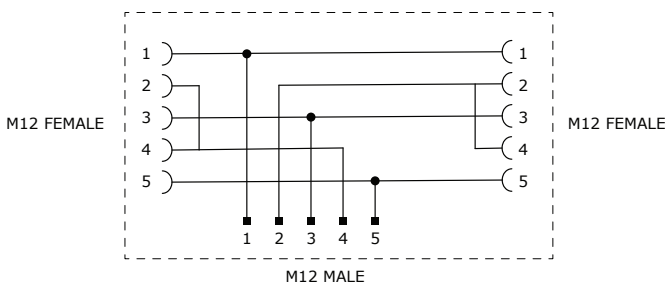

7000-41201-0000000

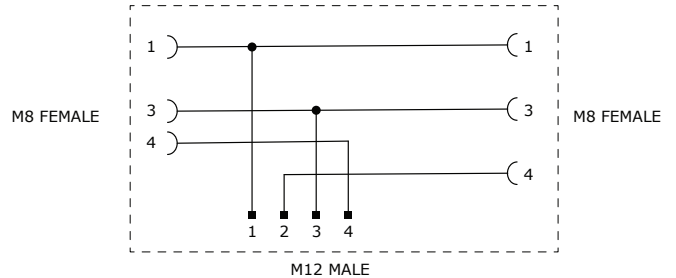



stay connected

M8 Bulkhead Connectors

M8 A-coded Bulkhead Connector to Pigtail

Features

- Male M8 to open leads connectors
- Metal housings

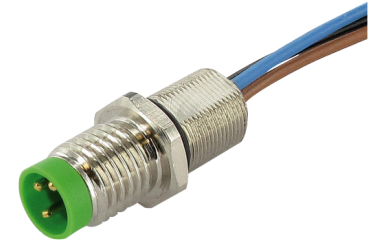

M8 A-coded Bulkhead Connectors to Pigtail					
Part Number	Price	Cable Length	Number of Wires	Connector	Drawing Link
7000-08553-9700050	\$11.00	0.5 m [1.64 ft]	3	Axial male	PDF
7000-08563-9690050	\$12.00		4		PDF
7000-08553-9700100	\$12.00	1m [3.28 ft]	3		PDF
7000-08563-9690100	\$12.50		4		PDF

Wiring Diagrams

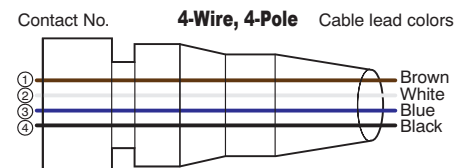
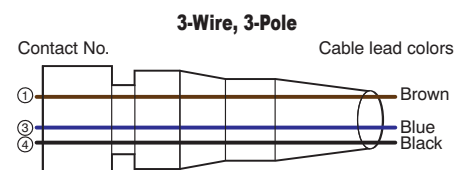

M8 A-coded Bulkhead Connectors to Pigtail Specifications		
Model	08553	08563
Type	3-Wire, 3-Pole	4-Wire, 4-Pole
Nominal Voltage	50VAC / 60VDC	
Max Current Per Contact	4A	
Protection Degree	IP67 in mated condition and tightened NEMA 3, 4, 6P (UL50E)	
Threaded Material	Nickel plated brass	
Cable Jacket material	Polyurethane (PUR)	
Contacts Material	Copper Alloy	
Conductors Cross Section	0.25 mm ² [24AWG]	
Mounting Hole Diameter	8.2 mm; max mounting material thickness: 4.5 mm	
Tightening Torque	≤ 0.4 N·m [≤ 0.34 ft·lb]	
Temperature Range	-40 to 90°C [-40 to 194°F]	
Approvals*	cURus	

*To obtain the most current agency approval information, see the Agency Compliance & Certifications Checklist section on the specific part number's web page.

Contact Diagrams

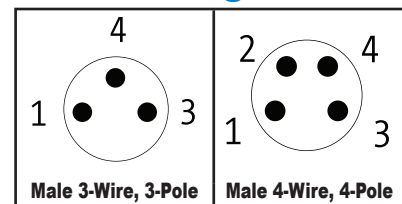



stay connected

M12 Bulkhead Connectors

M12 A-coded Bulkhead Connectors

Features

- Male or female M12 to pigtail open leads
- Male M12 to female M12 connectors
- Metal housings
- IP67 rated



7000-42111-0000000



7231-13501-9710050



7231-13541-9710050

M12 A-coded Bulkhead Connectors					
Part Number	Price	Cable Length m [ft]	Number of Wires	Connector	Drawing Link
7000-42111-0000000	\$20.50	N/A	5	Male to female	PDF
7000-48111-0000000	\$27.00		8		PDF
7231-13501-9710050	\$10.50	0.5 [1.64]	4	Male to leads	PDF
7231-13541-9710050	\$10.50			Female to leads	PDF
7231-13501-9710100	\$11.50	1 [3.28]		Male to leads	PDF
7231-13541-9710100	\$11.50			Female to leads	PDF
7231-13521-9720050	\$11.50	0.5 [1.64]	5	Male to leads	PDF
7231-13561-9720050	\$11.50			Female to leads	PDF
7231-13521-9720100	\$12.50	1 [3.28]		Male to leads	PDF
7231-13561-9720100	\$12.50			Female to leads	PDF
7231-17161-9730050	\$18.50	0.5 [1.64]	8	Male to leads	PDF
7231-17181-9730050	\$18.50			Female to leads	PDF
7231-17161-9730100	\$19.50	1 [3.28]		Male to leads	PDF
7231-17181-9730100	\$19.50			Female to leads	PDF
7000-17162-9730050	\$17.50	0.5 [1.64]	8	Male to leads	PDF
7000-17162-9820050	\$17.50				PDF
7000-19162-9790050	\$26.00	1 [3.28]	12		PDF
7000-17162-9730100	\$19.00		8		PDF
7000-17162-9820100	\$19.00		PDF		
7000-19162-9790100	\$27.00		12		PDF

M12 A-coded Bulkhead Connectors Specifications						
Model	42111, 48111		13501, 13541	13521, 13561	17161, 17181, 17162	19162
Type	5-Wire, 5-Pole	8-Wire, 8-Pole	4-Wire, 5-Pole	5-Wire, 5-Pole	8-Wire, 8-Pole	12-Wire, 12-Pole
Max Voltage	60 VAC/VDC	30 VAC/VDC	250 VAC/VDC	125 VAC/VDC	30 VAC/VDC	
Max Voltage - UL Rating	30 VAC/VDC		250 VAC/VDC	125 VAC/VDC	30 VAC/VDC	
Max Current Per Contact	4A	2A	4A		2A	1.5A
Protection Degree	IP65 / IP67 NEMA 3, 4, 6P (UL50E)		IP67 in mated condition and tightened, NEMA 3, 4, 6P (UL50E)			
Threaded Material	Male threads are nickel plated brass; Female threads are nickel plated die cast zinc					
Wire Insulation Material	N/A		PUR			PP
Contacts Material	Copper Alloy					
Conductors Cross Section	N/A		0.34 mm ² [22AWG]		0.25 mm ² [24AWG]	0.14mm ² [26AWG]
Mounting Hole Diameter	16.1 mm; maximum mounting material thickness: 4.5 mm					
Tightening Torque	≤ 0.6 N·m [≤ 0.44 ft·lb]					
Temperature Range	-25 to 85°C [-13 to 185°F]		-40 to 90°C [-40 to 194°F]		-25 to 85°C [-13 to 185°F]	
Approvals *	cULus			UR		

*To obtain the most current agency approval information, see the Agency Compliance & Certifications Checklist section on the specific part number's web page.

M12 Bulkhead Connectors

Contact Diagrams

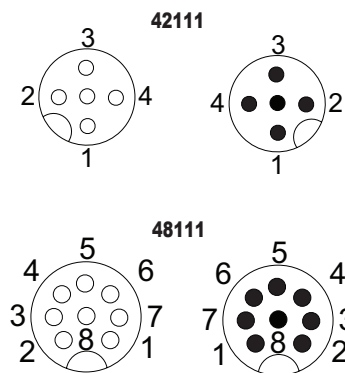

All other models

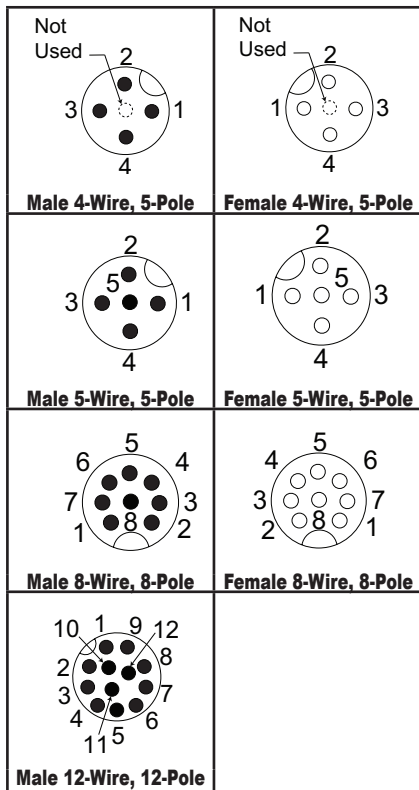

Wiring Diagrams

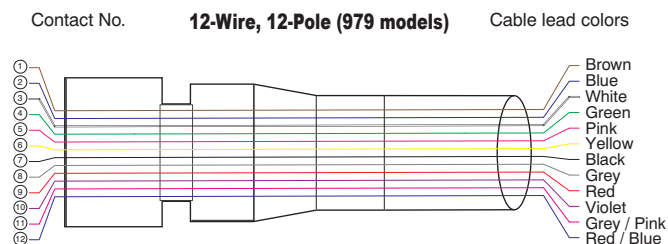
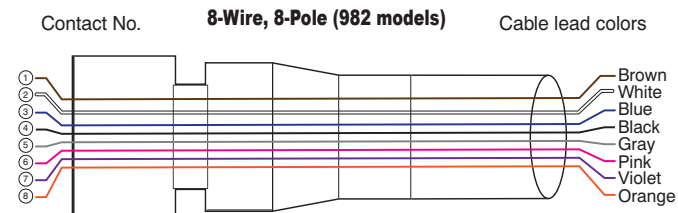
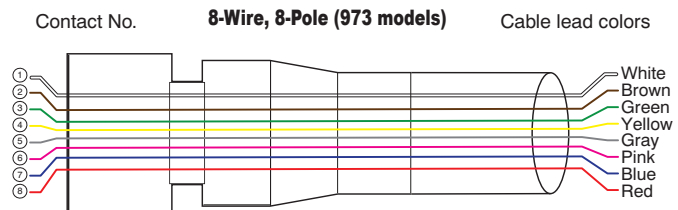
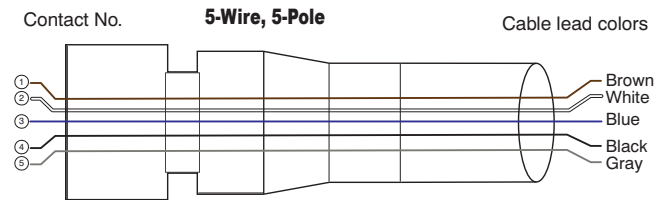
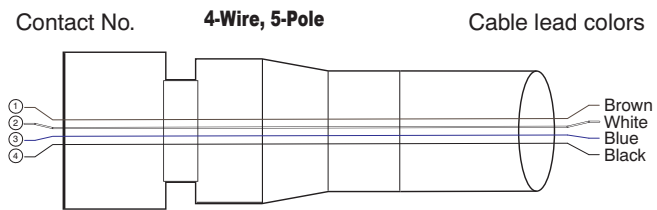



stay connected

Connection Cables - Data

Industrial Ethernet Shielded M12 D-coded Cables

Features

- High flex industrial Ethernet shielded Cat5e cables
- Resistant to welding sparks
- Flame retardant, chemical resistant
- TPE (thermoplastic elastomer) wire insulation for applications requiring high flexibility
- HDPE (High Density Polyethylene) wire insulation for excellent insulation properties and abrasion resistance



7700-44511 series



7700-44541 series



7700-44711 series



7700-44851 series

Ethernet Shielded M12 D-coded Cables											
Part Number	Price	Number of Wires	Connectors	Cable Jacket/ Wire Insulation Material	Jacket Color	Length m [ft]	Drawing Link				
7700-44511-S4U0060	\$27.50	4	Axial male to axial male	Thermoplastic Elastomer (TPE) / High Density Polyethylene (HDPE)	Teal	0.6 [1.9]	PDF				
7700-44511-S4U0100	\$28.50					1.0 [3.2]	PDF				
7700-44511-S4U0300	\$35.50					3.0 [9.8]	PDF				
7700-44511-S4U0500	\$36.50					5.0 [16.4]	PDF				
7700-44511-S4U0750	\$44.50					7.5 [24.6]	PDF				
7700-44511-S4U1000	\$53.00					10 [32.8]	PDF				
7700-44511-S4U1500	\$71.00		15 [49.2]			PDF					
7700-44541-S4U0060	\$27.50		Axial male to right-angle male			Thermoplastic Elastomer (TPE) / High Density Polyethylene (HDPE)	Teal	0.6 [1.9]	PDF		
7700-44541-S4U0100	\$28.50							1.0 [3.2]	PDF		
7700-44541-S4U0300	\$37.50							3.0 [9.8]	PDF		
7700-44541-S4U0500	\$39.00							5.0 [16.4]	PDF		
7700-44541-S4U0750	\$46.50							7.5 [24.6]	PDF		
7700-44541-S4U1000	\$56.00							10 [32.8]	PDF		
7700-44541-S4U1500	\$76.00		15 [49.2]					PDF			
7700-44711-S4U0060	\$26.50		Axial male to axial male RJ45					Thermoplastic Elastomer (TPE) / High Density Polyethylene (HDPE)	Teal	0.6 [1.9]	PDF
7700-44711-S4U0100	\$27.50									1.0 [3.2]	PDF
7700-44711-S4U0300	\$32.50									3.0 [9.8]	PDF
7700-44711-S4U0500	\$36.50									5.0 [16.4]	PDF
7700-44711-S4U0750	\$46.50									7.5 [24.6]	PDF
7700-44711-S4U1000	\$55.00									10 [32.8]	PDF
7700-44711-S4U1500	\$76.00	15 [49.2]	PDF								
7700-44761-S4U0060	\$26.50	Right-angle male to axial male RJ45	Thermoplastic Elastomer (TPE) / High Density Polyethylene (HDPE)	Teal	0.6 [1.9]					PDF	
7700-44761-S4U0100	\$28.00				1.0 [3.2]					PDF	
7700-44761-S4U0300	\$33.50				3.0 [9.8]					PDF	
7700-44761-S4U0500	\$38.00				5.0 [16.4]					PDF	
7700-44761-S4U0750	\$46.50				7.5 [24.6]					PDF	
7700-44761-S4U1000	\$53.00				10 [32.8]					PDF	
7700-44761-S4U1500	\$71.00	15 [49.2]			PDF						
7700-44851-S4U0050	\$26.50	Female bulkhead to axial male RJ45			Thermoplastic Elastomer (TPE) / High Density Polyethylene (HDPE)	Teal	0.5 [1.6]			PDF	
7700-44851-S4U0060	\$28.00						0.6 [1.9]			PDF	
7700-44851-S4U0100	\$28.00						1.0 [3.2]			PDF	



stay connected

Connection Cables - Data

Industrial Ethernet M12 D-coded Shielded Cables

Ethernet Shielded M12 D-coded Specifications					
Model	44511	44541	44711	44761	44851
Type	(M12) 4-Wire, 5-Pole; (RJ45) 4-Wire, 8-Pin				
Max Voltage	60VDC				
Max Voltage - UL Rating	60VDC		30VDC		
Max Current Per Contact	4A (UL Rated to 1.5 A)	4A	1.5 A		
Protection Degree	IP65 / IP66K / IP67		M12 IP67 RJ45 IP20		M12 IP67, Nema 3, 4, 6P (UL50E), RJ45 IP20
Nut Material	Nickel plated die cast zinc				
Cable Jacket/Wire Insulation Material	Thermoplastic Elastomer (TPE) / High Density Polyethylene (HDPE)				
Contacts Material	Copper Alloy				
Tightening Torque	≤ 0.6 N·m [≤ 0.44 ft·lb]				
Conductors Cross Section	24/7 AWG				
Ø Outer Cable	6.6 mm [0.26 in]				
Min Bend Radius	Stationary use: 5 x cable diameter; Flexible use: 10 x cable diameter				
Cable Temperature Range	-40 to 80°C [-40 to 176°F]				
Channel Transmission Length	max 70m				
Data Transmission Standard	CAT5e ISO/IEC 11801 (Class D - 100 MBit/s)				
Approvals*	cULus				

*To obtain the most current agency approval information, see the Agency Compliance & Certifications Checklist section on the specific part number's web page.

Connection Cables - Data

Industrial Ethernet Shielded RJ45 Cables

Features

- High flex industrial Ethernet shielded Cat5e cables
- Resistant to welding sparks
- Flame retardant, chemical resistant
- TPE (thermoplastic elastomer) jacket for typical industrial applications
- HDPE (High Density Polyethylene) wire insulation for excellent insulation properties and abrasion resistance.

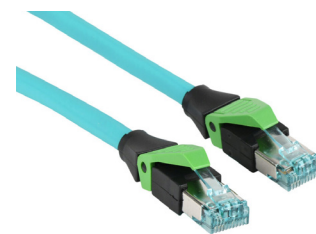

7700-74301 series

Industrial Ethernet Shielded RJ45 Cables							
Part Number	Price	Number of Wires	Connectors	Cable Jacket/ Wire Insulation Material	Jacket Color	Length	Drawing Link
						m [ft]	
7700-74301-S4U0060	\$19.00	4	RJ45 axial male to RJ45 axial male	Thermoplastic Elastomer (TPE) / High Density Polyethylene (HDPE)	Teal	0.6 [1.9]	PDF
7700-74301-S4U0100	\$20.00					1.0 [3.2]	PDF
7700-74301-S4U0300	\$25.00					3.0 [9.8]	PDF
7700-74301-S4U0500	\$32.00					5.0 [16.4]	PDF
7700-74301-S4U0750	\$40.50					7.5 [24.6]	PDF
7700-74301-S4U1000	\$49.50					10 [32.8]	PDF
7700-74301-S4U1500	\$70.00					15 [49.2]	PDF

Industrial Ethernet Shielded RJ45 Cables Specifications	
Model	74301
Type	4-Wire ,8-Pin
Max Voltage	60VDC
Max Voltage UL Rating	30VDC
Max Current Per Contact	1.5 A
Protection Degree	IP20
Cable Jacket/Wire Insulation Material	Thermoplastic Elastomer (TPE) / High Density Polyethylene (HDPE)
Contacts Material	Copper Alloy
Conductor Cross Section	24/7 AWG
Ø Outer Cable	6.6 mm [0.260 in]
Min Bend Radius	Stationary use: 5 x cable diameter; Flexible use: 10 x cable diameter
Cable Temperature Range	-40 to 80°C [-40 to 176°F]
Channel Transmission Length	max 70m
Data Transmission Standard	Cat5e (ISO/IEC 11801 (Class D - 100 MBit/s))
Approvals**	cULus

*To obtain the most current agency approval information, see the Agency Compliance & Certifications Checklist section on the specific part number's web page.



stay connected

Connection Cables - Data

Industrial Ethernet Shielded M12 D-coded to Pigtail Cables



7700-14541-series

Features

- High flex industrial Ethernet shielded Cat5e cables
- Resistant to welding sparks
- Flame retardant, chemical resistant
- TPE (thermoplastic elastomer) jacket for typical industrial applications
- HDPE (High Density Polyethylene) wire insulation for excellent insulation properties and abrasion resistance

Ethernet Shielded M12 D-coded to Pigtail Cables							
Part Number	Price	Number of Wires	Connector	Cable Jacket/ Wire Insulation Material	Jacket Color	Length	Drawing Link
						m [ft]	
7700-14541-S4U0060	\$18.00	4	Axial male to pigtail	Thermoplastic Elastomer (TPE) / High Density Polyethylene (HDPE)	Teal	0.6 [1.9]	PDF
7700-14541-S4U0100	\$19.00					1.0 [3.2]	PDF
7700-14541-S4U0300	\$25.50					3.0 [9.8]	PDF
7700-14541-S4U0500	\$31.00					5.0 [16.4]	PDF
7700-14541-S4U0750	\$39.00					7.5 [24.6]	PDF
7700-14541-S4U1000	\$46.50					10 [32.8]	PDF
7700-14541-S4U1500	\$65.00					15 [49.2]	PDF

Ethernet Shielded M12 D-coded to Pigtail Cable Specifications	
Model	14541
Type	4-Wire, 5-Pole
Max Voltage	60VDC
Max Voltage - UL Rating	30VDC
Max Current Per Contact	1.5 A
Protection Degree	IP65 / IP66K / IP67
Cable Jacket/Wire Insulation Material	Thermoplastic Elastomer (TPE) / High Density Polyethylene (HDPE)
Contacts Material	Copper Alloy
Conductors Cross Section	0.25 mm ² [24AWG]
Tightening Torque	≤ 0.6 N·m [≤ 0.44 ft-lb]
Ø Outer Cable	~ 6.6 mm [0.260 in]
Min Bend Radius	Stationary use: 5 x cable diameter; Flexible use: 10 x cable diameter
Cable Temperature Range	-40 to 80°C [-40 to 176°F]
Channel Transmission Length	max 70m
Data Transmission Standard	Cat5e, (ISO/IEC 11801), (Class D - 100 MBit/s)
Approvals*	cULus

*To obtain the most current agency approval information, see the Agency Compliance & Certifications Checklist section on the specific part number's web page.



stay connected

Field Wireable Connectors - Data

Shielded RJ45 IDC Field Wireable Connectors and Adapters

Features

- Insulation displacement connector (IDC)
- Cat5e (Ethernet) or Cat6a (Gigabit)
- Cable outlet in 5 directions: straight, right, left, top, or bottom
- 45° outlet makes stacking several connection



7000-74001-000000



7000-74031-000000



7000-74075-000000



7000-74085-000000



7000-44671-000000



7000-44681-000000

Shielded RJ45 IDC Field Wireable Connectors and Adapters

Part Number	Price	Wire Size	Number of Wires	Connector Type	Connection	Housing Material	Drawing Link
7000-74001-000000	\$20.00	26 to 22 AWG	4	RJ45 axial male	Profinet/Ethernet	PVC/PE	PDF
7000-74011-000000	\$23.00		8		Gigabit		PDF
7000-74021-000000	\$22.00		4	RJ45 male 45°	Profinet/Ethernet		PDF
7000-74031-000000	\$25.00		8		Gigabit		PDF
7000-74075-000000	\$24.50	26 to 24 AWG	8	RJ45 axial male	Gigabit	Zinc die casting	PDF
7000-74085-000000	\$26.50			RJ45 right-angle male			PDF
7000-44671-000000	\$29.50	N/A	4	M12 D-coded axial female to RJ45 axial male	Cat5	PUR	PDF
7000-44681-000000	\$30.00			M12 D-coded axial female to RJ45 right-angle female			PDF

Shielded RJ45 IDC Field Wireable Connectors and Adapters Specifications

Model	44671, 44681	74001, 74021	74011, 74031	74075, 74085
Type	M12: 4-Wire, 4-Pole RJ45: 4-Wire, 4-Pin	RJ45: 4-Wire, 4-Pin	RJ45: 8-Wire, 8-Pin	RJ45: 8-Wire, 8-Pin
Max Voltage	60VDC			50V
Max Current per Contact	1.76 A			1.75 A
Transmission Type	Cat5		Cat6	Cat5e
Temperature Range	-25 to 85°C [-13 to 185°F]		-40 to 70°C [-40 to 158°F]	
Protection Degree	IP68 (M12); IP20 (RJ45)		IP20	
Outside Cable Ø	N/A	5 to 9mm (74001, 74011), 5 to 8mm (74021, 74031)		5 to 9 mm
Wire Ø	N/A	max 1.6 mm		
Conductor Cross Section	N/A	0.14 to 0.34 mm² [26 to 22 AWG]		0.14 to 0.25 mm² [26 to 24 AWG]
Housing Material	PUR	PVC/PE		Zinc die casting
Approvals*	cULus	cURus		cULus

*To obtain the most current agency approval information, see the Agency Compliance & Certifications Checklist section on the specific part number's web page.

Pin Assignments

74001,74021

Industrial



74075,74085

Ethernet, AWG 24 - 26



74011,74031

568-B



568-A



Industrial





stay connected

Connection Cables - Power

M12 L-coded Cables

Features

- Resistant to welding sparks
- Flame retardant, chemical resistant
- 600V cable insulation rating
- TPE (thermoplastic elastomer) jacket for typical industrial applications
- PVC (polyvinyl chloride) jacketed cable for general use and chemical washdown applications, ex. food & beverage industry

M12 L-coded Cables									
Part Number	Price	Number of Wires	Connector	Wire Size	Amperage Rating	Cable Jacket/ Wire Insulation Material	Jacket Color	Length m [ft]	Drawing Link
7700-P4241-U0P0200	\$67.00	5	Axial male to axial female	14AWG	16A	Thermoplastic Elastomer (TPE) / Polyvinyl Chloride (PVC)	Yellow	2.0 [6.5]	PDF
7700-P4241-U0P0300	\$79.00							3.0 [9.8]	PDF
7700-P4241-U0P0500	\$102.00							5.0 [16.4]	PDF
7700-P4241-U0P0750	\$131.00							7.5 [24.6]	PDF
7700-P4241-U0P1000	\$160.00							10 [32.8]	PDF
7700-P4241-U0P1500	\$218.00							15 [49.2]	PDF
7700-P4241-U0D0200	\$61.00			16AWG	12A			2.0 [6.5]	PDF
7700-P4241-U0D0300	\$70.00							3.0 [9.8]	PDF
7700-P4241-U0D0500	\$87.00							5.0 [16.4]	PDF
7700-P4241-U0D0750	\$107.00							7.5 [24.6]	PDF
7700-P4241-U0D1000	\$128.00							10 [32.8]	PDF
7700-P4241-U0D1500	\$169.00							15 [49.2]	PDF
7700-P4201-U0P0200	\$42.50		Axial male to pigtail	14AWG	16A			2.0 [6.5]	PDF
7700-P4201-U0P0300	\$54.00							3.0 [9.8]	PDF
7700-P4201-U0P0500	\$76.00							5.0 [16.4]	PDF
7700-P4201-U0P0750	\$103.00							7.5 [24.6]	PDF
7700-P4201-U0P1000	\$130.00							10 [32.8]	PDF
7700-P4201-U0P1500	\$184.00							15 [49.2]	PDF
7700-P4201-U0D0200	\$36.50			16AWG	12A			2.0 [6.5]	PDF
7700-P4201-U0D0300	\$43.50							3.0 [9.8]	PDF
7700-P4201-U0D0500	\$59.00							5.0 [16.4]	PDF
7700-P4201-U0D0750	\$78.00							7.5 [24.6]	PDF
7700-P4201-U0D1000	\$97.00							10 [32.8]	PDF
7700-P4201-U0D1500	\$133.00							15 [49.2]	PDF
7700-P4221-U0P0200	\$42.50	Axial female to pigtail	14AWG	16A	2.0 [6.5]	PDF			
7700-P4221-U0P0300	\$52.00				3.0 [9.8]	PDF			
7700-P4221-U0P0500	\$72.00				5.0 [16.4]	PDF			
7700-P4221-U0P0750	\$98.00				7.5 [24.6]	PDF			
7700-P4221-U0P1000	\$122.00				10 [32.8]	PDF			
7700-P4221-U0P1500	\$174.00				15 [49.2]	PDF			
7700-P4221-U0D0200	\$38.00		16AWG	12A	2.0 [6.5]	PDF			
7700-P4221-U0D0300	\$45.50				3.0 [9.8]	PDF			
7700-P4221-U0D0500	\$60.00				5.0 [16.4]	PDF			
7700-P4221-U0D0750	\$78.00				7.5 [24.6]	PDF			
7700-P4221-U0D1000	\$97.00				10 [32.8]	PDF			
7700-P4221-U0D1500	\$133.00				15 [49.2]	PDF			



7700-P4241 series

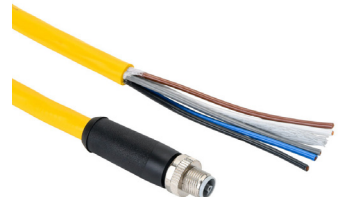

7700-P4201 series



7700-P4221 series



stay connected

Connection Cables - Power

M12 L-coded Cables Specifications

M12 L-coded Cables Specifications		
Model	7000-xxxxx-U0Pxxxx	7000-xxxxx-U0Dxxxx
Type	5-Wire, 5-Pole	
Max Voltage	63VDC	
Max Current Per Contact	16A	12A
Protection Degree	IP65 / IP67	
Nut Material	Male threads are nickel plated brass; Female threads are nickel plated die cast zinc	
Cable Jacket/Wire Insulation Material	TPE/PVC	
Contacts Material	Copper Alloy	
Tightening Torque	≤ 0.6 N·m [≤ 0.44 ft·lb]	
Conductors Cross Section	2.11 mm ² [14AWG]	1.31 mm ² [16AWG]
Ø Outer Cable	10.5 mm [0.415 in]	9.8 mm [0.385 in]
Temperature Range - Stationary Use	-50 to 105°C [-58 to 221°F]	
Temperature Range - Flexible Use	-20 to 90°C [-4 to 194°F]	
Min Bend Radius	Stationary use: 5 x cable diameter; Flexible use: 10 x cable diameter	
Approvals*	cULus, CE	

*To obtain the most current agency approval information, see the Agency Compliance & Certifications Checklist section on the specific part number's web page.

Connection Cables - Power

M12 L-coded Adapter Cable and T-Coupler

- Use to convert a 7/8-16 connection to M12 L-coded connection



M12 L-coded to 7/8" Adapter Cable							
Part Number	Price	Number of Wires	Connectors	Jacket		Length m [ft]	Drawing Link
				Material	Color		
7000-P4541-P040200	\$73.00	5	M12 axial female to 7/8" axial male	PUR/PP	Black	2 [6.5]	PDF

[7000-P4541-P040200](#)

Adapter Cable M12 L-coded to 7/8" Specifications	
Type	5-Wire, 5-Pole
Max Voltage	63 VAC/VDC
Max Current	12A
Connection	Connector 1: M12 L-coded axial female Connector 2: 7/8" axial male
Tightening Torque	M12: 0.6 N·m [0.44 ft·lb]; 7/8": 1.5 N·m [1.1 ft·lb]
Conductors Cross Section	1.5mm ² [16AWG]
Locking Material	Male threads are nickel plated brass; Female threads are nickel plated die cast zinc
Protection Degree	IP67
Ø Outer Cable	8.2 mm [0.32 in]
Min Bend Radius	Stationary use: 5 x cable diameter; Flexible use: 10 x cable diameter
Temperature Range - Stationary Use	-50 to 80°C [-58 to 176°F]
Temperature Range - Flexible Use	-25 to 80°C [-13 to 176°F]
Contact Material	Copper Alloy
Agency Approvals *	NA

*To obtain the most current agency approval information, see the Agency Compliance & Certifications Checklist section on the specific part number's web page.

M12 L-coded T-Coupler

M12 L-coded T-Coupler					
Part Number	Price	Number of Poles	Connectors	Wiring	Drawing Link
7000-P4901-0000000	\$111.00	5	Axial male to (2) axial female	1-1-1 2-2-2 3-3-3 4-4-4 FE-FE-FE	PDF



[7000-P4901-0000000](#)

M12 L-coded T-Coupler Specifications	
Type	5-Wire, 5-Pole
Max Voltage	63VDC
Max Current	16A
Connection	M12 L-coded
Tightening Torque	≤ 0.6 N·m [≤ 0.44 ft·lb]
Locking Material	Male threads are nickel plated brass; Female threads are nickel plated die cast zinc
Protection Degree	IP65 / IP67 / IP68
Temperature Range	-30 to 90°C [-22 to 194°F]
Material	Housing (TPU), Contact Carrier (PA), Contact (Brass, gold plated)
Approvals*	cULus, CE

*To obtain the most current agency approval information, see the Agency Compliance & Certifications Checklist section on the specific part number's web page.



stay connected

Field Wireable Connectors - Power

M12 L-coded Field Wireable Connectors



7000-P4591-0000000



7000-P4611-0000000

M12 L-coded Field Wireable Connectors					
Part Number	Price	Number of Wires	Connectors	Accepts Cable Diameter Size	Drawing Link
7000-P4591-0000000	\$29.00	5	Axial male	8-13 mm [0.31 - 0.51 in]	PDF
7000-P4611-0000000	\$29.00		Axial female		PDF

M12 L-coded Field Wireable Connector Specifications	
Type	5-Wire, 5-Pole
Max Voltage	63V
Max Current	16A
Connection	M12 L-coded
Tightening Torque	≤ 0.6 N·m [≤ 0.44 ft-lb]
Conductors Cross Section	2.5 mm ² [14AWG]
Locking Material	Male threads are nickel plated brass; Female threads are nickel plated die cast zinc
Protection Degree	IP67
Temperature Range	-40 to 85°C [-40 to 185°F]
Wire Connection	Screw terminal; M2.5x0.45 mm ² , torque to 40 N·m [29.5 ft-lb]
Wire Connection Cross Section	1.5 mm ² [16AWG] (with ferrule end); 2.5 mm ² [14AWG] (without ferrule end)
Approvals*	cURus

*To obtain the most current agency approval information, see the Agency Compliance & Certifications Checklist section on the specific part number's web page.

ZIPport Mini Cordsets

Features and General Specifications

- Oil-resistant yellow PVC body and cable jacket.
- Copper alloy contacts with gold plating
- Nickel-plated brass nut coupling
- Non-wicking, non-hygroscopic, UL style STOW
- Bare copper conductors, PVC insulated
- Temperature: -40 to 105°C (-40 to 221°F)
- IP67 protection rating when connected
- Approvals: UL File E328610, CE
- Made in the USA



STOW cords are ideal for usage in flex applications in harsh environments where high degree of oil resistance and extended service life are in great demand. Typical applications are portable tools, motors, sound equipment, portable lights and similar equipment.

S = Service or Hard Service Cord
 T = Thermoplastic (PVC)
 O = Oil Resistant Jacket
 W = Weather and Water Resistance

Mini Size 1 Straight Cordsets								
Face View of Male	Face View of Female	# of Poles	Wire Rating	Length m [ft]	Female Plugs	Price	Male Plugs	Price
		2 (North American Color Code)	16AWG	2 [6.56]	ZP-S1-2FP-2M	\$26.50	ZP-S1-2MP-2M	\$28.50
			600V	4 [13.12]	ZP-S1-2FP-4M	\$36.00	ZP-S1-2MP-4M	\$34.50
			13A	6 [19.69]	ZP-S1-2FP-6M	\$51.00	ZP-S1-2MP-6M	\$49.00
				10 [32.81]	ZP-S1-2FP-10M	\$62.00	ZP-S1-2MP-10M	\$60.00
		3 (North American Color Code)	16AWG	2 [6.56]	ZP-S1-3FP-2M	\$27.50	ZP-S1-3MP-2M	\$31.00
			600V	4 [13.12]	ZP-S1-3FP-4M	\$38.00	ZP-S1-3MP-4M	\$40.50
			13A	6 [19.69]	ZP-S1-3FP-6M	\$48.50	ZP-S1-3MP-6M	\$55.00
				10 [32.81]	ZP-S1-3FP-10M	\$75.00	ZP-S1-3MP-10M	\$77.00
		4 (North American Color Code)	16AWG	2 [6.56]	ZP-S1-4FP-2M	\$34.00	ZP-S1-4MP-2M	\$33.50
			600V	4 [13.12]	ZP-S1-4FP-4M	\$43.50	ZP-S1-4MP-4M	\$44.50
			10A	6 [19.69]	ZP-S1-4FP-6M	\$57.00	ZP-S1-4MP-6M	\$61.00
				10 [32.81]	ZP-S1-4FP-10M	\$77.00	ZP-S1-4MP-10M	\$81.00
		4 (Cenelec Color Code)	18AWG	2 [6.56]	ZP-S1C-4FPX-2M	\$27.50	ZP-S1C-4MPX-2M	\$30.50
			300V	4 [13.12]	ZP-S1C-4FPX-4M	\$35.50	ZP-S1C-4MPX-4M	\$39.00
			5.5 A	6 [19.69]	ZP-S1C-4FPX-6M	\$40.50	ZP-S1C-4MPX-6M	\$48.00
				10 [32.81]	ZP-S1C-4FPX-10M	\$56.00	ZP-S1C-4MPX-10M	\$64.00
		5 (North American Color Code)	16AWG	2 [6.56]	ZP-S1-5FP-2M	\$48.50	ZP-S1-5MP-2M	\$41.50
			600V	4 [13.12]	ZP-S1-5FP-4M	\$63.00	ZP-S1-5MP-4M	\$61.00
			8A	6 [19.69]	ZP-S1-5FP-6M	\$80.00	ZP-S1-5MP-6M	\$81.00
				10 [32.81]	ZP-S1-5FP-10M	\$112.00	ZP-S1-5MP-10M	\$113.00
		6 (North American Color Code)	16AWG	2 [6.56]	ZP-S1-6FP-2M	\$48.00	ZP-S1-6MP-2M	\$46.50
			600V	4 [13.12]	ZP-S1-6FP-4M	\$66.00	ZP-S1-6MP-4M	\$69.00
			8A	6 [19.69]	ZP-S1-6FP-6M	\$87.00	ZP-S1-6MP-6M	\$83.00
				10 [32.81]	ZP-S1-6FP-10M	\$115.00	ZP-S1-6MP-10M	\$114.00

Color Codes			
Poles		Color	
North American	2	1	White
		2	Black
	3	1	Green/Yellow
		2	Black
	4	3	White
		1	Black
		2	White
		3	Red
	5	4	Green/Yellow
		1	White
		2	Red
		3	Green/Yellow
4		Orange	
6	5	Black	
	1	White	
	2	Red	
	3	Green/Yellow	
	4	Orange	
	5	Black	
Cenelec	4	1	Brown
		2	White
		3	Blue
		4	Black

Note: Tightening torque 44 lb-in (5.0 N-m) coupling nut.

Dimensions

mm [in]

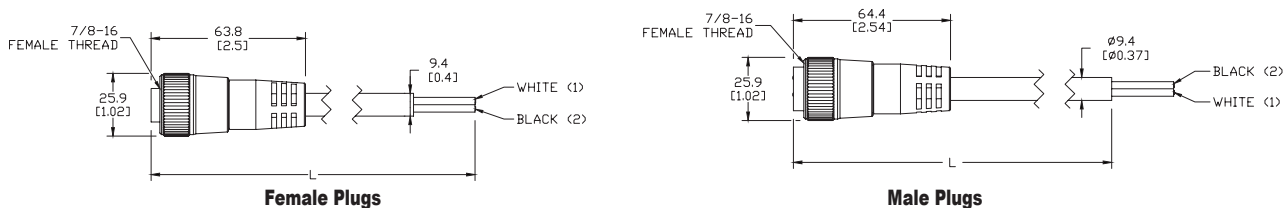

See our website: www.AutomationDirect.com for complete engineering drawings.

ZIPport Mini Patch Cables

Features and General Specifications

- Oil-resistant yellow PVC body and cable jacket
- Copper alloy contacts with gold plating
- Nickel-plated brass nut coupling
- Non-wicking, non-hygroscopic, UL style STOW
- Bare copper conductors, PVC insulated
- Temperature: -40 to 105°C (-40 to 221°F)
- IP67 protection rating when connected
- Approvals: UL File E328610, CE
- Made in the USA



Mini Size 1 Male to Female Patch Cables							
Face View of Male	Face View of Female	# of Poles	Wire Rating	Length m [ft]	Type	Part Number	Price
		3	16AWG 600V 13A	2 [6.56]	Male (Female Threads) to Female (Female Threads)	ZP-S1-3MFP-2M	\$46.00
				4 [13.12]		ZP-S1-3MFP-4M	\$53.00
				6 [19.69]		ZP-S1-3MFP-6M	\$70.00
				10 [32.81]		ZP-S1-3MFP-10M	\$83.00
		4	16AWG 600V 10A	2 [6.56]	Male (Female Threads) to Female (Female Threads)	ZP-S1-4MFP-2M	\$46.50
				4 [13.12]		ZP-S1-4MFP-4M	\$62.00
				6 [19.69]		ZP-S1-4MFP-6M	\$71.00
				10 [32.81]		ZP-S1-4MFP-10M	\$91.00
		4	18AWG 300V 5.5 A	2 [6.56]	Male (Male Threads) to Female (Female Threads)	ZP-S1C-4MFPX-2M	\$43.50
				4 [13.12]		ZP-S1C-4MFPX-4M	\$52.00
				6 [19.69]		ZP-S1C-4MFPX-6M	\$58.00
				10 [32.81]		ZP-S1C-4MFPX-10M	\$69.00
		5	16AWG 600V 8A	2 [6.56]	Male (Female Threads) to Female (Female Threads)	ZP-S1-5MFP-2M	\$69.00
				4 [13.12]		ZP-S1-5MFP-4M	\$84.00
				6 [19.69]		ZP-S1-5MFP-6M	\$113.00
				10 [32.81]		ZP-S1-5MFP-10M	\$146.00
		6	16AWG 600V 8A	2 [6.56]	Male (Female Threads) to Female (Female Threads)	ZP-S1-6MFP-2M	\$68.00
				4 [13.12]		ZP-S1-6MFP-4M	\$79.00
				6 [19.69]		ZP-S1-6MFP-6M	\$95.00
				10 [32.81]		ZP-S1-6MFP-10M	\$131.00

STOW cords are ideal for usage in flex applications in harsh environments where high degree of oil resistance and extended service life are in great demand. Typical applications are portable tools, motors, sound equipment, portable lights and similar equipment.

S = Service or Hard Service Cord
 T = Thermoplastic (PVC)
 O = Oil Resistant Jacket
 W = Weather and Water Resistance

Dimensions

mm [in]

Note: Tightening torque 44 lb-in (5.0 N-m) coupling nut.

Male - Female Extension Cable

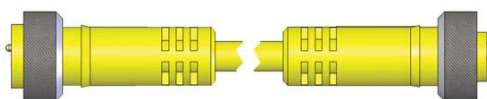

Male (Male Threads) to Female (Female Threads)

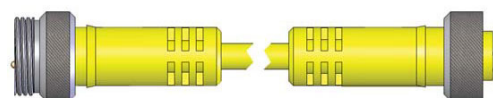

Male (Female Threads) to Female (Female Threads)

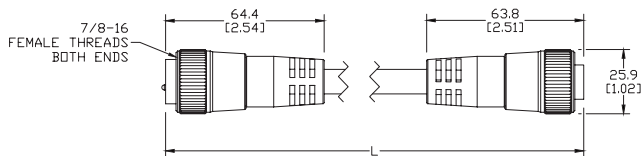

Male (Male Threads) to Female (Female Threads)

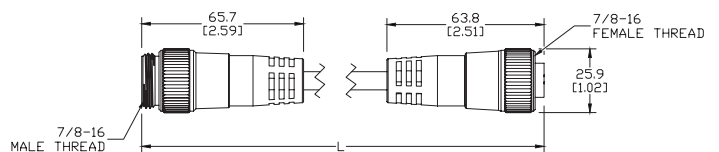

See our website: www.AutomationDirect.com for complete engineering drawings.



Field Wireable Connectors

Features and General Specifications

- Polyamide body
- Copper alloy/gold plating contacts
- BUNA-N O-Ring
- Nickel-plated brass coupling nut
- PVC insert
- Temperature: -40 to 90°C (-40 to 194°F)
- IP67 protection when connected
- Approvals: UL File E328610, CE
- Made in the USA



Field Wireable Connectors - Size 1										
Face View of Male	Face View of Female	# of Poles	Wire Rating	Cable O.D. Range - mm [in]	Female Straight (Female Threads)	Price	Male Straight (Female Threads)	Price	Male Straight (Male Threads)	Price
		3 (North American Color Code)	14-22 AWG 600V 18A Max	5-13 [0.20-0.51]	ZP-S1-3FP-FW	\$17.50	ZP-S1-3MP-FW	\$16.00	ZP-S1-3MPM-FW	\$16.00
				8-17 [0.31-0.67]	ZP-S1-3FP-FWX	\$17.50	ZP-S1-3MP-FWX	\$15.50	ZP-S1-3MPM-FWX	\$17.00
		4 (North American Color Code)	14-22 AWG 600V 15A Max	5-13 [0.20 - 0.51]	ZP-S1-4FP-FW	\$20.00	ZP-S1-4MP-FW	\$16.50	ZP-S1-4MPM-FW	\$17.50
				8-17 [0.31-0.67]	ZP-S1-4FP-FWX	\$20.00	ZP-S1-4MP-FWX	\$17.00	ZP-S1-4MPM-FWX	\$17.50
		4 (Cenelec Color Code)	14-22 AWG 600V 15A Max	5-13 [0.20-0.51]	ZP-S1C-4FP-FW	\$20.50	-	-	ZP-S1C-4MP-FW	\$18.50
				8-17 [0.31-0.67]	ZP-S1C-4FP-FWX	\$20.50	-	-	ZP-S1C-4MP-FWX	\$19.00
		5 (North American Color Code)	14-22 AWG 600V 12A Max	5-13 [0.20-0.51]	ZP-S1-5FP-FW	\$22.00	ZP-S1-5MP-FW	\$17.00	ZP-S1-5MPM-FW	\$19.00
				8-17 [0.31-0.67]	ZP-S1-5FP-FWX	\$22.50	ZP-S1-5MP-FWX	\$19.00	ZP-S1-5MPM-FWX	\$19.00
		6 (North American Color Code)	16-22 AWG 600V 8A Max	5-13 [0.20-0.51]	ZP-S1-6FP-FW	\$24.50	ZP-S1-6MP-FW	\$20.50	ZP-S1-6MPM-FW	\$23.50
				8-17 [0.31-0.67]	ZP-S1-6FP-FWX	\$24.50	ZP-S1-6MP-FWX	\$21.00	ZP-S1-6MPM-FWX	\$23.50

Note: Connection via screw terminal. Voltage and amperage ratings are cable dependent and are based on 600V 14AWG cable. Cables with lower voltage ratings and smaller conductors will lower these ratings.

Dimensions

mm [in]

Note: Tightening torque 44 lb-in (5.0 N·m) coupling nut.
Screw connections 20 lb-in (2.3 N·m)

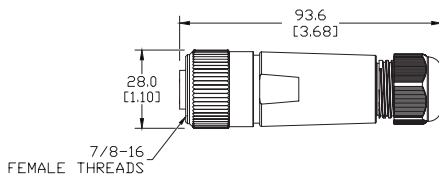

Female Straight (Female Threads)

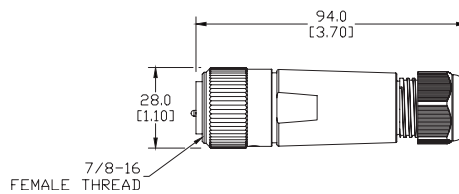

Male Straight (Female Threads)

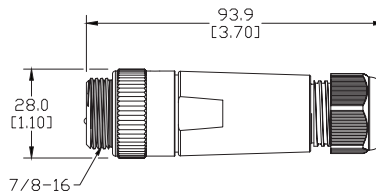

Male Straight (Male Threads)

Color Codes	
Poles	Color
2	1 White
	2 Black
3	1 Green/Yellow
	2 Black
4	1 White
	2 White
5	1 Black
	2 Red
6	1 White
	2 Red
North American	3 Green/Yellow
	4 Orange
Cenelec	1 White
	2 Red
4	3 Blue
	4 Black

Color Codes	
Poles	Color
Cenelec	1 Brown
	2 White
4	3 Blue
	4 Black

See our website: www.AutomationDirect.com for complete engineering drawings.



Mini Bulkhead Connectors

Features and General Specifications

- Clear anodized aluminum shell
- Yellow PVC insert
- Gold-plated copper alloy contacts
- Zinc-plated steel locknut
- NBR O-ring
- Cable length 0.3 m (1ft)
- Front mount
- Mounting thread 1/2 NPT
- Ingress protection rating: IP67 when connected
- Temperature: -40 to 105°C [-40 to 221°F]
- Approvals: UL File E328610, CE
- Made in the USA



Mini Bulkhead Connectors							
Face View of Male	Face View of Female	# of Poles	Wire Rating	Female Receptacles	Price	Male Receptacles	Price
		2 North American Color Code	16AWG Max 600V 13A Max	<u>ZP-S1-2FR-0P3M</u>	\$12.00	<u>ZP-S1-2MR-0P3M</u>	\$11.50
		3 North American Color Code	16AWG Max 600V 13A Max	<u>ZP-S1-3FR-0P3M</u>	\$13.00	<u>ZP-S1-3MR-0P3M</u>	\$12.50
		4 North American Color Code	16AWG Max 600V 10A Max	<u>ZP-S1-4FR-0P3M</u>	\$16.00	<u>ZP-S1-4MR-0P3M</u>	\$13.50
		4 Cenelec Color Code	18AWG Max 300V 5.5 A Max	<u>ZP-S1C-4FR-0P3M-18</u>	\$16.50	<u>ZP-S1C-4MR-0P3M-18</u>	\$14.00
		5 North American Color Code	16AWG Max 600V 8A Max	<u>ZP-S1-5FR-0P3M</u>	\$17.00	<u>ZP-S1-5MR-0P3M</u>	\$16.50
		6 North American Color Code	16AWG Max 600V 8A Max	<u>ZP-S1-6FR-0P3M</u>	\$16.50	<u>ZP-S1-6MR-0P3M</u>	\$16.50

Color Codes			
Poles		Color	
North American	2	1	White
		2	Black
	3	1	Green/Yellow
		2	Black
		3	White
	4	1	Black
		2	White
		3	Red
		4	Green/Yellow
	5	1	White
		2	Red
		3	Green/Yellow
4		Orange	
5		Black	
6	1	White	
	2	Red	
	3	Green/Yellow	
	4	Orange	
	5	Black	
	6	Blue	
Cenelec	4	1	Brown
		2	White
		3	Blue
		4	Black

Dimensions

mm [in]

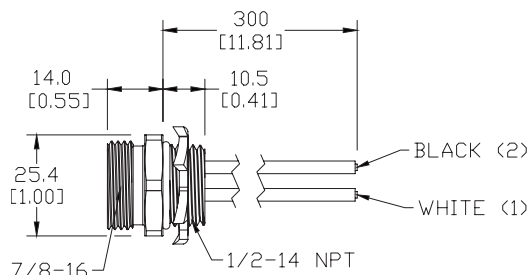

See our website: www.AutomationDirect.com for complete engineering drawings.



Mini Cordsets and Receptacles Accessories

Mini "T" Connectors Features and General Specifications

- Oil-resistant yellow PVC body
- Copper alloy/gold plating contacts
- Nickel-plated brass coupling nut
- Operating temperature range: -40 to 105°C [-40 to 221°F]
- IP67 protection when connected
- Approvals: UL File E328610, CE
- Made in the USA

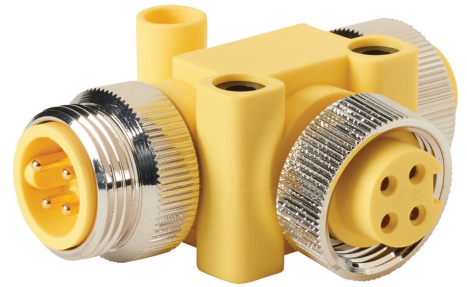

Mini "T" Connectors						
Face View of Male	Face View of Female	# of Poles	Rating	Part Number	Wiring	Price
		3	300V 8A	ZP-S1-3MFF-T	1-1-1 2-2-2 3-3-3	\$49.00
		4	300V 8A	ZP-S1-4MFF-T	1-1-1-1 2-2-2-2 3-3-3-3 4-4-4-4	\$51.00
		5	300V 8A	ZP-S1-5MFF-T	1-1-1-1-1 2-2-2-2-2 3-3-3-3-3 4-4-4-4-4 5-5-5-5-5	\$72.00

Dimensions

mm [in]

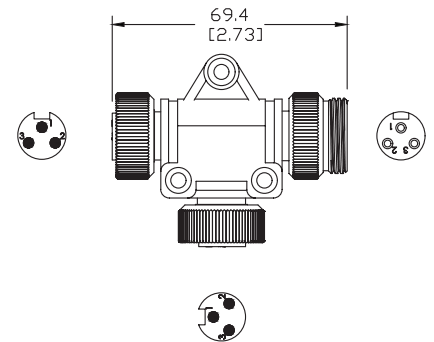

Note: Tightening torque 44 lb-in (5.0 N·m) coupling nut.

Caps and Adapters			
Dimensions – mm [in]	Description	Part Number	Price
	Closure cap for covering receptacles and plugs with male threads. 0.17" diameter mounting hole for securing the chain. Clear anodized aluminum with nickel-plated brass chain and hardware.	ZP-S1-CAP	\$6.00
	Closure plug for covering receptacles and plugs with female threads. 0.17" diameter mounting hole for securing the chain. Clear anodized aluminum with nickel-plated brass chain and hardware.	ZP-S1-PLUG	\$8.50
	Adapter coupling for connecting male and female plugs with female couplings. Clear anodized aluminum.	ZP-S1-XMP-AD	\$4.25





M12 Junction Blocks – Specifications

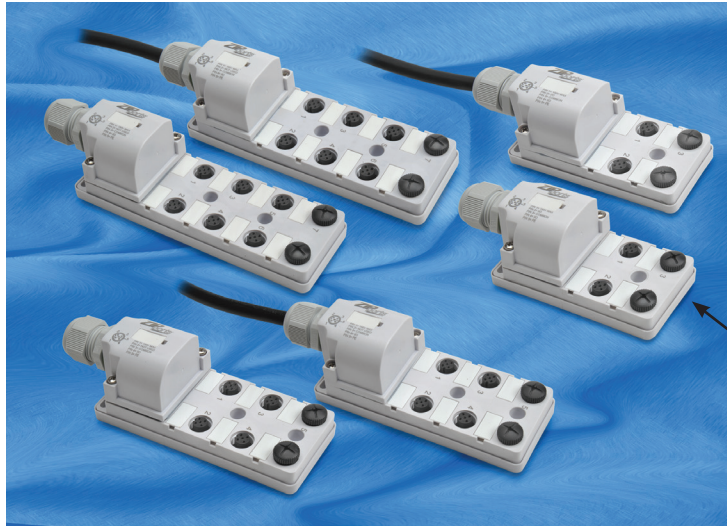

Note: 2 port caps for unused ports are included.

Overview

ZIPport multi-port interconnection junction blocks provide a simple and effective way to organize machine wiring for a variety of control systems, such as packaging equipment and conveying systems. These systems typically have many I/O points, such as sensors or solenoid-operated valves, consolidated in

one location. Many times these devices are hard-wired to a junction box or separately wired back to the main control cabinet. ZIPport multi-port junction blocks provide a more efficient and cost-effective solution: a main home-run control cable is run back to the main control cabinet, so the cost associated with errors in wiring,

rewiring, and I/O replacement is greatly reduced. The designer can choose from a variety of circuit configurations in industry standard M12-style connection, in port configurations of 4-, 6- and 8-pole, with a choice of one I/O per port or two I/O per port.

ZIPport Junction Block Specifications		
Electrical Specifications		
Voltage Rating	Without LEDs: 0 to 150 V AC/DC max. With LEDs: 48 VDC max, in accordance with LED Configuration	
Current Rating	3A per connector, 8A per block	
Technical Specifications		
Approvals*	UL file E328610, CE	
Degree of Protection	IP 67, with proper field wiring cable and all ports being used or covered with a protective cap.	
Operating Temperature Range	-20 to 80°C [-4 to 176°F]	
Material Specifications		
Body	Polypropylene	
Inserts	Polyamide	
Coupling Nuts	4, 6, and 8-Port: PBT	
Screws	Two m3x0.5x14 screws are used to assemble backshell.	
O-Ring	BUNA-N	
Cable Gland	M20x1.5	
Recommended Cable Diameters for Field Wireable	With inner grommet intact: • Max OD: 0.31" [7.9 mm]. • Min OD: For PUR Cable 0.19" [4.8 mm], For PVC Cable 0.17" [4.3 mm]	With inner grommet removed: • Max OD: 0.49" [12.5 mm]. • Min OD: For PUR Cable 0.28" [7.2 mm], For PVC cable 0.28" [7.2 mm], For SJT/SJE/ST/SE Cable 0.305" [7.75 mm]
LED Lens	Polycarbonate (LEDs visible only when power is supplied to the block)	
Contacts	Copper Alloy with Gold Plating	
Marker Tags	Polyamide (supplied on all units)	
Accessories	2 port caps for unused ports included. Purchase additional caps (in packs of 5) separately.	
Port Cap	Nylon	

*To obtain the most current agency approval information, see the Agency Compliance & Certifications Checklist section on the specific part number's web page.

ZIPport M12 Junction Blocks – Selection

ZIPport M12 Series Selection Chart														
Part Number	Price	Ports	Wires/ Poles	Indicating LEDs	I/O per Socket	Rating per Socket	Home Run Connection Type	Wiring	Pin Out Table	Dims.	Accessories			
4 Port														
ZP-JBH44-00-FW	\$71.00	4	4/5	No LED	1	150V AC/DC max, 3A	Cable clamp for field wiring	Diagram 1-A	–	Figure 1	ZP-JBH-CAP CDP12-0B-010-AA CDP12-0B-010-BB CDP12-0B-030-BB			
ZP-JBH44-2P-FW	\$91.00			PNP	1	48VDC max, 3A		Diagram 1-B	–	Figure 1				
ZP-JBH44-2N-FW	\$92.00			NPN	1	48VDC max, 3A		Diagram 1-C	–	Figure 1				
ZP-JBH44-00-5	\$109.00			No LED	1	150V AC/DC max, 3A	5m integrated cable	Diagram 1-A	Table 1	Figure 1				
ZP-JBH44-2P-5	\$118.00			PNP	1	48VDC max, 3A		Diagram 1-B	Table 1	Figure 1				
ZP-JBH44-2N-5	\$121.00			NPN	1	48VDC max, 3A		Diagram 1-C	Table 1	Figure 1				
ZP-JBH45-00-FW	\$84.00		5/5	4/5	No LED	2	150V AC/DC max, 3A	Cable clamp for field wiring	Diagram 2-A	–		Figure 2		
ZP-JBH45-2P-FW	\$101.00				PNP	2	48VDC max, 3A		Diagram 2-B	–		Figure 2		
ZP-JBH45-00-5	\$127.00				No LED	2	150V AC/DC max, 3A		Diagram 2-A	Table 2		Figure 2		
ZP-JBH45-2P-5	\$140.00			PNP	2	48VDC max, 3A	Diagram 2-B	Table 2	Figure 2					
6 Port														
ZP-JBH64-00-FW	\$87.00			6	4/5	No LED	1	150V AC/DC max, 3A	Cable clamp for field wiring	Diagram 3-A		–	Figure 3	ZP-JBH-CAP CDP12-0B-030-AA CDP12-0B-010-BB CDP12-0B-030-BB
ZP-JBH64-2P-FW	\$118.00	PNP	1			48VDC max, 3A	Diagram 3-B	–		Figure 3				
ZP-JBH64-2N-FW	\$118.00	NPN	1			48VDC max, 3A	Diagram 3-C	–		Figure 3				
ZP-JBH64-00-5	\$132.00	No LED	1			150V AC/DC max, 3A	5m integrated cable	Diagram 3-A	Table 3	Figure 3				
ZP-JBH64-2P-5	\$141.00	PNP	1			48VDC max, 3A		Diagram 3-B	Table 3	Figure 3				
ZP-JBH64-2N-5	\$141.00	NPN	1			48VDC max, 2A		Diagram 3-C	Table 3	Figure 3				
ZP-JBH65-00-FW	\$106.00	5/5	4/5		No LED	2	150V AC/DC max, 3A	Cable clamp for field wiring	Diagram 4-A	–	Figure 4			
ZP-JBH65-2P-FW	\$126.00				PNP	2	48VDC max, 3A		Diagram 4-B	–	Figure 4			
ZP-JBH65-00-5	\$160.00				No LED	2	150V AC/DC max, 3A		Diagram 4-A	Table 4	Figure 4			
ZP-JBH65-2P-5	\$175.00		PNP		2	48VDC max, 3A	Diagram 4-B	Table 4	Figure 4					
8 Port														
ZP-JBH84-00-FW	\$100.00		8		4/5	No LED	1	150V AC/DC max, 3A	Cable clamp for field wiring	Diagram 5-A	–	Figure 5	ZP-JBH-CAP CDP12-0B-010-AA CDP12-0B-030-AA CDP12-0B-010-BB CDP12-0B-030-BB	
ZP-JBH84-2P-FW	\$113.00	PNP		1		48VDC max, 3A	Diagram 5-B	–		Figure 5				
ZP-JBH84-2N-FW	\$112.00	NPN		1		48VDC max, 3A	Diagram 5-C	–		Figure 5				
ZP-JBH84-00-5	\$170.00	No LED		1		150V AC/DC max, 3A	5m integrated cable	Diagram 5-A	Table 5	Figure 5				
ZP-JBH84-2P-5	\$171.00	PNP		1		48VDC max, 3A		Diagram 5-B	Table 5	Figure 5				
ZP-JBH84-2N-5	\$177.00	NPN		1		48VDC max, 3A		Diagram 5-C	Table 5	Figure 5				
ZP-JBH85-00-FW	\$125.00	5/5		4/5	No LED	2	150V AC/DC max, 3A	Cable clamp for field wiring	Diagram 6-A	–	Figure 6			
ZP-JBH85-2P-FW	\$149.00				PNP	2	48VDC max, 3A		Diagram 6-B	–	Figure 6			
ZP-JBH85-2N-FW	\$149.00				NPN	2	48VDC max, 3A		Diagram 6-C	–	Figure 6			
ZP-JBH85-00-5	\$191.00			No LED	2	150V AC/DC max, 3A	5m integrated cable	Diagram 6-A	Table 6	Figure 6				
ZP-JBH85-2P-5	\$210.00			PNP	2	48VDC max, 3A		Diagram 6-B	Table 6	Figure 6				
ZP-JBH85-2N-5	\$217.00			NPN	2	48VDC max, 3A		Diagram 6-C	Table 6	Figure 6				
Accessories														
Part Number	Price	Qty	Description							Use With				
ZP-JBH-CAP	\$4.25	5	ZIPport junction block M12 protective cap.							 M12 ZipPort junction blocks				

ZIPport M12 Junction Blocks – Wiring

Wiring Diagrams

4-Port, 4-Wire/5-Pole

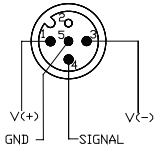

No LED Version
Diagram 1-A

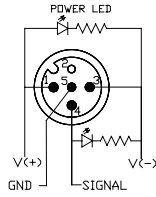

PNP Version
Diagram 1-B

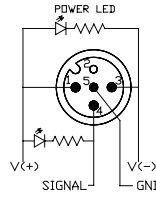

NPN Version
Diagram 1-C

4-Port, 5-Wire/5-Pole

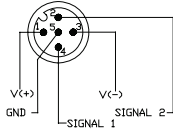

No LED Version
Diagram 2-A

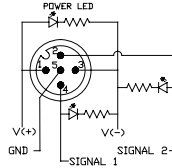

PNP Version
Diagram 2-B

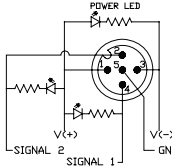

NPN Version
Diagram 2-C

6-Port, 4-Wire/5-Pole

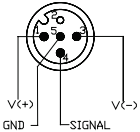

No LED Version
Diagram 3-A

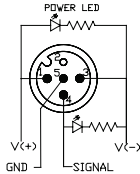

PNP Version
Diagram 3-B

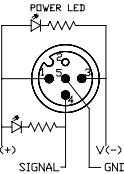

NPN Version
Diagram 3-C

6-Port, 5-Wire/5-Pole

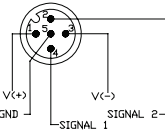

No LED Version
Diagram 4-A

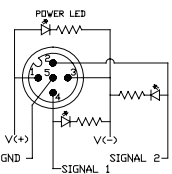

PNP Version
Diagram 4-B

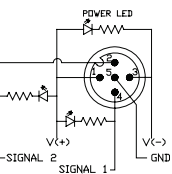

NPN Version
Diagram 4-C

8-Port, 4-Wire/5-Pole

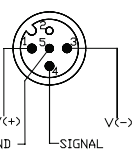

No LED Version
Diagram 5-A

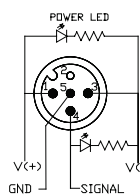

PNP Version
Diagram 5-B

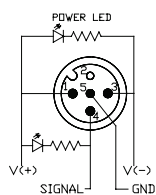

NPN Version
Diagram 5-C

8-Port, 5-Wire/5-Pole

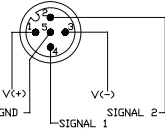

No LED Version
Diagram 6-A

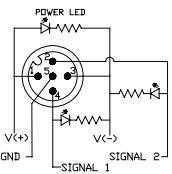

PNP Version
Diagram 6-B

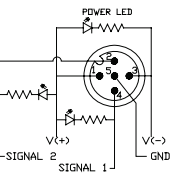

NPN Version
Diagram 6-C

Pin Out Tables

Pin Out Table 1	
M12 4-Port, 4-Wire/5-Pole ZipPort	
Function	Cable O.D. 0.34"
+V	Brown
-V	Blue
Ground	Green/Yellow
Port 1 Pin 4	White
Port 2 Pin 4	Green
Port 3 Pin 4	Yellow
Port 4 Pin 4	Gray

Pin Out Table 2	
M12 4-Port, 5-Wire/5-Pole ZipPort	
Function	Cable O.D. 0.38"
+V	Brown
-V	Blue
Ground	Green/Yellow
Port 1 Pin 2	Pink
Port 1 Pin 4	White
Port 2 Pin 2	Red
Port 2 Pin 4	Green
Port 3 Pin 2	Black
Port 3 Pin 4	Yellow
Port 4 Pin 2	Violet
Port 4 Pin 4	Gray

Pin Out Table 3	
M12 6-Port, 4-Wire/5-Pole ZipPort	
Function	Cable O.D. 0.35"
+V	Brown
-V	Blue
Ground	Green/Yellow
Port 1 Pin 4	White
Port 2 Pin 4	Green
Port 3 Pin 4	Yellow
Port 4 Pin 4	Gray
Port 5 Pin 4	Pink
Port 6 Pin 4	Red

Pin Out Table 4	
M12 6-Port, 5-Wire/5-Pole ZipPort	
Function	Cable O.D. 0.40"
+V	Brown
-V	Blue
Ground	Green/Yellow
Port 1 Pin 2	Gray/Pink
Port 1 Pin 4	White
Port 2 Pin 2	Red/Blue
Port 2 Pin 4	Green
Port 3 Pin 2	White/Green
Port 3 Pin 4	Yellow
Port 4 Pin 2	Brown/Green
Port 4 Pin 4	Gray
Port 5 Pin 2	White/Yellow
Port 5 Pin 4	Pink
Port 6 Pin 2	Yellow/Brown
Port 6 Pin 4	Red

Pin Out Table 5	
M12 8-Port, 4-Wire/5-Pole ZipPort	
Function	Cable O.D. 0.35"
+V	Brown
-V	Blue
Ground	Green/Yellow
Port 1 Pin 4	White
Port 2 Pin 4	Green
Port 3 Pin 4	Yellow
Port 4 Pin 4	Gray
Port 5 Pin 4	Pink
Port 6 Pin 4	Red
Port 7 Pin 4	Black
Port 8 Pin 4	Violet

Pin Out Table 6	
M12 8-Port, 5-Wire/5-Pole ZipPort	
Function	Cable O.D. 0.43"
+V	Brown
-V	Blue
Ground	Green/Yellow
Port 1 Pin 2	Gray/Pink
Port 1 Pin 4	White
Port 2 Pin 2	Red/Blue
Port 2 Pin 4	Green
Port 3 Pin 2	White/Green
Port 3 Pin 4	Yellow
Port 4 Pin 2	Brown/Green
Port 4 Pin 4	Gray
Port 5 Pin 2	White/Yellow
Port 5 Pin 4	Pink
Port 6 Pin 2	Yellow/Brown
Port 6 Pin 4	Red
Port 7 Pin 2	White/Gray
Port 7 Pin 4	Black
Port 8 Pin 2	Gray/Brown
Port 8 Pin 4	Violet

Note: Pin Out Tables are For 5-meter integrated cable only. Please refer to product insert for field wiring.



M12 Junction Blocks – Dimensions

Dimensions

inches [mm]

Figure 1: 4-Port, 4-Wire/5-Pole

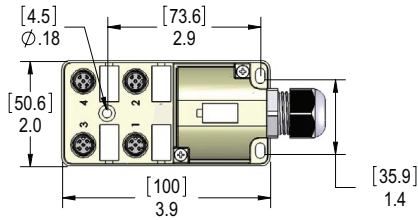

Figure 2: 4-Port, 5-Wire/5-Pole

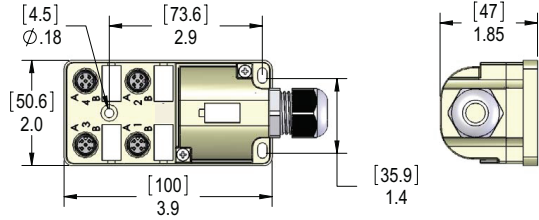

Figure 3: 6-Port, 4-Wire/5-Pole

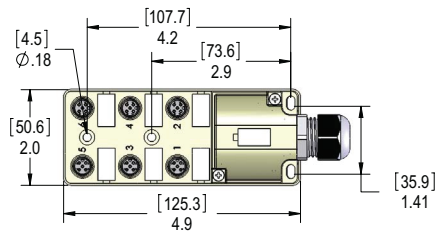

Figure 4: 6-Port, 5-Wire/5-Pole

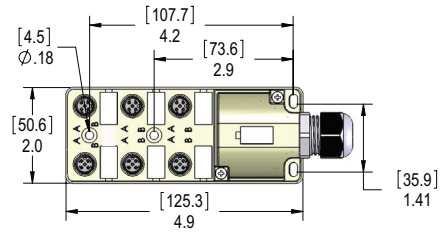

Figure 5: 8-Port, 4-Wire/5-Pole

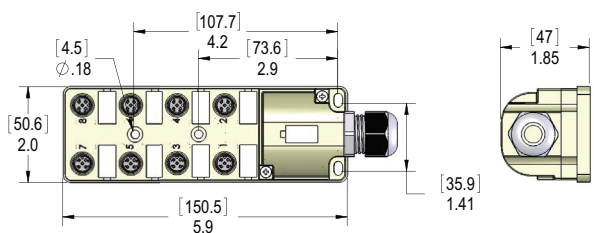
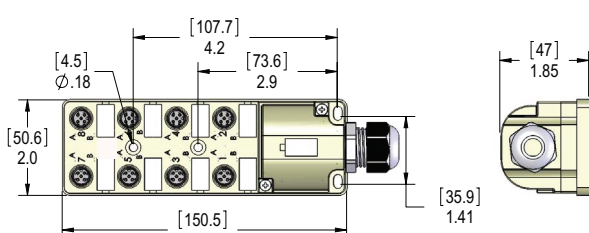

Figure 6: 8-Port, 5-Wire/5-Pole



M12 and M8 Series Distribution Blocks



Overview

Single-wire connectivity in machines and installations is troublesome and error-prone. Murrelektronik's passive distribution boxes provide a much more convenient method for connecting sensors and actuators to the control cabinet. Murrelektronik supplies a comprehensive range of distribution boxes. They create optimum installations for any application and are cost-effective, reliable, and space saving solutions!

Features

- 30mm wide footprint saves space and offers flexible mounting options
- Integrated LED indicators make troubleshooting easy
- Over molded bodies for vibration and environmental protection
- Available with Integrated cable or M12 12-pin Homerun cabling option
- Marking tags Included

Distribution Block Specifications

Distribution Block Specifications	
Electrical Specifications	
Voltage Rating	24 VDC
Voltage Range	18–30.2 VDC
Technical Specifications	
Approvals *	UL file E201820, CE
Degree of Protection	IP67
Material Specifications	
Body	Thermoplastic Polyurethane (TPU) clear and Polyamide (PA) UL 94 HB, Black
Contact Carrier M8	Polyamide (PA), UL94 HB, Green
Contact Carrier M12	Polyamide (PA) UL94 HB, Black
Contacts	Gold-plated
Gasket	Thermoplastic Polyurethane (TPU) clear
Connector housing M12 (12-pin M12 Quick-Disconnect)	Nickel-plated (CuZn)
Backside Gasket (8000-88590)	O-ring NBR
LED Lens	Thermoplastic Polyurethane (TPU), clear
LED Indicator Color	Power - Green, Signal 1- Yellow, Signal 2 - White
Marking Tags	Soft PVC

*To obtain the most current agency approval information, see the Agency Compliance & Certifications Checklist section on the specific part number's web page.

M12 and M8 Series Distribution Blocks



Exact 12 Series



Exact 8 Series

M12 and M8 Series Distribution Blocks									
Part Number	Price	Ports	LED Indicator	Socket Type	I/O per Socket	Socket Current	Load Current	Number of Commons	Operating Temperature
Exact 12									
8000-84560-0000000	\$100.00	4	PNP	5-pin M12	2	1A	–	1	-20 to 60°C [-4 to 140°F]
8000-88460-0000000	\$119.00	8	PNP	5-pin M12	1	1A	–	1	-20 to 60°C [-4 to 140°F]
8000-88590-0000000	\$119.00	8	PNP	5-pin M12	2	4A	8A/common	2	-30 to 70°C [-22 to 158°F]
Exact 8									
8000-84010-3370500	\$86.00	4	PNP	3-pin M8	1	2A	8A/common	1	-20 to 72°C [-4 to 162°F]
8000-84011-3370500	\$86.00	4	NPN	3-pin M8	1	2A	8A/common	1	-20 to 72°C [-4 to 162°F]
8000-84060-0000000	\$91.00	4	PNP	3-pin M8	1	1A	–	1	-20 to 57°C [-4 to 135°F]
8000-84110-3580500	\$111.00	4	PNP	4-pin M8	2	2A	8A/common	1	-20 to 72°C [-4 to 162°F]
8000-84111-3580500	\$111.00	4	NPN	4-pin M8	2	2A	8A/common	1	-20 to 72°C [-4 to 162°F]
8000-84160-0000000	\$96.00	4	PNP	4-pin M8	2	1A	–	1	-20 to 57°C [-4 to 135°F]
8000-88010-3570500	\$111.00	8	PNP	3-pin M8	1	2A	8A/common	1	-20 to 72°C [-4 to 162°F]
8000-88011-3570500	\$111.00	8	NPN	3-pin M8	1	2A	8A/common	1	-20 to 72°C [-4 to 162°F]
8000-88060-0000000	\$103.00	8	PNP	3-pin M8	1	1A	–	1	-20 to 57°C [-4 to 135°F]
8000-88110-3950500	\$147.00	8	PNP	4-pin M8	2	2A	8A/common	1	-20 to 72°C [-4 to 162°F]
8000-88111-3950500	\$147.00	8	NPN	4-pin M8	2	2A	8A/common	1	-20 to 72°C [-4 to 162°F]

M12 and M8 Series Distribution Blocks					
Part Number	Wiring	Pin Out Table	Main Connection Type	Recommended Cables	Drawing Link
Exact 12					
8000-84560-0000000	Diagram 1	Table 1	12-pin M12 quick-disconnect	7000-19041-705xxxx, 7000-19061-705xxxx	PDF
8000-88460-0000000	Diagram 2	Table 2	12-pin M12 quick-disconnect	7000-19041-705xxxx, 7000-19061-705xxxx	PDF
8000-88590-0000000	Diagram 1	Table 3	panel mount plug in	–	PDF
Exact 8					
8000-84010-3370500	Diagram 3	Table 4	5m integrated cable	–	PDF
8000-84011-3370500	Diagram 5	Table 4	5m integrated cable	–	PDF
8000-84060-0000000	Diagram 3	Table 5	12-pin M12 quick-disconnect	7000-19041-705xxxx, 7000-19061-705xxxx	PDF
8000-84110-3580500	Diagram 4	Table 6	5m integrated cable	–	PDF
8000-84111-3580500	Diagram 6	Table 6	5m integrated cable	–	PDF
8000-84160-0000000	Diagram 4	Table 7	12-pin M12 quick-disconnect	7000-19041-705xxxx, 7000-19061-705xxxx	PDF
8000-88010-3570500	Diagram 3	Table 8	5m integrated cable	–	PDF
8000-88011-3570500	Diagram 5	Table 8	5m integrated cable	–	PDF
8000-88060-0000000	Diagram 3	Table 9	12-pin M12 quick-disconnect	7000-19041-705xxxx, 7000-19061-705xxxx	PDF
8000-88110-3950500	Diagram 4	Table 10	5m integrated cable	–	PDF
8000-88111-3950500	Diagram 6	Table 10	5m integrated cable	–	PDF



M12 and M8 Series Distribution Blocks

Pin Out Tables

Pin Out Table 1		
M12 Male 12-pole plug M12, 4 port, 5-pin		
M12-Male pin	Function	
1	+V, Port 1-4, Pin 1	Brown
2	-V, Port 1-4, Pin 3	Blue
3	Port 1 Pin 4	White
5	Port 1 Pin 2	Pink
4	Port 2 Pin 4	Green
9	Port 2 Pin 2	Red
6	Port 3 Pin 4	Yellow
7	Port 3 Pin 2	Black
8	Port 4 Pin 4	Gray
10	Port 4 Pin 2	Violet
Thread M12	PE, Port 1-4, Pin 5	

Pin Out Table 4	
M8, 4 Port, 3-pin	
Function	Cable O.D. 6.9 mm
+V, Port 1-4, Pin 1	Brown
-V, Port 1-4, Pin 3	Blue
Port 1 Pin 4	White
Port 2 Pin 4	Green
Port 3 Pin 4	Yellow
Port 4 Pin 4	Gray

Pin Out Table 6	
Pre-wired cable, 5m M8, 4 port, 4-pin	
Function	Cable O.D. 8.6 mm
+V, Port 1-4, Pin 1	Brown
-V, Port 1-4, Pin 3	Blue
Port 1 Pin 4	White
Port 1 Pin 2	Gray Pink
Port 2 Pin 4	Green
Port 2 Pin 2	Red Blue
Port 3 Pin 4	Yellow
Port 3 Pin 2	White Green
Port 4 Pin 4	Gray
Port 4 Pin 2	Brown Green

Pin Out Table 8	
Pre-wired cable, 5m M8, 8 port, 3-pin	
Function	Cable O.D. 8.6 mm
+V, Port 1-8, Pin 1	Brown
-V, Port 1-8, Pin 3	Blue
Port 1 Pin 4	White
Port 2 Pin 4	Green
Port 3 Pin 4	Yellow
Port 4 Pin 4	Gray
Port 5 Pin 4	Pink
Port 6 Pin 4	Red
Port 7 Pin 4	Black
Port 8 Pin 4	Violet

Pin Out Table 2		
M12 Male 12-pole plug M12, 8 port, 4-pin		
M12-Male pin	Function	
1	+V, Port 1-8, Pin 1	Brown
2	-V, Port 1-8, Pin 3	Blue
3	Port 1 Pin 4	White
11	Port 1 Pin 2	Gray / Pink
4	Port 2 Pin 4	Green
12	Port 2 Pin 2	Red / Blue
6	Port 3 Pin 4	Yellow
8	Port 4 Pin 4	Gray
5	Port 5 Pin 4	Pink
9	Port 6 Pin 4	Red
7	Port 7 Pin 4	Black
10	Port 8 Pin 4	Violet
Thread M12	PE, Port 1-8, Pin 5	

Pin Out Table 5		
M12 Male 12-pole plug M8, 4 port, 3-pin		
M12-Male pin	Function	
1	+V, Port 1-4, Pin 1	Brown
2	-V, Port 1-4, Pin 3	Blue
3	Port 1 Pin 4	White
4	Port 2 Pin 4	Green
6	Port 3 Pin 4	Yellow
8	Port 4 Pin 4	Gray

Pin Out Table 7		
M12 Male 12-pole plug M12, 4 port, 5-pin		
M12-Male pin	Function	
1	+V, Port 1-4, Pin 1	Brown
2	-V, Port 1-4, Pin 3	Blue
3	Port 1 Pin 4	White
4	Port 2 Pin 4	Green
6	Port 3 Pin 4	Yellow
8	Port 4 Pin 4	Gray
5	Port 1 Pin 2	Pink
9	Port 2 Pin 2	Red
7	Port 3 Pin 2	Black
10	Port 4 Pin 2	Violet

Pin Out Table 9		
M12 Male, 12-pole plug M8, 8 port, 3-pin		
M12-Male pin	Function	
1	+V, Port 1-8, Pin 1	Brown
2	-V, Port 1-8, Pin 3	Blue
3	Port 1 Pin 4	White
4	Port 2 Pin 4	Green
6	Port 3 Pin 4	Yellow
8	Port 4 Pin 4	Gray
5	Port 5 Pin 4	Pink
9	Port 6 Pin 4	Red
7	Port 7 Pin 4	Black
10	Port 8 Pin 4	Violet

Pin Out Table 3	
Backside plug, removable spring terminals M12, 8 port, 5-pin	
Terminal	Function
+	+V, Port 1-8, Pin 1
+	
-	-V, Port 1-8, Pin 3
-	
Ground	PE, Port 1-8, Pin 5
1/4	Port 1 Pin 4
1/2	Port 1 Pin 2
2/4	Port 2 Pin 4
2/2	Port 2 Pin 2
3/4	Port 3 Pin 4
3/2	Port 3 Pin 2
4/4	Port 4 Pin 4
4/2	Port 4 Pin 2
5/4	Port 5 Pin 4
5/2	Port 5 Pin 2
6/4	Port 6 Pin 4
6/2	Port 6 Pin 2
7/4	Port 7 Pin 4
7/2	Port 7 Pin 2
8/4	Port 8 Pin 4
8/2	Port 8 Pin 2

Pin Out Table 10	
Pre-wired cable, 5m M8, 8 port, 4-pin	
Function	Cable O.D. 9.6 mm
+V, Port 1-8, Pin 1	Brown
-V, Port 1-8, Pin 3	Blue
Port 1 Pin 4	White
Port 1 Pin 2	Gray Pink
Port 2 Pin 4	Green
Port 2 Pin 2	Red Blue
Port 3 Pin 4	Yellow
Port 3 Pin 2	White Green
Port 4 Pin 4	Gray
Port 4 Pin 2	Brown Green
Port 5 Pin 4	Pink
Port 5 Pin 2	White Yellow
Port 6 Pin 4	Red
Port 6 Pin 2	Yellow Brown
Port 7 Pin 4	Black
Port 7 Pin 2	White Gray
Port 8 Pin 4	Violet
Port 8 Pin 2	Gray Green

M12 and M8 Series Distribution Blocks

Wiring Diagrams

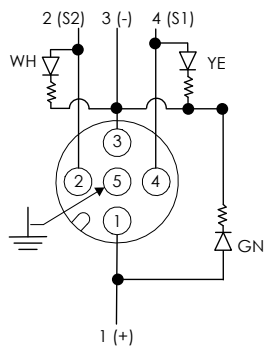

Diagram 1
(PNP field connection)
8000-84560-0000000
8000-88590-0000000

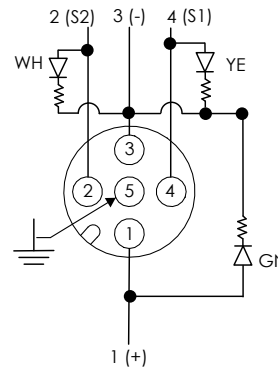

Diagram 2
(PNP field connection)
8000-88460-0000000

Note: Ports 1 and 2 have 2 signals S1 and S2
Ports 3 - 8 have signal S1 only

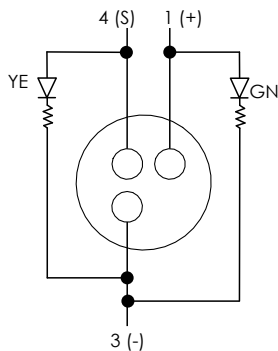

Diagram 3
(PNP field connection)
8000-84010-3370500
8000-88011-3570500
8000-84060-0000000
8000-88060-0000000

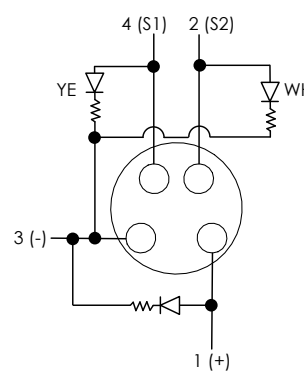

Diagram 4
(PNP field connection)
8000-84110-3580500
8000-88110-3950500
8000-84160-0000000

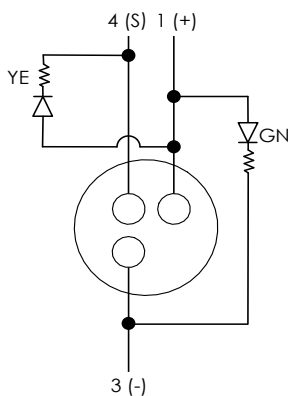

Diagram 5
(NPN field connection)
8000-84011-3370500
8000-88011-3570500

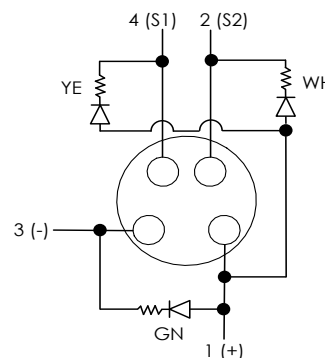

Diagram 6
(NPN field connection)
8000-84111-3580500
8000-88111-3950500

Connection Cables X-Coded Data

Industrial Ethernet Shielded M12 X-Coded Cables

Features

- High flex industrial Ethernet shielded Cat6a cables
- Resistant to welding sparks
- Flame retardant, chemical resistant
- TPE (thermoplastic elastomer) jacket for typical industrial applications



7700-51101 Series



7700-51201 Series

Ethernet Shielded M12 X-coded Cables

Part Number	Price	Poles/ Pins	Connectors	Jacket		Length m [ft]	Drawing Link
				Material	Color		
7700-51101-S4X0100	\$66.00	8	Male straight M12 to straight RJ45	TPE Thermoplastic Elastomer	Teal	1.0 [3.2]	PDF
7700-51101-S4X0300	\$84.00					3.0 [9.8]	PDF
7700-51101-S4X0500	\$103.00					5.0 [16.4]	PDF
7700-51201-S4X0100	\$72.00		Male 90° M12 to straight RJ45			1.0 [3.2]	PDF
7700-51201-S4X0300	\$91.00					3.0 [9.8]	PDF
7700-51201-S4X0500	\$109.00					5.0 [16.4]	PDF

Specifications

Nominal Voltage	60VDC UL rated: 30VDC	Locking Material	Zinc die casting, matte nickel plated
Max Current	0.5 A	Protection Degree	M12: IP66K/67 ; RJ45: IP20
Rated Surge Voltage	1.0 kV	Outer Ø	7.4 mm [0.29 in] ±5%
Transfer Parameters	Cat6a, Class EA (ISO/IEC 11801)	Bend Radius	10 x outer Ø*
Transfer Rate	Up to 10Gbps full duplex	Temperature Range	Cable: -40 to +80°C [-40 to +176°F] Connector: -25 to 85°C [13 to 185°F]
Connection	Connector 1: M12 X-coded Connector 2: RJ45	Wire Material	Copper wire, tin plated
		Approvals	cULus File E362618
Tightening Torque	0.6 N·m	To obtain the most current agency approval information, see the Agency Compliance & Certifications Checklist section on the specific part number's web page.	

*For a linear flex application with a bend radius of 10x of the outside diameter of the cable, you can expect a life of 1 million cycles.
For a linear flex application with a bend radius of 20x of the outside diameter of the cable, you can expect a life of 10 million cycles.