

# Wera Torque Wrenches



This classic torque wrench is the successful combination of robust design, simple setting of the desired limit value as well as rapid changeover of the ratcheting direction.

When the set value is reached, a distinctly audible and perceptible signal is triggered, after which the wrench is immediately ready for use once again.

All Wera torque tools are supplied with a calibration certificate.

### Adjustments are simple

Simple adjustment and locking of the pre-set value on an easy-to-read scale.

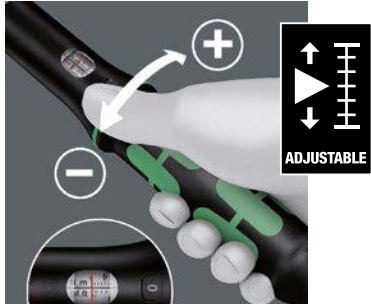

Torque Wrenches		
Part Number	Description	Price Each
05075393055	Wera adjustable torque wrench with reversible ratchet. 1.5 to 18 lb-ft, 1/4 inch square drive. Manufacturer part number 075393.	\$144.00
05075394055	Wera adjustable torque wrench with reversible ratchet 5 to 45 lb-ft, 3/8 inch square drive. Manufacturer part number 075394.	\$175.00
05075405055	Wera adjustable torque wrench with reversible ratchet. 15 to 80 lb-ft, 3/8 inch square drive. Manufacturer part number 075405.	\$175.00
05075402055	Wera adjustable torque wrench with reversible ratchet. 30 to 150 lb-ft, 1/2 inch square drive. Manufacturer part number 075402.	\$184.00

### Release signal

Release signal when the value is reached.



05075393055



05075394055



05075405055



05075402055

### Choice of hand direction

Suitable for right- and left-hand direction.

