

bit DEPURATOR

Coalescing mini-depurator

- Space saving
- Minimum load loss as the flow rate varies
- All-round condensate level viewing



UNITS

bit DEPURATOR

TECHNICAL DATA		DEP BIT 1/8"	DEP BIT 1/4"
Threaded port		1/8"	1/4"
Degree of purification		99.97% 0.01 µm	
Max. inlet pressure	MPa	1.3	
	bar	13	
	psi	188	
Suggested flow at 6 bar	NI/min	200	
	scfm	7	
Maximum suggested flow rate		See next page	
Max temperature at 1 MPa; 10 bar; 145 psi	°C	50	
	°F	122	
Weight	g	65	
Wall fixing screws		M4 by means of the bracket provided	
Bowl capacity	cm ³	16	
Mounting position		Vertical	
Condensate drain		RMSA: drain with manual condensate discharge and automatic discharge at zero pressure.	
Fluid		Filtered 5 µm compressed air	
Notes		A It is advisable to mount a 5 m filter upstream the depurator acting as a rough filter.	

USE AND MAINTENANCE

When replacing the coalescing cartridge, unscrew the bowl and then unscrew the screen of the cartridge assembly. Then replace the cartridge. Use a no. 3 compass spanner to unscrew the bowl.

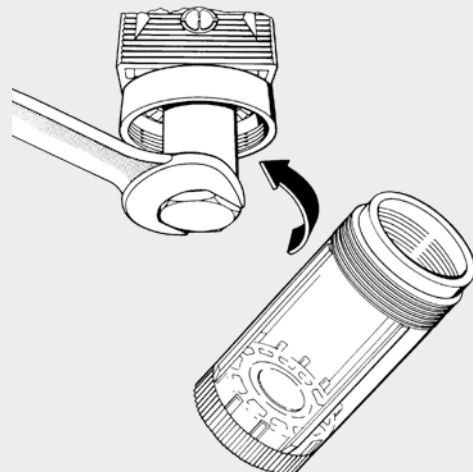

FLOW CHARTS

DEP

$\Delta P = (P_m - P_v)$
psi kPa bar

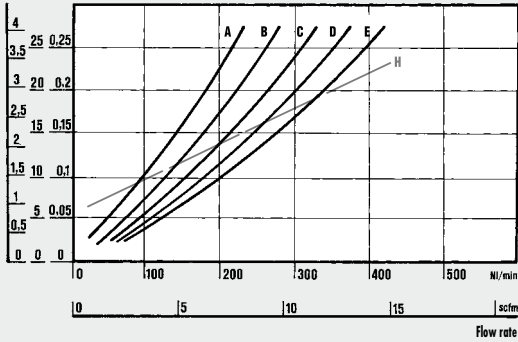

Department of Mechanics
Turin Polytechnic

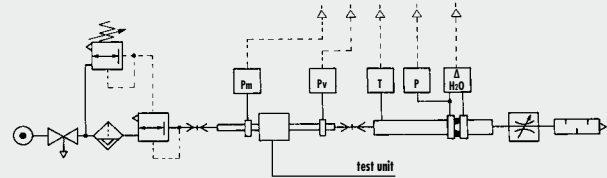

• Flow tests carried out at the Department of Mechanics, Turin Polytechnic, using the computerized test bench following CETOP RP50R recommendations (ISO DIS 6358-2-approved) with ISO 5167 diaphragm gauge.

- (A) = 2 bar - 0.2 MPa - 29 psi
- (B) = 4 bar - 0.4 MPa - 58 psi
- (C) = 6 bar - 0.6 MPa - 87 psi
- (D) = 8 bar - 0.8 MPa - 116 psi
- (E) = 10 bar - 1 MPa - 145 psi
- (H) = maximum flow rate recommended for optimal operation

DIMENSIONS

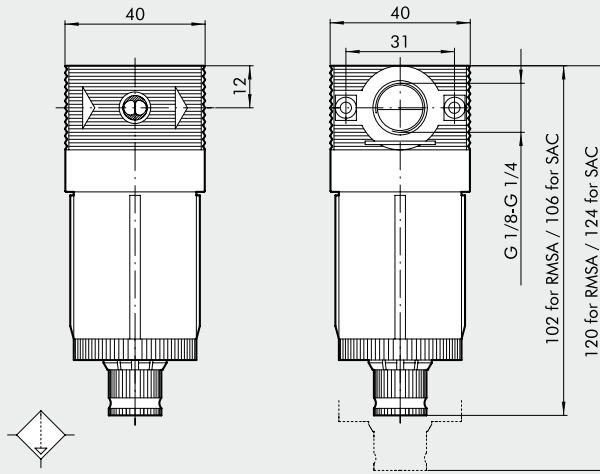

ORDERING CODES

Code	Description
5112001	DEP BIT 1/8 RMSA
5212001	DEP BIT 1/4 RMSA

SYNOPTIC, SIZES AND VERSIONS

DEP ELEMENT	BIT SIZE	1/8 THREADED PORT	RMSA CONDENSATE DRAIN
DEP	BIT	1/8 1/4	RMSA

RMSA: drain with manual condensate discharge and automatic discharge at zero pressure.

bit ACCESSORIES

ACCESSORIES FOR STANDARD bit AND SERIES F bit FOR WATER

PRESSURE GAUGE

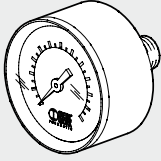

Code	Description
9700102 *	M 40 1/8 04
9700101 *	M 40 1/8 012

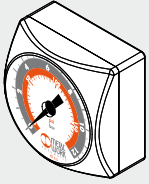

9700109 *	M 40x40 1/8 04
9700110 *	M 40x40 1/8 012

* Cannot be used with water

DOME DISASSEMBLY SPANNER

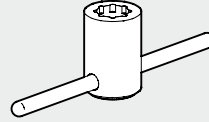

Code	Description
9220701	Cover LUB spanner

R/FR FIXING BRACKET

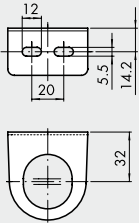

Code	Description
9200701	SF100 - BIT - ND 1/4 - SY1

COVER DISASSEMBLY SPANNER

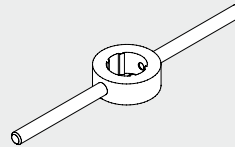

Code	Description
9170401	CS CS BIT

ASSEMBLY PLATE (PAIR)

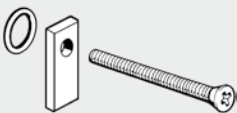

Code	Description
9170201	PAB 1/8 - 1/4 BIT

REDUCER PLUG DISASSEMBLY SPANNER

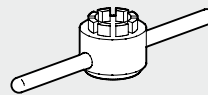

Code	Description
9170501	CS OTR BIT

WALL MOUNTING BRACKET (PAIR)

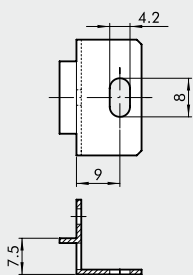

Code	Description
9170301	SFB 1/8 - 1/4 BIT

BOWL DISASSEMBLY SPANNER

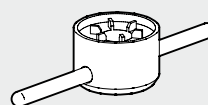

Code	Description
9170601	CS TF - TL BIT - SY1

bit SPARE PARTS



SPARE PARTS FOR STANDARD bit

UPPER COVER FOR MR

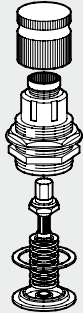

Code	Description
9250805	Spares CS 1/8 1/4 BIT 02
9250806	Spares CS 1/8 1/4 BIT 04
9250807	Spares CS 1/8 1/4 BIT 08
9250808	Spares CS 1/8 1/4 BIT 012

FILTER AND FILTER-REGULATOR BOWL

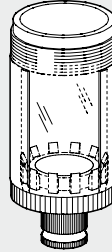

Code	Description
9255001	Spares TF 1/8 1/4 BIT RMSA
9255101	Spares TF 1/8 1/4 BIT SAC

UPPER COVER FOR MR FC

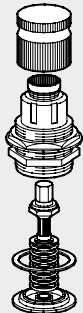

Code	Description
9250817	Spares CS FC 1/8 1/4 BIT 02
9250818	Spares CS FC 1/8 1/4 BIT 04

AUTOMATIC DRAIN (SAC)



Code	Description
9000803	Spares SAC automatic drain

UPPER COVER FOR MRA

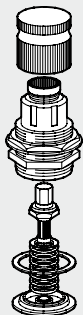

Code	Description
9250809	Spares CSA 1/8 - 1/4 BIT 02
9250814	Spares CSA 1/8 - 1/4 BIT 04
9250815	Spares CSA 1/8 - 1/4 BIT 08
9250816	Spares CSA 1/8 - 1/4 BIT 012

LUBRICATOR BOWL

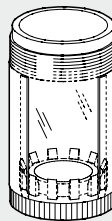

Code	Description
9251402	Spares TL 1/8 1/4 BIT

COMPLETE POPPET FOR MR AND MRA

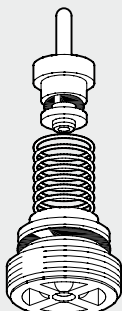

Code	Description
9250705	Spares poppet for MR
9250706	Spares poppet for MR-SR (rapid drain)
9250708	Spares poppet for MRA

FILTER ELEMENT

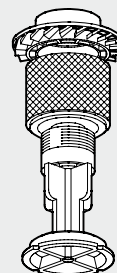

Code	Description
9251708	Spares FP 1/8-1/4 BIT 5 (yellow)
9251709	Spares FP 1/8-1/4 BIT 20 (white)
9251710	Spares FP 1/8-1/4 BIT 50 (blue)

FILTER CARTRIDGE

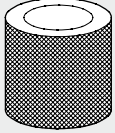

Code	Description
9251808	Spares filter cartridge BIT 5 (yellow)
9251809	Spares filter cartridge BIT 20 (white)
9251810	Spares filter cartridge BIT 50 (blue)

DEPURATOR FILTER ELEMENT

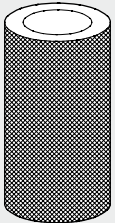

Code	Description
9251712	Spares FP DEP. 1/8 1/4 BIT

COMPLETE POPPET FOR FR



Code	Description
9250905	Spares OTFR 1/8 1/4 BIT 5 (yellow)
9250906	Spares OTFR 1/8 1/4 BIT 20 (white)
9250907	Spares OTFR 1/8 1/4 BIT 50 (blue)

TRANSPARENT LUBRICATOR COVER

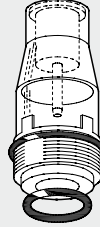

Code	Description
9251302	Spares CVL 100-200-300-400 BIT

SPRING FOR MR, FR

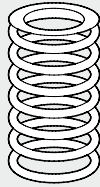

Code	Description
9250610	Spares MO 02 BIT
9250611	Spares MO 04 BIT
9250612	Spares MO 08 BIT
9250613	Spares MO 012 BIT

NOTES

SPARE PARTS FOR SERIES F bit FOR WATER

FILTER ELEMENT



Code	Description
9251709	Spares FP 1/8-1/4 BIT 20 (white)

SPRING FOR REG F, FR F

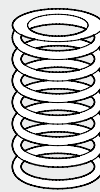

Code	Description
9250610	Spares MO 02 BIT
9250611	Spares MO 04 BIT
9250612	Spares MO 08 BIT
9250613	Spares MO 012 BIT

FILTER CARTRIDGE

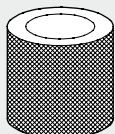

Code	Description
9251809	Spares filter cartridge BIT 20 (white)

NOTES

GENERAL TECHNICAL DATA **bit**

The units in the **bit** range feature:

- reduced dimensions
- negligible load loss
- long life
- excellent quality-to-price ratio

Thanks to its technical features the **bit** air treatment range is particularly suitable for de-centralized use near the final actuators.



TECHNICAL DATA

		BIT 1/8"	BIT 1/4"
Threaded port		1/8"	1/4"
Degree of filtration	µm	5 (yellow) 20 (white) 50 (blue)	
Degree of purification		99.97% α 0.01 µm	
Setting range	bar	0 to 2 - 0 to 4 - 0 to 8 - 0 to 12	
Max. inlet pressure	MPa	1.3	
	bar	13	
	psi	188	
Flow rate at 6.3 bar (0.63 MPa to 91 psi) ΔP 0.5 bar (0.05 MPa to 7 psi)	Nl/min	350	
	scfm	12	
Max temperature at 1 MPa; 10 bar; 145 psi	°C	- 10° to + 50°	
	°F	14° to 122°	
Elements		Filter - Regulator - Lubricator - Filter-regulator - Depurator	
		Units: FRL, FR + L, F + L, F + D	
Mounting		By means of the bracket provided	
Fluid		Compressed air	
Compatibility with oils		See chapter Z1	

ASSEMBLY

Use ASSEMBLY PLATES (code 9170201) to assemble the **bit** elements correctly.

Assembly procedure:

- Fit the plates right into the slots under the body of the **bit** element
- Check that there O-rings round the threaded outlet
- Assemble the elements, making sure that the flow run in the direction of the arrows marked on the body.

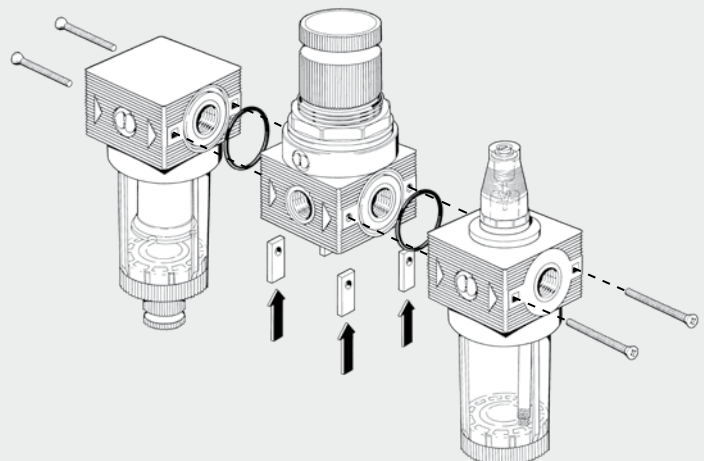

WALL MOUNTING

The wall fixing of a **bit** unit can be made through:

- Fixing bracket R/FR code 9200701 (A)
- Wall fixing plates code 9170301 (B)

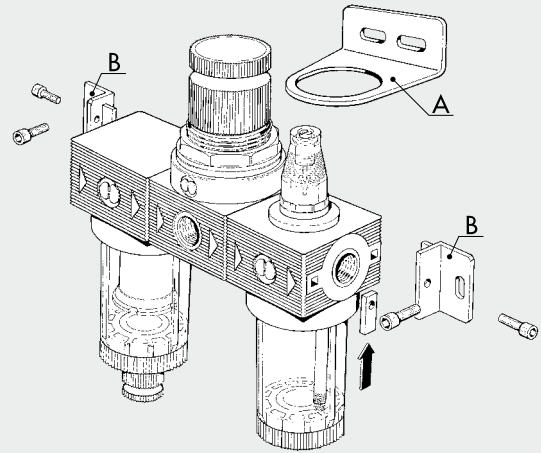

GENERAL RULES - USE AND MAINTENANCE

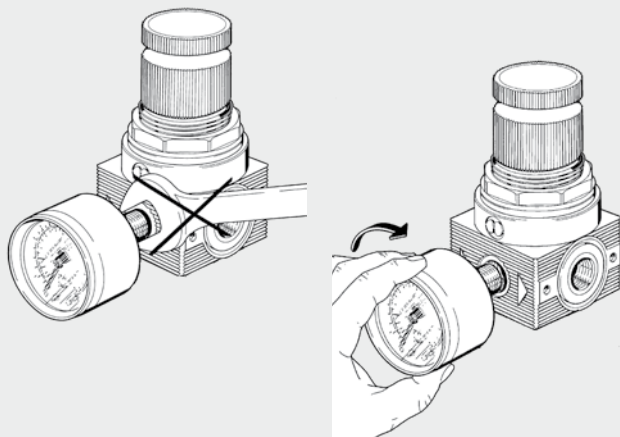

MOUNTING THE GAUGE

The gauge must be mounted by hand without using a spanner. Use fluid sealants to provide a good seal. N.B. Do not use Teflon.

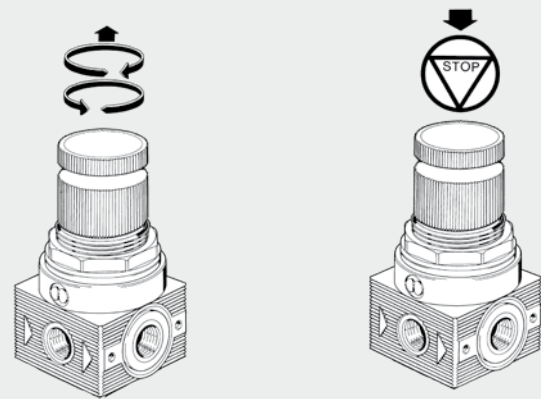

SETTING THE PRESSURE

The air pressure must always be set upwards. The knob can be locked so that the set pressure cannot be altered.

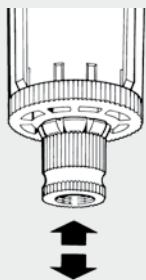

With the knob in the centre position, the drain is semi-automatic. The drain operates when the bowl is not pressurized and closes when it is.

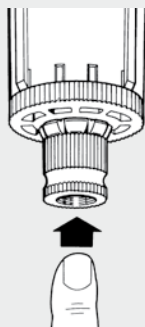

Press the button to drain condensate when the bowl is pressurized.

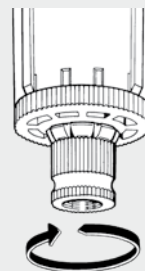

Turn the knob anticlockwise to close the valve with bowl pressurized or not pressurized.



To clean or replace the filter element unscrew the screen of the centrifuge assembly. Use a no. 3 compass spanner to unscrew the bowl.