

Solenoid Valve Cables and Connectors



These high quality connectors and over-molded cables help reduce wiring time. The lower voltage models, 24V or 110V AC/DC, include built-in surge suppression, Yellow LED indicator and are rated for connecting with electronics. The 230V AC/DC models are rated for straight wired products. All models are available in five sizes based on DIN 43650.

Features

- 8mm, 9.4mm, 10mm, 11mm and 18mm square DIN styles
- Fits most popular solenoid valves and sensors
- Suppression and LED indication available in 24V or 110V AC/DC models
- PVC jacketed cables in 1, 3 or 5 meter lengths on select connectors
- Field wireable connectors on select models
- Polarity insensitive (follow solenoid, sensor, or other devices wiring diagram)

8mm Connectors

Dimensions shown
mm [inches]

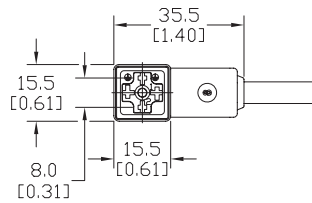
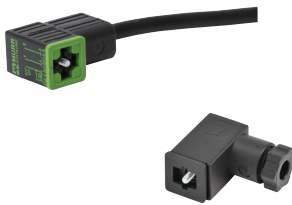

Height = 25mm [0.98in]

Connector with Cable

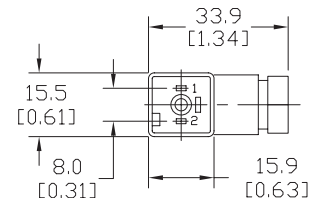

Height = 26mm [1.02]

Field Wireable Connector

8mm (3-pole) Connectors (per DIN 43650 Form C)

Part No.	Price	Voltage (AC/DC)	Current Rating	IP Rating	Wire Size	Cable Dia. (in.)	LED	Surge Protection	Wiring Figure	Screw Size/Torque	Weight (lbs)	Agency Approval
SC8-LS24-3	\$11.00	24 ±20%	max 4A	67	18 AWG	0.23	yes	zener diode (D-Z DO-15 47V 2W)	1	m2.5-0.45x25mm/ 0.4 Nm (3.5 in lb)	0.40	CSA (080128-0-000)
SC8-LS24-5	\$13.00							zener diode (D-Z DO-15 47V 2W)	7		0.65	
SC8-LS110-3	\$13.50	110 ±10%	max 4A	67	18 AWG	0.23	yes	zener diode (D-Z DO-41 ZY200 2W)	7	m2.5-0.45x25mm/ 0.4 Nm (3.5 in lb)	0.41	CSA (080128-0-000)
SC8-LS110-5	\$16.00							zener diode (D-Z DO-41 ZY200 2W)	7		0.63	
SC8-3	\$9.75	230	max 6A	65	Solid 12 AWG Stranded 14 AWG w/Ferrule 16 AWG	gland size 0.20 to 0.24	no	none	2	m2.5-0.45x25mm/ 0.5 Nm (4.4 in lb)	0.39	none
SC8-0	\$5.00								9		0.10	
SC8-1	\$9.75								9		0.10	
SC8-5	\$12.00								2		0.68	

Please note: The above parts are not compatible with the AVP and AVS series valves, which have 11mm DIN plugs.

Last digit in part number denotes cable length in meters, a 0 indicates field termination.

8mm Transmitter Connector

Dimensions shown
mm [inches]

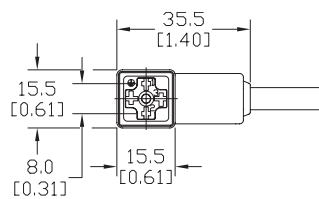

Height = 25mm [0.98in]

Connector with Cable

8mm (4-pole) Connectors (per DIN 43650 Form C)

Part No.	Price	Voltage (AC/DC)	Current Rating	IP Rating	Wire Size	Cable Dia. (in.)	LED	Surge Protection	Wiring Figure	Screw Size/Torque	Weight (lbs)	Agency Approval
SC8-5T	\$17.00	230	max 6A	67	18 AWG	0.26	yes	none	8	m3-0.5x42mm/ 0.5 Nm (4.4 in lb)	0.80	CSA (080128-0-000)

Last digit in part number denotes cable length in meters, a 0 indicates field termination.

Solenoid Valve Cables and Connectors

9.4mm Connectors

Dimensions shown
mm [inches]

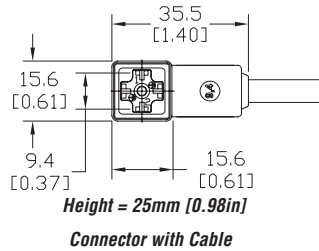

9.4mm (3-pole) Connectors (DIN Style, Form C Industrial)

Part No.	Price	Voltage (AC/DC)	Current Rating	IP Rating	Wire Size	Cable Dia. (in.)	LED	Surge Protection	Wiring Figure	Screw Size/Torque	Weight (lbs)	Agency Approval
SC9-LS24-3	\$11.00	24 ±20%	max 4A	67	18 AWG	0.23	yes	zener diode (D-Z DO-15 47V 2W)	1	m3-0.5x26mm/ 0.4 Nm (3.5 in lb)	0.40	CSA (080128-0-000)
SC9-LS24-5	\$13.00										0.64	
SC9-LS110-3	\$13.50	110 ±10%						zener diode (D-Z DO-41 ZY200 2W)	7		0.40	
SC9-LS110-5	\$16.00								0.64			
SC9-3	\$9.75	230	max 6A				no	none	2	m3-0.5x26mm/ 0.5 Nm (4.4 in lb)	0.40	none
SC9-5	\$12.00										0.64	

Please note: The above parts are not compatible with the AVP and AVS series valves, which have 11mm DIN plugs.
Last digit in part number denotes cable length in meters.

10mm Connectors

Dimensions shown
mm [inches]

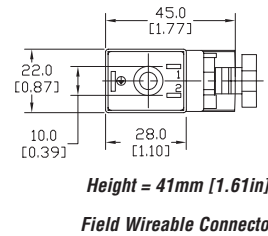
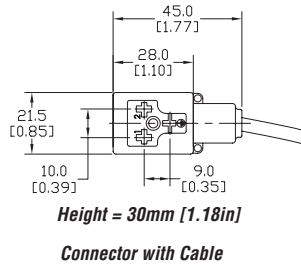

10mm (3-pole) Connectors (per DIN 43650 Form B)

Part No.	Price	Voltage (AC/DC)	Current Rating	IP Rating	Wire Size	Cable Dia. (in.)	LED	Surge Protection	Wiring Figure	Screw Size/Torque	Weight (lbs)	Agency Approval
SC10-LS24-3	\$11.00	24 ±20%	max 4A	67	18 AWG	0.23	yes	zener diode (D-Z DO-15 47V 2W)	10	m3-0.5x30mm/ 0.4 Nm (3.5 in lb)	0.43	CSA (080128-0-000)
SC10-LS24-5	\$13.00										0.68	
SC10-LS110-3	\$13.50	110 ±10%	max 1A					zener diode (D-Z DO-41 ZY200 2W)	6		0.43	
SC10-LS110-5	\$16.00							0.68				
SC10-3	\$9.75	230	max 10A				no	none	3		0.43	
SC10-5	\$12.00										0.68	
SC10-LS24-0	\$9.50	24 ±20%	max 4A	65	Solid 12 AWG Stranded 14 AWG w/Ferrule 16 AWG	gland size 0.24 to 0.32				yes	zener diode (D-Z DO-15 47V 2W)	4
SC10-LS110-0	\$10.00	110 ±10%	max 1A				mov (SIOV S10 K130)	5	0.07			
SC10-0	\$7.50	230	max 10A				no	none	9	0.06		

Please note: The above parts are not compatible with the AVP and AVS series valves, which have 11mm DIN plugs.
Last digit in part number denotes cable length in meters, a 0 indicates field termination.

Solenoid Valve Cables and Connectors

11mm Connectors

Dimensions shown
mm [inches]

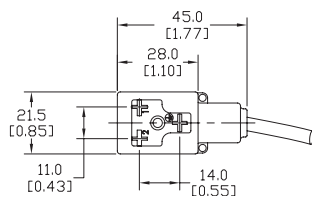

Height = 30mm [1.18in]

Connector with Cable

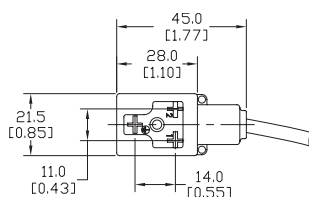

Height = 30mm [1.18in]

Reverse Connector with Cable

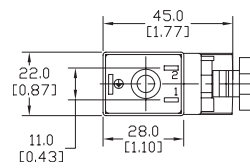

Height = 41mm [1.61in]

Field Wireable Connector

11mm (3-pole) Connectors (DIN Style, Form B Industrial)

Part No.	Price	Voltage (AC/DC)	Current Rating	IP Rating	Wire Size	Cable Dia. (in)	LED	Surge Protection	Wiring Figure	Screw Size/ Torque	Weight (lbs)	Agency Approval				
SC11-LS24-3	\$11.00	24 ±20%	max 4A	67	18 AWG	0.23	yes	zener diode (D-Z DO-15 47V 2W)	10	m3-0.5x30mm/ 0.4 Nm (3.5 in lb)	0.44	CSA (080128-0-000)				
SC11-LS24-5	\$13.00										0.67					
SC11-LS110-3	\$13.50	110 ±10%	max 1A					zener diode (D-Z DO-41 ZY200 2W)	6		0.44					
SC11-LS110-5	\$16.00										0.67					
SC11-LS24-3R	\$11.00	24 ±20%	max 4A					zener diode (D-Z DO-15 47V 2W)	10		0.44					
SC11-LS24-5R	\$13.00										0.67					
SC11-LS110-3R	\$13.50	110 ±10%	max 1A					zener diode (D-Z DO-41 ZY200 2W)	6		0.44					
SC11-LS110-5R	\$16.00								0.67							
SC11-3	\$9.75	230	max 10A				65	Solid 12 AWG Stranded 14 AWG w/Ferrule 16 AWG	gland size 0.24 to 0.32		no		none	3	0.44	none
SC11-5	\$12.00													0.67		
SC11-LS24-0	\$9.50	24 ±20%	max 4A	yes	zener diode (D-Z DO-15 47V 2W)	4				0.07						
SC11-LS110-0	\$10.00	110 ±10%	max 1A		mov (SIOV S10 K130)	5				0.07						
SC11-0	\$7.50	230	max 10A	no	none	9				0.07						

Last digit in part number denotes cable length in meters, a 0 indicates field termination.

18mm Connectors

Dimensions shown
mm [inches]

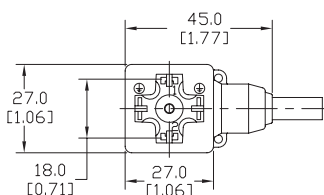

Height = 30mm [1.18in]

Connector with Cable

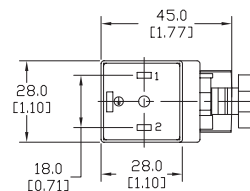

Height = 41mm [1.61in]

Field Wireable Connector

18mm (3-pole) Connectors (per DIN 43650 Form A)

Part No.	Price	Voltage (AC/DC)	Current Rating	IP Rating	Wire Size	Cable Dia. (in)	LED	Surge Protection	Wiring Figure	Screw Size/ Torque	Weight (lbs)	Agency Approval				
SC18-LS24-3	\$11.00	24 ±20%	max 4A	67	18 AWG	0.23	yes	zener diode (D-Z DO-15 47V 2W)	7	m3-0.5x30mm/ 0.4 Nm (3.5 in lb)	0.44	CSA (080128-0-000)				
SC18-LS24-5	\$13.00										0.69					
SC18-LS110-3	\$13.50	110 ±10%	max 1A					zener diode (D-Z DO-41 ZY200 2W)			0.44					
SC18-LS110-5	\$16.00										0.69					
SC18-3	\$9.75	230	max 10A				no	none	2		0.44					
SC18-5	\$12.00							0.69								
SC18-LS24-0	\$9.50	24 ±20%	max 4A	65	Solid 12 AWG Stranded 14 AWG w/Ferrule 16 AWG	gland size 0.24 to 0.32	yes	zener diode (D-Z DO-15 47V 2W)	4	m3-0.5x42mm/ 0.5 Nm (4.4 in lb)	0.07	none				
SC18-LS110-0	\$10.00	110 ±10%	max 1A						mov (SIOV S10 K130)		5		0.07			
SC18-0	\$7.50	230	max 10A					no	none		9		0.07			

Please note: The above parts are not compatible with the AVP and AVS series valves, which have 11mm DIN plugs.

Last digit in part number denotes cable length in meters, a 0 indicates field termination.

Solenoid Valve Cables and Connectors Wiring Diagrams

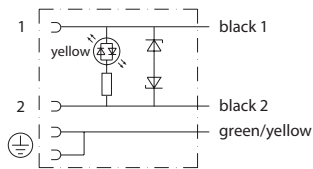

Figure No. 1

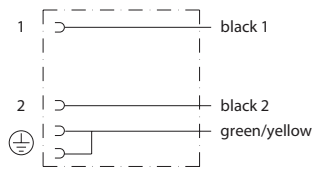

Figure No. 2

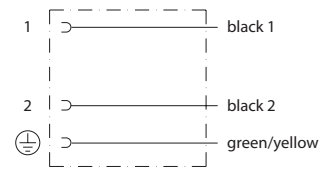

Figure No. 3

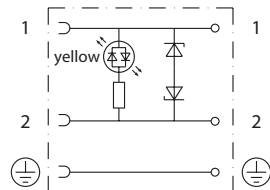

Figure No. 4

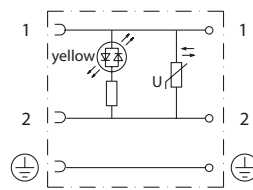

Figure No. 5

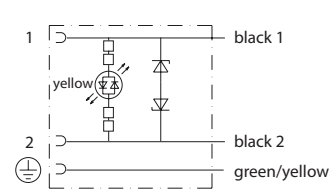

Figure No. 6

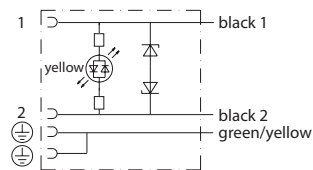

Figure No. 7

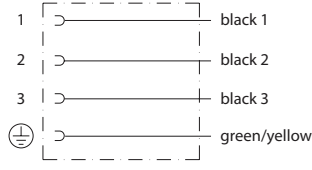

Figure No. 8

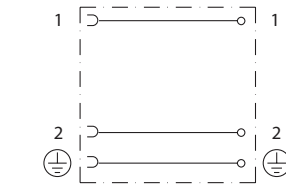

Figure No. 9

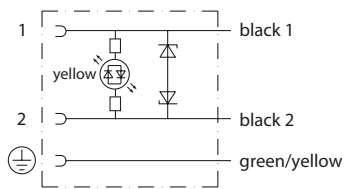

Figure No. 10