



# Colored Nylon Cable Ties

These colored Nylon 6.6 cable ties are slotted and held in place by the resistance of the elastic tooth against the rack. The tail of the strap is pulled through the head to form a noose that can only be tightened.

Used to fix and seal. The work load is calculated using a safety coefficient of no less than 2. A preload of no higher than 10% of the work load should be applied.

These cable ties are resistant to solvents and reagents, oil, gasoline, and hydrocarbons when used at low temperatures, in low concentrations, and for short periods of time.



- UL 94: V2 self-extinguishing nylon
- Halogen-free
- Designed for indoor applications
- Rounded edges to avoid cable damage
- Operating temperature:  
-40° to +85°C [-40° to +185°F]

Standard Colored Nylon Cable Ties													
Part Number	Pcs/Bag	Price	Color	Length		Width		Min. Bundle Ø		Max. Bundle Ø		Tensile Strength	
				mm	in	mm	in	mm	in	mm	in	Kg	lb
<b>SEL. 10.202</b>	100	\$1.00	red	100	3.94	2.5	0.10	2	0.08	24	0.94	11	24.25
<b>SEL. 11.202</b>	100	\$1.00	blue	100	3.94	2.5	0.10	2	0.08	24	0.94	11	24.25
<b>SEL. 12.202</b>	100	\$1.00	green	100	3.94	2.5	0.10	2	0.08	24	0.94	11	24.25
<b>SEL. 14.202</b>	100	\$1.00	yellow	100	3.94	2.5	0.10	2	0.08	24	0.94	11	24.25
<b>SEL. 21.202</b>	100	\$1.00	gray	100	3.94	2.5	0.10	2	0.08	24	0.94	11	24.25
<b>SEL. 10.210</b>	100	\$1.00	red	140	5.51	3.5	0.14	3	0.12	36	1.42	20	44.09
<b>SEL. 11.210</b>	100	\$1.00	blue	140	5.51	3.5	0.14	3	0.12	36	1.42	20	44.09
<b>SEL. 12.210</b>	100	\$1.00	green	140	5.51	3.5	0.14	3	0.12	36	1.42	20	44.09
<b>SEL. 14.210</b>	100	\$1.00	yellow	140	5.51	3.5	0.14	3	0.12	36	1.42	20	44.09
<b>SEL. 21.210</b>	100	\$1.00	gray	140	5.51	3.5	0.14	3	0.12	36	1.42	20	44.09
<b>SEL. 10.223</b>	100	\$2.00	red	200	7.87	4.5	0.18	3	0.12	51	2.01	28	61.73
<b>SEL. 11.223</b>	100	\$2.00	blue	200	7.87	4.5	0.18	3	0.12	51	2.01	28	61.73
<b>SEL. 12.223</b>	100	\$2.00	green	200	7.87	4.5	0.18	3	0.12	51	2.01	28	61.73
<b>SEL. 14.223</b>	100	\$2.00	yellow	200	7.87	4.5	0.18	3	0.12	51	2.01	28	61.73
<b>SEL. 21.223</b>	100	\$2.00	gray	200	7.87	4.5	0.18	3	0.12	51	2.01	28	61.73
<b>SEL. 10.425</b>	100	\$3.00	red	280	11.02	4.5	0.18	5	0.20	76	2.99	28	61.73
<b>SEL. 11.425</b>	100	\$3.00	blue	280	11.02	4.5	0.18	5	0.20	76	2.99	28	61.73
<b>SEL. 12.425</b>	100	\$3.00	green	280	11.02	4.5	0.18	5	0.20	76	2.99	28	61.73
<b>SEL. 14.425</b>	100	\$3.00	yellow	280	11.02	4.5	0.18	5	0.20	76	2.99	28	61.73
<b>SEL. 21.425</b>	100	\$3.00	gray	280	11.02	4.5	0.18	5	0.20	76	2.99	28	61.73



# Tools and Accessories

## Cable Tie Cutting Tool

The special angle of this cutter's tips enables clean cuts of the ties to sizes between 2.5 and 12.5 mm in width, maintaining the wired electric cables intact. The cutter can also be used for cutting cables.



## Collar Fastening Metal Plier

This tool makes it easier to tighten and cut collars. Use with Double-headed Cable Ties. Leaves a short length of tail close to the head. For use with up to 9mm wide cable ties.



## Cable Tie Gun Installation Tool

For use with cable ties up to 5mm wide. This tool helps to adjust the preload and cut the tie. Tightening torque of 2.5 kg to 12kg.



## Bi-directional Nylon Square Bases



**BAS.xMT.507**



**BAS.x.406**

*Note: Screw/mount not included*

Bi-directional Nylon Square Bases						
Part Number	Pcs/ Bag	Price	Color	Dual Adhesive	Dimensions	
					A	B
<b>BAS.2MT.507</b>	100	\$5.50	natural	Yes	18.8 mm [0.74 in]	4.4 mm [0.17 in]
<b>BAS.3MT.507</b>	100	\$5.50	black	Yes		
<b>BAS.2MT.508</b>	100	\$7.50	natural	Yes	26.5 mm [1.04 in]	5.9 mm [0.23 in]
<b>BAS.3MT.508</b>	100	\$7.50	black	Yes		
<b>BAS.2.406</b>	100	\$2.50	natural	No		
<b>BAS.3.406</b>	100	\$2.50	black	No		

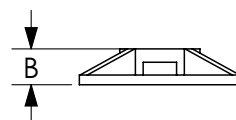
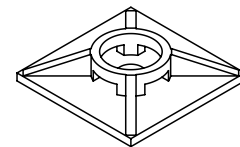
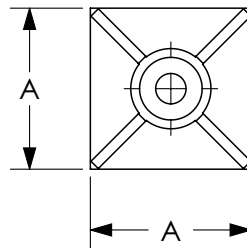



# Cable Ties Family Overview

## Standard Nylon Cable Ties



SapiSelco standard Nylon 6.6 cable ties are slotted and held in place by the resistance of the elastic tooth against the rack. These cable ties are resistant to solvents and reagents, oil, gasoline, and hydrocarbons when used at low temperatures, in low concentrations, and for short periods of time.

## Colored Nylon Cable Ties



SapiSelco colored Nylon 6.6 cable ties are useful in applications that require distinct identifiers. These ties are colored with inorganic dyes and are resistant to solvents and reagents, oil, gasoline, and hydrocarbons when used at low temperatures, in low concentrations, and for short periods of time.

## Stainless Steel Tooth Ties



SapiSelco stainless steel tooth ties are forged from nylon and hardened stainless steel with added Molybdenum. This ensures extremely high mechanical strength and optimal resistance to corrosion. A single central raised section makes this tie particularly flexible, while guaranteeing maximum strength at the same time.

## UV Resistant Cable Ties



Exposure to sun and ultraviolet rays causes deterioration in nylon. SapiSelco specialty Nylon UV Resistant cable ties can resist and endure the harsh conditions of outdoor applications for up to 10 years. These ties can withstand temperatures up to 125°C [257°F].

## Metal Detector Readable Cable Ties



These ties are fabricated with a special composite of 6.6 polyamide and metal powder and are sensitive to electromagnetic fields. They are recommended in the food, pharmaceutical and chemical industry. They are useful in applications where, for safety reasons, it is necessary for a metal detector to be able to detect even very small fragments of these ties that may be mixed in with products.

## Specialty Cable Ties



Re-Openable Push Button



Screw Mount



Button Hole



Marker Ties



Double-headed (Collars)

## Tools and Accessories



Cable Tie Cutting Tool



Collar Fastening Metal Plier



Cable Tie Gun Installation Tool



Bi-directional Nylon Square Bases