

Sockets for QL/QM Series Relays

SQL08D



Din-rail mounting, DPDT, for use with QL2 series relays

\$4.00

SQL14D



Din-rail mounting, 4PDT, for use with QL4 series relays

\$4.50

SQM08D



Din-rail mounting, DPDT, for use with QM2 series relays

\$3.50

SQM14D



Din-rail mounting, 4PDT, for use with QM4 series relays

\$3.50

Holding Clips

Holding clips for the QL2, QL4, QM2 and QM4 series relays can be removed by pushing the side of the inserting hole with a sharp object.

Note: Order sockets separately; holding clips are included with sockets.

Holding Clip Dimensions mm [in]

Holding clip for QL4 series relays is included with SQL14D sockets.

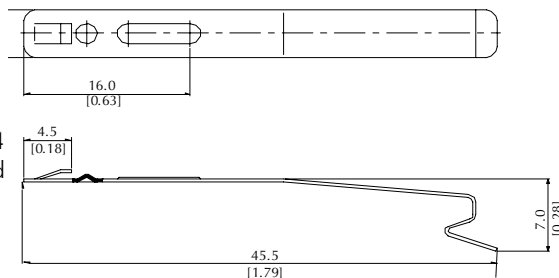

Insert holding clip into the slots provided on the socket.

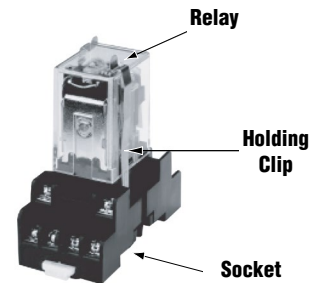

Holding Clip Dimensions mm [in]

Holding clip for QL2, QM2 and QM4 series relays is included with SQL08D, SQM08D and SQM14D sockets.

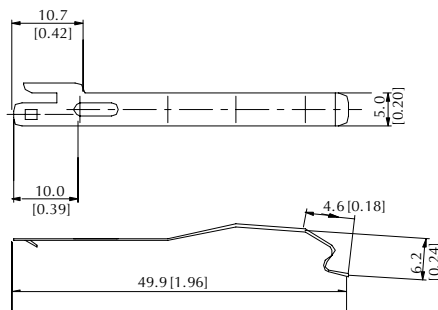

Socket Dimensions for QL/QM Series Relays

Dimensions

mm

Figure 3
SQL08D (for QL2 Series Relays)

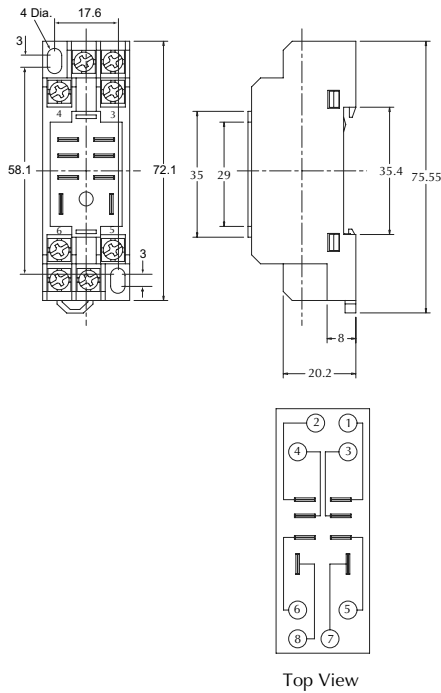

Figure 4
SQL14D (for QL4 Series Relays)

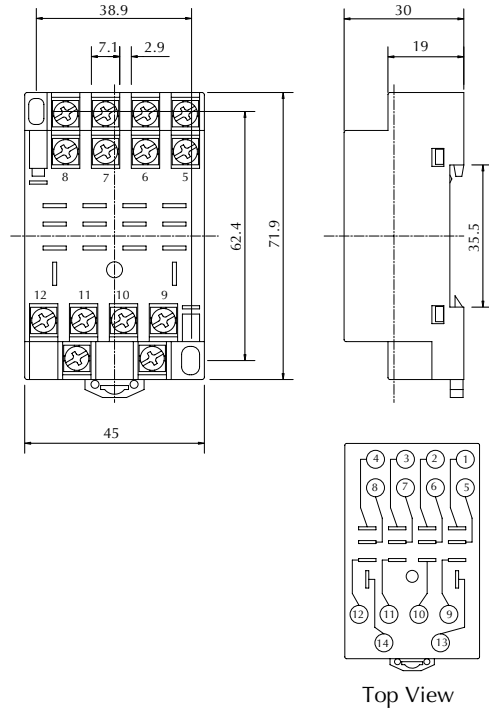

Figure 5
SQM08D (for QM2 Series Relays)

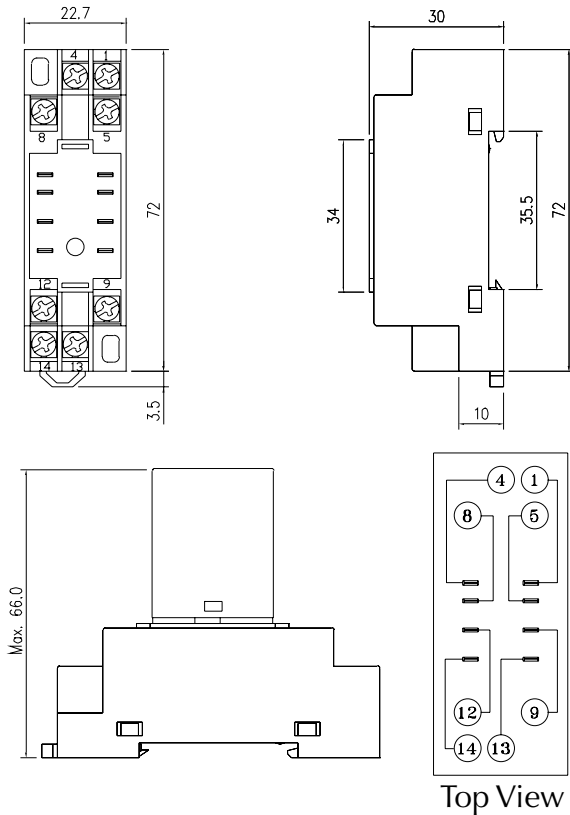

Figure 6
SQM14D (for QM4 Series Relays)

