

prosense® RTD Spring-Loaded Probes with Hex Nipple

**CHSC-AL-1****CHTB-3****Accessories**

Overview

- Spring-loaded for positive tip contact in thermowells
- 100 ohm platinum RTD 3-wire element
- Class A accuracy
- 1/4" diameter, 316 stainless steel sheath to protect against harsh environments
- RTD element encased in alumina powder insulation provides excellent vibration dampening and heat transfer
- 4", 6", or 12" probe length
- 1/2" x 1/2" NPT hex nipple allows easy replacement of existing probes and connection to a wiring junction box
- Made in the USA

RTD Spring-Loaded Probes with Hex Nipple

Part Number	Pcs/Pkg	Wt (lb)	Price	Type	Probe Diameter (O.D.)	Probe Length	Temperature Sensing Range	Mounting
RTD1-H04L01-02	1	0.5	\$81.00	PT 100, 3-wire	1/4"	4"	-50 to 300°C (-58 to 572°F)	Integral 1/2" x 1/2" NPT Hex Nipple, 316 SS
RTD1-H06L01-02			\$85.00			6"		
RTD1-H12L01-02			\$91.00			12"		

Technical Specifications

Sensing Element	Single 100Ω platinum (Pt 100), 3-wire; TCR = 0.00385 Ω/Ω/°C
Initial Accuracy	Class A $\pm[0.15 + 0.002 t]$ °C
Probe	ø1/4", 316 stainless steel sheath, single RTD is embedded in alumina powder
Response Time	7 seconds, 63% of a 25 to 77°C step change (ASTM E1137)
Wiring	3-inch stranded 24 AWG wire leads with terminal pins, Kapton insulated

Note: See end of section for thermowells to fit these unit.



Note: Check the chemical compatibility of the sensor's wetted parts with the medium to be measured.

Dimensions

inches [mm]

RTD1-HXXL01-02

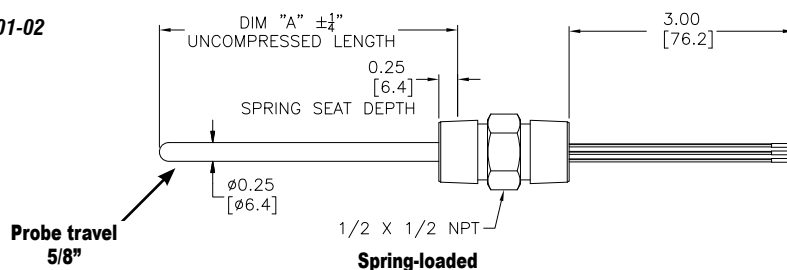

Wiring Information

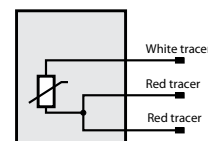

TABLE A

PART NUMBER	DIM "A"
RTD1-H04L01-02	4.00[101.6]
RTD1-H06L01-02	6.00[152.4]
RTD1-H12L01-02	12.00[304.8]

prosense®

RTD Spring-Loaded Probes with
Hex Nipple

Accessories

Part No.	Description	Pcs/Pkg	Price
CHSC-AL-1	ProSense general purpose screw cover connection head for temperature probes, die-cast aluminum, 1/2 inch NPT process opening, 3/4 inch NPT conduit opening, NEMA 4X, IP66 rated, graphite gasket, maximum temperature rating of 825°F (440°C). Order probe and terminal base separately.	1	\$24.50
CHTB-3	ProSense ceramic terminal base, three brass terminals with stainless steel screws, for use with ProSense temperature probe connection heads, two mounting screws included.	1	\$7.50

Note: Full listing of accessories available at the end of this section. RTD extension lead wire available at www.automationdirect.com

Dimensions

inches [mm]

CHSC-AL-1

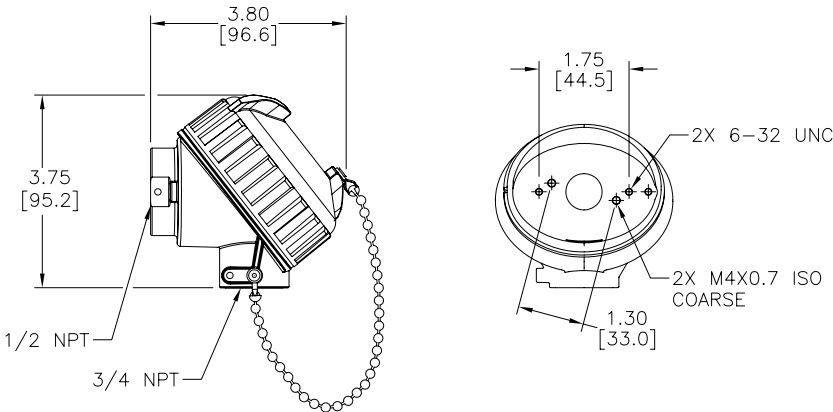

CHTB-3

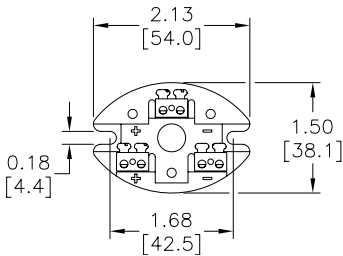

proSense® Thermowells



Overview

- Thermowells designed for use with ProSense thermocouple and RTD probes or ProSense Thermometers eliminate the need for a separate probe mounting fitting or adapter

RTDTW Series Thermowells

- Welded 316 stainless steel construction
- 1/2" NPT male process threads
- 3-year warranty

TW Series Thermowells

- Drilled bar stock one piece construction (no welds) from 304 or 316 stainless steel
- 1/2" and 3/4" NPT male process threads available
- Designs and fabrication comply with ASME B31.1 and boiler and pressure vessel codes
- Material complies with NACE MR 0175 / ISO 15156
- CRN registered for all Canadian provinces
- 1-year warranty



Thermowells for Thermocouples -TW Series										
Part Number	Pcs/ Pkg	Wt(lb)	Price	I.D.	Overall Length/"U" Length	Male Process Threads	Female Probe Threads	Wetted Material	Temperature/ Pressure Rating	Use With Probe or Thermometer
TW025-01	1	0.4	\$31.00	0.26"	2-3/4" / 1"	1/2" NPT	1/2" NPT	304 SS	304SS: 1000°F max; 3400psi max 316SS: 1000°F max; 5200psi max	See Sensor Compatibility Table
TW025-03	1	0.4	\$36.00			1/2" NPT		316 SS		
TW04-01	1	0.5	\$36.00		4-1/4" / 2-1/2"	1/2" NPT		304 SS		
TW04-02	1	0.5	\$36.00			3/4" NPT		304 SS		
TW04-03	1	0.5	\$45.00			1/2" NPT		316 SS		
TW04-04	1	0.5	\$45.00			3/4" NPT		316 SS		
TW06-01	1	0.7	\$49.50		6-1/4" / 4-1/2"	1/2" NPT		304 SS		
TW06-02	1	0.7	\$49.50			3/4" NPT		304 SS		
TW06-03	1	0.7	\$57.00			1/2" NPT		316 SS		
TW06-04	1	0.7	\$57.00			3/4" NPT		316 SS		
TW09-01	1	1.0	\$71.00		9-1/4" / 7-1/2"	1/2" NPT		304 SS		
TW09-03	1	1.0	\$82.00			1/2" NPT		316 SS		
TW12-01	1	1.2	\$80.00		12-1/4" / 10-1/2"	1/2" NPT		304 SS		
TW12-02	1	1.2	\$80.00			3/4" NPT		304 SS		
TW12-03	1	1.2	\$98.00			1/2" NPT		316 SS		
TW12-04	1	1.2	\$98.00			3/4" NPT		316 SS		

prosense® Thermowells

Thermowells for Thermocouples -RTDTW Series										
Part Number	Pcs/ Pkg	Wt(lb)	Price	I.D.	Overall Length	Male Process Threads	Female Probe Threads	Wetted Material	Temperature/ Pressure Rating	Use With
<u>RTDTW-06-010-50N</u>	1	0.10	\$43.00	7 mm (0.28")	113mm (4.4")	1/2" NPT	1/4" NPT	316 SS	600°F (315°C) max; 232 psi (16 bar) max	XTP-160-N40140F XTP-160-0300F XTP-160-0100C RTD0100-06-010-H CF06-25N fitting
<u>RTDTW-06-020-50N</u>	1	0.20	\$46.00		213mm (8.4")					XTP-260-N40140F XTP-260-0300F XTP-260-0100C RTD0100-06-020-H CF06-25N fitting
<u>RTDTW-06-030-50N</u>	1	0.30	\$51.00		313mm (12.3")					XTP-360-N40140F XTP-360-0300F XTP-360-0100C RTD0100-06-030-H CF06-25N fitting
<u>RTDTW-10-010-50N</u>	1	0.10	\$43.00	11 mm (0.43")	92mm (3.62")	1/2" NPT	1/2" NPT			RTD0100-10-010-H CF10-50N fitting
<u>RTDTW-10-030-50N</u>	1	0.22	Retired		292mm (11.48")					CF10-50N fitting



Note: Check the chemical compatibility of the thermowell's wetted parts with the medium to be measured.



Note: Response time will be slower when installed in a thermowell. Be sure to install the probe so that it contacts the end of the thermowell for faster response. Thermal compound may be used depending on application

Probe & Thermowell Assembly Example

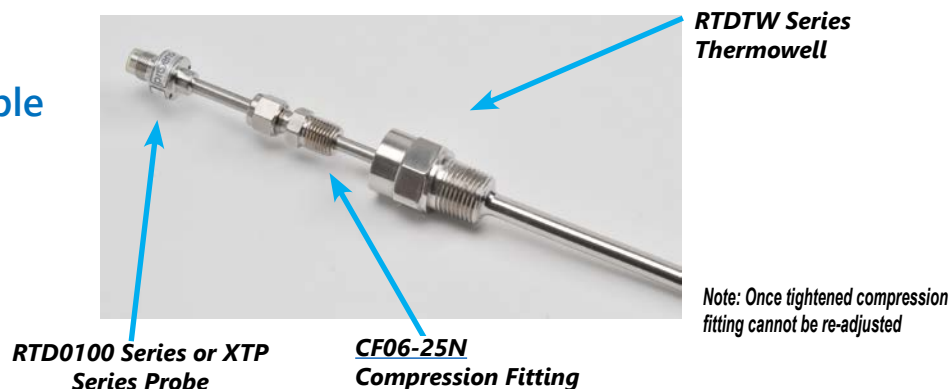

Spring-loaded Thermocouple or RTD and Thermowell Assembly Example



- Using spring-loaded probe design ensures positive tip contact with the bottom of the thermowell.
- Probes with hex nipple thread directly into thermowell. No additional probe mounting fittings are required.

prosense® Thermowells

Dimensions

inches [mm]

TW04-XX & TW025-XX

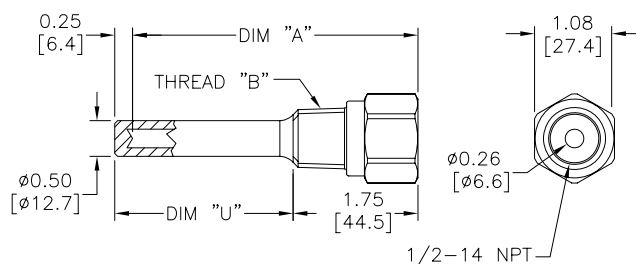

TABLE A			
PART NUMBER	DIM "A"	THREAD "B" NPT	DIM "U"
TW025-01	2.50[63.5]	1/2-14	1.00[25.5]
TW025-03	2.50[63.5]	1/2-14	
TW04-01	4.00[101.6]	1/2-14	2.50[63.5]
TW04-02	4.00[101.6]	3/4-14	
TW04-03	4.00[101.6]	1/2-14	
TW04-04	4.00[101.6]	3/4-14	

Dimensions

inches [mm]

TW06-XX

TW09-XX

TW12-XX

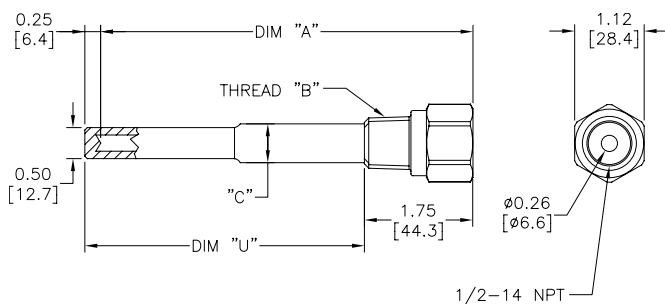

TABLE A				
PART NUMBER	DIM "A"	THREAD "B" NPT	DIM "C"	DIM "U"
TW06-01	6.00[152.4]	1/2-14	0.63[15.9]	4.50[114.3]
TW06-02	6.00[152.4]	3/4-14	0.75[19.1]	
TW06-03	6.00[152.4]	1/2-14	0.63[15.9]	
TW06-04	6.00[152.4]	3/4-14	0.75[19.1]	7.50[190.5]
TW09-01	9.00[228.6]	1/2-14	0.63[15.9]	
TW09-03	9.00[228.6]	1/2-14	0.63[15.9]	10.50[266.7]
TW12-01	12.00[304.8]	1/2-14	0.63[15.9]	
TW12-02	12.00[304.8]	3/4-14	0.75[19.1]	
TW12-03	12.00[304.8]	1/2-14	0.63[15.9]	
TW12-04	12.00[304.8]	3/4-14	0.75[19.1]	

prosense® Thermowells

Dimensions

mm [inches]

RTDTW-06 Series

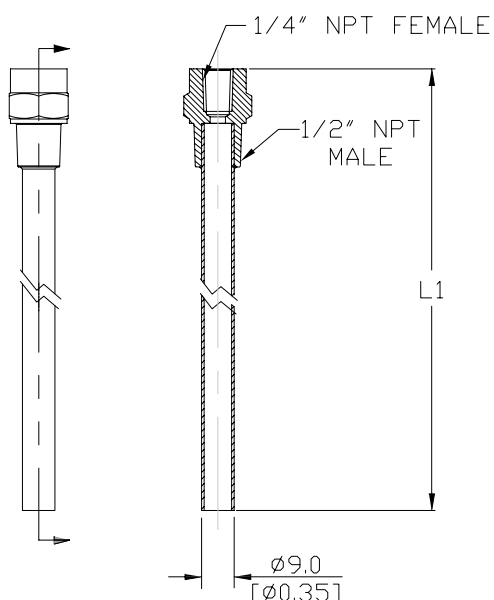

Part Number	L1
RTDTW-06-010-50N	113mm [4.4]
RTDTW-06-020-50N	213mm [8.4]
RTDTW-06-030-50N	313mm [12.3]

Torque threads to 40 lb-ft [54.23 Nm]*

* Torque values are for reference. Actual torque required for a proper seal of NPT threads is influenced by tolerance, sealant, lubricant, etc.

RTDTW-10 Series

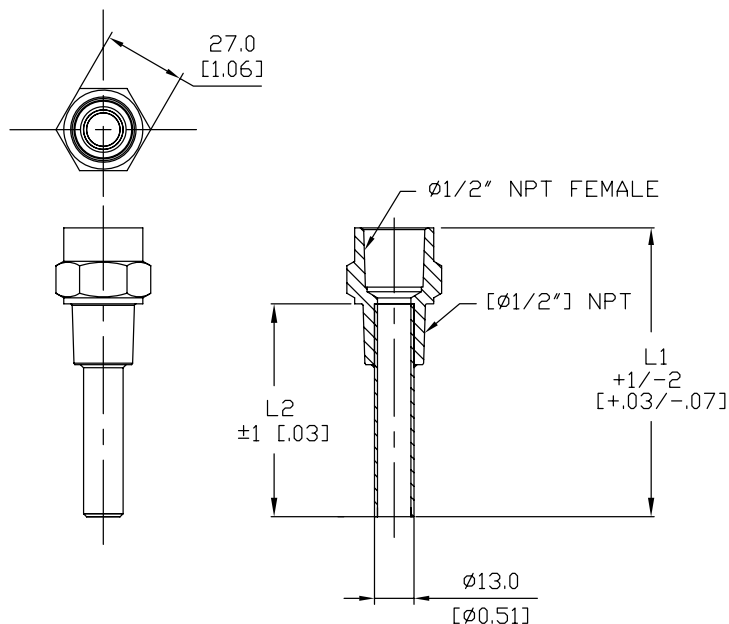









Part Number	L1	L2
RTDTW-10-030-50N	92mm [3.62]	70mm [2.75]
RTDTW-10-050-50N	292mm [11.48]	270mm [10.6]

Torque threads to 40 lb-ft [54.23 Nm]*

prosense® Thermowells

TW Series Thermowells Sensor Compatibility Table

	Junction Box	Connection Head	Hex Nipple	Attached Plug	Lead Wire Transition	M12	Thermometer
Thermowell							
<u>TW025-01</u> <u>TW025-03</u>	-	-	-	-	-	-	T30-N40160-25C T30-0250-25C T30-50500-25C T30-150750-25C T50-N40160-25A T50-0250-25A T50-50500-25A T50-150750-25A
<u>TW04-01</u> <u>TW04-02</u> <u>TW04-03</u> <u>TW04-04</u>	NTC10K3-JB04-03	RTD1-C04-03 THMJ-C04-03 THMK-C04-03 NTC10K3-C04-03	RTD1-H04L01-02 THMJ-H04L01-02 THMK-H04L01-02 NTC10K3-H04L01-02	RTD1-P06-01 w/ CF14-50N THMJ-P06-02 w/ CF14-50N THMK-P06-02 w/ CF14-50N NTC10K3-P06-02 w/ CF14-50N	RTD1-T06L06-01 w/ CF14-50N THMJ-T06L06-02 w/ CF14-50N THMK-T06L06-02 w/ CF14-50N NTC10K3-T06L06-02 w/CF14-50N	RTD1-50N-100-H RTD0100-06-010-H w/CF14-50N XTP-160-N40140F w/CF14-50N XTP-160-0300F w/CF14-50N XTP-160-0100C w/CF14-50N XTP50N-100-N40140F XTP50N-100-0300F XTP50N-100-0100C ETS50N-100-1001 ETS50N-100-1003	T30-N40160-4C T30-0250-4C T30-50500-4C T30-150750-4C T50-N40160-4A T50-0250-4A T50-50500-4A T50-150750-4A
<u>TW06-01</u> <u>TW06-02</u> <u>TW06-03</u> <u>TW06-04</u>	NTC10K3-JB06-03	RTD1-C06-03 THMJ-C06-03 THMK-C06-03 NTC10K3-C06-03	RTD1-H06L01-02 THMJ-H06L01-02 THMK-H06L01-02 NTC10K3-H06L01-02	RTD1-P12-01 w/ CF14-50N THMJ-P12-02 w/ CF14-50N THMK-P12-02 w/ CF14-50N NTC10K3-P12-02 w/ CF14-50N	RTD1-T12L06-01 w/ CF14-50N THMJ-T12L06-02 w/ CF14-50N THMK-T12L06-02 w/ CF14-50N NTC10K3-T12L06-02 w/CF14-50N	RTD1-50N-150-H RTD0100-06-020-H w/CF14-50N XTP-260-N40140F w/CF14-50N XTP-260-0300F w/CF14-50N XTP-260-0100C w/CF14-50N XTP50N-150-N40140F XTP50N-150-0300F XTP50N-150-0100C ETS50N-150-1001 ETS50N-150-1003	T30-N40160-6C T30-0250-6C T30-50500-6C T30-150750-6C T50-N40160-6A T50-0250-6A T50-50500-6A T50-150750-6A
<u>TW09-01</u> <u>TW09-03</u>	-	-	-	-	-	-	T50-N40160-9A T50-0250-9A T50-50500-9A T50-150750-9A
<u>TW12-01</u> <u>TW12-02</u> <u>TW12-03</u> <u>TW12-04</u>	NTC10K3-JB12-03	RTD1-C12-03 THMJ-C12-03 THMK-C12-03 NTC10K3-C12-03	RTD1-H12L01-02 THMJ-H12L01-02 THMK-H12L01-02 NTC10K3-H12L01-02	RTD1-P18-01 w/ CF14-50N THMJ-P18-02 w/ CF14-50N THMK-P18-02 w/ CF14-50N NTC10K3-P18-02 w/ CF14-50N	RTD1-T18L06-01 w/ CF14-50N THMJ-T18L06-02 w/ CF14-50N THMK-T18L06-02 w/ CF14-50N NTC10K3-T18L06-02 w/CF14-50N	RTD0100-06-030-H w/CF14-50N XTP-360-N40140F w/CF14-50N XTP-360-0300F w/CF14-50N XTP-360-0100C w/CF14-50N	-

 Note: Response time will be slower when installed in a thermowell. Be sure to install the probe so that it contacts the end of the thermowell for faster response. Thermal compound may be used depending on application.



Thermowells Sanitary Clean-in-Place (CIP)



STW06-01

Overview

- Sanitary Clean-In-Place 3-A approved thermowells allow the use of standard temperature sensors in hygienic applications
- All wetted parts are 316 stainless steel
- Surface finish that meets or exceeds 32µin Ra
- Up to 1500/1200 psi (103/83 bar) at 70/250 °F (21/121 °C) dependent on clamp and seal assembly.
- Bore diameter of 0.260" to accommodate sensing probes with a 0.252" maximum diameter
- Probes with integral 1/2" male NPT process threads mount directly into the thermowell. Probes without threads require a compression fitting with 1/2" male NPT threads.



Thermowells Sanitary Clean-in-Place (CIP)									
Part Number	Pcs/Pkg	Wt(lb)	Price	I.D.	Overall Length/"U" Length	Process Connection	Female Probe Threads	Wetted Material	Use With
<u>STW04-01</u>	1	0.75	\$106.00	ø0.260	4-1/4" / 2-1/2"	1-1/2" tri-clamp	1/2" NPT	316 stainless steel	See Sensor Compatibility Table
<u>STW06-01</u>	1	0.88	\$114.00		6-1/4" / 4-1/2"				
<u>STW12-01</u>	1	1.13	\$159.00		12-1/4" / 10-1/2"				
<u>STW04-02</u>	1	0.75	\$118.00		4-1/4" / 2-1/2"	2" tri-clamp			
<u>STW06-02</u>	1	0.88	\$127.00		6-1/4" / 4-1/2"				
<u>STW12-02</u>	1	1.13	\$164.00		12-1/4" / 10-1/2"				



Note: Check the chemical compatibility of the thermowell's wetted parts with the medium to be measured.



Note: Response time will be slower when installed in a thermowell. Be sure to install the probe so that it contacts the end of the thermowell for faster response. Thermal compound may be used depending on application

Probe & Thermowell Assembly Example

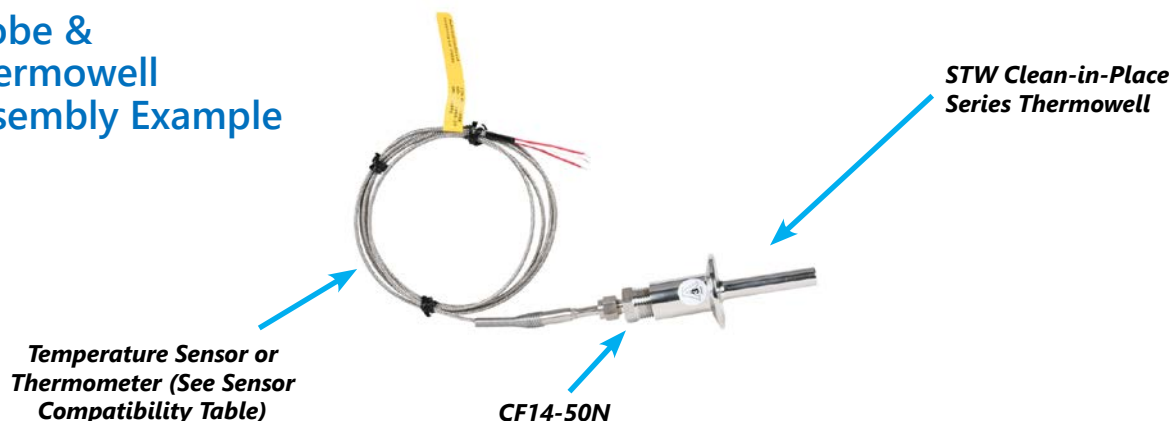

prosense® Thermowells Sanitary Clean-in-Place (CIP)

Spring-loaded Thermocouple or RTD and Thermowell Assembly Example



- Using spring-loaded probe design ensures positive tip contact with the bottom of the thermowell.
- Probes with hex nipple thread directly into thermowell. No additional probe mounting fittings are required.

Dimensions

inches [mm]

STWXX-XX

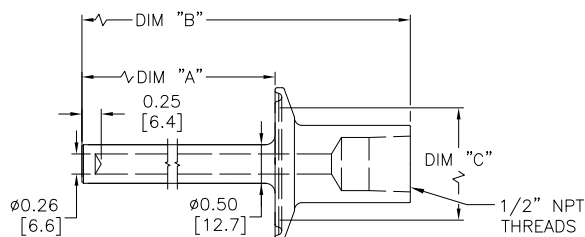









TABLE A

PART NUMBER	DIM "A"	DIM "B"	DIM "C"
STW04-01	2.50[63.5]	4.25[108.0]	1.50[38.1]
STW06-01	4.50[114.3]	6.25[158.8]	1.50[38.1]
STW12-01	10.50[266.8]	12.25[311.3]	1.50[38.1]
STW04-02	2.50[63.5]	4.25[108.0]	2.00[50.8]
STW06-02	4.50[114.3]	6.25[158.5]	2.00[50.8]
STW12-02	10.50[266.8]	12.25[311.3]	2.00[50.8]



Thermowells Sanitary Clean-in-Place (CIP)

Thermowells Sanitary Clean-in-Place (CIP) Sensors Compatibility Table							
	Junction Box	Connection Head Sensor	Hex Nipple Sensor	Attached Plug Sensor	Lead Wire Transition Sensor	M12 Sensor	Thermometer
Thermowell							
STW04-01	NTC10K3-JB04-03	RTD1-C04-03 THMJ-C04-03 THMK-C04-03 NTC10K3-C04-03	RTD1-H04L01-02 THMJ-H04L01-02 THMK-H04L01-02 NTC10K3-H04L01-02	RTD1-P06-01 w/ CF14-50N THMJ-P06-02 w/ CF14-50N THMK-P06-02 w/ CF14-50N NTC10K3-P06-02 w/ CF14-50N	RTD1-T06L06-01 w/ CF14-50N THMJ-T06L06-02 w/ CF14-50N THMK-T06L06-02 w/ CF14-50N	RTD1-50N-100-H RTD0100-06-010-H w/CF14-50N XTP-160-N40140F w/CF14-50N XTP-160-0300F w/CF14-50N XTP-160-0100C w/CF14-50N XTP50N-100-N40140F XTP50N-100-0300F XTP50N-100-0100C ETS50N-100-1001 ETS50N-100-1003	T30-N40160-4C T30-0250-4C T30-50500-4C T30-150750-4C T50-N40160-4A T50-0250-4A T50-50500-4A T50-150750-4A
STW06-01	NTC10K3-JB06-03	RTD1-C06-03 THMJ-C06-03 THMK-C06-03 NTC10K3-C06-03	RTD1-H06L01-02 THMJ-H06L01-02 THMK-H06L01-02 NTC10K3-H06L01-02	RTD1-P12-01 w/ CF14-50N THMJ-P12-02 w/ CF14-50N THMK-P12-02 w/ CF14-50N NTC10K3-P12-02 w/ CF14-50N	RTD1-T12L06-01 w/ CF14-50N THMJ-T12L06-02 w/ CF14-50N THMK-T12L06-02 w/ CF14-50N	RTD1-50N-150-H RTD0100-06-020-H w/CF14-50N XTP-260-N40140F w/CF14-50N XTP-260-0300F w/CF14-50N XTP-260-0100C w/CF14-50N XTP50N-150-N40140F XTP50N-150-0300F XTP50N-150-0100C ETS50N-150-1001 ETS50N-150-1003	T30-N40160-6C T30-0250-6C T30-50500-6C T30-150750-6C T50-N40160-6A T50-0250-6A T50-50500-6A T50-150750-6A
STW12-01	NTC10K3-JB12-03	RTD1-C12-03 THMJ-C12-03 THMK-C12-03 NTC10K3-C12-03	RTD1-H12L01-02 THMJ-H12L01-02 THMK-H12L01-02 NTC10K3-H12L01-02	RTD1-P18-01 w/ CF14-50N THMJ-P18-02 w/ CF14-50N THMK-P18-02 w/ CF14-50N NTC10K3-P18-02 w/ CF14-50N	RTD1-T18L06-01 w/ CF14-50N THMJ-T18L06-02 w/ CF14-50N THMK-T18L06-02 w/ CF14-50N	RTD0100-06-030-H w/CF14-50N XTP-360-N40140F w/CF14-50N XTP-360-0300F w/CF14-50N XTP-360-0100C w/CF14-50N	-
STW04-02	NTC10K3-JB04-03	RTD1-C04-03 THMJ-C04-03 THMK-C04-03 NTC10K3-C04-03	RTD1-H04L01-02 THMJ-H04L01-02 THMK-H04L01-02 NTC10K3-H04L01-02	RTD1-P06-01 w/ CF14-50N THMJ-P06-02 w/ CF14-50N THMK-P06-02 w/ CF14-50N NTC10K3-P06-02 w/ CF14-50N	RTD1-T06L06-01 w/ CF14-50N THMJ-T06L06-02 w/ CF14-50N THMK-T06L06-02 w/ CF14-50N	RTD1-50N-100-H RTD0100-06-010-H w/CF14-50N XTP-160-N40140F w/CF14-50N XTP-160-0300F w/CF14-50N XTP-160-0100C w/CF14-50N XTP50N-100-N40140F XTP50N-100-0300F XTP50N-100-0100C ETS50N-100-1001 ETS50N-100-1003	T30-N40160-4C T30-0250-4C T30-50500-4C T30-150750-4C T50-N40160-4A T50-0250-4A T50-50500-4A T50-150750-4A
STW06-02	NTC10K3-JB06-03	RTD1-C06-03 THMJ-C06-03 THMK-C06-03 NTC10K3-C06-03	RTD1-H06L01-02 THMJ-H06L01-02 THMK-H06L01-02 NTC10K3-H06L01-02	RTD1-P12-01 w/ CF14-50N THMJ-P12-02 w/ CF14-50N THMK-P12-02 w/ CF14-50N NTC10K3-P12-02 w/ CF14-50N	RTD1-T12L06-01 w/ CF14-50N THMJ-T12L06-02 w/ CF14-50N THMK-T12L06-02 w/ CF14-50N	RTD1-50N-150-H RTD0100-06-020-H w/CF14-50N XTP-260-N40140F w/CF14-50N XTP-260-0300F w/CF14-50N XTP-260-0100C w/CF14-50N XTP50N-150-N40140F XTP50N-150-0300F XTP50N-150-0100C ETS50N-150-1001 ETS50N-150-1003	T30-N40160-6C T30-0250-6C T30-50500-6C T30-150750-6C T50-N40160-6A T50-0250-6A T50-50500-6A T50-150750-6A
STW12-02	NTC10K3-JB12-03	RTD1-C12-03 THMJ-C12-03 THMK-C12-03 NTC10K3-C12-03	RTD1-H12L01-02 THMJ-H12L01-02 THMK-H12L01-02 NTC10K3-H12L01-02	RTD1-P18-01 w/ CF14-50N THMJ-P18-02 w/ CF14-50N THMK-P18-02 w/ CF14-50N NTC10K3-P18-02 w/ CF14-50N	RTD1-T18L06-01 w/ CF14-50N THMJ-T18L06-02 w/ CF14-50N THMK-T18L06-02 w/ CF14-50N	RTD0100-06-030-H w/CF14-50N XTP-360-N40140F w/CF14-50N XTP-360-0300F w/CF14-50N XTP-360-0100C w/CF14-50N	-



Note: Response time will be slower when installed in a thermowell. Be sure to install the probe so that it contacts the end of the thermowell for faster response. Thermal compound may be used depending on application.



Connection Head and Ceramic Terminal Bases



Overview

- Cast aluminum NEMA 4X, IP66 screw cover head with captive gasket
- One turn cover removal & installation eliminates cross threading and saves time
- 3/4" NPT conduit opening with internal stop to prevent overtightening and installation damage
- Gripping ribs on cover edge
- Stainless steel cover chain
- Made in the USA

ProSense Aluminum Connection Head

Part Number	Description	Pcs/ Pkg	Wt(lb)	Price
CHSC-AL-1	ProSense general purpose screw cover connection head for temperature probes, die-cast aluminum, 1/2 NPT process opening, 3/4 NPT conduit opening, NEMA 4X, IP66 rated, graphite gasket, maximum temperature rating of 825°F (440°C)	1	1.0	\$24.50

Dimensions

inches [mm]

CHSC-AL-1

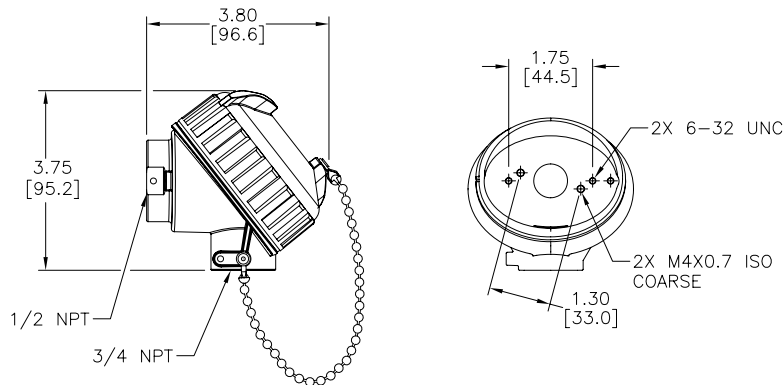

CHTB-2



CHTB-3

Overview

- Available with two terminals for thermocouples or three terminals for RTDs
- Fits **CHSC-AL-1** connection heads
- Ceramic base with brass terminals and stainless steel screws
- Accepts up to 12 AWG wire

Terminal Base for Connection Heads

Part Number	Description	Pcs/ Pkg	Wt(lb)	Price
CHTB-2	ProSense ceramic terminal base, two brass terminals with stainless steel screws, for use with ProSense temperature probe connection heads, two mounting screws included.	1	1.0	\$6.50
CHTB-3	ProSense ceramic terminal base, three brass terminals with stainless steel screws, for use with ProSense temperature probe connection heads, two mounting screws included.	1	1.0	\$7.50

Dimensions

inches [mm]

CHTB-2

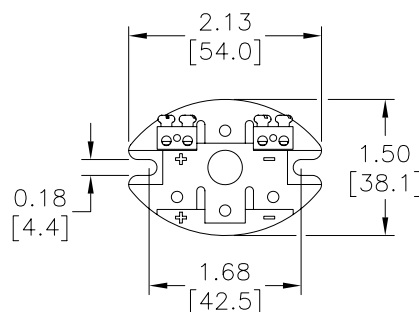

CHTB-3

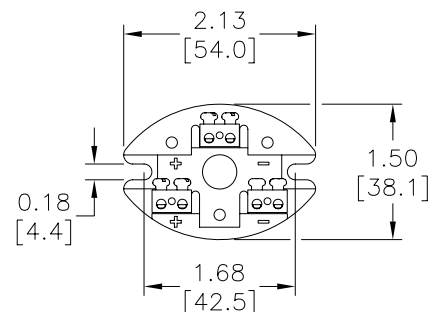

pro^{ense}® Compression Mounting Fittings for Temperature Probes

Compression Mounting Fittings for Temperature Probes				
Part Number	Description	Pcs/ Pkg	Wt(lb)	Price
<u>BCF18-125N</u>	Compression fitting, brass, for 1/8 inch diameter temperature probes, 1/8 inch NPT male thread	1	0.5	\$3.25
<u>BCF14-125N</u>	Compression fitting, brass, for 1/4 inch diameter temperature probes, 1/8 inch NPT male thread	1	0.5	\$3.25
<u>BCF18-25N</u>	Compression fitting, brass, for 1/8 inch diameter temperature probes, 1/4 inch NPT male thread	1	0.5	\$4.25
<u>BCF14-25N</u>	Compression fitting, brass, for 1/4 inch diameter temperature probes, 1/4 inch NPT male thread	1	0.5	\$4.25
<u>BCF18-50N</u>	Compression fitting, brass, for 1/8 inch diameter temperature probes, 1/2 inch NPT male thread	1	0.5	\$6.00
<u>BCF14-50N</u>	Compression fitting, brass, for 1/4 inch diameter temperature probes, 1/2 inch NPT male thread	1	0.5	\$6.50
<u>CF18-125N</u>	Compression fitting, 316 stainless steel, for 1/8 inch diameter temperature probes, 1/8 inch NPT male thread	1	0.5	\$8.00
<u>CF14-125N</u>	Compression fitting, 316 stainless steel, for 1/4 inch diameter temperature probes, 1/8 inch NPT male thread	1	0.5	\$8.00
<u>CF18-25N</u>	Compression fitting, 316 stainless steel, for 1/8 inch diameter temperature probes, 1/4 inch NPT male thread	1	0.5	\$9.25
<u>CF14-25N</u>	Compression fitting, 316 stainless steel, for 1/4 inch diameter temperature probes, 1/4 inch NPT male thread	1	0.5	\$9.25
<u>CF18-50N</u>	Compression fitting, 316 stainless steel, for 1/8 inch diameter temperature probes, 1/2 inch NPT male thread	1	0.5	\$13.50
<u>CF14-50N</u>	Compression fitting, 316 stainless steel, for 1/4 inch diameter temperature probes, 1/2 inch NPT male thread	1	0.5	\$14.00
<u>CFTF-18**</u>	Teflon™ ferrule for brass or stainless steel compression fittings and 1/8 diameter temperature probes	5	0.5	\$7.25
<u>CFTF-14**</u>	Teflon ferrule for brass or stainless steel compression fittings and 1/4 diameter temperature probes	5	0.5	\$7.75
<u>CF06-25N</u>	1/4 NPT stainless steel compression fitting for 0.24 inch (6 mm) diameter RTD probe with M12 connector.	1	0.18	\$33.00
<u>CF10-50N</u>	1/2 NPT stainless steel compression fitting for 10 mm (0.4 inch) diameter RTD probe with M12 connector.	1	0.20	\$34.00
<u>CF18-BC</u>	Bayonet compression fitting, for 1/8" diameter probe sheath sensors	1	0.1	\$10.50
<u>BB125N-50N</u>	Reducing bushing, brass, 1/2 MNPT x 1/8 FNPT, hex head	1	0.1	\$6.00



Note: Check the chemical compatibility of the sensor's wetted parts with the medium to be measured.

* Working pressure of compression fitting should not exceed 500 psi. However we recommend any pressure application use a thermowell

** Teflon has a max working temperature range of -400 to 500°F (-240 to 260°C)

[CF14-125N](#)



[CF14-50N](#)



[CF14-25N](#)



[CF18-BC](#)



[CF06-25N](#)



[CF10-50N](#)



[BCF18-125N](#)



[BCF18-25N](#)



[BCF18-50N](#)



[BB125N-50N](#)



[CFTF-14](#)



[CFTF-18](#)



pro^{sense}® Compression Mounting Fittings for Temperature Probes

BCF14-125N**BCF14-25N****BCF14-50N****CF18-25N****CF18-50N****CF18-125N**

Dimensions

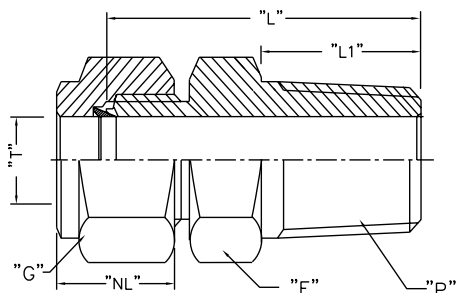

Note: All threaded connections should be hand tightened and then turned 1 to 2 full turns for proper sealing.

Actual torque required for a proper seal of NPT threads is influenced by tolerance, sealant, lubricant, etc.

ProSense Compression Fittings									
Part No.	Weight (lb)	Description	"T" Tube O.D.	"P" NPT(M)	"L" Body Length*	"L1" Thread Length**	"F" Body Hex**	"G" Nut Hex**	"NL" Nut Length**
BCF18-125N/CF18-125N	0.5	1/8" OD x 1/8" NPT(M)	0.128/0.132	1/8" NPT(M)	0.909"	0.393"	0.5"	0.433"	0.492"
BCF14-125N/CF14-125N	0.5	1/4" OD x 1/8" NPT(M)	0.253/0.257	1/8" NPT(M)	1.0"	0.393"	0.5"	0.559"	0.5"
BCF18-25N/CF18-25N	0.5	1/8" OD x 1/4" NPT(M)	0.128/0.132	1/4" NPT(M)	1.114"	0.551"	0.551"	0.433"	0.492"
BCF14-25N/CF14-25N	0.5	1/4" OD x 1/4" NPT(M)	0.253/0.257	1/4" NPT(M)	1.188"	0.551"	0.551"	0.559"	0.5"
BCF18-50N/CF18-50N	0.5	1/8" OD x 1/2" NPT(M)	0.128/0.132	1/2" NPT(M)	1.377"	0.748"	0.866"	0.433"	0.492"
BCF14-50N/CF14-50N	0.5	1/4" OD x 1/2" NPT(M)	0.253/0.257	1/2" NPT(M)	1.437"	0.748"	0.866"	0.559"	0.5"
CF06-25N	0.18	6 mm OD x 1/4" NPT(M)	0.236/0.240	1/4" NPT(M)	1.174"	0.59"	0.67"	0.55"	0.587"
CF10-50N	0.20	10 mm OD x 1/2" NPT(M)	0.394/0.399	1/2" NPT(M)	1.458"	0.55"	1.06"	0.75"	0.608"

Note: All dimensions are in inches

* w 0.07

** w 0.03

Note: Once the compression fitting has been fully tightened on the probe, the ferrule will be locked onto the probe and cannot be removed or reused.

**Working pressure of compression fitting should not exceed 500 psi. However we recommend any pressure application use a thermowell*



Scan the QR Code or click to view the CF06 & CF10 Compression Fitting Installation Instructions



Bayonet Mounting Adapter for Temperature Sensors

Bayonet Mounting Adapter for Temperature Sensors					
Part Number	Description	Material	Pcs/ Pkg	Wt(lb)	Price
<u>BA-078</u>	Bayonet adapter, 7/8 inch long, 7/16 inch outside diameter, 9/32 inch inside diameter, 1/8 inch MNPT	Stainless Steel (304)	1	0.5	\$1.75
<u>BA-100</u>	Bayonet adapter, 1 inch long, 7/16 inch outside diameter, 9/32 inch inside diameter, 1/8 inch MNPT		1	0.5	\$1.75
<u>BA-114</u>	Bayonet adapter, 1-1/4 inch long, 7/16 inch outside diameter, 9/32 inch inside diameter, 1/8 inch MNPT		1	0.5	\$2.25
<u>BA-112</u>	Bayonet adapter, 1-1/2 inch long, 7/16 inch outside diameter, 9/32 inch inside diameter, 1/8 inch MNPT		1	0.5	\$2.25
<u>BA-200</u>	Bayonet adapter, 2 inch long, 7/16 inch outside diameter, 9/32 inch inside diameter, 1/8 inch MNPT		1	0.5	\$2.50
<u>BA-212</u>	Bayonet adapter, 2-1/2 inch long, 7/16 inch outside diameter, 9/32 inch inside diameter, 1/8 inch MNPT		1	0.5	\$2.75
<u>BA-300</u>	Bayonet adapter, 3 inch long, 7/16 inch outside diameter, 9/32 inch inside diameter, 1/8 inch MNPT		1	0.5	\$3.00
<u>BA-312</u>	Bayonet adapter, 3-1/2 inch long, 7/16 inch outside diameter, 9/32 inch inside diameter, 1/8 inch MNPT		1	0.5	\$3.50
<u>CF18-BC</u>	Adjustable bayonet compression fitting, for 1/8" diameter probe sheath sensors	Brass	1	0.1	\$10.50
<u>BB125N-50N</u>	Reducing bushing, 1/2 MNPT x 1/8 FNPT, hex head		1	0.1	\$6.00

[BA-078](#)[BA-100](#)[BA-114](#)[BA-112](#)[BA-200](#)[BA-212](#)[BA-300](#)[BA-312](#)[CF18-BC](#)[BB125N-50N](#)

Note: Check the chemical compatibility of the sensor's wetted parts with the medium to be measured.