

# PS Series Fork Sensors

## Fork Sensor U-frame - Liquid Detection



- Rugged metal one-piece housing - always in alignment
- Slot sensor
- Infrared
- Liquid Detection
- Easy installation
- High resolution
- Light / Dark operation selectable
- Adjustable sensitivity
- High switching frequency
- M8 connector with 360° LED



PS Series Fork Sensor U-frame Selection Chart - Liquid Detection							
Part Number	Price	Sensing Range	Output State	Logic	Connection	Wiring	Dimensions
<b>PSTI-0P-4F</b>	\$138.00	30mm (1.18 in)	Light On/Dark On Selectable	PNP	M8 connector	Diagram 2	Figure 1
<b>PSTI-0N-4F</b>	\$138.00	30mm (1.18 in)	Light On/Dark On Selectable	NPN	M8 connector	Diagram 1	
<b>PSTI-0P-6F</b>	\$158.00	80mm (3.15 in)	Light On/Dark On Selectable	PNP	M8 connector	Diagram 2	Figure 2
<b>PSTI-0N-6F</b>	\$158.00	80mm (3.15 in)	Light On/Dark On Selectable	NPN	M8 connector	Diagram 1	

### Wiring diagrams

Diagram 1

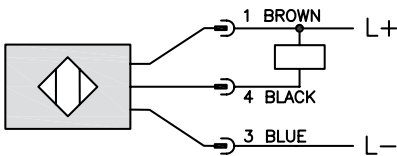
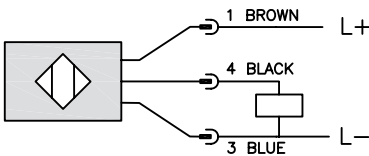
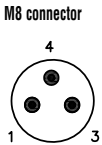

Diagram 2



Connectors



**NOTE: CLASS 2 POWER SUPPLY REQUIRED**

# PS Series Fork Sensors

Specifications	
	<b>Liquid Detection</b>
<b>Mounting Type</b>	Slot
<b>Sensing Distance</b>	30mm (1.18 in) or 80mm (3.15 in)
<b>Smallest Detectable Object*</b>	PSTI 4F 0.6 mm (0.003 in) PSTI 6F 0.8 mm (0.031 in)
<b>Emission</b>	Infrared Light
<b>Sensitivity</b>	Adjustable Potentiometer (0 to 270°)
<b>Output Type</b>	NPN or PNP/ Light on/Dark on/ 3-wire
<b>Operating Voltage</b>	10 to 30 VDC
<b>No-load Supply Current</b>	≤ 35 mA
<b>Operating (Load) Current</b>	200 mA
<b>Off-state (Leakage) Current</b>	N/A
<b>Voltage Drop</b>	≤ 3.0V (PNP); ≤2.5 (NPN)
<b>Switching Frequency</b>	2kHz
<b>Differential Travel</b>	N/A
<b>Repeat Accuracy*</b>	0.1 mm (0.0039 in)
<b>Ripple</b>	N/A
<b>Time Delay Before Availability (tv)</b>	N/A
<b>Reverse Polarity Protection</b>	Yes
<b>Short-Circuit Protection</b>	Yes
<b>Operating Temperature</b>	-10°C to +60°C (14°F to +140°F)
<b>Protection Degree (DIN 40050)</b>	IP67
<b>Indication/Switch Status</b>	On Yellow LED
<b>Housing Material</b>	GD Zn (Gadolinium-Zinc)
<b>Sensing Face Material</b>	Glass
<b>Shock</b>	Meets IEC 68-2-27 (See Photoelectric Sensor Terminology at the end of this section for more details)
<b>Vibration</b>	Meets IEC 68-2-6 (See Photoelectric Sensor Terminology at the end of this section for more details)
<b>Tightening Torque</b>	N/A
<b>Weight</b>	PSTI 4F 66g (2.33 oz) PSTI 6F 135g (4.76 oz)
<b>Connection</b>	M8 connector
<b>Agency Approvals</b>	CE
<small>Note: To obtain the most current agency approval information— see the Agency Approval Checklist section on the specific part number's web page. * Data applies to solid targets.</small>	

# PS Series Fork Sensors

## Dimensions

mm  
[inch]

**Figure 1**

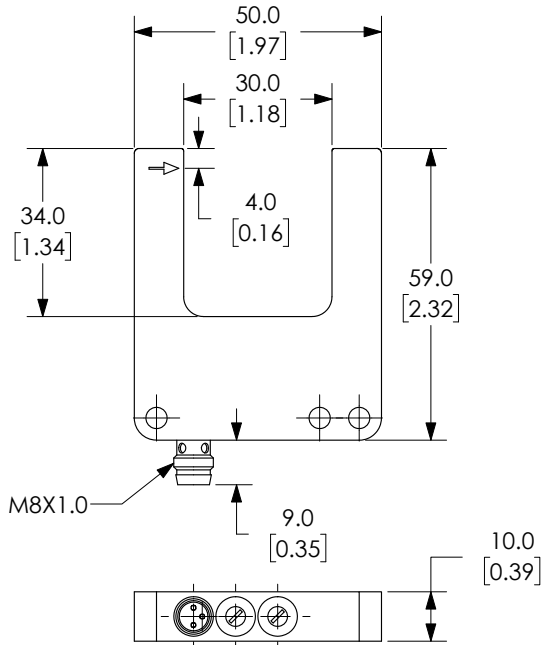

**Figure 2**

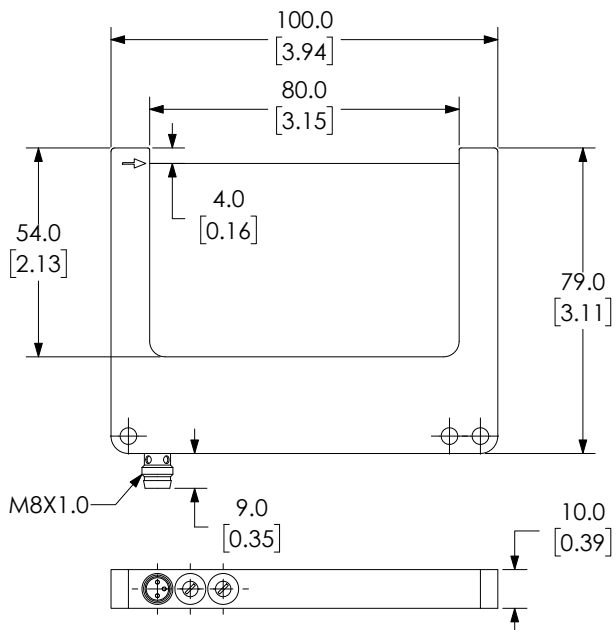

SEE OUR WEBSITE: [WWW.AUTOMATIONDIRECT.COM](http://WWW.AUTOMATIONDIRECT.COM) FOR COMPLETE ENGINEERING DRAWINGS.