

WKK Series Factor 1 Weld-Field Immune Inductive Proximity Sensors



M18 (18mm)

- Two models available
- Correction Factor (K-Factor) = 1
- Low cost/high performance
- Weld slag resistant coating
- Inductive sensor
- Metal thread M12 x 1 Connector
- Increased sensing range
- Gold-plated contacts
- Electromagnetic field immune
- Shielded mounting
- Lifetime warranty

WKK Series M18 Inductive Prox Selection Chart									
Part Number	Price	Sensing Range	Housing	Output State	Logic	Voltage	Connection	Wiring	Dimensions
WKK-AP-3H	\$32.00	8mm (0.31 in)	Shielded	NO	PNP	10 - 30 VDC	4-pin M12 quick disconnect	Diagram 1	Figure 1
WKK-AP-4H	\$42.00	12mm (0.47 in)	Unshielded						

Wiring Diagrams

Diagram 1

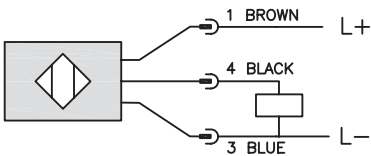

Connector

4-pin M12 connector



Dimensions

mm [inches]

Figure 1

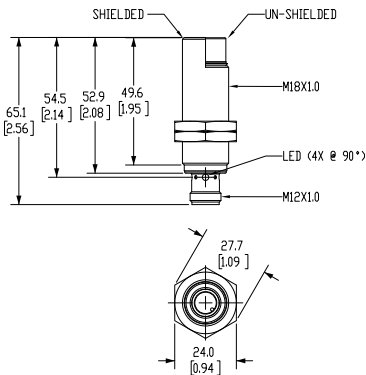

WKK Series Factor 1 Weld-Field Immune Inductive Proximity Sensors

Specifications	M18	
Model	WKK-AP-3H	WKK-AP-4H
Mounting Type	Shielded	Unshielded
Nominal Sensing Distance (mm)	8mm (0.31 in)	12mm (0.47 in)
Operating Distance	0 - 6.48 mm	0 - 9.7 mm
Material Correction Factors	Correction Factor (K-Factor) = 1	
Output Type	NO	
Operating Voltage	10 to 30 VDC	
No-load Supply Current	< 20 mA	
Operating (Load) Current	100mA	
Off-state Leakage Current	NA	
Voltage Drop	< 2.5 V	
Switching Frequency	2000Hz	
Differential Travel (% of Nominal Distance)	3 - 15	
Repeat Accuracy	NA	
Ripple	NA	
Time Delay Before Availability (tv)	NA	
Short Circuit Protection	Yes	
Operating Temperature	-40 — 85°C [-40 — 185°F]	-25 — 70°C [-13 — 158°F]
Protection Degree (DIN 40 050)	IP65 / IP66 / IP67 / IP68 / IP69K	IP67
LED Indicators	Illuminated when energized	
Housing Material	Brass with anti-spatter ceramic (Polytetrafluoroethylene (PTFE)) coating; LED window: Polyetherimide (PEI)	
Sensing Face Material	active face: Liquid Crystal Polymer (LCP) black	
Shock/Vibration	See Proximity Sensor Terminology	
Weight	0.05 kg	0.057 kg
Connection	4-pin M12 quick disconnect	
Agency Approvals	cULus E328811, CE	