

# APS Inductive Proximity Sensors

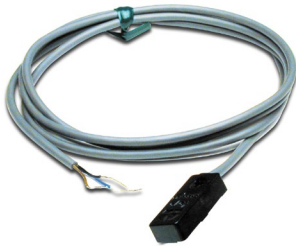

**Top Sensing  
APS4-12S-E-D**



**Front Sensing  
APS4-12M-E-D**

**Compact 12 x 27 / 8 x 26.5 mm plastic – DC**

- 10 models available
- Compact polycarbonate housing; comes with mounting plate
- High-frequency oscillation type
- Top or front sensing models
- DC 2-wire or 3-wire
- NPN, PNP, or NPN/PNP
- NO or NC
- Axial cable
- LED indicator
- IP67 rated
- Lifetime warranty



**Top Sensing  
APS25-8S-E-D**



**Front Sensing  
APS25-8M-E-D**

Compact Rectangular DC Prox Selection Chart									
Part Number	Price	Sensing Range	Housing	Output State	Logic	Connection	Wiring	Dimensions	
<b>Top-Sensing</b>									
APS25-8S-E-D	\$18.00	2.5mm (0.098 in)	Unshielded	NO	NPN	2m (6.5ft) axial cable	Diagram 1	Figure 1	
APS4-12S-E-D	\$18.00	4mm (0.157in)		NO				PNP	Diagram 2
APS4-12S-E1-D	\$18.00			NC					
APS4-12S-E2-D	\$18.00			NO	PNP				
APS4-12S-Z-D	\$18.00			NO	NPN/ PNP				
<b>Front-Sensing</b>									
APS25-8M-E-D	\$18.00	2.5mm (0.098 in)	Unshielded	NO	NPN	2m (6.5ft) axial cable	Diagram 1	Figure 2	
APS4-12M-E-D	\$18.00	4mm (0.157in)		NO				PNP	Diagram 2
APS4-12M-E1-D	\$18.00			NC					
APS4-12M-E2-D	\$18.00			NO	PNP				
APS4-12M-Z-D	\$18.00			NO	NPN/ PNP				

## Wiring diagrams

**Diagram 1**

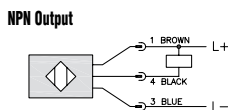

**Diagram 2**

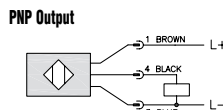

**Diagram 3**

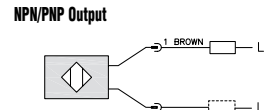

# APS Inductive Proximity Sensors

Specifications		
	APS25	APS4
<b>Mounting Type</b>	Unshielded	
<b>Nominal Distance</b>	2.5 mm [0.09 in]	4mm [0.157 in]
<b>Operating Distance</b>	NA	
<b>Material Correction Factor</b>	See the <a href="#">Material influence table</a>	
<b>Output Type</b>	See sensor selection chart	
<b>Operating Voltage</b>	10-30 VDC	
<b>No-load Supply Current</b>	≤20 mA	≤20 mA (NA for Z)
<b>Operating (Load) Current</b>	≤50mA	
<b>Off-state (Leakage) Current</b>	≤0.1 mA (≤1.0 mA for Z units)	
<b>Voltage Drop</b>	≤1.0 VDC (< 3V for Z models)	
<b>Switching Frequency</b>	500Hz	200Hz
<b>Differential Travel</b>	<20%	
<b>Repeat Accuracy</b>	NA	
<b>Ripple</b>	NA	
<b>Time Delay Before Availability (tv)</b>	5ms	
<b>Reverse Polarity Protection</b>	NA	
<b>Short Circuit Protection</b>	NA	
<b>Operating Temperature</b>	-10° to +50° C (14° to 122° F)	
<b>Protection Degree (DIN 40 050)</b>	IEC IP67	
<b>Indication/Switch Status</b>	Embedded red LED (illuminated when output is active)	
<b>Housing, Sensing Face Material</b>	Polycarbonate	
<b>Shock/Vibration</b>	See <a href="#">Proximity Sensor Terminology</a>	
<b>Tightening Torque</b>	<0.4 Nm	
<b>Weight (cable/M8 connector)</b>	0.0816 lb	
<b>Connection</b>	2m (6.5 ft) axial cable	
<b>Agency Approvals</b>	CE, cURus (UR E198343)	

## Dimensions

mm [inches]

Figure 1

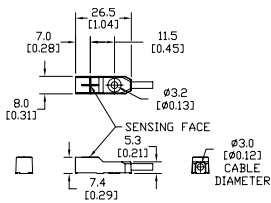

Figure 2

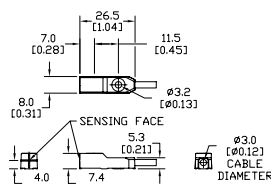

Figure 3

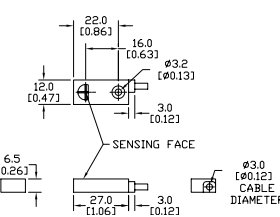
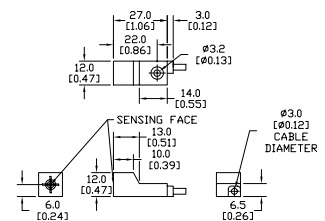
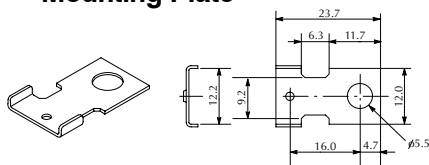

Figure 4



## Mounting Plate



Supplied with APS4x sensors

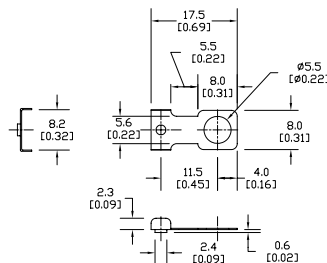

Supplied with APS25x sensors

