

# proSense™ RTD Thermowells and Fittings

by AUTOMATIONDIRECT

## RTDTW-10 Series Dimensions

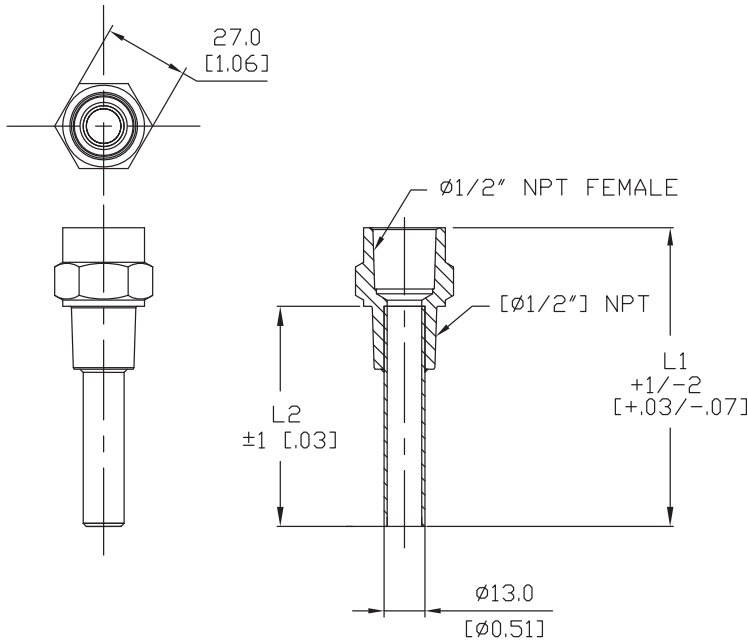

Part Number	L 1	L 2
RTDW-10-010-50N	92 mm [3.62]	70 mm [2.75]
RTDW-10-020-50N	192 mm [7.55]	170 mm [6.69]
RTDW-10-030-50N	292 mm [11.48]	270 mm [10.6]
RTDW-10-050-50N	492 mm [19.37]	470 mm [18.47]

Torque threads to 40 lb-ft [54.23 Nm]\*

Dimensions shown mm [inches]

ProSense Compression Fittings for Temperature Probes					
Part Number	Description	Pcs/Pkg	Wt(lb)	Price	Use With
<b>CF06-25N</b>	ProSense 1/4 (0.25 inch) NPT stainless steel (320S31) compression fitting for 1/4 inch (6 mm) diameter temperature probe. Pressure rating 725 psi (50 bar).	1	0.18	<--->	TTD25C-20-0100C-H TTD25C-20-0300F-H RTD0100-06-010-H RTD0100-06-020-H RTD0100-06-030-H
<b>CF10-50N</b>	ProSense 1/2 (0.50 inch) NPT stainless steel (320S31) compression fitting for 10 mm (0.4 inch) diameter temperature probe. Pressure rating 725 psi (50 bar).	1	0.20	<--->	RTD0100-10-010-H RTD0100-10-020-H RTD0100-10-030-H RTD0100-10-050-H

### CF06-25N Dimensions

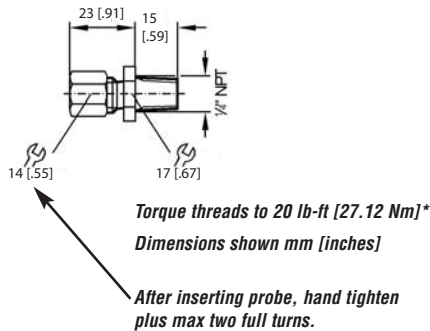

### CF10-50N Dimensions

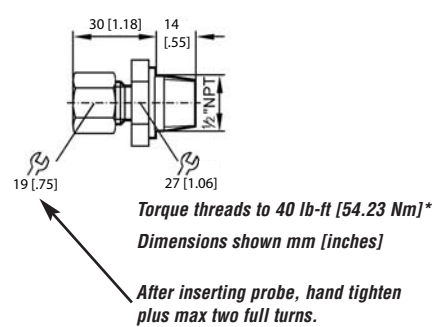

Note: Once the compression fitting has been fully tightened on the probe, the ferrule will be locked onto the probe and cannot be removed or reused.

\* Torque values are for reference. Actual torque required for a proper seal of NPT threads is influenced by tolerance, sealant, lubricant, etc.