

Input Simulator / Filler Module

P3-16SIM \$137.00

Input Simulator Module

The P3-16SIM Input Simulator module provides 16 toggle switches to simulate input devices.



Input Specifications	
Inputs per Module	16 Internal switches
OFF to ON Response	Max. 20 ms
ON to OFF Response	Max. 20 ms
Status Indicators	Logic Side (16 points)

General Specifications	
Operating Temperature	0° to 60°C (32° to 140°F),
Storage Temperature	-20° to 70°C (-4° to 158°F)
Humidity	5 to 95% (non-condensing)
Environmental Air	No corrosive gases permitted
Vibration	IEC60068-2-6 (Test Fc)
Shock	IEC60068-2-27 (Test Ea)
Heat Dissipation	0.25 W
Enclosure Type	Open Equipment
Module Location	Any I/O slot in any local, expansion, or remote base in a Productivity3000 System.
EU Directive	See the "EU Directive" topic in the Productivity3000 Help File. Information can also be obtained at: www.productivitypac.com
Weight	120g (4.23 oz)
Agency Approvals	UL508 file E157382, Canada & USA UL1604 file E200031, Canada & USA CE (EN61131-2*) This equipment is suitable for use in Class 1, Division 2, Groups A, B, C and D or non-hazardous locations only.

*Meets EMC and Safety requirements. See the Declaration of Conformity for details.

WARNING: Explosion hazard – Substitution of components may impair suitability for Class I, Division 2.

P3-FILL \$17.00

Filler Module

The P3-FILL filler module protects unused I/O module slots in the base.



I/O Modules

A variety of discrete, analog and specialty I/O modules are available for use in local, expansion, and remote I/O bases. Specifications for each module are on the following pages.

A filler module is available for unused I/O module slots (part number P3-FILL).

Discrete Input Modules

Productivity3000 Discrete Input Modules			
Part Number	Number of Inputs	Description	Price
P3-16SIM	16	Input Simulator Module	\$137.00
P3-08ND3S	8	Isolated Sinking/Sourcing DC Input	\$72.00
P3-16ND3	16	Sinking/Sourcing DC Input	\$118.00
P3-32ND3*	32	Sinking/Sourcing DC Input	\$160.00
P3-64ND3*	64	Sinking/Sourcing DC Input	\$201.00
P3-08NAS	8	Isolated AC Input	\$97.00
P3-16NA	16	AC Input	\$123.00

*ZIPLink required.

Analog I/O Modules

Productivity3000 Analog Input Modules			
Part Number	Number of Channels	Description	Price
P3-04ADS	4	Isolated Analog Input	\$372.00
P3-08AD	8	Analog Input	\$236.00
P3-16AD-1	16	Analog Input (Current)	\$314.00
P3-16AD-2	16	Analog Input (Voltage)	\$314.00
P3-08RTD	8	Analog RTD Input	\$347.00
P3-08THM	8	Analog Thermocouple Input	\$440.00

Productivity3000 Analog Output Modules			
Part Number	Number of Channels	Description	Price
P3-04DA	4	Analog Output	\$252.00
P3-08DA-1	8	Analog Output (Current)	\$440.00
P3-08DA-2	8	Analog Output (Voltage)	\$440.00
P3-06DAS-1	6	Isolated Analog Output (Current)	\$518.00
P3-06DAS-2	6	Isolated Analog Output (Voltage)	\$640.00
P3-16DA-1	16	Analog Output (Current)	\$551.00
P3-16DA-2	16	Analog Output (Voltage)	\$551.00

Productivity3000 Analog Input/Output Modules			
Part Number	Number of Channels	Description	Price
P3-8AD4DA-1	8/4	Analog Input/Output (Current)	\$337.00
P3-8AD4DA-2	8/4	Analog Input/Output (Voltage)	\$337.00

Specialty Modules

Productivity3000 Specialty Modules			
Part Number	Number of Channels	Description	Price
P3-HSI*	2	High-Speed Input	\$334.00
P3-HSO*	2	High-Speed Output	\$354.00
P3-SCM	4 ports	Serial Communications Module	\$289.00

*ZIPLink required.

Discrete Output Modules

Productivity3000 Discrete Output Modules			
Part Number	Number of Outputs	Description	Price
P3-08TD1S	8	Isolated Sinking Output	\$86.00
P3-08TD2S	8	Isolated Sourcing Output	\$88.00
P3-16TD1	16	Sinking Output	\$125.00
P3-16TD2	16	Sourcing Output	\$125.00
P3-32TD1*	32	Sinking Output	\$160.00
P3-32TD2*	32	Sourcing Output	\$160.00
P3-64TD1*	64	Sinking Output	\$199.00
P3-64TD2*	64	Sourcing Output	\$199.00
P3-08TAS	8	Isolated AC Output	\$137.00
P3-16TA	16	AC Output	\$162.00
P3-08TRS	8	Isolated Relay Output	\$97.00
P3-16TR	16	Relay Output	\$137.00
P3-08TRS-1	8	Isolated Relay Output	\$108.00
P3-16TD3P*	16	Sinking/Sourcing Protected Output	\$153.00

*ZIPLink required.

Module Installation Procedure

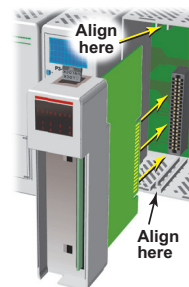

WARNING: Do not apply field power until the following steps are completed. See hot-swapping procedure for exceptions.

Step One: Align circuit card with slot and press firmly to seat module into connector.

Step Two: Pull top and bottom locking tabs toward module face. Click indicates lock is engaged.

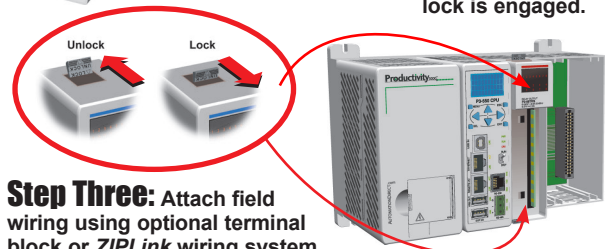

Step Three: Attach field wiring using optional terminal block or ZIPLink wiring system and install cover.

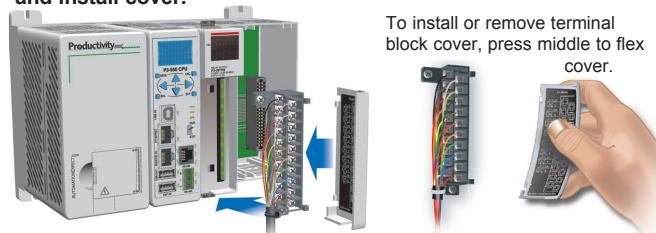

To install or remove terminal block cover, press middle to flex cover.

WARNING: Explosion hazard – Do not connect or disconnect connectors or operate switches while circuit is live unless the area is known to be non-hazardous. Do not hot-swap modules unless the area is known to be non-hazardous.