

WSK Series Weld-Field Immune Inductive Proximity Sensors

M18 (18mm)



- Four models available
- Low cost/high performance
- Weld slag resistant coating
- Inductive sensor
- Full metal housing
- Increased sensing range
- Gold-plated contacts
- Flush mounting
- Lifetime warranty



WSK Series M18 Inductive Prox Selection Chart									
Part Number	Price	Sensing Range	Mounting	Output State	Logic	Voltage	Connection	Wiring	Dimensions
WSK-AP-3H		8mm (0.31 in)	Flush	N.O.	PNP	10 - 30 VDC	4-pin M12 quick-disconnect	Diagram 1	Figure 1
WSK-AN-3H	Retired	6mm (0.24 in)			NPN	10 - 36 VDC	4-pin M12 quick-disconnect	Diagram 2	Figure 2
WSK-A0-3E					PNP/NPN		4-pin M12 with 0.3 m cable	Diagram 3	Figure 3
WSK-A0-3A	Retired						3m axial cable	Diagram 4	

Wiring Diagrams

Diagram 1

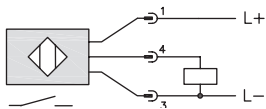

Diagram 2

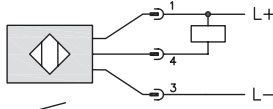

Diagram 3

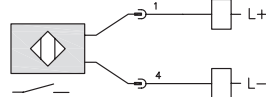
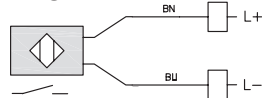

Diagram 4



Connector

4-pin M12 NPN



4-pin M12 PNP



4-pin M12 0.3m



Dimensions

mm [inches]

Figure 1

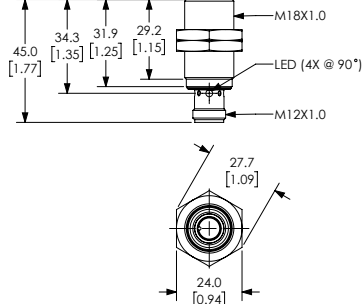

Figure 2

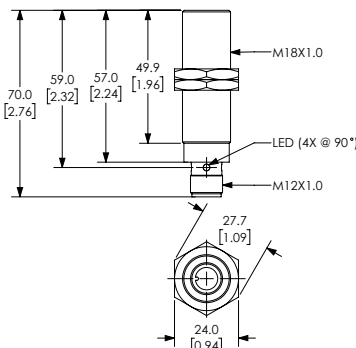
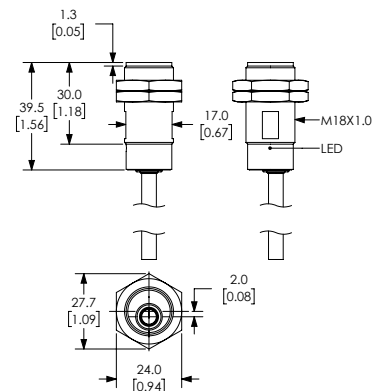

Figure 3



WSK Series Weld-Field Immune Inductive Proximity Sensors

Specifications	M18 Models			
Model	WSK-AP-3H	WSK-AN-3H	WSK-A0-3E	WSK-A0-3A
Mounting Type	Flush			
Nominal Sensing Distance (mm)	8mm (0.31 in)	6mm (0.24 in)		
Operating Distance	0 - 6.48 mm	0 - 4.9 mm		
Material Correction Factors	See the Material Influence table			
Output Type	N.O.			
Operating Voltage	10 to 30 VDC	10 to 36 VDC		
No-load Supply Current	< 10mA	< 20mA	NA	
Operating (Load) Current	< 100mA			
Off-state Leakage Current	NA		< 0.6 mA	
Voltage Drop	< 2.5 V			
Switching Frequency	2Hz		50Hz	
Differential Travel (% of Nominal Distance)	3 - 15	1 - 20		
Repeat Accuracy	NA			
Ripple	NA			
Time Delay Before Availability (tv)	NA			
Short Circuit Protection	Yes	Pulsed		
Operating Temperature	-40 to 85°C [-40 to 185°F]	0 - 85°C [32 to 185°F]	-25 - 70°C [-13 to 158°F]	
Protection Degree (DIN 40 050)	IP65 / IP66 / IP67 / IP68 / IP69K	IP67		
LED Indicators	Illuminated when energized			
Housing Material	Stainless steel 316L / 1.4404 with anti-spatter ceramic (Polytetrafluoroethylene [PTFE]) coating			
Sensing Face Material	active face: stainless steel 316L 1.4404 anti-spatter			
Shock/Vibration	See Proximity Sensor Terminology			
Weight	0.046 kg	0.055 kg	0.067 kg	0.157 kg
Connection	4-pin M12 quick-disconnect		PUR cable / 0.3 m; 2 x 0.5 mm ² ; with M12 quick-disconnect	PUR cable / 0.3 m; 2 x 0.5 mm ²
Agency Approvals	cULus E328811, CE			