



# Pneumatic Directional Control Solenoid Valves – BVS-4 Series



BVS Series Solenoid with Leads



BVS Series Solenoid with DIN 43650 Form C

NITRA pneumatic BVS-4 series modular solenoid valves are body ported 4-port (4-way) spool valve models have removable flying leads or an 8 mm Micro DIN connector. Units are only DIN rail mountable when used with BVM series manifolds.

## Features

- Body ported, 4-port (4-way) spool valves
- 1/4" (6mm) push-to-connect ports
- Flow coefficients (Cv) 0.8
- 2-position, single solenoid spring return
- 12VDC, 24VDC, 24VAC or 120VAC solenoid coils with LED status indication & surge suppression diode
- Flying leads or 8mm DIN connection
- Lever manual operator - latching
- 2-year warranty

## Valve Symbol

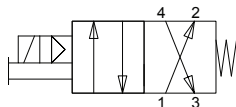

BVS (4-port, 2-position) 4 Series Specifications								
Models	<u>BVS-4251-12D</u>	<u>BVS-4252-12D</u>	<u>BVS-4251-24D</u>	<u>BVS-4252-24D</u>	<u>BVS-4251-24A</u>	<u>BVS-4252-24A</u>	<u>BVS-4251-120A</u>	<u>BVS-4252-120A</u>
Price								
Weight (lbs)	0.2							
Acting	Spool (2-Position)							
Port Size	1/4" Push-to-Connect							
Orifice Size	0.2" [5.0 mm] (Cv = 0.8)							
Fluid	Air or Inert Gas (to be filtered by 40μ filter element)							
Min. / Max. Pressure	30psi (2bar) - 120psi (8.3 bar)							
Vacuum	Air pilot models can be used in vacuum applications with external air signal to pilot ports.							
Body	Glass Reinforced Thermoplastic							
Voltage	12VDC		24VDC		24VAC		120VAC	
Inrush Power	1.6 W		1.4 W		1.4 VA		1.7 VA	
Continuous ON Power	1.3 W		1.2 W		1.2 VA		1.5 VA	
Expected Life	20,000,000 cycles at max 3 cycles/second							
Wiring	Removable 18" Flying Leads	DIN 43650 Form C	Removable 18" Flying Leads	DIN 43650 Form C	Removable 18" Flying Leads	DIN 43650 Form C	Removable 18" Flying Leads	DIN 43650 Form C
Response Time	0.016 sec							
Temperature - Operation and Storage	0~120°F (-18~49°C)							
Lubrication	Not Required							
Protection	IP 65							



# Pneumatic Directional Control Solenoid Valves – BVS-4 Series

BVS (4-port, 2-position) 4 Series Specifications						
Models	<a href="#"><u>BVS-46M1-12D</u></a>	<a href="#"><u>BVS-46M2-12D</u></a>	<a href="#"><u>BVS-46M1-24A</u></a>	<a href="#"><u>BVS-46M2-24A</u></a>	<a href="#"><u>BVS-46M1-120A</u></a>	<a href="#"><u>BVS-46M2-120A</u></a>
Price						
Weight (lbs)	0.2					
Acting	Spool (2-Position)					
Port Size	6mm Push-to-Connect					
Orifice Size	0.2" [5.0 mm] (Cv = 0.8)					
Fluid	Air or Inert Gas (to be filtered by 40μ filter element)					
Min. / Max. Pressure	30psi (2bar) - 120psi (8.3 bar)					
Vacuum	Air pilot models can be used in vacuum applications with external air signal to pilot ports.					
Body	Glass Reinforced Thermoplastic					
Voltage	12VDC		24VAC		120VAC	
Inrush Power	1.6 W		1.4 VA		1.7 VA	
Continuous ON Power	1.3 W		1.2 VA		1.5 VA	
Expected Life	20,000,000 cycles at max 3 cycles/second					
Wiring	Removable 18" Flying Leads	DIN 43650 Form C	Removable 18" Flying Leads	DIN 43650 Form C	Removable 18" Flying Leads	DIN 43650 Form C
Response Time	0.016 sec					
Temperature - Operation and Storage	0~120°F (-18~49°C)					
Lubrication	Not Required					
Protection	IP 65					



# Pneumatic Directional Control Solenoid Valves – BVS-4 Series

## Dimensions

inches [mm]

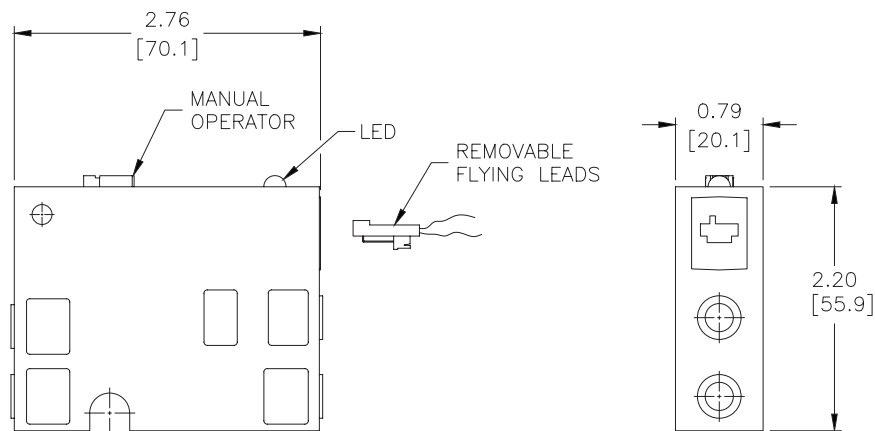

**BVS 4 Series w/Removable Leads**

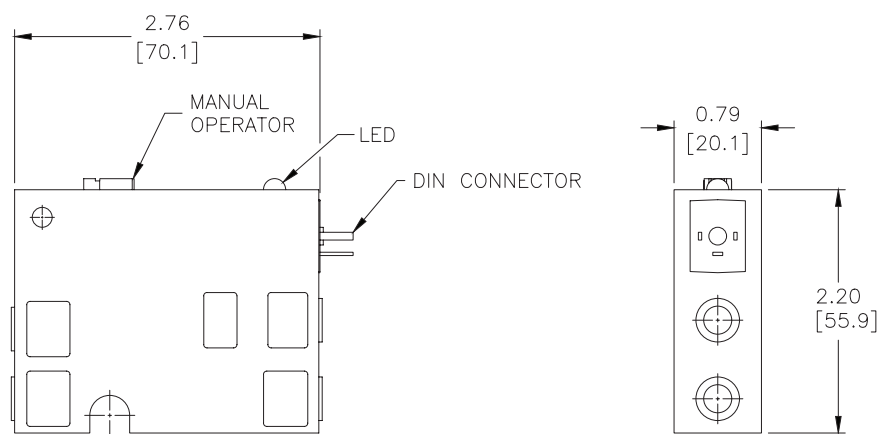

**BVS 4 Series w/DIN 43650 Form C**

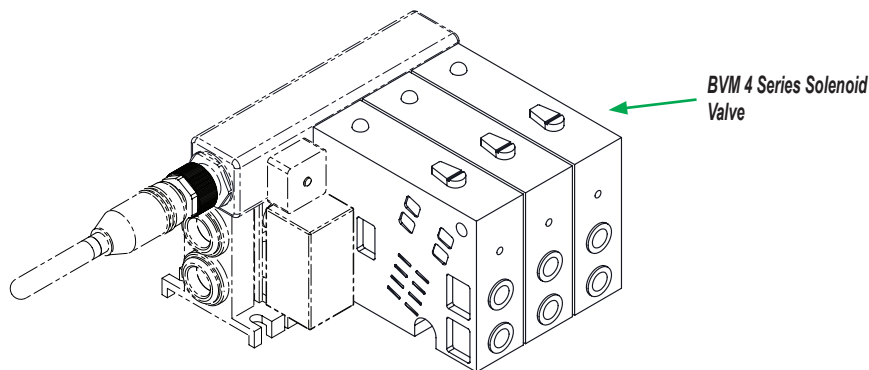

See our website [www.AutomationDirect.com](http://www.AutomationDirect.com) for complete Engineering drawings.



# Manifolds for Modular Solenoid Valves

## – BVM-4 Series



BVM - 2-Station



BVM - 3-Station



BVM - 4-Station

NITRA pneumatic BVM-4 series modular manifolds simplify the mounting of BVS-4 series solenoid valves. Made of sturdy glass reinforced thermoplastic with DIN rail mounting clips included, they are available in 2, 3 and 4-station models. Push-to-connect inlet and outlet ports allow quick and easy tubing connections.

### Features

- No tools required to install/remove valves
- 2, 3 or 4-station manifolds available
- 3/8" or 10mm tube inlets and outlets
- 35 mm DIN rail mounting clips included
- 2-year warranty

### BVM Series Manifolds

Part No.	Stations	Inlet	Outlet	Dimension "A" in [mm]	Price	Weight (lbs)
<a href="#">BVM-4225</a>	2	3/8"	3/8"	2.71 [68.9]		0.3
<a href="#">BVM-426M</a>	2	10mm	10mm			0.3
<a href="#">BVM-4325</a>	3	3/8"	3/8"	3.54 [89.9]		0.3
<a href="#">BVM-436M</a>	3	10mm	10mm			0.3
<a href="#">BVM-4425</a>	4	3/8"	3/8"	4.37 [110.9]		0.3
<a href="#">BVM-446M</a>	4	10mm	10mm			0.3

### Dimensions

inches [mm]

#### 2-Station Manifold

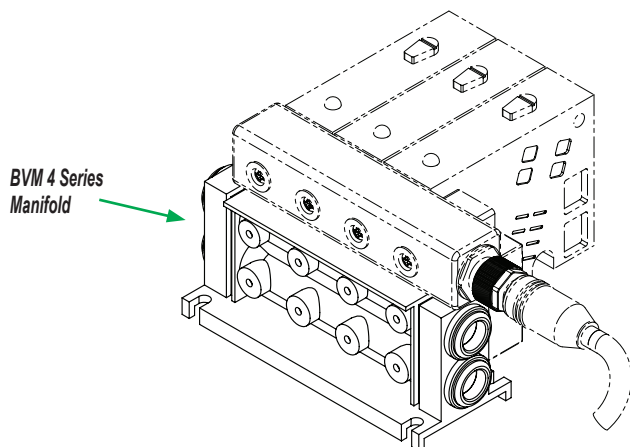
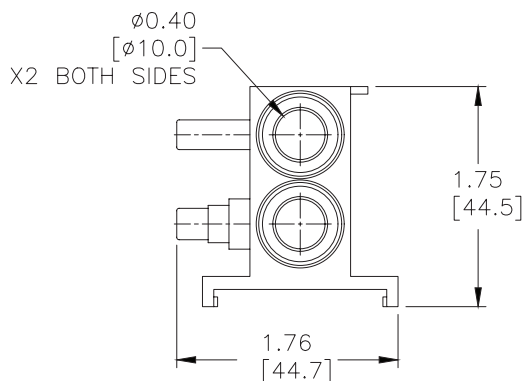
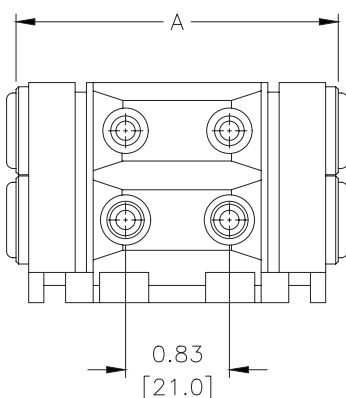

See our website [www.AutomationDirect.com](http://www.AutomationDirect.com) for complete Engineering drawings.



# BVS-4 Series Control Distribution Blocks



Part No. **BVPS-4**

NITRA pneumatic control distribution blocks are a convenient way to connect a bank of valves to a controller. Replace a bundle of solenoid cables with one 5-pole M12 cable. Each block matches up with a manifold of two to four stations.

## Features

- Single 5-pole M12 wiring connection
- IP 65 rating
- 2 to 4 stations

BVS-4 Series Control Distribution Blocks				
Part No.	Description	Dimension "A" in [mm]	Price	Weight (lbs)
<b>BVPS-2</b>	NITRA control distribution block, AC/DC, 2 stations, M12 connector. For use with BVS-4 series valves.	2.60 [66.0]		0.2
<b>BVPS-3</b>	NITRA control distribution block, AC/DC, 3 stations, M12 connector. For use with BVS-4 series valves.	3.43 [87.0]		0.3
<b>BVPS-4</b>	NITRA control distribution block, AC/DC, 4 stations, M12 connector. For use with BVS-4 series valves.	4.25 [108.0]		0.3

## Dimensions

inches [mm]

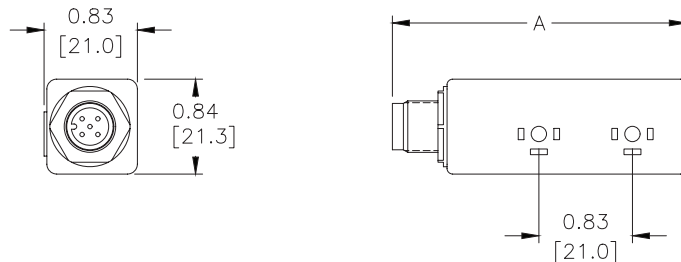

## Wiring

BVPS WIRING DIAGRAM

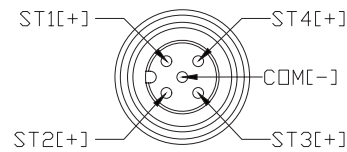

BVM 4 Series Control Distribution Block

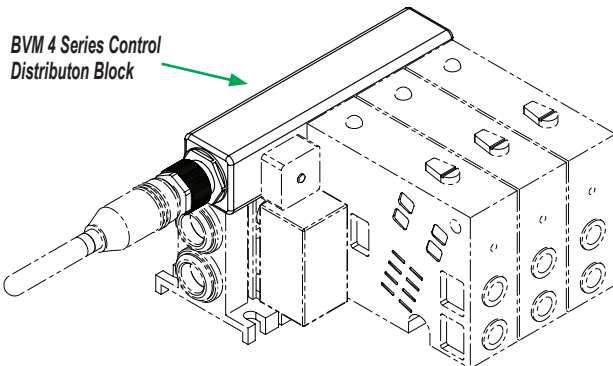

For the BVS-4 Control Distribution Block use one of the following cable part numbers:

7000-12241-2150300

7000-12361-2150300

7000-12241-2150500

7000-12361-2150500

7000-12241-2151000

7000-12361-2151000

For further details see the wiring-solutions section of our catalog or our website [www.AutomationDirect.com](http://www.AutomationDirect.com)

See our website [www.AutomationDirect.com](http://www.AutomationDirect.com) for complete Engineering drawings.



# BVS-4 Series Control Distribution Blocks

## BVS-4 Series Control Distribution Blocks Accessories



**BVPS-BP**



**BVM-4BP1**

AVPS Series Control Distribution Blocks Accessories			
Part No.	Description	Price	Weight (lbs)
<b><u>BVPS-BP</u></b>	NITRA blanking plug, for use with BVPS series control distribution blocks.		0.1
<b><u>BVM-4BP1</u></b>	NITRA blanking plug, fiberglass reinforced plastic. For use with BVM-4x25 manifolds.		0.1
<b><u>BVM-4BP2</u></b>	NITRA blanking plug, fiberglass reinforced plastic. For use with BVM-4x6M manifolds.		0.1

## Dimensions

inches [mm]

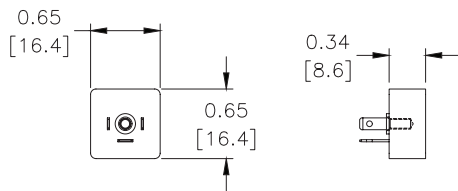

Part No. **BVPS-BP**

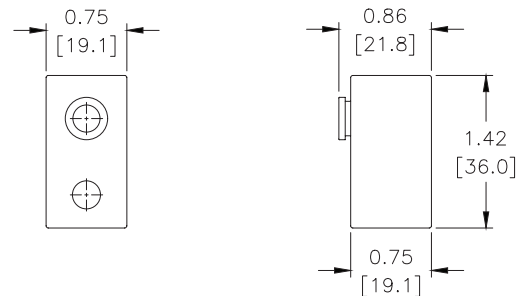

Part No. **BVM-4BPx**

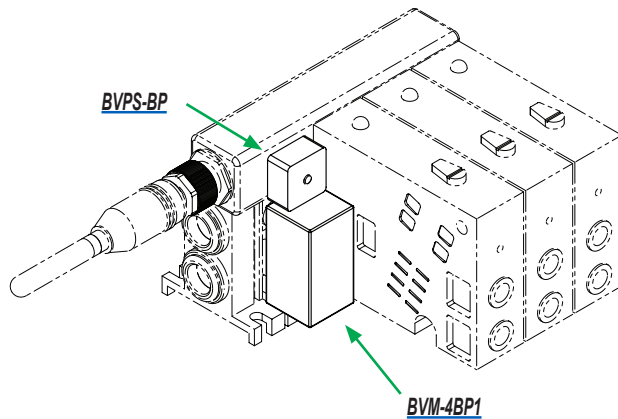

See our website [www.AutomationDirect.com](http://www.AutomationDirect.com) for complete Engineering drawings.