

# Connection Cables - Sensor and Signal

## M8 A-coded Cable to Pigtail

- Industry-standard axial and right-angle M8 screw-lock connectors with open leads
- Cables listed can be used with patch cables
- 1.5m [4.9 ft], 2m [6.5 ft], 5m [16.4 ft], 7m [23 ft], and 10m [32.8 ft] cable lengths
- PVC (polyvinyl chloride) jacketed cable for general use and chemical washdown applications, ex. food & beverage industry
- PUR (polyurethane) jacketed cable for applications with exposure to oil and dynamic applications requiring more flexibility
- PP (polypropylene) wire insulation for low temperature applications



### M8 A-coded Cable to Pigtail

| Part Number                        | Price | Number of Wires    | Connector          | Cable Jacket/<br>Wire Insulation Material | Jacket Color | Dimensions |        |        |        |        |        |        |        |       |
|------------------------------------|-------|--------------------|--------------------|---|--------------|------------|--------|--------|--------|--------|--------|--------|--------|-------|
|                                    |       |                    |                    |   |              | A          | B      | C      | L      |        |        |        |        |       |
|                                    |       |                    |                    |   |              | mm         |        |        | m [ft] |        |        |        |        |       |
| <a href="#">CD08-0A-020-A1</a>     |       | 3                  | Axial female       | PVC/PVC                                   | Gray         | 32         | 10     | -      | 2      |        |        |        |        |       |
| <a href="#">CD08-0A-020-C1</a>     |       |                    | Right-angle female |   |              | 25         | 10     | 20     | [6.5]  |        |        |        |        |       |
| <a href="#">CD08-0A-050-A1</a>     |       |                    | Axial female       | PUR/PVC                                   | Black        | 32         | 10     | -      | 5      |        |        |        |        |       |
| <a href="#">CD08-0A-050-C1</a>     |       |                    | Right-angle female |   |              | 25         | 10     | 20     |        | [16.4] |        |        |        |       |
| <a href="#">CD08-0C-050-A1</a>     |       |                    | Axial female       | PUR/PVC                                   | Black        | 32         | 10     | -      | 5      |        |        |        |        |       |
| <a href="#">CD08-0C-050-A1-A</a>   |       |                    | Axial female       | PUR/PP                                    |              | 32         | 10     | -      |        | [16.4] |        |        |        |       |
| <a href="#">CD08-0C-050-C1</a>     |       |                    | Right-angle female | PUR/PVC                                   | Black        | 25         | 10     | 20     | 5      |        |        |        |        |       |
| <a href="#">CD08-0C-050-C1-A</a>   |       |                    | Right-angle female | PUR/PP                                    |              | 25         | 10     | 20     |        | [16.4] |        |        |        |       |
| <a href="#">CD08-0A-070-A1</a>     |       |                    | Axial female       | PVC/PVC                                   | Gray         | 32         | 10     | -      | 7      |        |        |        |        |       |
| <a href="#">CD08-0A-070-C1</a>     |       |                    | Right-angle female |   |              | 25         | 10     | 20     | [23]   |        |        |        |        |       |
| <a href="#">7000-08001-0200200</a> |       |                    | Axial male         | PUR/PVC                                   | Yellow       | Yellow     | 39     | 10     | -      | 10     |        |        |        |       |
| <a href="#">7000-08001-0300200</a> |       |                    | Axial male         | PUR/PP                                    |              |            | 39     | 10     | -      |        | [6.5]  |        |        |       |
| <a href="#">7000-08021-0200200</a> |       |                    | Right-angle male   | PUR/PVC                                   |              |            | 25     | 10     | 26     |        | 10     |        |        |       |
| <a href="#">7000-08021-0300200</a> |       |                    | Right-angle male   | PUR/PP                                    |              |            | 25     | 10     | 26     |        |        | [32.8] |        |       |
| <a href="#">7000-08001-0300500</a> |       |                    | Axial male         | PUR/PP                                    |              |            | 39     | 10     | -      |        | 10     |        |        |       |
| <a href="#">7000-08021-0200500</a> |       |                    | Right-angle male   | PUR/PVC                                   |              |            | 25     | 10     | 26     |        |        | [32.8] |        |       |
| <a href="#">7000-08021-0300500</a> |       |                    | Right-angle male   | PUR/PP                                    |              |            | 25     | 10     | 26     |        | 10     |        |        |       |
| <a href="#">7000-08001-0201000</a> |       |                    | Axial male         | PUR/PVC                                   |              |            | 39     | 10     | -      |        |        | [6.5]  |        |       |
| <a href="#">7000-08001-0301000</a> |       |                    | Axial male         | PUR/PP                                    |              |            | 39     | 10     | -      |        | 10     |        |        |       |
| <a href="#">7000-08021-0201000</a> |       |                    | Right-angle male   | PUR/PVC                                   |              |            | 25     | 10     | 26     |        |        | [32.8] |        |       |
| <a href="#">7000-08021-0301000</a> |       |                    | Right-angle male   | PUR/PP                                    |              |            | 25     | 10     | 26     |        | 10     |        |        |       |
| <a href="#">7000-08001-2100200</a> |       |                    | Axial male         | PVC/PVC                                   |              |            | Gray   | 39     | 10     |        |        | -      | 2      |       |
| <a href="#">7000-08021-2100200</a> |       |                    | Right-angle male   |   |              |            |        | 25     | 10     |        | 26     | [6.5]  |        |       |
| <a href="#">7000-08001-2100500</a> |       |                    | Axial male         | PVC/PVC                                   |              |            | Gray   | 39     | 10     |        | -      | 5      |        |       |
| <a href="#">7000-08021-2100500</a> |       | Right-angle male   | 25                 |   |              |            |        | 10     | 26     |        | [16.4] |        |        |       |
| <a href="#">7000-08001-2101000</a> |       | Axial male         | PVC/PVC            | Gray                                      |              |            | 39     | 10     | -      |        | 10     |        |        |       |
| <a href="#">7000-08021-2101000</a> |       | Right-angle male   |                    |   |              |            | 25     | 10     | 26     |        | [32.8] |        |        |       |
| <a href="#">7000-08041-0200200</a> |       | Axial female       | PUR/PVC            | Yellow                                    |              |            | Yellow | 32     | 10     |        | -      | 5      |        |       |
| <a href="#">7000-08041-0300200</a> |       | Axial female       | PUR/PP             |   |              |            |        | 32     | 10     |        | -      |        | [16.4] |       |
| <a href="#">7000-08081-0200200</a> |       | Right-angle female | PUR/PVC            |   |              |            |        | 25     | 10     |        | 20     |        | 2      |       |
| <a href="#">7000-08081-0300200</a> |       | Right-angle female | PUR/PP             |   |              |            |        | 25     | 10     |        | 20     |        |        | [6.5] |
| <a href="#">7000-08041-0200500</a> |       | Axial female       | PUR/PVC            |   |              |            |        | Yellow | 32     |        | 10     |        | -      | 5     |
| <a href="#">7000-08041-0300500</a> |       | Axial female       | PUR/PP             |   |              |            |        |        | 32     |        | 10     |        | -      |       |
| <a href="#">7000-08081-0200500</a> |       | Right-angle female | PUR/PVC            |   |              |            |        | Yellow | 25     |        | 10     |        | 20     | 5     |
| <a href="#">7000-08081-0300500</a> |       | Right-angle female | PUR/PP             |   | 25           | 10         |        |        | 20     | [16.4] |        |        |        |       |

Continued on next page.

### Dimensions

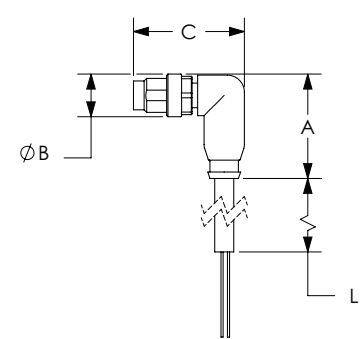
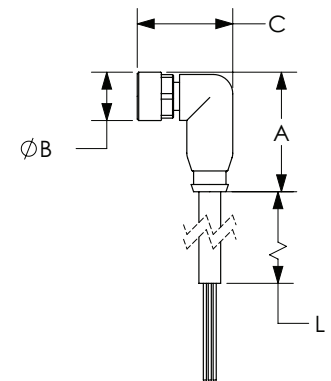
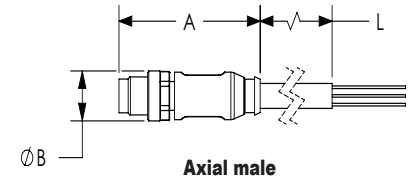
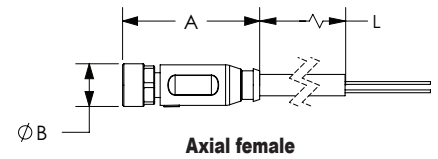

See our website: [www.AutomationDirect.com](http://www.AutomationDirect.com) for complete engineering drawings.

# Connection Cables - Sensor and Signal

## M8 A-coded Cable to Pigtail (continued)

| M8 A-coded Cable to Pigtail        |       |                    |                    |                                       |              |            |       |        |           |           |           |          |          |
|------------------------------------|-------|--------------------|--------------------|---------------------------------------|--------------|------------|-------|--------|-----------|-----------|-----------|----------|----------|
| Part Number                        | Price | Number of Wires    | Connector          | Cable Jacket/Wire Insulation Material | Jacket Color | Dimensions |       |        |           |           |           |          |          |
|                                    |       |                    |                    |                                       |              | A          | B     | C      | L         |           |           |          |          |
|                                    |       |                    |                    |                                       |              | mm         |       |        | m [ft]    |           |           |          |          |
| <a href="#">7000-08041-0200700</a> |       | 3                  | Axial female       | PUR/PVC                               | Yellow       | 32         | 10    | -      | 7 [22.9]  |           |           |          |          |
| <a href="#">7000-08041-0300700</a> |       |                    | Axial female       | PUR/PP                                |              | 32         | 10    | -      |           |           |           |          |          |
| <a href="#">7000-08081-0200700</a> |       |                    | Right-angle female | PUR/PVC                               |              | 25         | 10    | 20     |           |           |           |          |          |
| <a href="#">7000-08081-0300700</a> |       |                    | Right-angle female | PUR/PP                                |              | 25         | 10    | 20     |           |           |           |          |          |
| <a href="#">7000-08041-2100500</a> |       |                    | Axial female       | PVC/PVC                               |              | Gray       | 32    | 10     |           | -         | 5 [16.4]  |          |          |
| <a href="#">7000-08081-2100500</a> |       |                    | Right-angle female |                                       |              |            | 25    | 10     |           | 20        |           |          |          |
| <a href="#">7000-08061-0210200</a> |       | 4                  | Axial female       | PUR-PVC/PVC                           | Yellow       | 32         | 10    | -      | 2 [6.5]   |           |           |          |          |
| <a href="#">7000-08061-0310200</a> |       |                    | Axial female       | PUR/PP                                |              | 32         | 10    | -      |           |           |           |          |          |
| <a href="#">7000-08101-0210200</a> |       |                    | Right-angle female | PUR-PVC/PVC                           |              | 25         | 10    | 20     |           |           |           |          |          |
| <a href="#">7000-08101-0310200</a> |       |                    | Right-angle female | PUR/PP                                |              | 25         | 10    | 20     |           |           |           |          |          |
| <a href="#">7000-08061-0210500</a> |       |                    | Axial female       | PUR-PVC/PVC                           |              | 32         | 10    | -      |           | 5 [16.4]  |           |          |          |
| <a href="#">7000-08061-0310500</a> |       |                    | Axial female       | PUR/PP                                |              | 32         | 10    | -      |           |           |           |          |          |
| <a href="#">7000-08101-0210500</a> |       |                    | Right-angle female | PUR-PVC/PVC                           |              | 25         | 10    | 20     |           |           |           |          |          |
| <a href="#">7000-08101-0310500</a> |       |                    | Right-angle female | PUR/PP                                |              | 25         | 10    | 20     |           |           |           |          |          |
| <a href="#">7000-08061-0211000</a> |       |                    | Axial female       | PUR-PVC/PVC                           |              | 32         | 10    | -      | 10 [32.8] |           |           |          |          |
| <a href="#">7000-08061-0311000</a> |       |                    | Axial female       | PUR/PP                                |              | 32         | 10    | -      |           |           |           |          |          |
| <a href="#">7000-08101-0211000</a> |       |                    | Right-angle female | PUR-PVC/PVC                           |              | 25         | 10    | 20     |           |           |           |          |          |
| <a href="#">7000-08101-0311000</a> |       |                    | Right-angle female | PUR/PP                                |              | 25         | 10    | 20     |           |           |           |          |          |
| <a href="#">CD08-0G-020-A1</a>     |       |                    | 4                  | Axial female                          |              | PVC/PVC    | Black | 32     |           | 10        | -         | 2 [6.5]  |          |
| <a href="#">CD08-0W-020-C1</a>     |       |                    |                    | Right-angle female                    |              |            |       | 25     |           | 10        | 20        | 5 [16.4] |          |
| <a href="#">CD08-0G-050-A1</a>     |       |                    |                    | Axial female                          |              |            |       | 32     | 10        | -         | 10 [32.8] |          |          |
| <a href="#">CD08-0W-050-C1</a>     |       |                    |                    | Right-angle female                    |              |            |       | 25     | 10        | 20        | 5 [16.4]  |          |          |
| <a href="#">CD08-0G-100-A1</a>     |       |                    |                    | Axial female                          |              |            |       | 32     | 10        | -         | 10 [32.8] |          |          |
| <a href="#">CD08-0W-100-C1</a>     |       |                    |                    | Right-angle female                    |              |            |       | 25     | 10        | 20        | 2 [6.5]   |          |          |
| <a href="#">7000-08061-2110200</a> |       | Axial female       |                    | PVC/PVC                               | Gray         |            |       | 32     | 10        | -         | 5 [16.4]  |          |          |
| <a href="#">7000-08101-2110200</a> |       | Right-angle female |                    |                                       |              |            |       | 25     | 10        | 20        | 5 [16.4]  |          |          |
| <a href="#">7000-08061-2110500</a> |       | Axial female       |                    |                                       |              |            |       | 32     | 10        | -         | 10 [32.8] |          |          |
| <a href="#">7000-08101-2110500</a> |       | Right-angle female |                    |                                       |              |            |       | 25     | 10        | 20        | 1.5 [4.9] |          |          |
| <a href="#">7000-08061-2111000</a> |       | Axial female       |                    |                                       |              |            |       | PUR/PP | Black     | 34        | 10        | -        | 5 [16.4] |
| <a href="#">7000-08951-6950150</a> |       | Right-angle female |                    |                                       |              |            |       |        |           | 28        | 10        | 21       | 5 [16.4] |
| <a href="#">7000-08941-6950500</a> |       | Axial female       | 34                 |                                       |              | 10         | -     |        |           | 10 [32.8] |           |          |          |
| <a href="#">7000-08951-6950500</a> |       | Right-angle female | 28                 |                                       |              | 10         | 21    |        |           | 10 [32.8] |           |          |          |
| <a href="#">7000-08941-6951000</a> |       | Axial female       | 34                 |                                       |              | 10         | -     |        |           | 10 [32.8] |           |          |          |
| <a href="#">7000-08951-6951000</a> |       | Right-angle female | 28                 |                                       |              | 10         | 21    |        |           |           |           |          |          |

### Dimensions

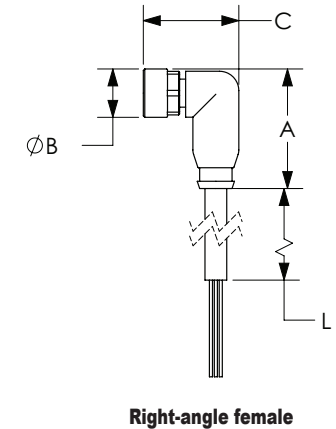
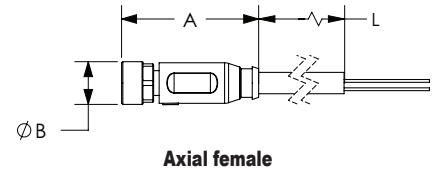

See our website: [www.AutomationDirect.com](http://www.AutomationDirect.com) for complete engineering drawings.

# Connection Cables - Sensor and Signal

| M8 A-coded Cable to Pigtail Specifications          |  |                |                         |                         |                |
|---|--|----------------|-------------------------|-------------------------|----------------|
| Model   | CD08 Series  |                |                         | 7000 Series             |                |
| Type  | 3-Wire, 3-Pole   | 4-Wire, 4-Pole | 3-Wire, 3-Pole          | 4-Wire, 4-Pole          | 5-Wire, 5-Pole |
| Max Voltage   | 50VAC / 60VDC  |                |                         |                         | 30 VAC/VDC     |
| Max Voltage - UL Rating                             | N/A  |                |                         | 30 VAC/VDC              |                |
| Max Current Per Contact                             | 4A   |                |                         |                         | 3A             |
| Protection Degree                                   | IP65 / IP66K / IP67  |                |                         |                         | IP67           |
| Nut Material  | Male threads are nickel plated brass; female threads are nickel plated die cast zinc           |                |                         |                         |                |
| Cable Jacket/Wire Insulation Material               | PUR-PVC/PVC, PVC/PVC, PUR/PVC, or PUR/PP   |                |                         |                         | PUR/PP         |
| Contacts Material                                   | Copper Alloy   |                |                         |                         |                |
| Tightening Torque                                   | ≤ 0.4 N·m [≤ 0.34 ft·lb]   |                |                         |                         |                |
| Conductors Cross Section                            | 0.25 mm <sup>2</sup> [24AWG]   |                |                         |                         |                |
| Ø Outer Cable For PUR/PVC or PVC/PVC or PUR-PVC/PVC | 3-Wire 4.5 mm [0.18 in] / 4-Wire 4.8 mm [0.19 in]  |                |                         |                         |                |
| Ø Outer Cable For PUR/PP                            | 3-Wire 4.1 mm [0.16 in] / 4-Wire 4.5 mm [0.18 in]  |                |                         | 5-Wire 4.7 mm [0.19 in] |                |
| Temperature Range - Stationary Use                  | PUR-PVC/PVC, PVC/PVC and PUR/PVC -30 to 80°C [-22 to 176°F]; PUR/PP -40 to 80°C [-40 to 176°F] |                |                         |                         |                |
| Temperature Range - Flexible Use                    | PUR-PVC/PVC, PVC/PVC and PUR/PVC -5 to 80C [23 to 176F]; PUR/PP -25 to 80°C [-13 to 176°F]     |                |                         |                         |                |
| Min Bend Radius                                     | Stationary use: 5 x cable diameter;<br>Flexible use: 10 x cable diameter                       |                |                         |                         |                |
| Approvals*  | CE, cCSAus   |                | cULus, CE, UKCA, cCSAus |                         | cURus          |

\*To obtain the most current agency approval information, see the Agency Compliance & Certifications Checklist section on the specific part number's web page.

## Contact Diagrams

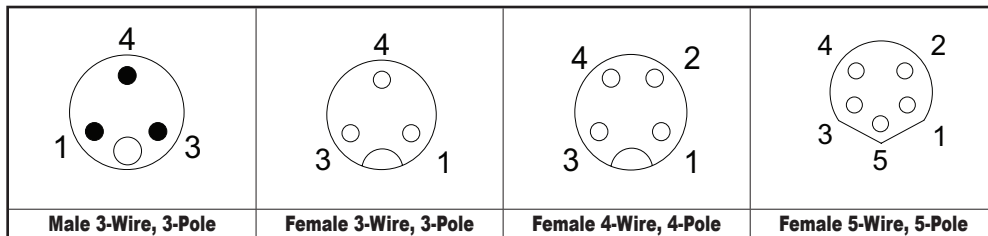

## Wiring Diagrams

