

PROFIBUS Slave Base Controller

| Baud | Max. Segment Length | | Max. Expansion | |
|------------|---------------------|--------|----------------|--------|
| | Feet | Meters | Feet | Meters |
| 9.6 Kbps | 3278 | 1,000 | 3,2786 | 1,0000 |
| 19.2 Kbps | 3278 | 1,000 | 3,2786 | 1,0000 |
| 93.75 Kbps | 3278 | 1,000 | 3,2786 | 1,0000 |
| 187.5 Kbps | 3278 | 1,000 | 3,2786 | 1,0000 |
| 500 Kbps | 1311 | 400 | 1,3114 | 4,000 |
| 1.5 Mbps | 655 | 200 | 6,557 | 2,000 |
| 3 Mbps | 327 | 100 | 3,270 | 1,000 |
| 6 Mbps | 327 | 100 | 3,270 | 1,000 |
| 12 Mbps | 327 | 100 | 3,270 | 1,000 |

| Recommended Cables | |
|--------------------|----------------|
| Siemens | 6XV1 830 0AH10 |
| Belden | 3079A |

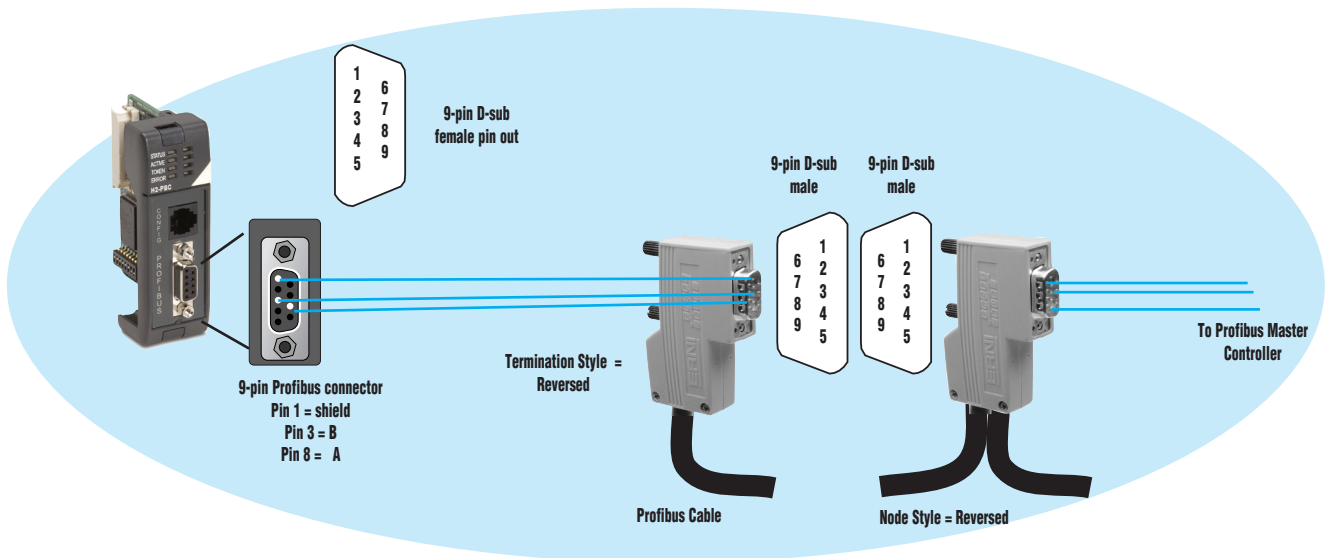

ERNI ERbic connectors for Profibus networks

ERNI ERbic connectors are available for the Profibus Base Controller. They are available in node and termination reversed styles for DL205 and PC connections, horizontal or vertical cable entry, and termination or daisy-chain configurations.

| ERNI ERbic connectors | | |
|-----------------------|--|--|
| Part No. | Description | Device |
| 104577 | PROFIBUS-certified reverse node horizontal connector. 9-pin Male D-Sub | H2-PBC or any PROFIBUS ISA/PCI Personal Computer Master/Slave Card |
| 104322 | PROFIBUS-certified reversed termination horizontal connector. 9-pin Male D-Sub | H2-PBC or any PROFIBUS ISA/PCI Personal Computer Master/Slave Card |

