

Fiberglass In-Line Pushbutton Enclosures – Commander Series

30mm and 22mm with Lift-off Cover



Construction

- Hot compression molded fiberglass reinforced thermoset polyester
- Poured polyurethane seamless gasket provides watertight, dust-tight environmental seal
- Recessed captive stainless steel screws
- 300 Series stainless steel used on all external hardware
- Workable material cuts, drills, punches and saws with ease and accuracy
- Optional mounting feet
- Rounded edges, minimal protrusions or exposed pocket area for accumulation of dust or debris
- Metal grounding strap
- Submersible, non-corrosive environmental design
- Lift-off cover with four cover screws
- Non-conductive, impact-resistant, UV-resistant
- Temperature Range: -40°F to 250°F (-40°C to 120°C)
- Non-flame propagating
- Subpanel not required
- Smooth surface, no color variations, swirls or color pockets, no voids
- Color: Gray

Listings

- UL/cUL File # E64358
- NEMA Ratings 1, 3R, 4X, 6P, and 12 [UL508A, UL50 and UL50e]
- CSA Std. C22.2 File # 1, 3R, 4X, 6P, and 12 per CSA File# LR069014
- IEC 60529 Ratings IP66, IP67, IP68 per UL file# E362920
- UL 1741 File # E333478
- Temperature Range (-76°F to +274°F) (-60°C to +134°C)
- Flammability Rating UL94-5V
 - Self-extinguishing
 - Non-halogenated
 - Non-flame propagating
- NFPA No. 101 Flame Spread Class A (1)
- Certifications cULus, CSA, IEC, REACH, RoHS
- Outdoor UV Exposure (UL 746C) (f1) Rated
- Plenum Space Rating (UL 2043) Yes



Shipping Schedule

Same day 1 - 5 days 1 - 7 days 1 - 15 days 1 - 20 days

Color indicates shipping lead time in business days.

30mm Fiberglass In-Line Pushbutton with Lift-off Cover – Commander Series

Part Number	Price	# Holes	Enclosure Overall Size HxWxD
CO1PB	Retired	1	6.63 x 3.81 x 3.89 [168 x 97 x 99]
CO2PB	Retired	2	6.63 x 3.81 x 3.89 [168 x 97 x 99]
CO3PB	Retired	3	8.88 x 3.81 x 3.89 [226 x 97 x 99]
CO4PB	Retired	4	11.13 x 3.81 x 3.89 [283 x 97 x 99]
CO5PB	Retired	5	13.78 x 3.63 x 3.14 [350 x 92 x 80]
CO6PB	Retired	6	17.35 x 3.63 x 3.14 [441 x 92 x 80]

Notes: Subpanels not required.
Dimensions in inches [millimeters].

CO1PB

22mm Fiberglass Pushbutton Enclosure with Lift-off Cover – Commander Series

Part Number	Price	# Holes	Enclosure Overall Size HxWxD
CO1PB22	Retired	1	6.63 x 3.81 x 3.89 [168 x 97 x 99]
CO2PB22	Retired	2	6.63 x 3.81 x 3.89 [168 x 97 x 99]
CO3PB22	Retired	3	6.63 x 3.81 x 3.89 [168 x 97 x 99]
CO4PB22	Retired	4	8.88 x 3.81 x 3.89 [226 x 97 x 99]
CO5PB22	Retired	5	11.13 x 3.81 x 3.89 [283 x 97 x 99]
CO6PB22	Retired	6	11.13 x 3.81 x 3.89 [283 x 97 x 99]

Notes: Subpanels not required.
Dimensions in inches [millimeters].

CO4PB22

Fiberglass In-Line Pushbutton Enclosures – Commander Series

30mm and 22mm with Lift-off Cover

30mm Dimensions

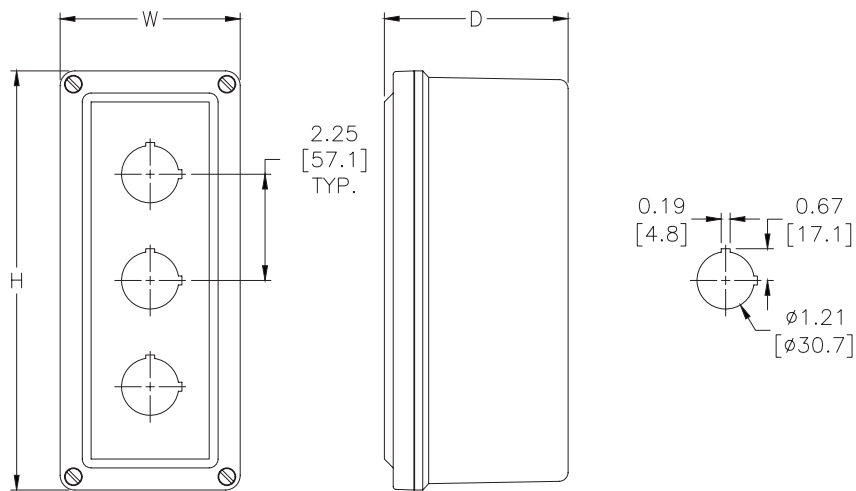

22mm Dimensions

