



Brass Adapter Fittings

NITRA brass fittings are machined from quality brass bar stock or forgings. They work well with air, water, oil, oxygen, nitrogen and argon. Available in most popular styles and sizes, the fittings all have NPT threaded connections.

Features

- 10 different styles
- Machined from yellow brass bar stock or forging
- Work with water, oil, air and other gases
- Maximum pressure of 800 psi

Note: Actual product dimensions and appearance may vary

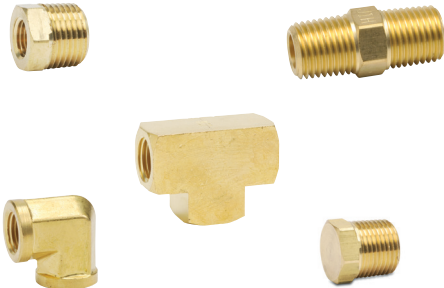

BFMC-14N

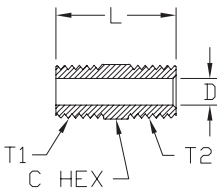

| NITRA™ Male Brass Connectors | | | | | | | | | |
|-----------------------------------|---------|--|---------------|--------|-----|-----|-------|------|-------------|
| Inch Sizes - dimensions in inches | | | | | | | | | |
| Part No. | Price | Description | Parts Per Pkg | Weight | T1 | T2 | C Hex | L | Flow Dia. D |
| BFMC-18N | \$4.00 | Male connector, 1/8 inch NPT to 1/8 inch NPT | 5 | 0.1 | 1/8 | 1/8 | 7/16 | 0.97 | 0.22 |
| BFMC-14N-18N | \$5.75 | Male connector, 1/4 inch NPT to 1/8 inch NPT | 5 | 0.1 | 1/4 | 1/8 | 9/16 | 1.19 | 0.22 |
| BFMC-14N | \$6.00 | Male connector, 1/4 inch NPT to 1/4 inch NPT | 5 | 0.1 | 1/4 | 1/4 | 9/16 | 1.38 | 0.31 |
| BFMC-38N-18N | \$7.50 | Male connector, 3/8 inch NPT to 1/8 inch NPT | 5 | 0.3 | 3/8 | 1/8 | 11/16 | 1.22 | 0.22 |
| BFMC-38N-14N | \$8.25 | Male connector, 3/8 inch NPT to 1/4 inch NPT | 5 | 0.3 | 3/8 | 1/4 | 11/16 | 1.41 | 0.31 |
| BFMC-38N | \$10.00 | Male connector, 3/8 inch NPT to 3/8 inch NPT | 5 | 0.3 | 3/8 | 3/8 | 11/16 | 1.41 | 0.44 |
| BFMC-12N-14N | \$5.25 | Male connector, 1/2 inch NPT to 1/4 inch NPT | 2 | 0.3 | 1/2 | 1/4 | 7/8 | 1.62 | 0.31 |
| BFMC-12N-38N | \$5.25 | Male connector, 1/2 inch NPT to 3/8 inch NPT | 2 | 0.2 | 1/2 | 3/8 | 7/8 | 1.62 | 0.44 |
| BFMC-12N | \$6.00 | Male connector, 1/2 inch NPT to 1/2 inch NPT | 2 | 0.3 | 1/2 | 1/2 | 7/8 | 1.81 | 0.56 |



BFFC-12N-14N

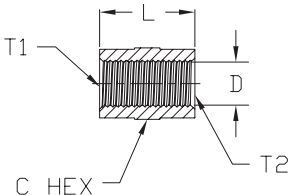

| NITRA™ Female Brass Connectors | | | | | | | | | |
|-----------------------------------|---------|--|---------------|--------|-----|-----|--------|------|-------------|
| Inch Sizes - dimensions in inches | | | | | | | | | |
| Part No. | Price | Description | Parts Per Pkg | Weight | T1 | T2 | C Hex | L | Flow Dia. D |
| BFFC-18N | \$4.50 | Female connector, 1/8 inch NPT to 1/8 inch NPT | 5 | 0.1 | 1/8 | 1/8 | 9/16 | 0.75 | 0.34 |
| BFFC-14N-18N | \$7.00 | Female connector, 1/4 inch NPT to 1/8 inch NPT | 5 | 0.1 | 1/4 | 1/8 | 3/4 | 0.97 | 0.34 |
| BFFC-14N | \$9.25 | Female connector, 1/4 inch NPT to 1/4 inch NPT | 5 | 0.2 | 1/4 | 1/4 | 3/4 | 1.12 | 0.44 |
| BFFC-38N-14N | \$11.50 | Female connector, 3/8 inch NPT to 1/4 inch NPT | 5 | 0.2 | 3/8 | 1/4 | 7/8 | 1.16 | 0.44 |
| BFFC-38N | \$11.50 | Female connector, 3/8 inch NPT to 3/8 inch NPT | 5 | 0.3 | 3/8 | 3/8 | 7/8 | 1.12 | 0.52 |
| BFFC-12N-14N | \$6.50 | Female connector, 1/2 inch NPT to 1/4 inch NPT | 2 | 0.4 | 1/2 | 1/4 | 1-1/16 | 1.28 | 0.44 |
| BFFC-12N-38N | \$5.50 | Female connector, 1/2 inch NPT to 3/8 inch NPT | 2 | 0.2 | 1/2 | 3/8 | 15/16 | 1.32 | 0.52 |
| BFFC-12N | \$7.50 | Female connector, 1/2 inch NPT to 1/2 inch NPT | 2 | 0.4 | 1/2 | 1/2 | 1-1/16 | 1.50 | 0.70 |



Brass Adapter Fittings

Note: Actual product dimensions and appearance may vary



BFMFR-38N-14N

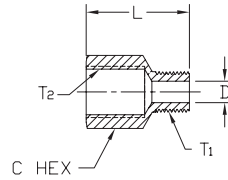

| NITRA™ Male to Female Brass Connectors | | | | | | | | | |
|--|--------|--|---------------|--------|-----|-----|--------|------|-------------|
| Inch Sizes - dimensions in inches | | | | | | | | | |
| Part No. | Price | Description | Parts Per Pkg | Weight | T1 | T2 | C Hex | L | Flow Dia. D |
| BFMFR-14N-18N | \$8.25 | Male to female connector, 1/8 inch NPT male to 1/4 inch NPT female | 5 | 0.1 | 1/4 | 1/8 | 3/4 | 1.06 | 0.22 |
| BFMFR-38N-18N | \$8.25 | Male to female connector, 1/8 inch NPT male to 3/8 inch NPT female | 5 | 0.1 | 3/8 | 1/8 | 7/8 | 1.1 | 0.22 |
| BFMFR-38N-14N | \$9.00 | Male to female connector, 1/4 inch NPT male to 3/8 inch NPT female | 5 | 0.1 | 3/8 | 1/4 | 7/8 | 1.25 | 0.314 |
| BFMFR-12N-38N | \$7.00 | Male to female connector, 3/8 inch NPT male to 1/2 inch NPT female | 5 | 0.4 | 1/2 | 3/8 | 1-1/16 | 1.47 | 0.44 |



BFHB-12N-14N

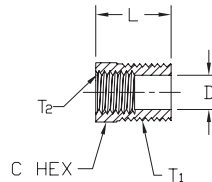

| NITRA™ Brass Hex Bushing | | | | | | | | | |
|-----------------------------------|--------|---|---------------|--------|-----|-----|-------|------|-------------|
| Inch Sizes - dimensions in inches | | | | | | | | | |
| Part No. | Price | Description | Parts Per Pkg | Weight | T1 | T2 | C Hex | L | Flow Dia. D |
| BFHB-14N-18N | \$4.50 | Hex bushing, 1/4 inch NPT male to 1/8 inch NPT female | 5 | 0.3 | 1/4 | 1/8 | 9/16 | 0.75 | 0.34 |
| BFHB-38N-18N | \$6.50 | Hex bushing, 3/8 inch NPT male to 1/8 inch NPT female | 5 | 0.3 | 3/8 | 1/8 | 11/16 | 0.75 | 0.34 |
| BFHB-38N-14N | \$6.50 | Hex bushing, 3/8 inch NPT male to 1/4 inch NPT female | 5 | 0.3 | 3/8 | 1/4 | 3/4 | 0.75 | 0.44 |
| BFHB-12N-18N | \$4.75 | Hex bushing, 1/2 inch NPT male to 1/8 inch NPT female | 2 | 0.3 | 1/2 | 1/8 | 7/8 | 1.0 | 0.34 |
| BFHB-12N-14N | \$4.25 | Hex bushing, 1/2 inch NPT male to 1/4 inch NPT female | 2 | 0.3 | 1/2 | 1/4 | 7/8 | 1.0 | 0.44 |
| BFHB-12N-38N | \$4.25 | Hex bushing, 1/2 inch NPT male to 3/8 inch NPT female | 2 | 0.2 | 1/2 | 3/8 | 7/8 | 1.0 | 0.57 |



BFFE-14N

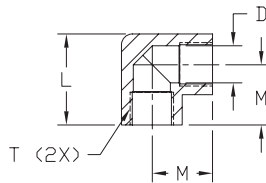

| NITRA™ Brass Female Elbow | | | | | | | | |
|-----------------------------------|--------|-----------------------------------|---------------|--------|-----|------|-------------|------|
| Inch Sizes - dimensions in inches | | | | | | | | |
| Part No. | Price | Description | Parts Per Pkg | Weight | T | M | Flow Dia. D | L |
| BFFE-18N | \$3.75 | Female elbow, 1/8 inch NPT female | 2 | 0.2 | 1/8 | 0.55 | 0.339 | 0.83 |
| BFFE-14N | \$5.25 | Female elbow, 1/4 inch NPT female | 2 | 0.2 | 1/4 | 0.78 | 0.441 | 1.06 |
| BFFE-38N | \$7.50 | Female elbow, 3/8 inch NPT female | 2 | 0.4 | 3/8 | 0.84 | 0.571 | 1.30 |



BFSE-38N

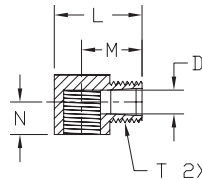

| NITRA™ Female to Male Brass Street Elbow | | | | | | | | | |
|--|---------|---|---------------|--------|-----|------|------|-------------|------|
| Inch Sizes - dimensions in inches | | | | | | | | | |
| Part No. | Price | Description | Parts Per Pkg | Weight | T | M | N | Flow Dia. D | L |
| BFSE-18N | \$2.25 | Street elbow, 1/8 inch NPT female to 1/8 male | 2 | 0.2 | 1/8 | 0.66 | 0.35 | 0.22 | 0.81 |
| BFSE-14N | \$4.00 | Street elbow, 1/4 inch NPT female to 1/4 male | 2 | 0.2 | 1/4 | 0.91 | 0.47 | 0.34 | 1.25 |
| BFSE-38N | \$6.00 | Street elbow, 3/8 inch NPT female to 3/8 male | 2 | 0.3 | 3/8 | 0.97 | 0.49 | 0.41 | 1.42 |
| BFSE-12N | \$12.50 | Street elbow, 1/2 inch NPT female to 1/2 male | 2 | 0.4 | 1/2 | 1.25 | 1.03 | 0.56 | 1.61 |



Brass Adapter Fittings

Note: Actual product dimensions and appearance may vary



BFMT-14N

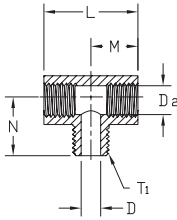

| NITRA™ Brass Male Tee Fittings | | | | | | | | | | |
|-----------------------------------|--------|-----------------------------|---------------|--------|-----|-----|------|------|------|-------------|
| Inch Sizes - dimensions in inches | | | | | | | | | | |
| Part No. | Price | Description | Parts Per Pkg | Weight | T1 | T2 | L | M | N | Flow Dia. D |
| BFMT-18N | \$4.50 | Male tee, 1/8 inch NPT male | 2 | 0.3 | 1/8 | 1/8 | 1.06 | 0.53 | 0.66 | 0.22 |
| BFMT-14N | \$6.50 | Male tee, 1/4 inch NPT male | 2 | 0.3 | 1/4 | 1/4 | 1.52 | 0.76 | 0.91 | 0.31 |
| BFMT-38N | \$9.00 | Male tee, 3/8 inch NPT male | 2 | 0.4 | 3/8 | 3/8 | 1.68 | 0.84 | 0.97 | 0.44 |



BFFT-14N

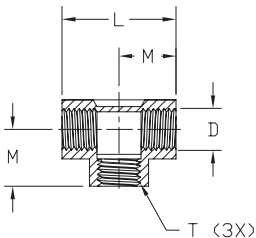

| NITRA™ Brass Female Tee Fittings | | | | | | | | | |
|-----------------------------------|---------|---------------------------------|---------------|--------|-----|------|------|-------------|--|
| Inch Sizes - dimensions in inches | | | | | | | | | |
| Part No. | Price | Description | Parts Per Pkg | Weight | T | L | M | Flow Dia. D | |
| BFFT-18N | \$4.75 | Female tee, 1/8 inch NPT female | 2 | 0.3 | 1/8 | 1.06 | 0.53 | 0.34 | |
| BFFT-14N | \$8.00 | Female tee, 1/4 inch NPT female | 2 | 0.3 | 1/4 | 1.52 | 0.76 | 0.44 | |
| BFFT-38N | \$9.75 | Female tee, 3/8 inch NPT female | 2 | 0.5 | 3/8 | 1.68 | 0.84 | 0.57 | |
| BFFT-12N | \$17.50 | Female tee, 1/2 inch NPT female | 2 | 0.9 | 1/2 | 2.14 | 1.07 | 0.70 | |



BFRHP-38N

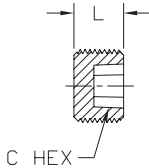

| NITRA™ Brass Recessed Hex Plug Fittings | | | | | | |
|---|--------|--------------------------------------|---------------|--------|-------|------|
| Inch Sizes - dimensions in inches | | | | | | |
| Part No. | Price | Description | Parts Per Pkg | Weight | C Hex | L |
| BFRHP-14N | \$3.00 | Recessed hex plug, 1/4 inch NPT male | 5 | 0.1 | 1/4 | 0.46 |
| BFRHP-38N | \$4.25 | Recessed hex plug, 3/8 inch NPT male | 5 | 0.2 | 5/16 | 0.46 |
| BFRHP-12N | \$8.25 | Recessed hex plug, 1/2 inch NPT male | 5 | 0.2 | 3/8 | 0.61 |



BFHHP-38N

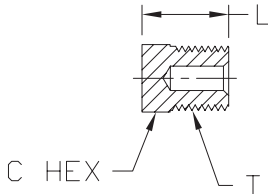

| NITRA™ Brass Hex Plug Fittings | | | | | | | |
|-----------------------------------|--------|----------------------------------|---------------|--------|-----|-------|------|
| Inch Sizes - dimensions in inches | | | | | | | |
| Part No. | Price | Description | Parts Per Pkg | Weight | T | C Hex | L |
| BFHHP-18N | \$2.75 | Hex head plug, 1/8 inch NPT male | 5 | 0.1 | 1/8 | 7/16 | 0.56 |
| BFHHP-14N | \$4.25 | Hex head plug, 1/4 inch NPT male | 5 | 0.1 | 1/4 | 9/16 | 0.75 |
| BFHHP-38N | \$6.25 | Hex head plug, 3/8 inch NPT male | 5 | 0.1 | 3/8 | 11/16 | 0.78 |
| BFHHP-12N | \$8.75 | Hex head plug, 1/2 inch NPT male | 5 | 0.2 | 1/2 | | 0.97 |



Brass Adapter Fittings

Note: Actual product dimensions and appearance may vary



BAHB-316-18N

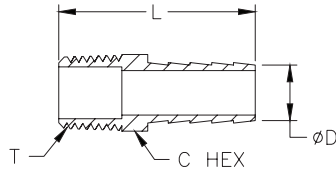

| NITRA™ Brass Straight Barb Fitting | | | | | | | | |
|------------------------------------|---------|--|---------------|--------|-----|-------------|-------------|-------------|
| Inch Sizes - dimensions in inches | | | | | | | | |
| Part No. | Price | Description | Parts Per Pkg | Weight | T | L | ØD | C Hex |
| BAHB-316-18N | \$8.50 | Straight barb, 3/16 inch hose to 1/8 inch male NPT | 5 | 0.1 | 1/8 | 1.20 [305] | 0.20 [5.1] | 0.44 [11.1] |
| BAHB-316-14N | \$8.50 | Straight barb, 3/16 inch hose to 1/4 inch male NPT | 5 | 0.2 | 1/4 | 1.43 [36.2] | 0.20 [5.1] | 0.56 [14.3] |
| BAHB-14-18N | \$5.75 | Straight barb, 1/4 inch hose to 1/8 inch male NPT | 5 | 0.1 | 1/8 | 1.49 [37.7] | 0.24 [6.1] | 0.44 [11.1] |
| BAHB-14-14N | \$7.00 | Straight barb, 1/4 inch hose to 1/4 inch male NPT | 5 | 0.2 | 1/4 | 1.69 [42.9] | 0.24 [6.1] | 0.56 [14.3] |
| BAHB-14-38N | \$10.00 | Straight barb, 1/4 inch hose to 3/8 inch male NPT | 5 | 0.3 | 3/8 | 1.70 [43.3] | 0.24 [6.1] | 0.69 [17.5] |
| BAHB-516-18N | \$8.25 | Straight barb, 5/16 inch hose to 1/8 inch male NPT | 5 | 0.1 | 1/8 | 1.40 [35.6] | 0.29 [7.4] | 0.44 [11.1] |
| BAHB-516-14N | \$6.75 | Straight barb, 5/16 inch hose to 1/4 inch male NPT | 5 | 0.2 | 1/4 | 1.70 [43.3] | 0.29 [7.4] | 0.56 [14.3] |
| BAHB-516-38N | \$15.00 | Straight barb, 5/16 inch hose to 3/8 inch male NPT | 5 | 0.3 | 3/8 | 1.49 [37.8] | 0.29 [7.4] | 0.69 [17.5] |
| BAHB-38-14N | \$7.00 | Straight barb, 3/8 inch hose to 1/4 inch male NPT | 5 | 0.2 | 1/4 | 1.70 [43.3] | 0.36 [9.2] | 0.56 [14.3] |
| BAHB-38-38N | \$9.75 | Straight barb, 3/8 inch hose to 3/8 inch male NPT | 5 | 0.3 | 3/8 | 1.70 [43.3] | 0.36 [9.2] | 0.69 [17.4] |
| BAHB-38-12N | \$16.50 | Straight barb, 3/8 inch hose to 1/2 inch male NPT | 5 | 0.5 | 1/2 | 1.89 [48.0] | 0.36 [9.2] | 0.88 [22.2] |
| BAHB-12-14N | \$9.50 | Straight barb, 1/2 inch hose to 1/4 inch male NPT | 5 | 0.3 | 1/4 | 1.70 [43.3] | 0.48 [12.3] | 0.56 [14.3] |
| BAHB-12-38N | \$10.50 | Straight barb, 1/2 inch hose to 3/8 inch male NPT | 5 | 0.3 | 3/8 | 1.76 [44.8] | 0.48 [12.3] | 0.69 [17.5] |
| BAHB-12-12N | \$15.00 | Straight barb, 1/2 inch hose to 1/2 inch male NPT | 5 | 0.5 | 1/2 | 1.86 [47.2] | 0.48 [12.3] | 0.88 [22.2] |
| BAHB-58-38N | \$10.00 | Straight barb, 5/8 inch hose to 3/8 inch male NPT | 3 | 0.2 | 3/8 | 1.84 [46.7] | 0.60 [15.3] | 0.88 [22.2] |
| BAHB-58-12N | \$11.00 | Straight barb, 5/8 inch hose to 1/2 inch male NPT | 3 | 0.4 | 1/2 | 1.98 [50.4] | 0.60 [15.3] | 0.88 [22.2] |
| BAHB-58-34N | \$18.00 | Straight barb, 5/8 inch hose to 3/4 inch male NPT | 3 | 0.5 | 3/4 | 1.89 [48.1] | 0.60 [15.3] | 1.06 [27.0] |
| BAHB-34-12N | \$12.00 | Straight barb, 3/4 inch hose to 1/2 inch male NPT | 3 | 0.4 | 1/2 | 1.99 [50.5] | 0.73 [18.5] | 0.88 [22.2] |
| BAHB-34-34N | \$15.00 | Straight barb, 3/4 inch hose to 3/4 inch male NPT | 3 | 0.3 | 3/4 | 2.03 [51.6] | 0.73 [18.5] | 1.06 [27.0] |
| BAHB-34-1N | \$30.00 | Straight barb, 3/4 inch hose to 1 inch male NPT | 3 | 0.8 | 1 | 2.25 [57.2] | 0.73 [18.5] | 1.38 [34.9] |
| BAHB-1-34N | \$6.00 | Straight barb, 1 inch hose to 3/4 inch male NPT | 1 | 0.2 | 3/4 | 2.17 [55.0] | 0.99 [25.1] | 1.06 [27.0] |
| BAHB-1-1N | \$11.00 | Straight barb, 1 inch hose to 1 inch male NPT | 1 | 0.3 | 1 | 2.36 [60.0] | 0.99 [25.1] | 1.38 [34.9] |



Brass Adapter Fittings

Note: Actual product dimensions and appearance may vary



BAHBL-316-18N

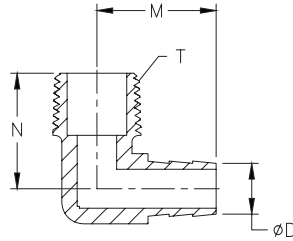

NITRA™ Brass Male Elbow Barb Fitting

Inch Sizes - dimensions in inches

| Part No. | Price | Description | Parts Per Pkg | Weight | T | M | N | ØD |
|----------------------|---------|--|---------------|--------|-----|-------------|-------------|-------------|
| BAHBL-316-18N | \$16.50 | Male elbow barb, 3/16 inch hose to 1/8 inch male NPT | 5 | 0.1 | 1/8 | 0.95 [24.0] | 0.71 [18.2] | 0.20 [5.1] |
| BAHBL-316-14N | \$21.00 | Male elbow barb, 3/16 inch hose to 1/4 inch male NPT | 5 | 0.3 | 1/4 | 1.00 [25.4] | 0.83 [21.1] | 0.20 [5.1] |
| BAHBL-14-18N | \$16.50 | Male elbow barb, 1/4 inch hose to 1/8 inch male NPT | 5 | 0.2 | 1/8 | 1.25 [31.8] | 0.60 [15.3] | 0.24 [6.1] |
| BAHBL-14-14N | \$21.00 | Male elbow barb, 1/4 inch hose to 1/4 inch male NPT | 5 | 0.3 | 1/4 | 1.33 [33.8] | 0.84 [21.4] | 0.24 [6.1] |
| BAHBL-14-38N | \$35.00 | Male elbow barb, 1/4 inch hose to 3/8 inch male NPT | 5 | 0.4 | 3/8 | 1.22 [31.0] | 0.94 [23.9] | 0.24 [6.1] |
| BAHBL-516-18N | \$18.50 | Male elbow barb, 5/16 inch hose to 1/8 inch male NPT | 5 | 0.2 | 1/8 | 1.01 [25.6] | 0.82 [20.8] | 0.29 [7.4] |
| BAHBL-516-14N | \$30.00 | Male elbow barb, 5/16 inch hose to 1/4 inch male NPT | 5 | 0.3 | 1/4 | 1.02 [25.8] | 0.87 [22.1] | 0.29 [7.4] |
| BAHBL-516-38N | \$38.00 | Male elbow barb, 5/16 inch hose to 3/8 inch male NPT | 5 | 0.4 | 3/8 | 1.22 [31.1] | 0.90 [22.9] | 0.29 [7.4] |
| BAHBL-38-14N | \$16.50 | Male elbow barb, 3/8 inch hose to 1/4 inch male NPT | 5 | 0.4 | 1/4 | 1.32 [33.4] | 0.83 [21.1] | 0.36 [9.2] |
| BAHBL-38-38N | \$22.00 | Male elbow barb, 3/8 inch hose to 3/8 inch male NPT | 5 | 0.6 | 3/8 | 1.42 [35.9] | 0.95 [24.0] | 0.36 [9.2] |
| BAHBL-38-12N | \$37.00 | Male elbow barb, 3/8 inch hose to 1/2 inch male NPT | 5 | 0.5 | 1/2 | 1.12 [28.6] | 1.04 [26.5] | 0.36 [9.2] |
| BAHBL-12-14N | \$22.50 | Male elbow barb, 1/2 inch hose to 1/4 inch male NPT | 5 | 0.4 | 1/4 | 1.29 [32.7] | 0.98 [24.9] | 0.48 [12.3] |
| BAHBL-12-38N | \$37.00 | Male elbow barb, 1/2 inch hose to 3/8 inch male NPT | 5 | 0.5 | 3/8 | 1.36 [34.6] | 1.01 [25.5] | 0.48 [12.3] |
| BAHBL-12-12N | \$32.00 | Male elbow barb, 1/2 inch hose to 1/2 inch male NPT | 5 | 0.6 | 1/2 | 1.14 [28.8] | 1.10 [28.0] | 0.48 [12.3] |
| BAHBL-58-38N | \$25.00 | Male elbow barb, 5/8 inch hose to 3/8 inch male NPT | 3 | 0.4 | 3/8 | 1.45 [37.0] | 1.16 [29.5] | 0.60 [15.3] |
| BAHBL-58-12N | \$29.50 | Male elbow barb, 5/8 inch hose to 1/2 inch male NPT | 3 | 0.5 | 1/2 | 1.45 [37.0] | 1.14 [29.1] | 0.60 [15.3] |
| BAHBL-34-12N | \$37.00 | Male elbow barb, 3/4 inch hose to 1/2 inch male NPT | 3 | 0.6 | 1/2 | 1.35 [34.4] | 1.25 [31.8] | 0.73 [18.5] |
| BAHBL-34-34N | \$54.00 | Male elbow barb, 3/4 inch hose to 3/4 inch male NPT | 3 | 0.7 | 3/4 | 1.54 [39.0] | 1.31 [33.2] | 0.73 [18.5] |
| BAHBL-1-34N | \$22.00 | Male elbow barb, 1 inch hose to 3/4 inch male NPT | 1 | 0.4 | 3/4 | 1.70 [43.1] | 1.42 [36.2] | 0.99 [25.1] |
| BAHBL-1-1N | \$38.00 | Male elbow barb, 1 inch hose to 1 inch male NPT | 1 | 0.4 | 1 | 1.78 [45.2] | 1.63 [41.5] | 0.99 [25.1] |



BAHM-58

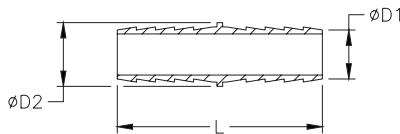

NITRA™ Brass Hose Mender Fitting

Inch Sizes - dimensions in inches

| Part No. | Price | Description | Parts Per Pkg | Weight | L | ØD1 | ØD2 |
|-----------------|---------|--|---------------|--------|-------------|-------------|-------------|
| BAHM-316 | \$5.25 | Hose mender, 3/16 inch hose to 1/8 inch male NPT | 5 | 0.1 | 1.45 [36.7] | 0.20 [5.1] | 0.23 [5.8] |
| BAHM-14 | \$6.75 | Hose mender, 3/16 inch hose to 1/4 inch male NPT | 5 | 0.1 | 2.00 [50.8] | 0.24 [6.1] | 0.50 [12.7] |
| BAHM-516 | \$8.50 | Hose mender, 1/4 inch hose to 1/8 inch male NPT | 5 | 0.1 | 1.67 [42.4] | 0.29 [7.4] | 0.36 [9.1] |
| BAHM-38 | \$9.50 | Hose mender, 1/4 inch hose to 1/4 inch male NPT | 5 | 0.2 | 2.00 [50.8] | 0.36 [9.2] | 0.50 [12.7] |
| BAHM-12 | \$12.50 | Hose mender, 1/4 inch hose to 3/8 inch male NPT | 5 | 0.3 | 2.01 [51.1] | 0.48 [12.3] | 0.63 [15.9] |
| BAHM-58 | \$9.25 | Hose mender, 5/16 inch hose to 1/8 inch male NPT | 3 | 0.3 | 2.29 [58.0] | 0.60 [15.3] | 0.75 [19.1] |
| BAHM-34 | \$11.50 | Hose mender, 5/16 inch hose to 1/4 inch male NPT | 3 | 0.3 | 2.00 [50.8] | 0.73 [18.5] | 0.88 [22.2] |
| BAHM-1 | \$13.50 | Hose mender, 5/16 inch hose to 3/8 inch male NPT | 3 | 0.6 | 2.49 [63.2] | 0.99 [25.1] | 1.19 [30.2] |