



# Air or Water Threaded Fittings with Strain Relief



NITRA™ air or water threaded fittings with strain relief are excellent for use on our Hybrid PVC polyester reinforced hose. They are comprised of a nickel-plated brass body and threads with an impact resistant acetal strain relief. Threaded sealant is pre-applied.

### Features

- Available in either 1/4" or 3/8" MNPT
- Nickel-plated brass
- Pre-applied thread sealant

Air or Water Threaded Fittings with Strain Relief			
Part Number	Price	Description	Package Weight (lbs)
<a href="#">HSR14-14N</a>	\$6.75	NITRA air or water threaded fitting, male, hose rigid, nickel-plated brass body, nickel-plated brass threads, thread sealant, 1/4in inside diameter to 1/4in male NPT with strain relief.	0.2
<a href="#">HSR38-14N</a>	\$7.00	NITRA air or water threaded fitting, male, hose rigid, nickel-plated brass body, nickel-plated brass threads, thread sealant, 3/8in inside diameter to 1/4in male NPT with strain relief.	0.3
<a href="#">HSR38-38N</a>	\$10.00	NITRA air or water threaded fitting, male, hose rigid, nickel-plated brass body, nickel-plated brass threads, thread sealant, 3/8in inside diameter to 3/8in male NPT with strain relief.	0.3

### Threaded Fitting Application Illustration

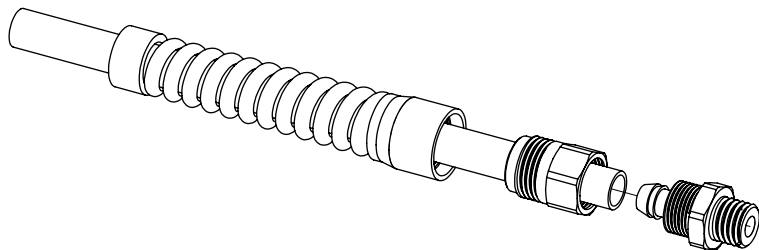



# Hybrid PVC Hose



NITRA™ Hybrid PVC hose is a blend of PVC and rubber with a polyester braided reinforcement. The PVC gives light weight, color stability and hardness for higher working pressures while the rubber gives improved flexibility and operating temperature range. Our Hybrid PVC polyester reinforced hose is sold with or without male NPT nickel-plated brass rigid fittings (additional fittings may be purchased separately).

## Features

- 1/4" and 3/8" inside diameters
- 25 and 50 foot hose lengths with fittings
- 100, 250 and 500 foot bulk hose lengths without fittings
- Works with air or water
- Black with Green Stripe color
- Shore A 62 hardness
- Strong, flexible and kink resistant



Hybrid PVC Hose								
<b>Working Pressure (psi) @ 68°F</b>		300		<b>Temp. Range</b>		-40°F to +180°F (-40°C to +82°C)		
<b>Burst Pressure (psi) @ 68°F</b>		900		<b>Hardness</b>		Shore A 62		
Part Number	Price	Hose I.D. (in)	Hose O.D. (in)	Wall Thickness (in)	Fittings	Min. Bend Radius	PKG Length	Package Weight (lbs)
<a href="#">HPVC14-25BG2</a>	\$28.00	1/4	7/16	0.09	1/4 in MNPT	1.00"	25 ft	1.5
<a href="#">HPVC14-50BG2</a>	\$34.00						50 ft	2.9
<a href="#">HPVC38-25BG3</a>	\$37.00	3/8	9/16	0.09	3/8 in MNPT	1.63"	25 ft	2.3
<a href="#">HPVC38-50BG3</a>	\$50.00						50 ft	4.5
<a href="#">HPVC14-100BG</a>	\$46.00	1/4	7/16	0.09	NA	1.00"	100 ft	5.8
<a href="#">HPVC14-250BG</a>	\$114.00				NA		250 ft	14.6
<a href="#">HPVC14-500BG</a>	\$222.00				NA		500 ft	29.2
<a href="#">HPVC38-100BG</a>	\$63.00	3/8	9/16	0.09	NA	1.63"	100 ft	9.0
<a href="#">HPVC38-250BG</a>	\$165.00				NA		250 ft	22.6
<a href="#">HPVC38-500BG</a>	\$342.00				NA		500 ft	45.1

## Dimensions

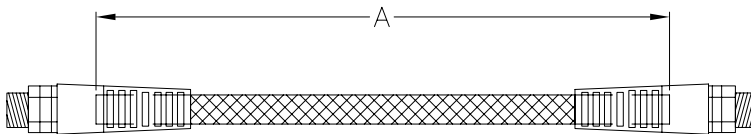

Table 1	
Part Number	DIM A (OVERALL LENGTH)
HPVC14-25BG2	25'
HPVC14-50BG2	50'
HPVC38-25BG3	25'
HPVC38-50BG3	50'