

# NEMA 4, 4x, 12 and 13 Stainless Steel Single-Door Wall Mount (Ultimate Series)



## Application

The Hubbell/Wiegmann N412-SS stainless steel series, with its streamlined design, is a perfect fit for mounting electrical or high-tech electronic equipment in a variety of indoor and outdoor settings. It is typically used in the following areas where corrosion-resistant protection is needed: food processing plants, pharmaceutical manufacturing facilities, petrochemical plants, pulp and paper processing, and waste water treatment facilities.



- removable [open to 90° to remove door]
- 1/4 turn semi-flush oil tight latches are supplied to hold door securely closed
- Mounting holes in rear of enclosure
- Optional N412MFKSS mounting foot kit is required to maintain the NEMA Types 4, 4X, 12 and 13 ratings. Mounting foot kit must be ordered separately.

## Finish

- All exterior surfaces have a smooth grained finish
- Painted steel subpanels are painted white polyester powder over phosphatized surfaces
- Galvanized and stainless subpanels are a conductive finish [unpainted]

## Construction

- Bodies and doors fabricated from 14 or 16 gauge type 304 or 316L stainless steel
- Doors are sealed with poured-in-place polyurethane gasket
- Concealed hinges
- Increased tub openings to accommodate larger size [optional] subpanels
- Collar studs for mounting optional subpanels
- Grounding provisions provided
- Optional subpanels must be ordered separately
- Swing-out panel kits WAJCDFK and WANADFK will not work with these enclosures.
- Doors are interchangeable and easily

## Listings

- UL 508, Types 4, 4X, 12, and 13 [UL file E64791]
- CSA Certified, Types 4, 4X, 12, and 13 [CSA file LL66078]
- Meets NEMA/EEMAC Types 4, 4X, 12, and 13 requirements
- Wall mounting brackets required to maintain UL/CSA external mounting requirements



Enclosure Shipping Schedule		
Same day	1 - 7 days	1 - 10 days

Color indicates shipping lead time in business days.

FOR CURRENT LISTINGS, PLEASE SEE WWW.AUTOMATIONDIRECT.COM

NEMA 4, 4x, 12 and 13 Stainless Steel Single-Door Wall Mount (Ultimate Series)									
304 Stainless Steel	Price	316L Stainless Steel	Price	Enclosure Size HxWxD	Steel Gauge	Painted Steel Subpanel	Stainless Steel Subpanel	Galvanized Subpanel	Swing-Out Panel
<b>N412121206SSC</b>	\$511.00	<b>N412121206SSAC</b>	\$679.00	12x12x6 [305x305x152]	16	<b>NP1212C</b>	-	<b>NP1212CG</b>	<b>HFWNSP1212C</b>
<b>N412161206SSC</b>	\$558.00	<b>N412161206SSAC</b>	\$716.00	16x12x6 [406x305x152]	16	<b>NP1612C</b>	<b>NP1612SSC</b>	<b>NP1612CG</b>	<b>HFWNSP1612C</b>
<b>N412161208SSC</b>	\$544.00	<b>N412161208SSAC</b>	\$844.00	16x12x8 [406x305x203]	16	<b>NP1612C</b>	<b>NP1612SSC</b>	<b>NP1612CG</b>	<b>HFWNSP1612C</b>
<b>N412161210SSC</b>	\$581.00	<b>N412161210SSAC</b>	\$743.00	16x12x10 [406x305x254]	16	<b>NP1612C</b>	<b>NP1612SSC</b>	<b>NP1612CG</b>	<b>HFWNSP1612C</b>
<b>N412161606SSC</b>	\$618.00	<b>N412161606SSAC</b>	\$871.00	16x16x6 [406x406x152]	16	<b>NP1616C</b>	<b>NP1616SSC</b>	<b>NP1616CG</b>	<b>HFWNSP1616C</b>
<b>N412161608SSC</b>	\$651.00	<b>N412161608SSAC</b>	\$1,025.00	16x16x8 [406x406x203]	16	<b>NP1616C</b>	<b>NP1616SSC</b>	<b>NP1616CG</b>	<b>HFWNSP1616C</b>
<b>N412161610SSC</b>	\$661.00	<b>N412161610SSAC</b>	\$847.00	16x16x10 [406x406x254]	16	<b>NP1616C</b>	<b>NP1616SSC</b>	<b>NP1616CG</b>	<b>HFWNSP1616C</b>
<b>N412162008SSC</b>	\$727.00	<b>N412162008SSAC</b>	\$935.00	16x20x8 [406x508x203]	16	<b>NP2016C</b>	<b>NP2016SSC</b>	<b>NP2016CG</b>	<b>HFWNSP1620C</b>
<b>N412162010SSC</b>	\$739.00	<b>N412162010SSAC</b>	\$945.00	16x20x10 [406x508x254]	16	<b>NP2016C</b>	<b>NP2016SSC</b>	<b>NP2016CG</b>	<b>HFWNSP1620C</b>
<b>N412201606SSC</b>	\$682.00	<b>N412201606SSAC</b>	\$814.00	20x16x6 [508x406x152]	16	<b>NP2016C</b>	<b>NP2016SSC</b>	<b>NP2016CG</b>	<b>HFWNSP2016C</b>
<b>N412201608SSC</b>	\$727.00	<b>N412201608SSAC</b>	\$935.00	20x16x8 [508x406x203]	16	<b>NP2016C</b>	<b>NP2016SSC</b>	<b>NP2016CG</b>	<b>HFWNSP2016C</b>
<b>N412201610SSC</b>	\$718.00	<b>N412201610SSAC</b>	\$919.00	20x16x10 [508x406x254]	16	<b>NP2016C</b>	<b>NP2016SSC</b>	<b>NP2016CG</b>	<b>HFWNSP2016C</b>

Note: Subpanels must be ordered separately. Dimensions in inches [millimeters]; letters in table correspond to letters on dimensional drawings.

# NEMA 4, 4X, 12 and 13 Stainless Steel Single-Door Wall Mount (Ultimate Series)



Enclosure Shipping Schedule		
Same day	1 - 7 days	1 - 10 days
Color indicates shipping lead time in business days.		

NEMA 4, 4x, 12 and 13 Stainless Steel Single-Door Wall Mount (Ultimate Series) – [cont.]									
304 Stainless Steel	Price	316L Stainless Steel	Price	Enclosure Size HxWxD	Steel Gauge	Painted Steel Subpanel	Stainless Steel Subpanel	Galvanized Subpanel	Swing-Out Panel
N412202006SSC	\$749.00	N412202006SSAC	\$869.00	20x20x6 [508x508x152]	16	NP2020C	NP2020SSC	NP2020CG	HFWNSP2020C
N412202008SSC	\$805.00	N412202008SSAC	\$1,090.00	20x20x8 [508x508x203]	16	NP2020C	NP2020SSC	NP2020CG	HFWNSP2020C
N412202010SSC	\$802.00	N412202010SSAC	\$1,026.00	20x20x10 [508x508x254]	16	NP2020C	NP2020SSC	NP2020CG	HFWNSP2020C
N412202012SSC	\$848.00	N412202012SSAC	\$1,290.00	20x20x12 [508x508x305]	16	NP2020C	NP2020SSC	NP2020CG	HFWNSP2020C
N412241608SSC	\$755.00	N412241608SSAC	\$1,056.00	24x16x8 [610x406x203]	16	NP2416C	NP2416SSC	NP2416CG	HFWNSP2416C
N412241610SSC	\$790.00	N412241610SSAC	\$1,011.00	24x16x10 [610x406x254]	16	NP2416C	NP2416SSC	NP2416CG	HFWNSP2416C
N412242008SSC	\$881.00	N412242008SSAC	\$1,133.00	24x20x8 [610x508x203]	16	NP2420C	NP2420SSC	NP2420CG	HFWNSP2420C
N412242010SSC	\$877.00	N412242010SSAC	\$1,123.00	24x20x10 [610x508x254]	16	NP2420C	NP2420SSC	NP2420CG	HFWNSP2420C
N412242408SSC	\$988.00	N412242408SSAC	\$1,270.00	24x24x8 [610x610x203]	14	NP2424C	NP2424SSC	NP2424CG	HFWNSP2424C
N412242410SSC	\$1,013.00	N412242410SSAC	\$1,296.00	24x24x10 [610x610x254]	14	NP2424C	NP2424SSC	NP2424CG	HFWNSP2424C
N412242412SSC	\$1,175.00	N412242412SSAC	\$1,533.00	24x24x12 [610x610x305]	14	NP2424C	NP2424SSC	NP2424CG	HFWNSP2424C
N412302408SSC	\$1,122.00	N412302408SSAC	\$1,441.00	30x24x8 [762x610x203]	14	NP3024C	NP3024SSC	NP3024CG	HFWNSP3024C
N412302410SSC	\$1,140.00	N412302410SSAC	\$1,459.00	30x24x10 [762x610x254]	14	NP3024C	NP3024SSC	NP3024CG	HFWNSP3024C
N412302412SSC	\$1,283.00	N412302412SSAC	\$1,635.00	30x24x12 [762x610x305]	14	NP3024C	NP3024SSC	NP3024CG	HFWNSP3024C
N412303008SSC	\$1,282.00	N412303008SSAC	\$1,751.00	30x30x8 [762x762x203]	14	NP3030C	NP3030SSC	NP3030CG	HFWNSP3030C
N412303010SSC	\$1,339.00	N412303010SSAC	\$1,715.00	30x30x10 [762x762x254]	14	NP3030C	NP3030SSC	NP3030CG	HFWNSP3030C
N412362408SSC	\$1,262.00	N412362408SSAC	\$1,701.00	36x24x8 [914x610x203]	14	NP3624C	NP3624SSC	NP3624CG	HFWNSP3624C
N412362410SSC	\$1,288.00	N412362410SSAC	\$1,649.00	36x24x10 [914x610x254]	14	NP3624C	NP3624SSC	NP3624CG	HFWNSP3624C
N412362412SSC	\$1,366.00	N412362412SSAC	\$1,751.00	36x24x12 [914x610x305]	14	NP3624C	NP3624SSC	NP3624CG	HFWNSP3624C
N412363008SSC	\$1,441.00	N412363008SSAC	\$1,850.00	36x30x8 [914x762x203]	14	NP3630C	NP3630SSC	NP3630CG	HFWNSP3630C
N412363010SSC	\$1,506.00	N412363010SSAC	\$1,927.00	36x30x10 [914x762x254]	14	NP3630C	NP3630SSC	NP3630CG	HFWNSP3630C
N412363012SSC	\$1,681.00	N412363012SSAC	\$2,084.00	36x30x12 [914x762x305]	14	NP3630C	NP3630SSC	NP3630CG	HFWNSP3630C

Note: Subpanels must be ordered separately. Dimensions in inches [millimeters]; letters in table correspond to letters on dimensional drawings.

# NEMA 4, 4X, 12 and 13 Stainless Steel Single-Door Wall Mount [Ultimate Series]



Enclosure Shipping Schedule		
Same day	1 - 7 days	1 - 10 days
Color indicates shipping lead time in business days.		

NEMA 4, 4x, 12 and 13 Stainless Steel Single-Door Wall Mount (Ultimate Series) – [cont.]									
304 Stainless Steel	Price	316L Stainless Steel	Price	Enclosure Size HxWxD	Steel Gauge	Painted Steel Subpanel	Stainless Steel Subpanel	Galvanized Subpanel	Swing-Out Panel
<b>N412363610SSC</b>	\$1,612.00	<b>N412363610SSAC</b>	\$2,063.00	36x36x10 [914x914x254]	14	<b>NP3636C</b>	<b>NP3636SSC</b>	<b>NP3636CG</b>	<b>HFWN3636C</b>
<b>N412363612SSC</b>	\$1,826.00	<b>N412363612SSAC</b>	\$2,492.00	36x36x12 [914x914x254]	14	<b>NP3636C</b>	<b>NP3636SSC</b>	<b>NP3636CG</b>	<b>HFWN3636C</b>
<b>N412423610SSC</b>	\$1,807.00	<b>N412423610SSAC</b>	\$2,314.00	42x36x10 [1067x914x254]	14	<b>NP4236C</b>	<b>NP4236SSC</b>	<b>NP4236CG</b>	-
<b>N412423612SSC</b>	\$2,025.00	<b>N412423612SSAC</b>	\$2,761.00	42x36x12 [1067x914x305]	14	<b>NP4236C</b>	<b>NP4236SSC</b>	<b>NP4236CG</b>	-
<b>N412483610SSC</b>	\$1,966.00	<b>N412483610SSAC</b>	\$2,517.00	48x36x10 [1219x914x254]	14	<b>NP4836C</b>	<b>NP4836SSC</b>	<b>NP4836CG</b>	-
<b>N412483612SSC</b>	\$2,227.00	<b>N412483612SSAC</b>	\$3,041.00	48x36x12 [1219x914x305]	14	<b>NP4836C</b>	<b>NP4836SSC</b>	<b>NP4836CG</b>	-
<b>N412603610SSC</b>	\$2,226.00	<b>N412603610SSAC</b>	\$2,849.00	60x36x10 [1524x914x254]	14	<b>NP6036C</b>	<b>NP6036SSC</b>	<b>NP6036CG</b>	-
<b>N412603612SSC</b>	\$2,391.00	<b>N412603612SSAC</b>	\$3,589.00	60x36x12 [1524x914x305]	14	<b>NP6036C</b>	<b>NP6036SSC</b>	<b>NP6036CG</b>	-

**Note:** Subpanels must be ordered separately. Dimensions in inches [millimeters]; letters in table correspond to letters on dimensional drawings.

## Dimensions in [mm]

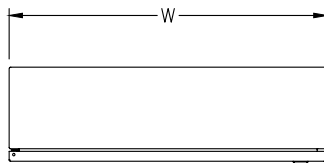

### NOTE:

- ENCLOSURES INCLUDE A 3-POINT LATCH WHEN H=40" OR MORE.
- TWO HINGES PROVIDED WHEN H=36". THREE HINGES PROVIDED WHEN H=36" OR GREATER. FOUR HINGES PROVIDED WHEN H=48" OR GREATER.
- ENCLOSURES SMALLER THAN 24"x24" ONLY HAVE ONE LATCH.

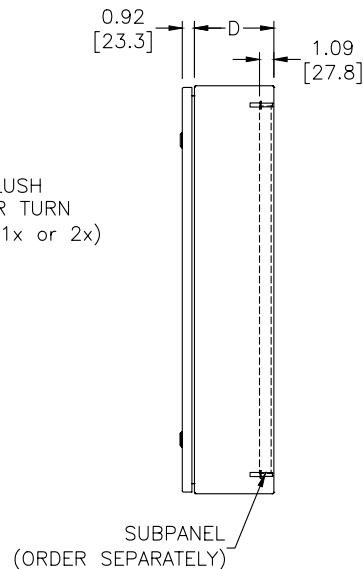
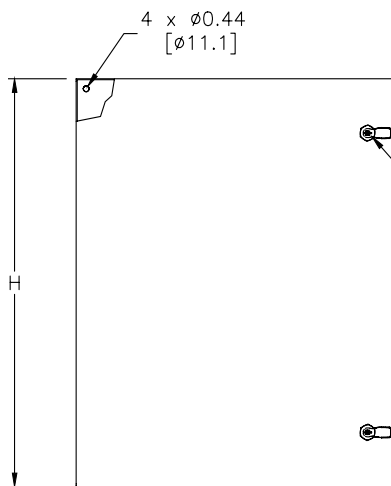

See our website: [www.AutomationDirect.com](http://www.AutomationDirect.com) for complete engineering drawings.

# Enclosure Subpanels



## Subpanels for Ultimate Series Wall Mount Enclosures

- 12 gauge steel
- Subpanels with dimensions 30" x 30" and larger are flanged on all sides. Smaller subpanels are flanged on two sides
- Painted steel subpanels are white polyester powder over phosphatized surfaces
- Galvanized subpanels have a conductive finish (no paint)



### Dimensions in [mm]

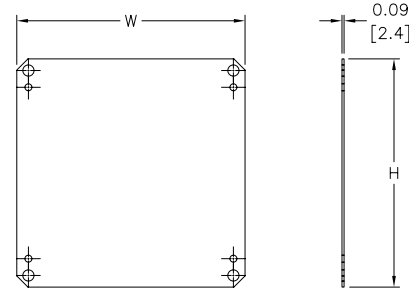

Panels listed fit all styles of N412 Ultimate Series wall mount enclosures, including slope top and disconnect enclosures.

**NOTE:** NPxxxxC subpanels will not fit in older NEMA 4/12 enclosures (purchased prior to 3-23-05) that do not have a C suffix. For example: Subpanel NP1212C will not fit enclosures N412121206 or N412121206SS.

Enclosure Shipping Schedule	
Same day	1 - 7 days
Color indicates shipping lead time in business days.	

Subpanels for Ultimate Series Wall Mount Enclosures							
Painted Steel	Price	Galvanized	Price	304 Stainless Steel	Price	Nominal Enclosure Size HxW*	Subpanel Size AxB
NP1212C	\$16.00	NP1212CG	\$16.00	—		12 x 12	10.20 x 10.20 [259 x 259]
NP1612C	\$19.50	NP1612CG	\$19.50	NP1612SSC	\$101.00	16 x 12	14.20 x 10.20 [361 x 259]
NP1616C	\$26.50	NP1616CG	\$26.50	NP1616SSC	\$70.00	16 x 16	14.20 x 14.20 [361 x 361]
NP2016C	\$26.50	NP2016CG	\$26.50	NP2016SSC	\$70.00	16 x 20 20 x 16	18.20 x 14.20 [462 x 361]
NP2020C	\$33.00	NP2020CG	\$33.00	NP2020SSC	\$93.00	20 x 20	18.20 x 18.20 [462 x 462]
NP2416C	\$37.00	NP2416CG	\$37.00	NP2416SSC	\$105.00	24 x 16	22.20 x 14.20 [564 x 361]
NP2420C	\$45.00	NP2420CG	\$45.00	NP2420SSC	\$119.00	24 x 20	22.20 x 18.20 [564 x 462]
NP2424C	\$47.50	NP2424CG	\$47.50	NP2424SSC	\$128.00	24 x 24	22.20 x 22.20 [564 x 564]
NP3020C	\$60.00	NP3020CG	\$60.00	—		30 x 20	28.20 x 18.20 [716 x 462]
NP3024C	\$57.00	NP3024CG	\$57.00	NP3024SSC	\$155.00	30 x 24	28.20 x 22.20 [716 x 564]
NP3030C	\$97.00	NP3030CG	\$97.00	NP3030SSC	\$276.00	30 x 30	28.20 x 28.20 [716 x 716]
NP3624C	\$75.00	NP3624CG	\$75.00	NP3624SSC	\$213.00	36 x 24	34.20 x 22.20 [869 x 564]
NP3630C	\$99.00	NP3630CG	\$99.00	NP3630SSC	\$263.00	36 x 30	34.20 x 28.20 [869 x 716]
NP3636C	\$117.00	NP3636CG	\$117.00	NP3636SSC	\$318.00	36 x 36	34.20 x 34.20 [869 x 869]
NP4024C	\$99.00	NP4024CG	\$99.00	—		40 x 24	38.20 x 22.20 [970 x 564]
NP4230C	\$126.00	—		—		42 x 32	40.20 x 28.20 [1021 x 716]
NP4236C	\$148.00	NP4236CG	\$148.00	NP4236SSC	\$411.00	42 x 36	40.20 x 34.20 [1021 x 869]
NP4824C	\$107.00	NP4824CG	\$107.00	—		48 x 24	46.20 x 22.20 [1173 x 564]
NP4836C	\$168.00	NP4836CG	\$168.00	NP4836SSC	\$446.00	48 x 36	46.20 x 34.20 [1173 x 869]
NP6036C	\$188.00	NP6036CG	\$188.00	NP6036SSC	\$535.00	60 x 36	58.20 x 34.20 [1478 x 869]

**Notes:** Dimensions in inches [millimeters].  
 Letters in table correspond to letters on dimensional drawing.  
 \*Disconnect enclosures will be up to 2 inches [51mm] wider than width dimensions in this table.

# Swing-Out Panels for Ultimate Series Enclosures

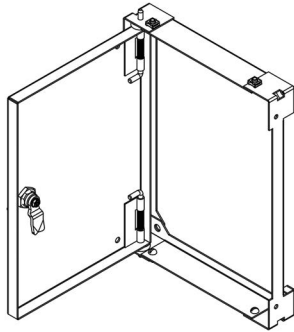

For N412 Ultimate Series Wall Mount Enclosures except N412-1PTC, -3PTC, -SS1PTC, -SS3PTC, -SSA1PTC, and -SSA3PTC

- Maximum swing 107 degrees
- Convenient access to sub enclosure is provided via 1/4 turn pull-tab
- On solid doors, the clearance from the swing panel face to the interior door face is 1-1/4", and 1" on window doors (when the door is closed)
- The kit includes the swing panel, brackets and hardware necessary for a tub flange install. Swing out panels meet Type 1 with enclosure door open
- Painted steel subpanels are painted white polyester powder over phosphated surfaces
- Fabricated from 14 gauge steel
- Mounting hardware is furnished with each panel

Enclosure Shipping Schedule
1 -10 days
Color indicates shipping lead time in business days.

**NOTE:** HFWNSPxxxC swing-out panels will not fit in older NEMA 4/12 enclosures (purchased prior to 3-23-05) that do not have a C suffix. For example: Swing-out panel HFWNSP1212C will not fit enclosures N41212126 or N412121206SS.



Swing-Out Panels for Ultimate Series Enclosures				
Part Number	Price	Panel Size CxE	Overall Dimensions HxW	Nominal Enclosure Nominal Size
HFWNSP1212C	\$85.00	9.75 x 9.75 [248 x 248]	10.50 x 10.62 [267 x 270]	12 x 12
HFWNSP1612C	\$89.00	13.75 x 9.75 [349 x 248]	14.50 x 10.62 [368 x 270]	16 x 12
HFWNSP1616C	\$93.00	13.75 x 13.75 [349 x 349]	14.50 x 14.62 [368 x 37]	16 x 16
HFWNSP1620C	\$98.00	13.75 x 17.75 [349 x 451]	14.50 x 18.62 [368 x 473]	16 x 20
HFWNSP2016C	\$98.00	17.75 x 13.75 [451 x 349]	18.50 x 14.62 [470 x 371]	20 x 16
HFWNSP2020C	\$104.00	17.75 x 17.75 [451 x 451]	18.50 x 18.62 [470 x 473]	20 x 20
HFWNSP2024C	\$110.00	17.75 x 21.75 [451 x 552]	18.50 x 22.62 [470 x 575]	20 x 24
HFWNSP2416C	\$103.00	21.75 x 13.75 [552 x 349]	22.50 x 14.62 [572 x 371]	24 x 16
HFWNSP2420C	\$110.00	21.75 x 17.75 [552 x 451]	22.50 x 18.62 [572 x 473]	24 x 20
HFWNSP2424C	\$117.00	21.75 x 21.75 [552 x 552]	22.50 x 22.62 [572 x 575]	24 x 24
HFWNSP3020C	\$119.00	27.75 x 17.75 [705 x 451]	28.50 x 18.62 [724 x 473]	30 x 20
HFWNSP3024C	\$128.00	27.75 x 21.75 [705 x 552]	28.50 x 22.62 [724 x 575]	30 x 24
HFWNSP3030C	\$141.00	27.75 x 27.75 [705 x 705]	28.50 x 28.62 [724 x 727]	30 x 30
HFWNSP3624C	\$139.00	33.75 x 21.75 [857 x 552]	34.50 x 22.62 [876 x 575]	36 x 24
HFWNSP3630C	\$155.00	33.75 x 27.75 [857 x 705]	34.50 x 28.62 [876 x 727]	36 x 30
HFWNSP3636C	\$171.00	33.75 x 33.75 [857 x 857]	34.50 x 34.62 [876 x 879]	36 x 36

**Notes:** Dimensions in inches [millimeters]. Letters in table correspond to letters on dimensional drawings. If used in a two-door enclosure, a center panel support must be ordered.

## Dimensions

in [mm]

See our website: [www.AutomationDirect.com](http://www.AutomationDirect.com) for complete engineering drawings.

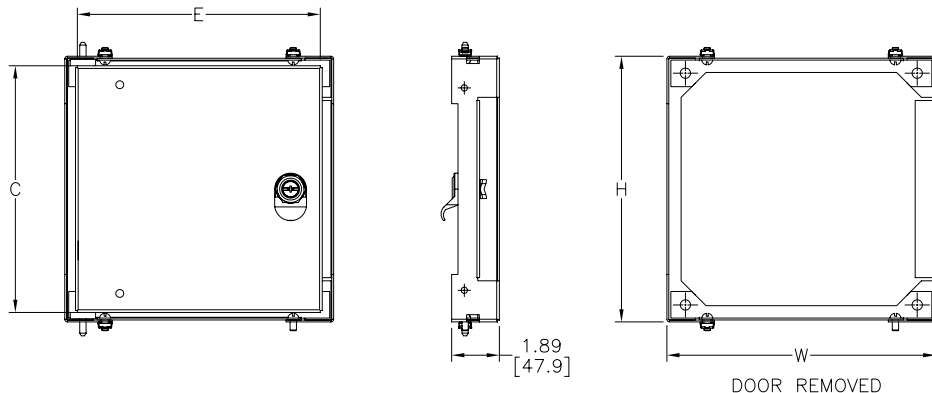

# Enclosure Accessories - Miscellaneous



## Vapor Capsule

### Carrying Handle



Carrying Handle	Price	Description	Wt.
<b>HW-CARRYINGHANDLE</b>	\$17.50	Non-metallic black handle, for use on Hubbell-Wiegmann non-metallic enclosures.	2 oz.



Vapor Capsule	Price	Description	Wt.
<b>HW-C12</b>	\$15.00	Non-toxic vapor emitted from the capsule passivates the metal surfaces on the interior of the enclosure against atmospheric corrosion for up to one year by reducing the electro-chemical activity of the metal surfaces. Installs easily with a self-adhesive strip.	1 oz.

### Strip Gasket



Enclosure Shipping Schedule	
Same day	1 - 14 days
Color indicates shipping lead time in business days.	

Strip Gasket	Price	Description	Wt.
<b>WGAS51634</b>	\$16.00	Hubbell-Wiegmann strip gasket, replacement, self-adhesive, microcell urethane foam, 5/16 inch thick x 3/4 inch wide x 10 ft long roll. For gasket replacement on Hubbell-Wiegmann wall-mount NEMA 12, 4 & 4X enclosures.	7oz.
<b>WGAS3834</b>	\$16.00	Hubbell-Wiegmann strip gasket, replacement, self-adhesive, closed cell sponge rubber, 3/8 inch thick x 3/4 inch wide x 10 ft long roll. For gasket replacement on Hubbell-Wiegmann floor-mount and freestanding NEMA 12, 4 & 4X enclosures.	7oz.



### Locking Protective Cover



#### Dimensions

in [mm]

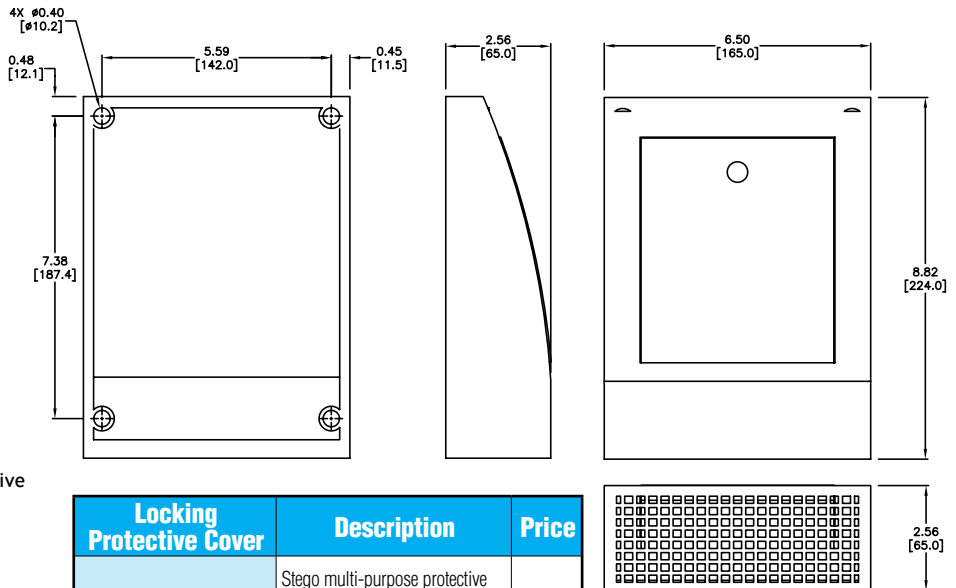

#### Features

- Packaged multi-purpose protective cover
- Locking door
- Weather and UV resistant (UL 94-HB)
- IP 20 Protection Class
- Includes mounting screws

Locking Protective Cover	Description	Price
<b>086110-00</b>	Stego multi-purpose protective cover with locking door, weather and UV resistant (UL 94-HB), IP20 protection class. Includes mounting screws and keys.	\$37.00

See our website: [www.AutomationDirect.com](http://www.AutomationDirect.com) for complete engineering drawings.