

NEMA 1 Single-Door Wall Mount with Knockouts



Applications

Designed for use as surface-mounted junction box, service box, switch box and cutout box.

Construction

- Bodies and doors fabricated from 16 or 14 gauge steel
- 3" depth enclosures furnished with formed steel hinge non removable cover. 4" and 6" depth enclosures furnished with clamp style hinges allowing for removable/replaceable covers
- Various sizes of removable concentric knockouts are furnished on all four sides of standard cutout enclosures
- Mounting holes on back of enclosure

Finish

- ANSI 61 gray polyester powder inside and out

Listings

- UL 50, Type 1 [UL File E6924]
- CSA Certified, Type 1 [CSA File LL66078]
- NEMA/EEMAC Type 1



Enclosure Shipping Schedule				
Same day	1 - 7 days	1 -10 days	1 - 15 days	1 - 20 days

Color indicates shipping lead time in business days.

A Series NEMA 1 Single-Door Wall Mount with Knockouts					
Part Number	Price	Body/Door Steel Gauge	Enclosure Size HxWxD	Knockout Pattern	
				Width Side	Height Side
A040503	\$10.50	16/16	5.25 x 4.81 x 3.06 [133 x 122 x 78]	A-A	A-B-A
A040604	\$10.50	16/16	6.44 x 4.44 x 4.38 [164 x 113 x 111]	A-A	A-B-A
A060603	\$12.00	16/16	6.37 x 6.37 x 3.06 [162 x 162 x 78]	A-B-A	A-B-A
A060604	\$12.50	16/16	6.37 x 6.37 x 4.38 [162 x 162 x 111]	A-A	A-B-A
A060606	\$15.00	16/16	6.37 x 6.37 x 6.38 [162 x 162 x 162]	A-B-A	A-B-A
A060804	\$14.50	16/16	8.25 x 6.25 x 4.38 [210 x 159 x 111]	A-B-A	A-B-A
A080804	\$17.50	16/16	8.37 x 8.37 x 4.38 [213 x 213 x 111]	A-B-A	A-B-A
A080806	\$21.00	16/16	8.37 x 8.37 x 6.38 [213 x 213 x 162]	A-B-A	A-B-A
A081004	\$19.50	16/16	10.37 x 8.37 x 4.38 [263 x 213 x 111]	A-B-A	B-A-F-F-A
A081006	\$23.50	16/16	10.37 x 8.37 x 6.38 [263 x 213 x 162]	A-B-A	B-A-F-F-A
A081204	\$22.50	16/16	12.25 x 8.25 x 4.38 [311 x 210 x 111]	A-B-A	B-A-F-F-A-B
A101004	\$23.00	16/16	10.25 x 10.25 x 4.38 [260 x 260 x 111]	B-A-F-F-A	B-A-F-F-A
A101006	\$25.50	16/16	10.25 x 10.25 x 6.38 [260 x 260 x 162]	B-A-F-F-A	B-A-F-F-A
A101204	\$25.00	16/16	12.25 x 10.25 x 4.38 [311 x 260 x 111]	B-A-F-F-A	B-A-F-F-A-B
A101206	\$27.00	16/16	12.25 x 10.25 x 6.38 [311 x 260 x 162]	B-A-F-F-A	B-A-F-F-A-B
A121204	\$26.50	16/16	12.25 x 12.25 x 4.38 [311 x 311 x 111]	B-A-F-F-A-B	B-A-F-F-A-B
A121206	\$29.50	16/16	12.25 x 12.25 x 6.38 [311 x 311 x 162]	B-A-F-F-A-B	B-A-F-F-A-B
A121504	\$29.50	16/16	15.25 x 12.25 x 4.38 [387 x 311 x 111]	B-A-F-F-A-B	A-B-A-F-F-A-B-A
A121604	\$32.50	16/16	16.25 x 12.25 x 4.38 [413 x 311 x 111]	B-A-F-F-A-B	A-B-A-F-F-A-B-A
A121606	\$38.00	16/16	16.25 x 12.25 x 6.38 [413 x 311 x 162]	B-A-F-F-A-B	A-B-A-F-F-A-B-A
A121804	\$32.50	16/16	18.25 x 12.25 x 4.38 [464 x 311 x 111]	B-A-F-F-A-B	A-B-A-F-F-A-B-A

Note: Dimensions in inches [millimeters].

Table continued on next page.

NEMA 1 Single-Door Wall Mount with Knockouts



Enclosure Shipping Schedule				
Same day	1 - 7 days	1 - 10 days	1 - 15 days	1 - 20 days

Color indicates shipping lead time in business days.

Table continued from previous page.

A Series NEMA 1 Single-Door Wall Mount with Knockouts					
Part Number	Price	Body/Door Steel Gauge	Enclosure Size HxWxD	Knockout Pattern	
				Width Side	Height Side
A121806	\$34.50	16/16	18.25 x 12.25 x 6.38 [464 x 311 x 162]	B-A-F-F-A-B	A-B-A-F-F-A-B-A
A151506	\$31.50	16/16	15.25 x 15.25 x 6.38 [387 x 387 x 162]	A-B-A-F-F-A-B-A	A-B-A-F-F-A-B-A
A151804	\$36.00	16/16	18.25 x 15.25 x 4.38 [464 x 387 x 111]	A-B-A-F-F-A-B-A	A-B-A-F-F-A-B-A
A161606	\$47.50	16/16	16.25 x 16.25 x 6.38 [413 x 413 x 162]	A-B-A-F-F-A-B-A	A-B-A-F-F-A-B-A
A181806	\$39.00	16/16	18.25 x 18.25 x 6.38 [464 x 464 x 162]	A-B-A-F-F-A-B-A	A-B-A-F-F-A-B-A
A182406	\$63.00	14/14	24.25 x 18.25 x 6.39 [616 x 464 x 162]	A-B-A-F-F-A-B-A	A-B-A-F-F-A-B-A
A242406	\$71.00	14/14	24.25 x 24.25 x 6.39 [616 x 616 x 162]	A-B-A-F-F-A-B-A	A-B-A-F-F-A-B-A
A243006	\$79.00	14/14	30.44 x 24.44 x 6.39 [733 x 621 x 162]	A-B-A-F-F-A-B-A	A-B-A-F-F-A-B-A
A243606	\$105.00	14/14	36.31 x 24.37 x 6.15 [922 x 619 x 156]	A-B-A-F-F-A-B-A	A-B-A-F-F-A-B-A
A243608	\$121.00	14/14	36.31 x 24.37 x 8.15 [922 x 619 x 207]	A-B-A-F-F-A-B-A	A-B-A-F-F-A-B-A

Note: Dimensions in inches [millimeters].

Dimensions

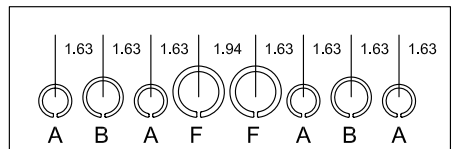
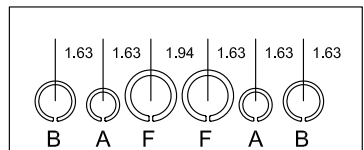
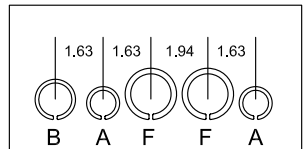
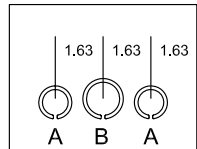
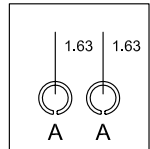
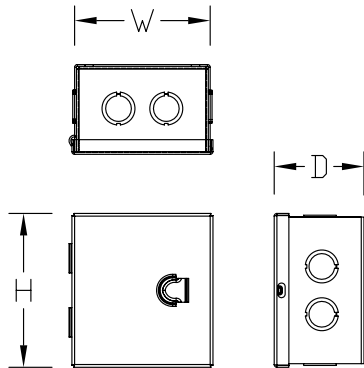

See our website: www.AutomationDirect.com for complete engineering drawings.