

NEMA 12 Two-Door Freestanding



Applications

Designed to protect electrical and electronic controls, components, and instruments in typical industrial environments. Enclosures protect equipment from dust, dirt, oil and dripping water. These enclosures are used in machine tool applications for housing motor starters, drives, contactors, and PLCs, as well as a wide variety of other electrical and electronic equipment. The enclosures are found extensively in automotive, pulp and paper, wood products, textile and similar industries.

Construction

- Continuously welded seams ground smooth.
- Body stiffeners for extra rigidity.
- Heavy duty lifting eyes for easy handling.
- Grounding provisions provided.
- Heavy gauge continuous hinges support each door.
- 3-point latching mechanism with an oil-tight key locking handle is provided.
- Doors are sealed with a closed cell neoprene gasket.
- Stiffeners are welded to back of two door enclosures to maintain flatness and increase rigidity.

- “Uni-strut” mounting channels are welded horizontally to interior body sides and top, bottom and center to allow back panels to be positioned in enclosure.
- Optional swing, half, full and rack panels can be mounted anywhere along “uni-strut” channel.
- [Uses WAL4 series handles and WAEMK44 replacement key.](#)

Finish

- ANSI 61 gray polyester powder light texture inside and out over phosphatized surfaces

Listings

- UL 508Type 12 [UL File E64791]
- CSA Certified, Type 12 [CSA File LL66078]
- NEMA/EEMAC Type



NEMA 12 Two-Door Freestanding		
Part Number	Price	Enclosure Size HxWxD
WA604818FSD	\$1,951.00	60.12 x 48.12 x 18.12 [1527 x 1222 x 460]
WA724818FSD	\$2,045.00	72.12 x 48.12 x 18.12 [1832 x 1222 x 460]
WA724824FSD	\$2,218.00	72.12 x 48.12 x 24.12 [1832 x 1222 x 613]
WA726018FSD	\$2,304.00	72.12 x 60.12 x 18.12 [1832 x 1527 x 460]
WA726024FSD	\$2,491.00	72.12 x 60.12 x 24.12 [1832 x 1527 x 613]
WA726036FSD	\$2,867.00	72.12 x 60.12 x 36.12 [1832 x 1527 x 917]
WA727218FSD	\$2,559.00	72.12 x 72.12 x 18.12 [1832 x 1832 x 460]
WA727224FSD	\$2,764.00	72.12 x 72.12 x 24.12 [1832 x 1832 x 613]
WA904820FSD	\$2,395.00	90.12 x 48.12 x 20.12 [2289 x 1222 x 511]
WA907220FSD	\$3,020.00	90.12 x 72.12 x 20.12 [2289 x 1832 x 511]
WA907224FSD	\$3,174.00	90.12 x 72.12 x 24.12 [2289 x 1832 x 613]
WA907236FSD	\$3,215.00	90.12 x 72.12 x 36.12 [2289 x 1832 x 917]

*Notes: Subpanels must be ordered separately.
Dimensions in inches [millimeters].
Letters in table correspond to letters on dimensional drawings.*

Enclosure Shipping Schedule				
Same day	1 - 7 days	1 - 10 days	1 - 15 days	1 - 20 days

Color indicates shipping lead time in business days.

NEMA 12 Two-Door Freestanding

Dimensions

in [mm]

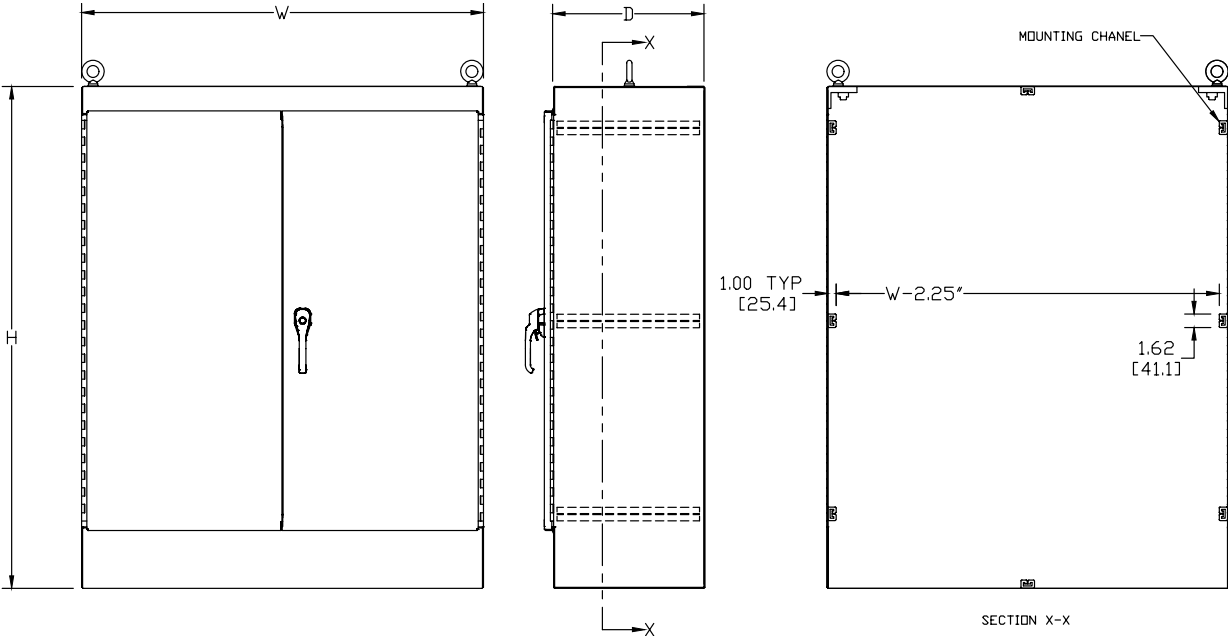

See our website: www.AutomationDirect.com for complete engineering drawings.

Standard Subpanels for Freestanding Enclosures

Enclosure Shipping Schedule				
Same day	1 - 7 days	1 - 10 days	1 - 15 days	1 - 20 days

Color indicates shipping lead time in business days.

Standard Subpanels for Freestanding Enclosures				
Enclosures	Standard Subpanels			
	Full Height		Half Height	
	Painted Steel	Galvanized	Painted Steel	Galvanized
WA602418FS	WA60P24F1	WA60P24F1G	WA60P24F2	WA60P24F2G
WA603624FS	WA60P36F1	WA60P36F1G	WA60P36F2	WA60P36F2G
WA722418FS	WA72P24F1	WA72P24F1G	WA72P24F2	WA72P24F2G
WA722424FS	WA72P24F1	WA72P24F1G	WA72P24F2	WA72P24F2G
WA723018FS	WA72P30F1	WA72P30F1G	WA72P30F2	WA72P30F2G
WA723024FS	WA72P30F1	WA72P30F1G	WA72P30F2	WA72P30F2G
WA723618FS	WA72P36F1	WA72P36F1G	WA72P36F2	WA72P36F2G
WA723624FS	WA72P36F1	WA72P36F1G	WA72P36F2	WA72P36F2G
WA723630FS	WA72P36F1	WA72P36F1G	WA72P36F2	WA72P36F2G
WA723636FS	WA72P36F1	WA72P36F1G	WA72P36F2	WA72P36F2G
WA902420FS	WA90P24F1	WA90P24F1G	WA90P24F2	WA90P24F2G
WA903620FS	WA90P36F1	WA90P36F1G	WA90P36F2	WA90P36F2G
WA903624FS	WA90P36F1	WA90P36F1G	WA90P36F2	WA90P36F2G
WA903636FS	WA90P36F1	WA90P36F1G	WA90P36F2	WA90P36F2G
WA604818FSD	WA60P48F1	WA60P48F1G	WA60P48F2	WA60P48F2G
WA724818FSD	WA72P48F1	WA72P48F1G	WA72P48F2	WA72P48F2G
WA724824FSD	WA72P48F1	WA72P48F1G	WA72P48F2	WA72P48F2G
WA726018FSD	WA72P60F1	WA72P60F1G	WA72P60F2	WA72P60F2G
WA726024FSD	WA72P60F1	WA72P60F1G	WA72P60F2	WA72P60F2G
WA726036FSD	WA72P60F1	WA72P60F1G	WA72P60F2	WA72P60F2G
WA727218FSD	WA72P72F1	WA72P72F1G	WA72P72F2	WA72P72F2G
WA727224FSD	WA72P72F1	-	WA72P72F2	WA72P72F2G
WA904820FSD	WA90P48F1	WA90P48F1G	WA90P48F2	WA90P48F2G
WA907220FSD	WA90P72F1	-	WA90P72F2	WA90P72F2G
WA907224FSD	WA90P72F1	-	WA90P72F2	WA90P72F2G
WA907236FSD	WA90P72F1	-	WA90P72F2	WA90P72F2G
WA722424FSDA	WA72P24F1	WA72P24F1G	WA72P24F2	WA72P24F2G
WA722430FSDA	WA72P24F1	WA72P24F1G	WA72P24F2	WA72P24F2G
WA722436FSDA	WA72P24F1	WA72P24F1G	WA72P24F2	WA72P24F2G
WA723024FSDA	WA72P30F1	WA72P30F1G	WA72P30F2	WA72P30F2G
WA723624FSDA	WA72P36F1	WA72P36F1G	WA72P36F2	WA72P36F2G
WA723636FSDA	WA72P36F1	WA72P36F1G	WA72P36F2	WA72P36F2G
WA903624FSDA	WA90P36F1	WA90P36F1G	WA90P36F2	WA90P36F2G
WA903636FSDA	WA90P36F1	WA90P36F1G	WA90P36F2	WA90P36F2G
WA724824FSDAD	WA72P48F1	WA72P48F1G	WA72P48F2	WA72P48F2G
WA726024FSDAD	WA72P60F1	WA72P60F1G	WA72P60F2	WA72P60F2G
WA726036FSDAD	WA72P60F1	WA72P60F1G	WA72P60F2	WA72P60F2G
WA727224FSDAD	WA72P72F1	-	WA72P72F2	WA72P72F2G
WA907224FSDAD	WA90P72F1	-	WA90P72F2	WA90P72F2G

Swing-Out Panels for Freestanding Enclosures

Enclosure Shipping Schedule

Same day	1 - 7 days	1 -10 days	1 - 15 days	1 - 20 days
----------	------------	------------	-------------	-------------

Color indicates shipping lead time in business days.

Swing-Out Panels for Freestanding Enclosures				
Enclosures	Swing-Out Panels			
	Full Height		Half Height	
	Painted Steel	Galvanized	Painted Steel	Galvanized
WA602418FS	WA60SP24F3	WA60SP24F3G	WA60SP24F4	WA60SP24F4G
WA603624FS	WA60SP36F3	WA60SP36F3G	WA60SP36F4	WA60SP36F4G
WA722418FS	WA72SP24F3	WA72SP24F3G	WA72SP24F4	WA72SP24F4G
WA722424FS	WA72SP24F3	WA72SP24F3G	WA72SP24F4	WA72SP24F4G
WA723018FS	WA72SP30F3	WA72SP30F3G	WA72SP30F4	WA72SP30F4G
WA723024FS	WA72SP30F3	WA72SP30F3G	WA72SP30F4	WA72SP30F4G
WA723618FS	WA72SP36F3	WA72SP36F3G	WA72SP36F4	WA72SP36F4G
WA723624FS	WA72SP36F3	WA72SP36F3G	WA72SP36F4	WA72SP36F4G
WA723630FS	WA72SP36F3	WA72SP36F3G	WA72SP36F4	WA72SP36F4G
WA723636FS	WA72SP36F3	WA72SP36F3G	WA72SP36F4	WA72SP36F4G
WA902420FS	-	-	-	-
WA903620FS	WA90SP36F3	WA90SP36F3G	WA90SP36F4	WA90SP36F4G
WA903624FS	WA90SP36F3	WA90SP36F3G	WA90SP36F4	WA90SP36F4G
WA903636FS	WA90SP36F3	WA90SP36F3G	WA90SP36F4	WA90SP36F4G
WA604818FSD	-	-	-	-
WA724818FSD	-	-	-	-
WA724824FSD	-	-	-	-
WA726018FSD	-	-	-	-
WA726024FSD	-	-	-	-
WA726036FSD	-	-	-	-
WA727218FSD	-	-	-	-
WA727224FSD	-	-	-	-
WA904820FSD	-	-	-	-
WA907220FSD	-	-	-	-
WA907224FSD	-	-	-	-
WA907236FSD	-	-	-	-
WA722424FSDA	WA72SP24F3	WA72SP24F3G	WA72SP24F4	WA72SP24F4G
WA722430FSDA	WA72SP24F3	WA72SP24F3G	WA72SP24F4	WA72SP24F4G
WA722436FSDA	WA72SP24F3	WA72SP24F3G	WA72SP24F4	WA72SP24F4G
WA723024FSDA	WA72SP30F3	WA72SP30F3G	WA72SP30F4	WA72SP30F4G
WA723624FSDA	WA72SP36F3	WA72SP36F3G	WA72SP36F4	WA72SP36F4G
WA723636FSDA	WA72SP36F3	WA72SP36F3G	WA72SP36F4	WA72SP36F4G
WA903624FSDA	WA90SP36F3	WA90SP36F3G	WA90SP36F4	WA90SP36F4G
WA903636FSDA	WA90SP36F3	WA90SP36F3G	WA90SP36F4	WA90SP36F4G
WA724824FSDAD	-	-	-	-
WA726024FSDAD	-	-	-	-
WA726036FSDAD	-	-	-	-
WA727224FSDAD	-	-	-	-
WA907224FSDAD	-	-	-	-

Side-Mount Panels for Freestanding Enclosures

Enclosure Shipping Schedule				
Same day	1 - 7 days	1 - 10 days	1 - 15 days	1 - 20 days

Color indicates shipping lead time in business days.

Side-Mount Panels for Freestanding Enclosures		
Enclosures	Side-Mount Panels	
	Painted Steel	Galvanized
WA602418FS	WA60SMP14	WA60SMP14G
WA603624FS	WA60SMP14	WA60SMP14G
WA722418FS	WA72SMP14	WA72SMP14G
WA722424FS	WA72SMP14, WA72SMP20	WA72SMP14G, WA72SMP20G
WA723018FS	WA72SMP14	WA72SMP14G
WA723024FS	WA72SMP14, WA72SMP20	WA72SMP14G, WA72SMP20G
WA723618FS	WA72SMP14	WA72SMP14G
WA723624FS	WA72SMP14, WA72SMP20	WA72SMP14G, WA72SMP20G
WA723630FS	WA72SMP14, WA72SMP20	WA72SMP14G, WA72SMP20G
WA723636FS	WA72SMP14, WA72SMP20	WA72SMP14G, WA72SMP20G
WA902420FS	WA90SMP14	WA90SMP14G
WA903620FS	WA90SMP14	WA90SMP14G
WA903624FS	WA90SMP14, WA90SMP20	WA90SMP14G, WA90SMP20G
WA903636FS	WA90SMP14, WA90SMP20	WA90SMP14G, WA90SMP20G
WA604818FSD	WA60SMP14	WA60SMP14G
WA724818FSD	WA72SMP14	WA72SMP14G
WA724824FSD	WA72SMP14, WA72SMP20	WA72SMP14G, WA72SMP20G
WA726018FSD	WA72SMP14	WA72SMP14G
WA726024FSD	WA72SMP14, WA72SMP20	WA72SMP14G, WA72SMP20G
WA726036FSD	WA72SMP14, WA72SMP20	WA72SMP14G, WA72SMP20G
WA727218FSD	WA72SMP14	WA72SMP14G
WA727224FSD	WA72SMP14, WA72SMP20	WA72SMP14G, WA72SMP20G
WA904820FSD	WA90SMP14	WA90SMP14G
WA907220FSD	WA90SMP14	WA90SMP14G
WA907224FSD	WA90SMP14, WA90SMP20	WA90SMP14G, WA90SMP20G
WA907236FSD	WA90SMP14, WA90SMP20	WA90SMP14G, WA90SMP20G
WA722424FSDA	WA72SMP14, WA72SMP20	WA72SMP14G, WA72SMP20G
WA722430FSDA	WA72SMP14, WA72SMP20	WA72SMP14G, WA72SMP20G
WA722436FSDA	WA72SMP14, WA72SMP20	WA72SMP14G, WA72SMP20G
WA723024FSDA	WA72SMP14, WA72SMP20	WA72SMP14G, WA72SMP20G
WA723624FSDA	WA72SMP14, WA72SMP20	WA72SMP14G, WA72SMP20G
WA723636FSDA	WA72SMP14, WA72SMP20	WA72SMP14G, WA72SMP20G
WA903624FSDA	WA90SMP14, WA90SMP20	WA90SMP14G, WA90SMP20G
WA903636FSDA	WA90SMP14, WA90SMP20	WA90SMP14G, WA90SMP20G
WA724824FSDAD	WA72SMP14, WA72SMP20	WA72SMP14G, WA72SMP20G
WA726024FSDAD	WA72SMP14, WA72SMP20	WA72SMP14G, WA72SMP20G
WA726036FSDAD	WA72SMP14, WA72SMP20	WA72SMP14G, WA72SMP20G
WA727224FSDAD	WA72SMP14, WA72SMP20	WA72SMP14G, WA72SMP20G
WA907224FSDAD	WA90SMP14, WA90SMP20	WA90SMP14G, WA90SMP20G

Swing-Out Racks and Center Post Supports for Freestanding Enclosures

Enclosure Shipping Schedule				
Same day	1 - 7 days	1 - 10 days	1 - 15 days	1 - 20 days

Color indicates shipping lead time in business days.

Swing-Out Racks and Center Post Supports for Freestanding Enclosures		
Enclosures	Swing-Out Rack	Center Post Support
WA602418FS	-	-
WA603624FS	-	-
WA722418FS	-	-
WA722424FS	-	-
WA723018FS	WA7230SOF19	-
WA723024FS	WA7230SOF19	-
WA723618FS	WA7236SOF19	-
WA723624FS	WA7236SOF19	-
WA723630FS	WA7236SOF19	-
WA723636FS	WA7236SOF19	-
WA902420FS	-	-
WA903620FS	WA9036SOF19	-
WA903624FS	WA9036SOF19	-
WA903636FS	WA9036SOF19	-
WA604818FSD	-	WA60FSCPS
WA724818FSD	-	WA72FSCPS
WA724824FSD	-	WA72FSCPS
WA726018FSD	-	WA72FSCPS
WA726024FSD	-	WA72FSCPS
WA726036FSD	-	WA72FSCPS
WA727218FSD	-	WA72FSCPS
WA727224FSD	-	WA72FSCPS
WA904820FSD	-	WA90FSCPS
WA907220FSD	-	WA90FSCPS
WA907224FSD	-	WA90FSCPS
WA907236FSD	-	WA90FSCPS
WA722424FSDA	-	-
WA722430FSDA	-	-
WA722436FSDA	-	-
WA723024FSDA	WA7230SOF19	-
WA723624FSDA	WA7236SOF19	-
WA723636FSDA	WA7236SOF19	-
WA903624FSDA	WA9036SOF19	-
WA903636FSDA	WA9036SOF19	-
WA724824FSDAD	-	WA72FSCPS
WA726024FSDAD	-	WA72FSCPS
WA726036FSDAD	-	WA72FSCPS
WA727224FSDAD	-	WA72FSCPS
WA907224FSDAD	-	WA90FSCPS

WA-F1/F2 Panels for Two-door Freestanding Enclosures

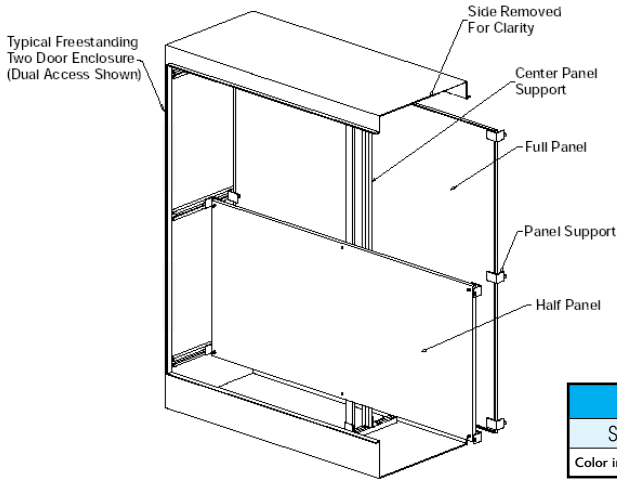

Description

- Panels for two-door single-access and two-door dual-access, freestanding NEMA 12 enclosures
- Manufactured of 10 gauge steel and can be positioned anywhere along horizontal depth-wise mounting channels
- Half-height panels can be located in the upper or lower portion of the enclosure
- Mounting hardware is furnished with each panel
- Painted steel subpanels are painted white polyester powder over phosphatized surfaces
- Galvanized subpanels have a conductive finish (no paint)

Enclosure Shipping Schedule				
Same day	1 - 7 days	1 - 10 days	1 - 15 days	1 - 20 days

Color indicates shipping lead time in business days.

Painted Steel	Price	Galvanized	Price	Panel Size AxB	Subpanel Type
WA60P48F1	\$462.00	WA60P48F1G	\$462.00	48.00 x 44.00 [1219 x 1118]	Full
WA60P48F2	\$257.00	WA60P48F2G	\$257.00	24.88 x 44.00 [632 x 1118]	Half
WA72P48F1	\$523.00	WA72P48F1G	\$523.00	60.00 x 44.00 [1524 x 1118]	Full
WA72P48F2	\$334.00	WA72P48F2G	\$334.00	30.88 x 44.00 [784 x 1118]	Half
WA72P60F1	\$606.00	WA72P60F1G	\$606.00	60.00 x 56.00 [1524 x 1422]	Full
WA72P60F2	\$376.00	WA72P60F2G	\$376.00	30.88 x 56.00 [784 x 1422]	Half
WA72P72F1	\$689.00	-	-	68.00 x 68.00 [1727 x 1727]	Full
WA72P72F2	\$419.00	WA72P72F2G	\$419.00	30.88 x 68.88 [784 x 1727]	Half
WA90P48F1	\$615.00	WA90P48F1G	\$615.00	78.00 x 44.00 [1981 x 1118]	Full
WA90P48F2	\$380.00	WA90P48F2G	\$380.00	39.88 x 44.00 [1013 x 1118]	Half
WA90P72F1	\$830.00	-	-	78.00 x 68.00 [1981 x 1727]	Full
WA90P72F2	\$490.00	WA90P72F2G	\$490.00	39.88 x 68.00 [1013 x 1727]	Half

Notes: Dimensions in inches [millimeters].
Suffix F1 = full panel, F2 = half panel

Dimensions

in [mm]

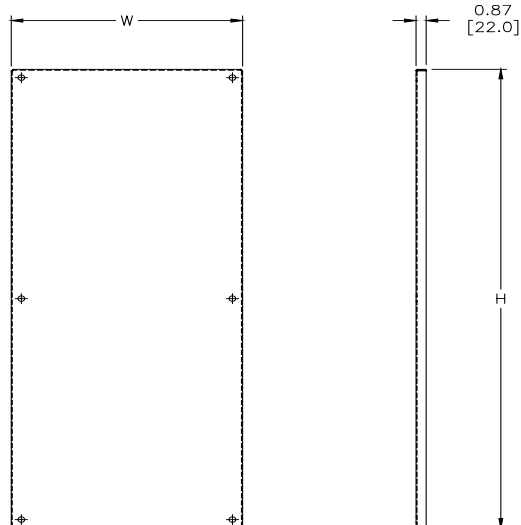

IMPORTANT NOTE: CENTER PANEL SUPPORT IS SUPPLIED WITH A REGULAR TWO-DOOR ENCLOSURE PANEL. THIS SUPPORT IS USED ONLY AS A BRACE. IT IS NOT INTENDED TO BE USED AS A SUPPORT FOR SINGLE-DOOR SUBPANELS, RELAY RACKS, ETC. USE WA_FSCPS PANEL SUPPORTS FOR THIS PURPOSE.

See our website: www.AutomationDirect.com for complete engineering drawings.

WA-SMP Series Side-Mount Panels for Freestanding Enclosures

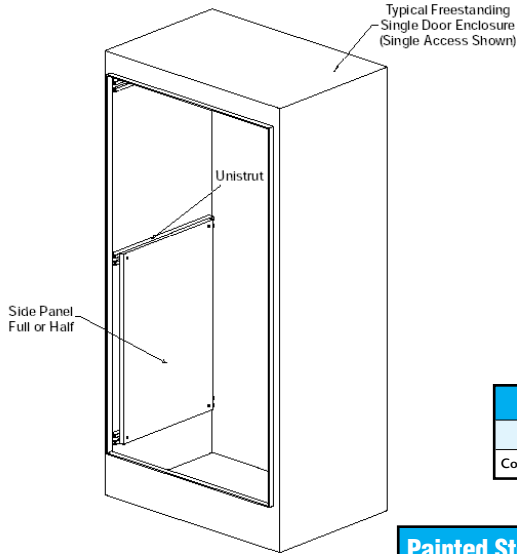

Description

- Panels for freestanding NEMA 4 and freestanding NEMA 12 enclosures
- Panels are fabricated from 12 gauge steel
- They provide extra mounting space on the sides of the enclosure
- Mounting hardware is furnished with each panel
- Painted steel subpanels are painted white polyester powder over phosphatized surfaces
- Galvanized subpanels have a conductive finish (no paint)
- Panels attach securely to mounting channels

Enclosure Shipping Schedule				
Same day	1 - 7 days	1 - 10 days	1 - 15 days	1 - 20 days

Color indicates shipping lead time in business days.

Painted Steel	Price	Galvanized	Price	Panel Size AxB
WA60SMP14	\$135.00	WA60SMP14G	\$135.00	48.00 x 14.00 [1219 x 356]
WA72SMP14	\$153.00	WA72SMP14G	\$153.00	60.00 x 14.00 [1524 x 356]
WA72SMP20	\$188.00	WA72SMP20G	\$188.00	60.00 x 20.00 [1524 x 508]
WA90SMP14	\$220.00	WA90SMP14G	\$220.00	78.00 x 14.00 [1981 x 356]
WA90SMP20	\$231.00	WA90SMP20G	\$231.00	78.00 x 20.00 [1981 x 508]

Note: Dimensions in inches (millimeters)

Dimensions

in [mm]

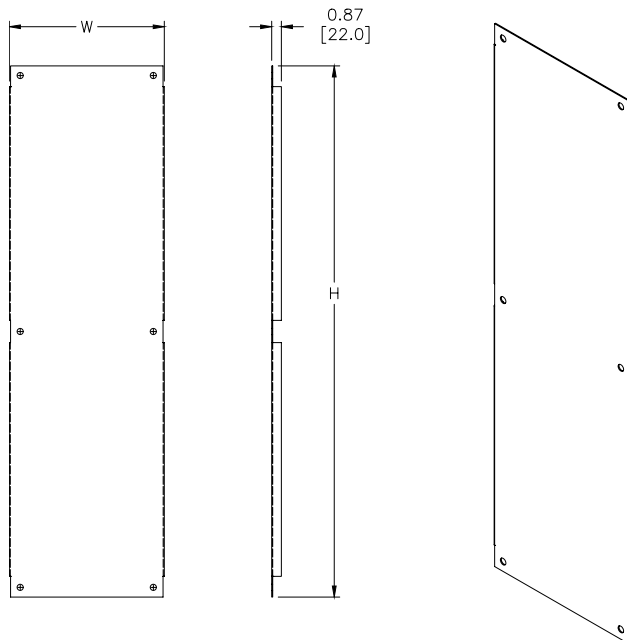

See our website: www.AutomationDirect.com for complete engineering drawings.

Enclosure Accessories - Panel Mounting



JIC and NEMA Swing-Out Panel Kits

Swing-out panel kits are designed to allow mounting of switches, pilot lights and other components near the front of the enclosure for easy access or meter reading.

Sealing washers are included to ensure that the enclosure will meet the original NEMA rating after installation.

These kits are designed for use with standard Hubbell-Wiegmann JIC and NEMA panels. They do not work with N412xxxC Ultimate Series enclosures or HW-XXXX series non-metal enclosures.



Panel Kits	Price	Description	Wt. [lb]
WAJCDFK	\$37.00	Hubbell-Wiegmann enclosure swing-out panel kit, plated steel, for use on NEMA continuous hinge style enclosures. Includes (2) hinge brackets, (2) fixed brackets, and mounting hardware. Panel sold separately.	1
WANADFK	\$49.50	Hubbell-Wiegmann enclosure swing-out panel kit, plated steel, for use on NEMA single and two-door style enclosures. Includes (2) hinge brackets, (2) fixed brackets, and mounting hardware. Panel sold separately.	3

Note: Panels must be ordered separately from enclosure.

Enclosure Shipping Schedule		
Same day	1 - 7 days	1 -10 days

Color indicates shipping lead time in business days.

Panel Supports

Panel supports provide additional support for panels on which heavy instruments are mounted.

They are adjustable so the weight of the panel is partially supported by the bottom of the enclosure.



WAPS03

Panel Supports	Price	Description	Wt. [lb]
WAPS03	\$34.50	Hubbell-Wiegmann enclosure panel support foot, white polyester powder finish, for single and two-door enclosures where distance between bottom of panel and enclosure is less than 2.25 inches. Package of 2. Load limit: 250 lbs.	1
WAPS09	\$49.50	Hubbell-Wiegmann enclosure panel support foot, white polyester powder finish, for free-standing enclosures where distance between bottom of panel and enclosure is less than 8.5 inches and greater than 2.88 inches. Package of 2. Load limit: 250 lbs.	2

Center Panel Supports for Freestanding Enclosures

Center Panel Supports	Price	Description	Wt. [lb]
WA60FSCPS	\$137.00	Hubbell-Wiegmann enclosure center panel support, white polyester powder finish, for 60 inch high enclosures. Allows two single-wide sub-panels (including swing-out panels and rack mount frames) to be mounted in a double-door enclosure.	15
WA72FSCPS	\$152.00	Hubbell-Wiegmann enclosure center panel support, white polyester powder finish, for 72 inch high enclosures. Allows two single-wide sub-panels (including swing-out panels and rack mount frames) to be mounted in a double-door enclosure.	21
WA90FSCPS	\$181.00	Hubbell-Wiegmann enclosure center panel support, white polyester powder finish, for 90 inch high enclosures. Allows two single-wide sub-panels (including swing-out panels and rack mount frames) to be mounted in a double-door enclosure.	22



WA60FSCPS

See our website: www.AutomationDirect.com for complete engineering drawings.