

NEMA 12 and 13 Hinged Screw Cover Wall Mount



Applications

Designed for use as instrument housings, electrical control enclosures, terminal wiring boxes or electrical junction boxes. Provides protection from dirt, dust, oil and water.

Construction

- Bodies and doors fabricated from 14 gauge steel
- Lids are sealed with closed cell oil resistant neoprene gasket
- Continuously welded seams ground smooth, less knockouts of holes
- Captive door screws thread into sealed wells
- Grounding provisions provided
- Weldnuts are provided for mounting optional subpanel
- No mounting feet or mounting holes are provided

Finish

- ANSI 61 gray polyester powder light texture inside and out over phosphatized surfaces

Listings

- UL 50, Types 12 & 13 [UL File E6924]
- CSA Certified, Type 12 [CSA File LL66078]
- NEMA/EEMAC Types 12 & 13
- JIC EL-1-71



Enclosure Shipping Schedule

Same day	1 - 7 days
----------	------------

Color indicates shipping lead time in business days.

NEMA 12 and 13 Hinged Screw Cover Wall Mount

Part Number	Price	Enclosure Size HxWxD	Painted Steel Subpanel	Perforated Subpanel	Galvanized Steel Subpanel
WA060604GIE	\$54.00	6.31 x 6.31 x 4.15 [160 x 160 x 105]	N1P0606	N1P0606PP	N1P0606G
WA080604GIE	\$59.00	8.31 x 6.31 x 4.15 [211 x 160 x 105]	N1P0608	N1P0608PP	N1P0608G
WA080804GIE	\$65.00	8.31 x 8.31 x 4.15 [211 x 211 x 105]	N1P0808	N1P0808PP	N1P0808G
WA080806GIE	\$68.00	8.31 x 8.31 x 6.15 [211 x 211 x 156]	N1P0808	N1P0808PP	N1P0808G
WA100804GIE	\$71.00	10.31 x 8.31 x 4.15 [262 x 211 x 105]	N1P0810	N1P0810PP	N1P0810G
WA100806GIE	\$81.00	10.31 x 8.31 x 6.15 [262 x 211 x 156]	N1P0810	N1P0810PP	N1P0810G
WA101006GIE	\$86.00	10.31 x 10.31 x 6.15 [262 x 262 x 156]	N1P1010	N1P1010PP	N1P1010G
WA121004GIE	\$86.00	12.31 x 10.31 x 4.15 [313 x 262 x 105]	N1P1012	N1P1012PP	N1P1012G
WA121006GIE	\$94.00	12.31 x 10.31 x 6.15 [313 x 262 x 156]	N1P1012	N1P1012PP	N1P1012G
WA121206GIE	\$106.00	12.31 x 12.31 x 6.15 [313 x 313 x 156]	N1P1212	N1P1212PP	N1P1212G
WA141206GIE	\$115.00	14.31 x 12.31 x 6.15 [363 x 313 x 156]	N1P1214	N1P1214PP	N1P1214G

Note: Subpanels must be ordered separately.

Dimensions in inches [millimeters]

Letters in table correspond to letters on dimensional drawings.

NEMA 12 and 13 Hinged Screw Cover Wall Mount

Dimensions

in [mm]

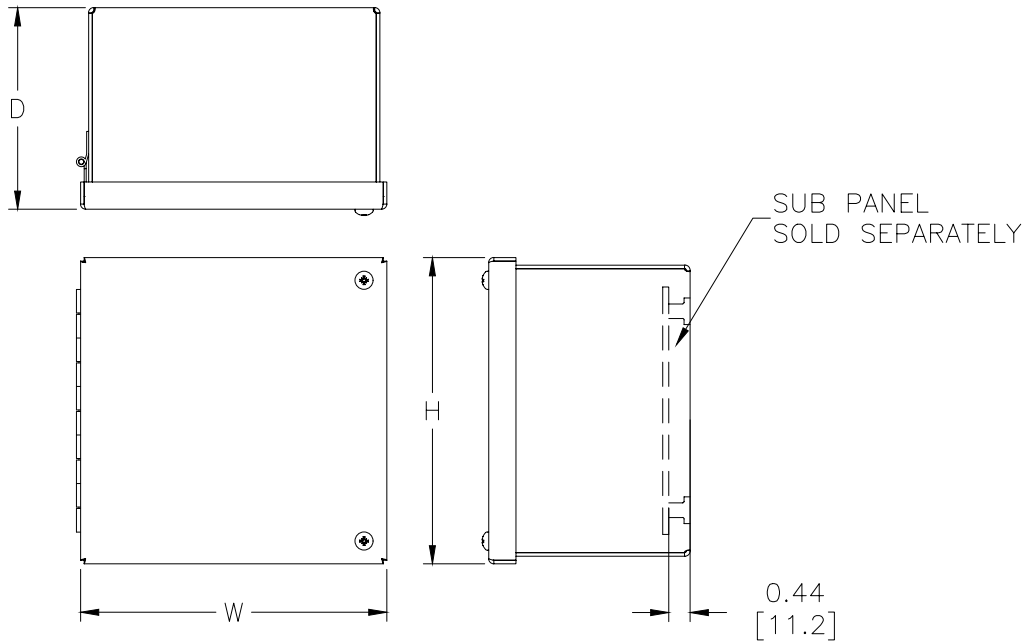

NOTES:

1. PANELS ARE 14GA STEEL.
2. PANEL SCREWS ARE #10-32 PAN HEAD.

See our website: www.AutomationDirect.com for complete engineering drawings.

Enclosure Subpanels



Subpanels for Small NEMA 1, NEMA 3R and NEMA 12 enclosures

- 14 gauge
- Painted steel and perforated subpanels are painted white polyester powder over phosphatized surfaces
- Galvanized panels have a conductive finish (no paint)
- Panels listed fit the following enclosures:

NEMA 1 small (N1C)
 NEMA 3R small (RHC)
 NEMA 12 WA_GIE

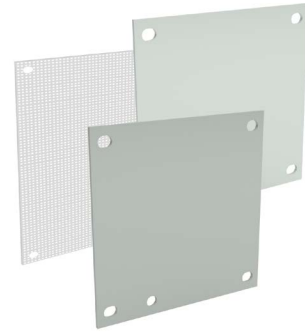

Subpanels for Small NEMA 1, NEMA 3R and NEMA 12 Enclosures							
Painted Steel	Price	Galvanized	Price	Perforated	Price	Nominal Enclosure Size HxW	Subpanel Size AxB
N1P0606	\$3.50	N1P0606G	\$3.50	N1P0606PP	\$3.50	6 x 6	4.25 x 4.25 [108 x 108]
N1P0608	\$4.00	N1P0608G	\$4.00	N1P0608PP	\$4.00	6 x 8	6.25 x 4.25 [159 x 108]
N1P0808	\$4.75	N1P0808G	\$4.75	N1P0808PP	\$4.75	8 x 8	6.25 x 6.25 [159 x 159]
N1P0810	\$5.50	N1P0810G	\$5.50	N1P0810PP	\$5.50	8 x 10	8.25 x 6.25 [210 x 159]
N1P1010	\$6.50	N1P1010G	\$6.50	N1P1010PP	\$6.50	10 x 10	8.25 x 8.25 [210 x 210]
N1P1012	\$7.50	N1P1012G	\$7.50	N1P1012PP	\$7.50	10 x 12	10.25 x 8.25 [260 x 210]
N1P1212	\$9.00	N1P1212G	\$9.00	N1P1212PP	\$9.00	12 x 12	10.25 x 10.25 [260 x 260]
N1P1214	\$10.00	N1P1214G	\$10.00	N1P1214PP	\$10.00	12 x 14	12.25 x 10.25 [311 x 260]
N1P1216	\$11.25	N1P1216G	\$11.25	N1P1216PP	\$11.25	12 x 16	14.25 x 10.25 [362 x 260]
N1P1220	\$13.75	N1P1220G	\$13.75	N1P1220PP	\$13.75	12 x 20	18.25 x 10.25 [464 x 260]

*Notes: Dimensions in inches [millimeters].
 Letters in table correspond to letters on dimensional drawing.*

Dimensions

in [mm]

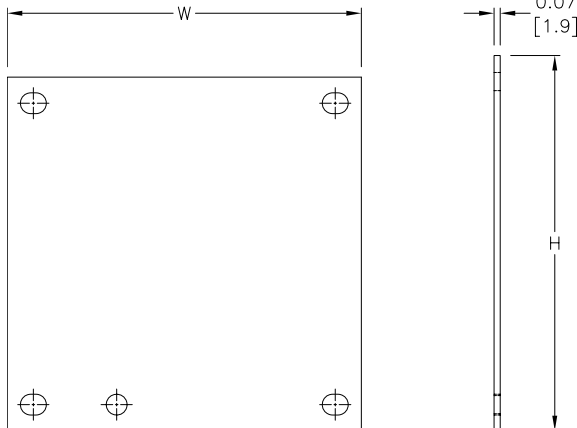

Enclosure Shipping Schedule	
Same day	1 - 7 days
Color indicates shipping lead time in business days.	

Perforated panels have 0.13" diameter holes at 0.25" spacing.

See our website: www.AutomationDirect.com for complete engineering drawings.