



Electrical Fixing and Fastening

Overview

Minerallac's comprehensive range of electrical fasteners and support systems ensures secure mounting, reliable positioning, and efficient installation in commercial and industrial applications. Designed for durability and precision, these components provide essential structural support for conduit, threaded rod, and wiring assemblies.



Products Included:

Beam and Flange Clamps – Screw-on and hammer-on designs for secure attachment to structural beams, available in steel, spring steel, and malleable iron.

Threaded Rod – 6-foot lengths of low-carbon steel with a zinc-plated finish for sturdy suspension and fastening applications.

Cable Flange Clips – High-carbon steel clips designed to fit flanges ranging from 1/16 inch to 1/2 inch, ensuring dependable wire and conduit placement.

Conduit Clips – Precision-engineered fasteners for securing electrical conduit to surfaces while maintaining installation stability.

Beam Clamp Conduit Clips – Integrated clips for conduit mounting via beam clamps, offering strong structural support.

Screw-On Beam Clamp Conduit Clips – Threaded fastening solutions for conduit installations using screw-on beam clamps.

Conduit Hanger Assemblies – Stable suspension systems for electrical conduit, built for reliability and ease of placement.

Rod Hangers – Right-angle brackets, side flange, vertical flange, and Z-perlin configurations for secure threaded rod installation.

Conduit Straps – Available in single-hole/single-cable, single-hole/two-cable, and two-hole/single-cable configurations for versatile conduit mounting.

Engineered for strength and efficiency, Minerallac's fasteners and supports ensure seamless electrical installations with long-lasting performance.



500

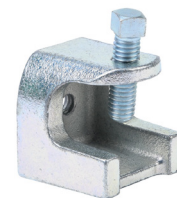

701



BC516



125



228



KC1234



BC516KC1234



RA38T



R1838T



301



F4D



59706-6



ABC25R38T



APSKC1



500KC1B



Beam/Flange Clamps

Screw-On Clamps

Designed for secure and adjustable fastening, Minerallac Screw-On Beam Clamps provide a reliable mounting solution for electrical conduit, threaded rod, and various structural components. Available in steel, spring steel, and malleable iron, these clamps offer strength and durability while ensuring a firm grip on beams and support structures. Their threaded design allows for precise positioning and secure attachment, making them an essential choice for commercial and industrial installations.

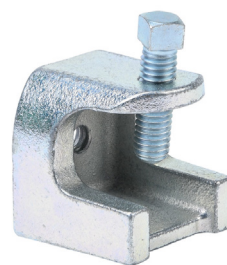
**500****701**

Hammer-On Beam Clamps

Minerallac Hammer-On Beam Clamps deliver a fast and efficient mounting option for electrical conduit and support systems. Crafted from spring steel, these clamps provide a firm hold without requiring additional hardware, reducing installation time while maintaining a strong and dependable grip. Ideal for applications where speed and simplicity are crucial, they ensure secure attachment with minimal effort in demanding work environments.

**602B****BC516**

Screw-On Beam Clamp Specifications

Part Number	Qty.	Price	Max. Flange	Weight Rating*	Mounting Holes	Set Screw Size	Fits	Material
500	100	\$89.00	1/2in	100 lbs.	1/4in pass through bottom 3/8in pass through bottom 1/4-20 UNC bottom 1/4-20 UNC back #10-24 UNC back	1/4in-20 UNC	Flanges up to 1/2in and up to 3/8 threaded rod with nut (nut not included)	Spring steel
500-25	25	\$27.00						
600	50	\$59.00	1/2in	75 lbs.	1/4-20 UNC bottom 1/4-20 UNC back	1/4in-20 UNC	Flanges up to 1/2in and 1/4-20 threaded rod	Steel
600-6	6	\$11.00						
602B	25	\$100.00	3/4in	200 lbs.	3/8-16 UNC bottom 3/8-16 UNC back	5/16in-18 UNC	Flanges up to 3/4in and 3/8-16 threaded rod	
602B-6	6	\$35.00						
701	25	\$159.00	3/4in	525 lbs.	5/16-18 UNC bottom 5/16-18 UNC back	3/8in-16 UNC	Flanges up to 3/4in and 5/16-18 threaded rod	
701-6	6	\$38.00						
702	25	\$198.00	3/4in	750 lbs.	3/8-16 UNC bottom 3/8-16 UNC back	1/2in-13 UNC	Flanges up to 3/4in and 3/8-16 threaded rod	Malleable iron
702-6	6	\$49.00						
703	25	\$315.00	7/8in	900 lbs.	1/2-13 UNC bottom 1/2-13 UNC back	5/8in-11 UNC	Flanges up to 7/8in and 1/2-13 threaded rod	
703-6	6	\$81.00						

*Weight ratings for bottom threads hanging vertically.

Hammer-On Beam Clamp Specifications

Part Number	Qty.	Price	Max. Flange	Min. Flange	Weight Rating*	Mounting Holes	Fits	Material
<u>BC18</u>	100	\$84.00	1/4in	1/8in	75 lbs.	1/4-20 UNC bottom 1/4-20 UNC back	1/8 to 1/4in flanges and 1/4-20 threaded rod	Spring steel
<u>BC18-25</u>	25	\$26.00						
<u>BC516</u>	100	\$91.00	1/2in	5/16in			5/16 to 1/2in flanges and 1/4-20 threaded rod	
<u>BC516-25</u>	25	\$27.50						
<u>BC916</u>	100	\$115.00	3/4in	9/16in			9/16 to 3/4in flanges and 1/4-20 threaded rod	
<u>BC916-25</u>	25	\$34.00						

*Weight ratings for bottom threads hanging vertically.





Beam/Flange Clamps

Hammer-On Flange Clamps

Minerallac Hammer-On Flange Clamps provide a quick and reliable method for securing electrical conduit to structural beams and flanges. Designed for fast installation without additional hardware, these clamps ensure a secure grip while maintaining structural integrity. Constructed from durable materials, they offer long-lasting performance in commercial and industrial applications.

Features

- Spring steel
- Zinc phosphate plated finish



SFC516

Hammer-On Flange Clamps Specifications

Part Number	Qty.	Price	Flanges (in)	Load Rating*	Mounting Hole Size
SFC18	100	\$55.00	1/8 to 1/4in	200 lbs	1/4in
SFC18-25	25	\$19.00			
SFC516	100	\$58.00	5/16 to 1/2in		
SFC516-25	25	\$19.50			
SFC916	100	\$62.00	9/16 to 3/4in		
SFC916-25	25	\$20.50			

*Weight ratings for clamp installed horizontally and hanging vertical load.

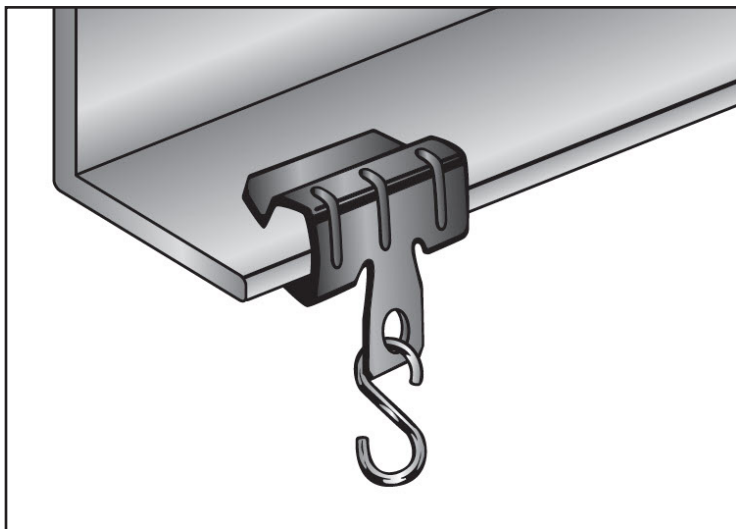



Threaded Rod

Threaded Rod

Minerallac Threaded Rod provides a strong, versatile fastening solution for structural support and electrical installations. Manufactured from low-carbon steel and coated with a zinc-plated finish, each 6-foot length ensures durability, corrosion resistance, and reliable performance in a variety of applications. Whether used for mounting conduit, suspending fixtures, or securing assemblies, this threaded rod delivers precision and strength, making it an essential component for commercial and industrial projects.

Features

- Low-carbon steel
- Zinc-plated finish
- 6-foot rods
 - Sold in quantities of 6 (36ft total)
- Yield strength: 36,000psi

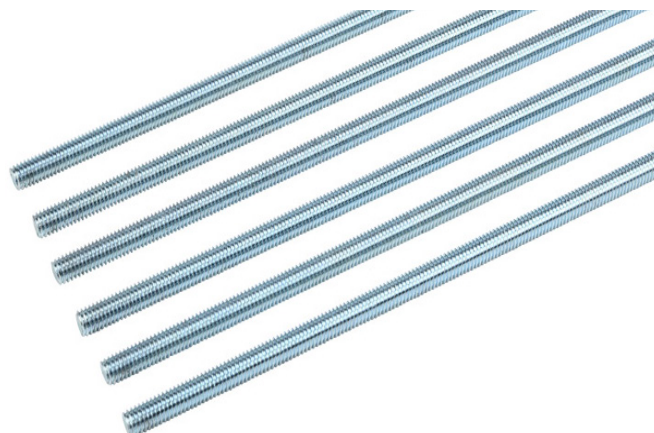

59706-6

Threaded Rod Specifications

Part Number	Qty.	Price	Thread Size	Tightening Torque	Estimated Max. Load (lbs)
59704-6	6	\$22.50	1/4-20 UNC	4 ft-lb	240
59705-6		\$33.00	5/16-18 UNC	8 ft-lb	400
59706-6		\$41.00	3/8-16 UNC	14 ft-lb	610

Note: Tabulated loads are based on allowable tensile stress of 12,000 psi (82.87 MPa) reduced by 25% resulting in 9,000psi (62 MPa). From ANSI/MSS SP-58, Table 3.



Conduit Straps/Clips

Cable Flange Clips

Minerallac Cable Flange Clips provide a secure mounting solution for electrical wiring and conduit, designed to fit flanges ranging from 1/16 inch to 1/2 inch depending on application needs. Constructed from high-carbon steel with a zinc-plated finish, these clips offer durability and corrosion resistance in demanding environments. Their precision-engineered design ensures a reliable grip while allowing for efficient installation in electrical and construction applications.

Features

- High-carbon steel
- Zinc-plated finish
- Sold in packages of 100



F4D

Cable Flange Clips Specifications

Part Number	Price	Tubing Size	Fits						
			Flanges	Tubing/Cable	Rigid Metallic Conduit (RMC) Trade Size	Electrical Metallic Tubing (EMT) Trade Size	Intermediate Metallic Conduit (IMC) Trade Size	Reduced Wall Flexible Metal Conduit Trade Size (FMC)	Liquid-tight Flexible Metal Conduit (LFMC) Trade Size
F2A	\$31.50	1/4in	1/16 to 3/16in	0.218 to 0.281	N/A	N/A	N/A	N/A	N/A
F2B	\$32.00	5/16in	1/16 to 3/16in	0.312 to 0.375in	N/A	N/A	N/A	N/A	N/A
F2C	\$32.50	3/8in	1/16 to 3/16in	0.375 to 0.437in	N/A	N/A	N/A	N/A	N/A
F2D	\$33.50	1/2in	1/16 to 3/16in	0.468 to 0.562in	N/A	N/A	N/A	N/A	N/A
F2E	\$35.50	1/2in 9/16in 5/8in 11/16in	1/16 to 3/16in	0.500 to 0.718in	N/A	1/2in	N/A	3/8in	N/A
F4A	\$33.50	1/4in	3/16 to 9/32in	0.218 to 0.281	N/A	N/A	N/A	N/A	N/A
F4D	\$36.50	1/2in	3/16 to 9/32in	0.468 to 0.562in	N/A	N/A	N/A	N/A	N/A
F4E	\$37.00	1/2in 9/16in 5/8in 11/16in	3/16 to 9/32in	0.500 to 0.718in	N/A	1/2in	N/A	3/8in	N/A
F4F	\$38.00	3/4in 13/16in 7/8in 15/16in	3/16 to 9/32in	0.750 to 0.937in	1/2in	3/4in	1/2in	1/2in	1/2in
F8D	\$38.50	1/2in	5/16 to 1/2in	0.468 to 0.562in	N/A	N/A	N/A	N/A	N/A
F8E	\$40.50	1/2in 9/16in 5/8in 11/16in	5/16 to 1/2in	0.500 to 0.718in	N/A	1/2in	N/A	3/8in	N/A

Cable Flange Clips Comparison Chart

		Flange Size (in)		
		1/16 to 3/16	3/16 to 9/32	5/16 to 1/2
Cable Size (in)	0.218 to 0.281	F2A	F4A	
	0.312 to 0.375	F2B		
	0.375 to 0.437	F2C		
	0.468 to 0.562	F2D	F4D	F8D
	0.562 to 0.718	F2E	F4E	F8E
	0.750 to 0.937		F4F	

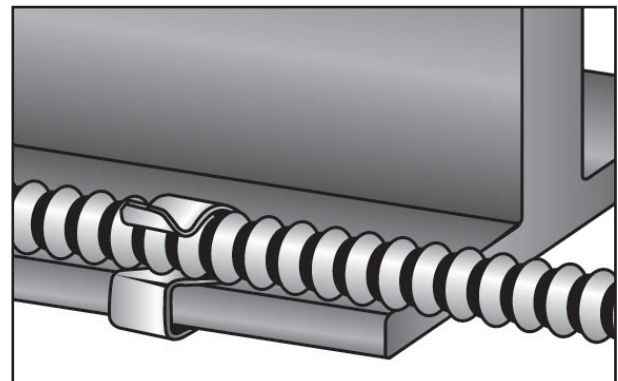



Conduit Straps/Clips

Conduit Clips

Minerallac Conduit Clips provide a secure attachment method for electrical conduit to structural surfaces, ensuring stability in various installations. Constructed for durability and designed to accommodate standard conduit sizes, these clips maintain a firm grip while allowing for straightforward placement. Their precision-engineered form enables efficient mounting in electrical and construction applications.

Features

- Spring steel
- Zinc phosphate plated finish
- Sold in packages of 25 or 100
- 1/4in mounting hole size



KC1234

Conduit Clips Specifications

Part Number	Qty.	Price	Fits		Outside Diameter
			Conduit Trade Size (EMT / IMC / Rigid / LFMC)	Reduced Wall Flexible Metal Conduit Trade Size (FMC)	
KC1	100	\$62.00	1in	1in	1.11-1.31in
KC1-25	25	\$20.50			
KC112	100	\$110.00	1-1/2in	N/A	1.73-1.91in
KC112-25	25	\$32.50			
KC1234	100	\$47.50	1/2in	3/8in	0.70-1.05in
KC1234-25	25	\$17.00	3/4in	1/2in	
KC38	100	\$55.00	3/8in	N/A	0.51in
KC38-25	25	\$19.00			

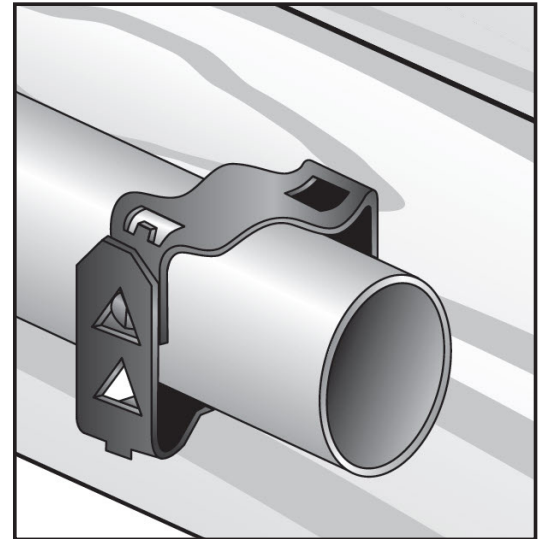

Conduit Clips Comparison Chart

Conduit Size (in)	Part Number
3/8	KC38
1/2 & 3/4	KC1234
1	KC1
1-1/2	KC112

Static Load Limit

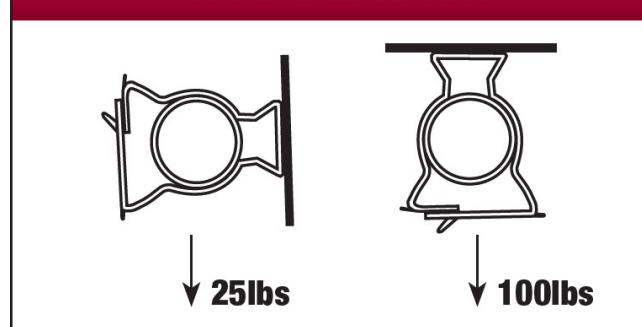

Minerallac[®] Company Conduit Clip/Clamp Assemblies

Beam Clamp Conduit Clips

Minerallac Beam Clamp Conduit Clips provide a secure mounting solution for electrical conduit, integrating with beam clamps for stable support. Engineered for durability, these clips ensure a firm grip while allowing for efficient installation in structural and industrial environments. Designed to accommodate standard conduit sizes, they maintain reliable performance in various applications.

Features

- Spring steel
- Zinc phosphate plated finish
- Sold in packages of 10 or 100



BC516KC1234

Beam Clamp Conduit Clips Specifications

Part Number	Qty.	Price	Fits		
			Flanges	Conduit Trade Size (EMT / IMC / Rigid / LFMC)	Reduced Wall Flexible Metal Conduit Trade Size (FMC)
BC18KC1	100	\$170.00	1/8 to 1/4in	1in	3/4in
BC18KC1-10	10	\$24.00			
BC18KC112	100	\$198.00		1-1/2in	N/A
BC18KC112-10	10	\$27.00			
BC18KC114	100	\$181.00		1-1/4in	1-1/4in
BC18KC114-10	10	\$25.00			
BC18KC1234	100	\$148.00		1/2in 3/4in	3/8in 1/2in
BC18KC1234-10	10	\$22.00			
BC18KC2	100	\$208.00		2in	1-1/2in
BC18KC2-10	10	\$28.00			
BC18KC38	100	\$148.00	5/16 to 1/2in	3/8in	N/A
BC18KC38-10	10	\$22.00			
BC516KC1	100	\$168.00		1in	3/4in
BC516KC1-10	10	\$24.00			
BC516KC112	100	\$202.00		1-1/2in	N/A
BC516KC112-10	10	\$27.00			
BC516KC114	100	\$199.00		1-1/4in	1-1/4in
BC516KC114-10	10	\$27.00			
BC516KC1234	100	\$153.00		1/2in 3/4in	3/8in 1/2in
BC516KC1234-10	10	\$22.50			
BC516KC2	100	\$211.00	9/16 to 3/4in	2in	1-1/2in
BC516KC2-10	10	\$28.00			
BC516KC38	100	\$157.00		3/8in	N/A
BC516KC38-10	10	\$22.50			
BC916KC1	100	\$187.00		1in	3/4in
BC916KC1-10	10	\$25.50			
BC916KC1234	100	\$178.00		1/2in 3/4in	3/8in 1/2in
BC916KC1234-10	10	\$25.00			
BC916KC38	100	\$170.00		3/8in	N/A
BC916KC38-10	10	\$24.00			

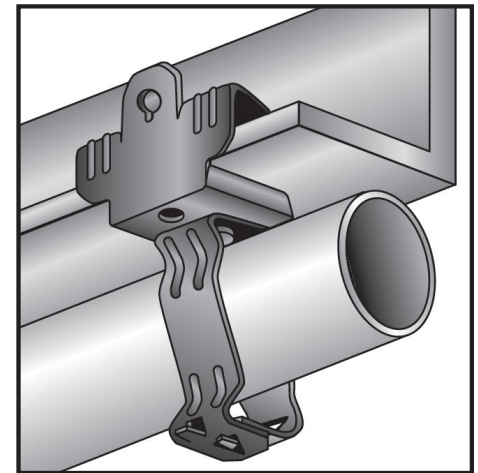

Static Load Limit

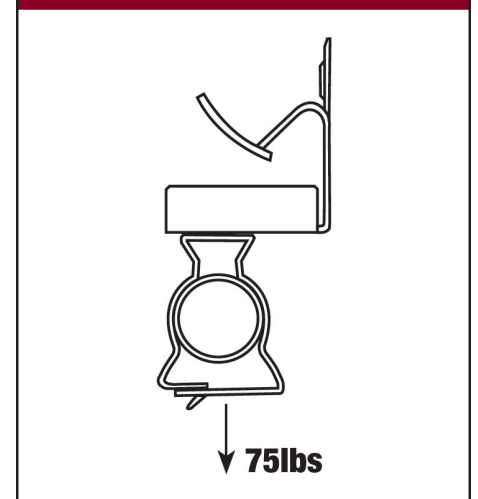

Minerallac[®] Company Conduit Clip/Clamp Assemblies

Screw-On Beam Clamp Conduit Clips

Minerallac Screw-On Beam Clamp Conduit Clips provide a secure and adjustable method for fastening electrical conduit to beam-mounted clamps. Designed for durability and stability, these clips ensure a firm grip while allowing for precise positioning. Their threaded attachment mechanism enables reliable mounting, making them a dependable solution for structural and industrial installations.

Features

- Spring steel
- Zinc phosphate plated finish
- Sold in packages of 10 or 100



500KC1234

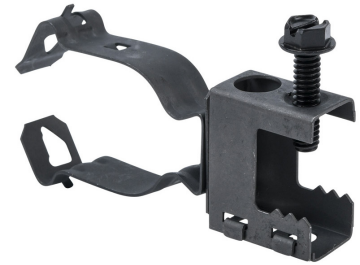

500KC1B

Screw-On Beam Clamp Conduit Clips Specifications

Part Number	Qty.	Price	Fits			Back or Bottom Mount
			Flanges	Conduit Trade Size (EMT / IMC / Rigid / LFMC)	Reduced Wall Flexible Metal Conduit Trade Size (FMC)	
500KC1	100	\$162.00	Up to 1/2in	1in	3/4in	Bottom
500KC1-10	10	\$23.00				Bottom
500KC112B	100	\$215.00		1-1/2in		Back
500KC112B-10	10	\$28.50				Back
500KC114B	100	\$195.00		1-1/4in	1-1/4in	Back
500KC114B-10	10	\$26.50				Back
500KC1234	100	\$149.00		1/2in	3/8in	Bottom
500KC1234-10	10	\$22.00		3/4in	1/2in	Bottom
500KC1234B	100	\$152.00		1/2in	3/8in	Back
500KC1234B-10	10	\$22.00		3/4in	1/2in	Back
500KC1B	100	\$164.00		1in	3/4in	Back
500KC1B-10	10	\$23.50				Back
500KC2B	100	\$226.00		2in	1-1/2in	Back
500KC2B-10	10	\$29.50				Back

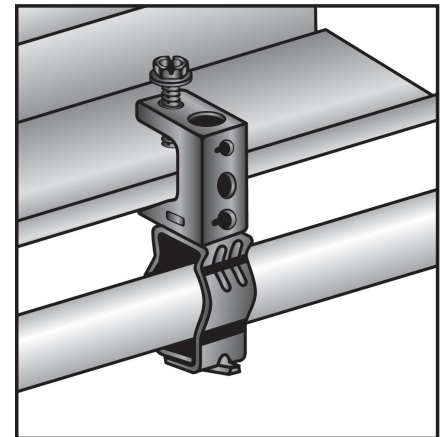

Screw-On Beam Clamp Conduit Clips Comparison Chart

		Clamp Bottom	Clamp Back
Size (in)	1/2 to 3/4	500KC1234	500KC1234B
	<u>1</u>	500KC1	
	1-1/4		500KC114B
	1-1/2		500KC112B
	2		500KC2B

Static Load Limit

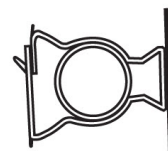

↓ 25lbs



↓ 100lbs

Minerallac[®] Company Conduit Clip/Clamp Assemblies

Conduit Hanger Assemblies

Minerallac Conduit Hanger Assemblies provide a stable suspension system for electrical conduit, supporting secure installation in various environments. Designed for durability, these assemblies ensure reliable positioning while accommodating different conduit sizes. Their construction allows for efficient installation, maintaining structural integrity in electrical and construction applications.

Features

- Spring steel
- Zinc phosphate plated finish
- Sold in packages of 25 or 100



APSKC1

Conduit Hanger Assemblies Specifications

Part Number	Qty.	Price	Fits		
			Flanges (in)	Conduit Trade Size (EMT / IMC / Rigid / LFMC)	Reduced Wall Flexible Metal Conduit Trade Size (FMC)
APSKC1	100	\$108.00	1/8 to 3/8in	1in	3/4in
APSKC1-25	25	\$32.00			
APSKC1234	100	\$123.00		1/2in	3/8in
APSKC1234-25	25	\$35.50		3/4in	1/2in

Conduit Hanger Assemblies Comparison Chart

		Multi-Clip
Size (in)	1	APSKC1
	1/2 to 3/4	APSKC1234

Static Load Limit (Flange)

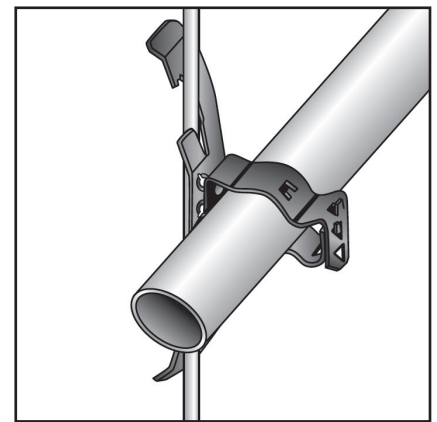
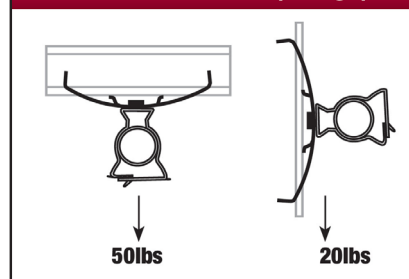

Minerallac[®] Company Conduit Clip/Clamp Assemblies

Conduit Hanger Assemblies

Minerallac Hanger Assemblies provide stable suspension for electrical conduit, ensuring secure support in various installation environments. Designed for durability and ease of placement, these assemblies maintain reliable positioning while accommodating different conduit sizes. Engineered for strength, they enhance structural stability in electrical and construction applications.

Features

- Spring steel
- Zinc phosphate plated finish



SFC516KC1234

Conduit Hanger Assemblies Specifications

Part Number	Qty.	Price	Fits		
			Flanges (in)	Conduit Trade Size (EMT / IMC / Rigid / LFMC)	Reduced Wall Flexible Metal Conduit Trade Size (FMC)
<u>SFC18KC1</u>	100	\$135.00	1/8 to 1/4in	1in	3/4in
<u>SFC18KC1-10</u>	10	\$20.50			
<u>SFC18KC1234</u>	100	\$123.00		1/2in	3/8in
<u>SFC18KC1234-10</u>	10	\$19.50		3/4in	1/2in
<u>SFC18KC38</u>	100	\$115.00		3/8in	N/A
<u>SFC18KC38-10</u>	10	\$18.50			
<u>SFC516KC1</u>	100	\$140.00	5/16 to 1/2in	1in	3/4in
<u>SFC516KC1-10</u>	10	\$21.00			
<u>SFC516KC1234</u>	100	\$125.00		1/2in	3/8in
<u>SFC516KC1234-10</u>	10	\$19.50		3/4in	1/2in
<u>SFC516KC38</u>	100	\$119.00		3/8in	N/A
<u>SFC516KC38-10</u>	10	\$19.00			

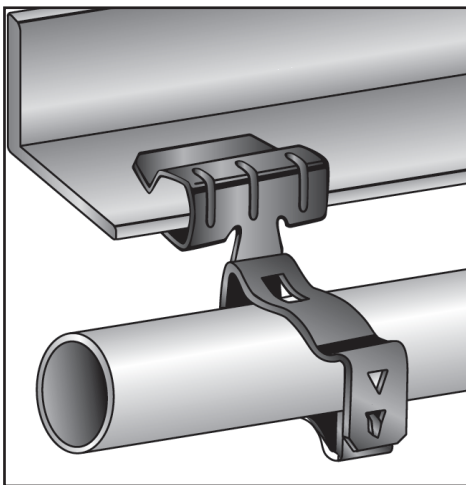

Static Load Limit

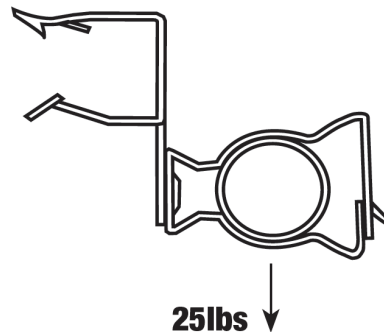



Rod Hanger/Clamp Assemblies

Rod Hangers





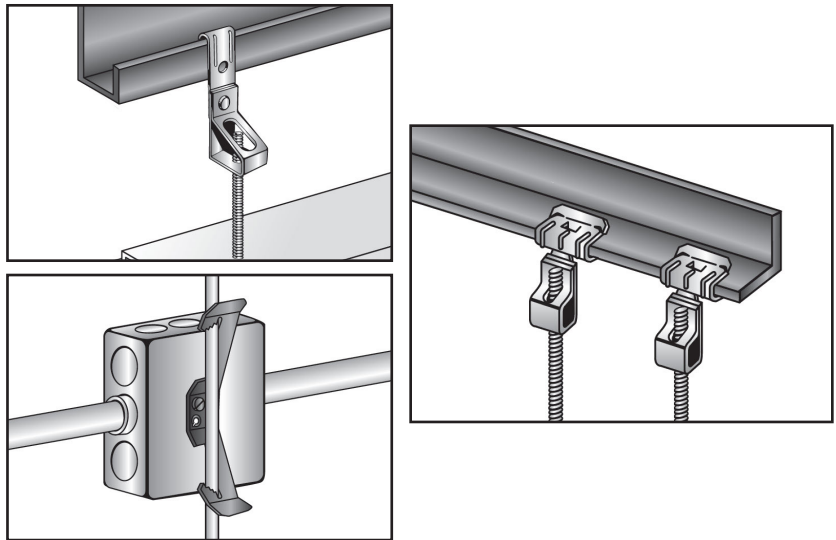

Minerallac Rod Hangers provide secure mounting solutions for threaded rod in structural installations. Available in right-angle brackets, side flange, vertical flange, and Z-perlin configurations, these hangers ensure reliable support for conduit, piping, and other suspended components. Designed for durability, they maintain stability in commercial and industrial environments.

Features

- Sold in packages of 25 or 100



Rod Hangers Specifications

Product Image	Hanger Type	Part Number	Qty.	Price	Fits			Load Rating
					Flanges	Threaded Rod	Mounting Hole Size	
	Multi-function Clip 	<u>APS</u>	100	\$48.00	1/8 to 3/8in	1/4 to 3/8 UNC	#10-24 UNC 1/4-20 UNC 1/4in	N/A
		<u>APS-25</u>	25	\$17.00				
	Right angle bracket	<u>RA14T</u>	100	\$90.00	N/A	1/4-20 UNC	1/4-20 UNC	160 lbs
		<u>RA14T-25</u>	25	\$27.50			3/8-18 UNC	
		<u>RA38T</u>	100	\$93.00				
		<u>RA38T-25</u>	25	\$28.50				
	Side flange 	<u>R1814T</u>	100	\$117.00	1/8 to 1/4in	1/4-20 UNC	N/A	160 lbs
		<u>R1814T-25</u>	25	\$34.00		3/8-18 UNC		
		<u>R1838T</u>	100	\$118.00				
		<u>R1838T-25</u>	25	\$34.50				
		5/16in to 1/2in	<u>R51614T</u>	100	\$120.00	1/4-20 UNC		
			<u>R51614T-25</u>	25	\$35.00	3/8-18 UNC		
			<u>R51638T</u>	100	\$123.00			
			<u>R51638T-25</u>	25	\$36.00			
	Vertical flange	<u>VBC25R14T</u>	100	\$145.00	1/16 to 1/4in	1/4-20 UNC	N/A	100 lbs
		<u>VBC25R14T-25</u>	25	\$41.00		1/4-20 UNC		
		<u>VBC25R38T</u>	100	\$151.00		3/8-18 UNC		
		<u>VBC25R38T-25</u>	25	\$43.00		3/8-18 UNC		
	Z-purlin	<u>ABC25R14T</u>	100	\$135.00		1/4-20 UNC		
		<u>ABC25R14T-25</u>	25	\$38.50		1/4-20 UNC		
		<u>ABC25R38T</u>	100	\$138.00		3/8-18 UNC		
		<u>ABC25R38T-25</u>	25	\$39.50		3/8-18 UNC		



Conduit Straps/Clips

Conduit Straps



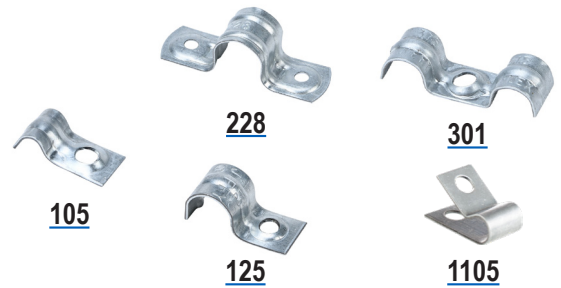

Minerallac Conduit Straps provide a secure fastening solution for electrical conduit, ensuring reliable attachment to structural surfaces. Available in single-hole/single-cable, single-hole/two-cable, and two-hole/single-cable configurations, these straps accommodate various installation requirements while maintaining a firm hold. Designed for durability and ease of installation, they offer dependable support in electrical and construction applications.

Features

- Galvanized steel



Conduit Straps Specifications

Strap Type	Product Image	Part Number	Qty.	Price	Fits					Mounting Hole Size
					Outside Diameter (OD)	Tubing Size	Conduit Trade Size (IMC / Rigid / LFMC)	EMT Trade Size	Reduced Wall Flexible Metal Conduit Trade Size (FMC)	
Duplex strap		300*	100	\$17.50	0.25in	1/4in	N/A	N/A	N/A	3/16in
		300A*	100	\$15.00	0.125in	1/8in	N/A	N/A	N/A	
		301*	100	\$25.00	0.375in	3/8in	N/A	N/A	N/A	
Closed clip		1105*	100	\$14.00	0.25in	1/4in	N/A	N/A	N/A	
One-hole strap		102*	100	\$9.50	0.125in	1/8in	N/A	N/A	N/A	3/16in
		103*	100	\$9.75	0.188in	3/16in	N/A	N/A	N/A	
		105*	100	\$10.00	0.25in	1/4in	N/A	N/A	N/A	
		110*	100	\$12.00	0.313in	5/16in	N/A	N/A	N/A	
		115*	100	\$15.50	0.375in	3/8in	N/A	N/A	N/A	
		120*	100	\$11.00	0.405in		1/8in	N/A	N/A	
						BX Armored Cable Size				
One-hole strap		121	100	\$11.00	0.435-0.475in	14-2 14-3 12-2	N/A	N/A	N/A	3/16in
		121J25	25	\$3.75	0.435-0.475in		N/A	N/A	N/A	
		125	100	\$11.50	0.505-0.551in	12-3 10-2 10-3	N/A	N/A	N/A	
		125J25	25	\$3.75	0.505-0.551in		N/A	N/A	N/A	
		MINE28*	100	\$16.50	0.56in	N/A	N/A	3/8in	1/4in	
		130*	100	\$13.50	0.675-0.706in	N/A	3/8in	1/2in	N/A	1/4in
		130J25*	25	\$4.25	0.675-0.706in	N/A	3/8in	1/2in	N/A	
		140*	100	\$20.00	0.84in	N/A	1/2in	N/A	N/A	
		150*	100	\$25.00	1.00-1.05in	N/A	3/4in	N/A	N/A	
		160*	100	\$47.00	1.30-1.32in	N/A	1in	N/A	1in	5/16in
		170*	100	\$77.00	1.63-1.73in	N/A	1-1/4in	1-1/2in	1-1/4in	
		MED80*	50	\$48.00	1.88-1.91in	N/A	N/A	N/A	N/A	
MED90*	50	\$69.00	2.36-2.38in	N/A	N/A	N/A	N/A			
						Service Entrance Wire Size (SER)				
Two-hole Strap		228*	100	\$21.50	0.70-0.79in	6 AWG	3/8in	1/2in	N/A	3/16in
		240	100	\$16.00	0.80-0.82in	2 AWG	1/2in	N/A	N/A	
		250	100	\$16.50	1.00-1.05in	2/0 AWG	3/4in	N/A	N/A	
		260	100	\$19.50	1.30-1.32in	4/0 AWG	1in	N/A	N/A	
		270	100	\$31.50	1.63-1.73in	N/A	1-1/4in	1-1/2in	1-1/4in	1/4in
		280	100	\$71.00	1.88-1.91in	N/A	1-1/2in	N/A	1-1/2in	
		290	50	\$53.00	2.36-2.38in	N/A	2in	N/A	N/A	

*Not UL Listed