

# Sensor Cables and Connectors

## M12 Patch Cables with LED

- Right-angle M12 female plug with LED indication on one end and axial male plug on the other end
- 0.3m, 0.6m, 1m, 2m, 5m, and 10m cable lengths
- PUR (polyurethane) jacket for oily and direct sunlight applications
- IP67 / IP68 / IP69K, II rated
- LED indication for 10 -36 VDC PNP sensors only

Specifications						
Part Number	Price	Length	Poles	Connectors	LED	Jacket
<b>EVC322*</b>	\$11.50	0.3 m [0.98 ft]	4	Right-angle female, axial male	Yes	PUR
<b>EVC323*</b>	\$12.50	0.6 m [1.97 ft]	4	Right-angle female, axial male	Yes	PUR
<b>EVC324*</b>	\$13.00	1m [3.28 ft]	4	Right-angle female, axial male	Yes	PUR
<b>EVC325*</b>	\$15.00	2m [6.5 ft]	4	Right-angle female, axial male	Yes	PUR
<b>EVC326*</b>	\$17.50	5m [16.4 ft]	4	Right-angle female, axial male	Yes	PUR
<b>EVC327*</b>	\$22.00	10m [32.8 ft]	4	Right-angle female, axial male	Yes	PUR

*\*Note: LED for 10 to 36 VDC PNP devices only.  
Do not use with NPN or analog output devices.  
Do not use when white wire (Pin 2) is used for selection of a sensor function.  
Do not use when emitter has check function.*

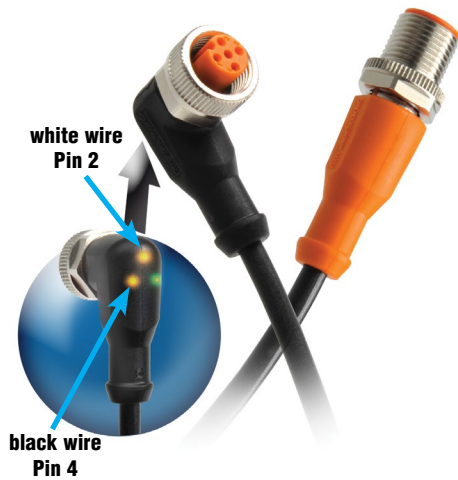

### Wiring

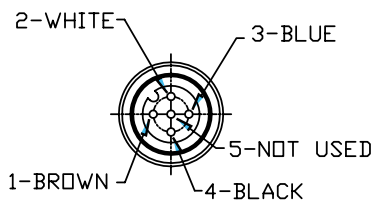
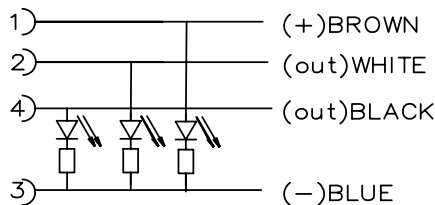

### Dimensions mm [in]

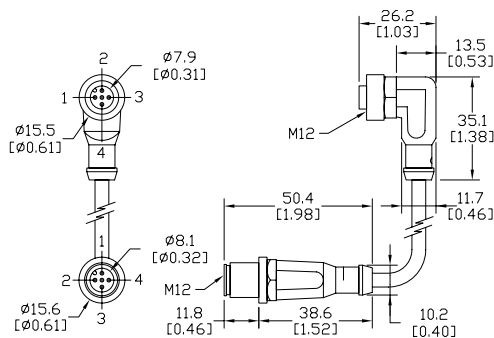

Specifications		
<b>Length</b>	2m [6.5 ft] / 5m [16.4 ft] / 10m [32.8 ft]	
<b>Nominal Voltage</b>	10 to 36 VDC	
<b>Max Current</b>	4A	
<b>LED Current Loading</b>	10V input Brown wire LED: 1.7 mA White and/or Black LED: 0.9 mA 36V input Brown wire LED: 7.3 mA White and/or Black LED: 4.7 mA	
<b>Protection Degree</b>	IP67 / IP68 / IP69K	
<b>Material Nut</b>	Nickel plated Brass	
<b>Jacket Material</b>	Polyurethane (PUR)	
<b>Housing Material</b>	Connector: Orange PUR, Socket: Black PUR	
<b>Contacts Material</b>	Gold plated Brass	
<b>Tightening Torque</b>	Plug: 0.6 to 1.5 N·m (take into account the maximum value of the counterpart) Socket: 0.6 to 1.5 N·m	
<b>Conductors Cross Section</b>	0.34 mm <sup>2</sup> [22 AWG]	
<b>Ø Outer Cable</b>	5mm	
<b>Temperature Range</b>	-25° to +90°C [-13° to 194°F]	
<b>Function Display Power LED</b>	Green	
<b>Switching Status LED</b>	2 x Yellow	
<b>Drag Chain (Roller Cable Tray) Suitability</b>	<b>Bending Radius</b>	min. 10 x cable diameter
	<b>Bending Cycles</b>	>5 million
	<b>Travel Speed</b>	Max. 3.3 m/s for a horizontal travel length of 5m and max. acceleration of 5 m/s <sup>2</sup>
	<b>Torsional Strain</b>	±180°/m
<b>Agency Approvals</b>	UL File E191684, RoHS	

UL Reference	
<b>EVC322</b>	VDOAH043MSS00.3H04STGH040MSS
<b>EVC323</b>	VDOAH043MSS00.6H04STGH040MSS
<b>EVC324</b>	VDOAH043MSS0001H04STGH040MSS
<b>EVC325</b>	VDOAH043MSS0002H04STGH040MSS
<b>EVC326</b>	VDOAH043MSS0005H04STGH040MSS
<b>EVC327</b>	VDOAH043MSS0010H04STGH040MSS

*Note: Shown in UL file under Cable Assemblies using catalog number*