

Precision Limit Switches

High Temperature: HT Series

- Operating up to 200°C (392°F)
- Straight touch, or angled/sliding touch, or mini stopper bolt
- 10 micron (µm) repeat accuracy
- No movement differential
- No temperature drift
- Stainless steel

High Temperature HT Series

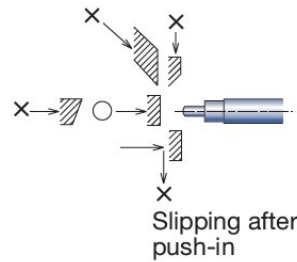
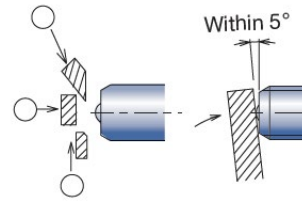

○ indicates correct target approach and orientation.
 × indicates approach and orientation that should be avoided.

High Temperature Precision Limit Switches Selection Chart									
Part Number	Price	Actuator/Head Type*	Barrel Type	Barrel Diameter/Thread	Stroke	Switching Output	Contact Force	Sensor Dimensions	Connection Type
Straight Touch									
CS067A-HT2	\$197.00	Ø 2mm plunger, SR 1.5 mm	Threaded	M6×0.75	2.8 mm (0.110 in)	N.O.	1N	Figure 1	2m (6.56 ft) cable
Indexing/Angled/Sliding Touch									
BP060A-HT2	\$181.00	Ø 3mm ball	Threaded	M6×1.0	0.8 mm (0.031 in)	N.O.	6N Max. 13N	Figure 2	2m (6.56 ft) cable
Heat Resistant Stopper Bolt									
STS060A-HT2	\$161.00	1.5 mm (0.059 in) plunger, 3.4 mm (0.139 in) flat	Threaded	M6×1.0	0.7 mm (0.028 in)	N.O.	1N	Figure 3	2m (6.56 ft) cable
STM82A-HT2	\$158.00	Ø 3 mm (0.118 in) plunger with boot	Threaded	M10×0.75	0.3 mm (0.012 in)	N.O.	1N	Figure 4	2m (6.56 ft) cable

* Ø = diameter, SR = surface radius

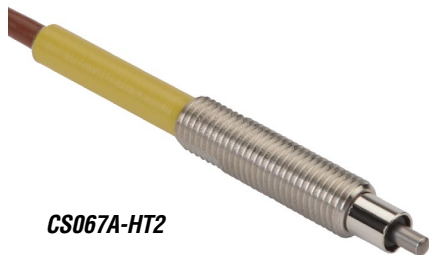

Precision Limit Switches

High Temperature: HT Series

Dimensions

mm [inches]

Figure 1
CS067A-HT2

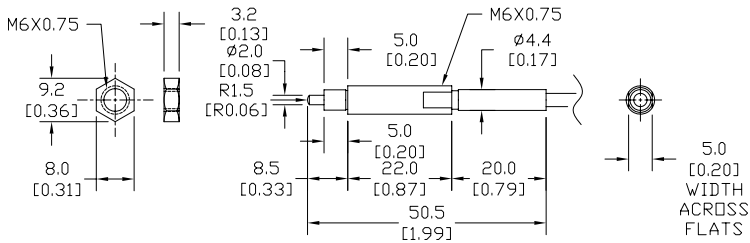

Figure 2
BP060A-HT2

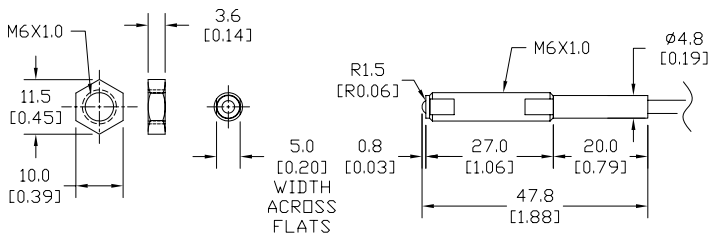
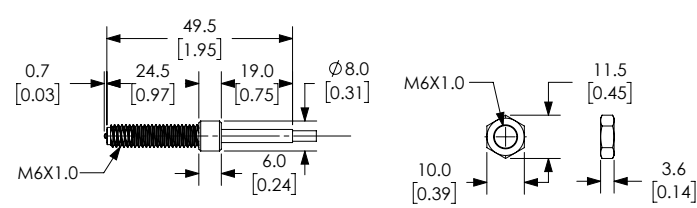
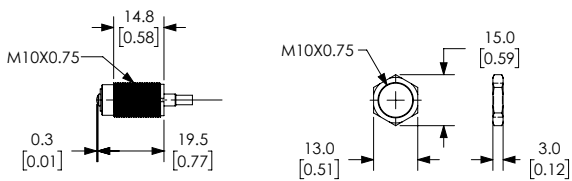

Figure 3
STS060A-HT2



MATERIAL: SUS304

Figure 4
STM82A-HT2



See our website, www.AutomationDirect.com, for complete Engineering drawings.

Precision Limit Switches

High Temperature: HT Series

High Temperature Precision Limit Switches Specifications						
	CS067A-HT2	BP060A-HT2			STS060A-HT2	STM82A-HT2
Environmental						
Degree of Protection	IP65**	IP40**			IP40**	IP65**
Temperature Range	Operating: 0–200°C (32–392°F) (Ice-free)					
Mechanical Ratings						
Enclosure Material	Stainless steel					
Pretravel	0.3 mm (0.012 in)			0.3 mm (0.012 in) from stopping face		Middle of stroke
Torque (for nuts on threaded barrels, set screws on smooth barrels)	4 N·m	See BP060A-HT2 Torque Limit Figure				
		L1: 2.5 N·m (1.844 lb·ft)	L2: 5 N·m (3.688 lb·ft)	L3: 5 N·m (3.688 lb·ft)	L1: 5 N·m (3.688 lb·ft)	L2: 5 N·m (3.688 lb·ft)
Oscillation	10–55Hz total amplitude 1.5 for X, Y, Z each direction					
Impact	300 m/s ² for X, Y, Z each direction					
Electrical Ratings						
Contact Life	3 million operations					
Repeat Accuracy	Both On–Off, Off–On: 0.01 mm* **					
Recommended Minimum Operating Speed	10 mm (0.394 in)/minute					
Contact Voltage	5–24VDC					
Steady Current Rating	10mA or less					
Max In-rush Current Rating	20mA					
Connection Type	Cable: 2m Heat resistant Ø2.8/2 cores, 26AWG					
Indicating	N/A					

* At operating speed 50-200 mm (1.97-7.87 in)/minute. Operating speed slower than 10 mm (0.39 in)/min is not recommended.

** At normal temperature (0–80°C [32–176°F]).

Circuit Diagrams

Normally open (NO)

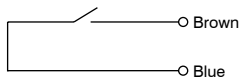

Torque Limits

BP060A-HT2

