

# Eaton Limit Switches

## F25 Series NEMA Limit Switches

- 9 side rotary heads available
- 90-degree adjustable head. Levers are adjustable to any angle on the operating shaft.
- Die-cast zinc housing for industrial applications
- Fully assembled out of box
- SPDT and DPDT snap action configurations available
- 1/2 inch NPT conduit opening
- Contact patterns similar to those of leading competitors



A



B



C



D

F25 Series								
Part Number	Price	Actuator Type	Snap Action Contacts	Travel to Operate Contacts	Total Travel	Force to Operate Contacts	Diagram	Photo
<b>Side Rotary</b>								
<b>F25ASRL200</b>	\$94.00	1.5 inch stainless steel lever with Nylatron roller	1NO, 1NC	5°	90°	3 lb in (0.34 Nm)	Figure 1	A
<b>F25BSRL200</b>	\$116.00		2NO, 2NC					B
<b>F25ASRL355</b>	\$94.00	1.5 inch stainless steel lever with metal roller	1NO, 1NC				Figure 1	C
<b>F25BSRL355</b>	\$116.00		2NO, 2NC				D	
<b>F25ASRL549</b>	\$103.00	2 inch stainless steel lever with metal roller	1NO, 1NC				Figure 2	E
<b>F25BSRL549</b>	\$125.00		2NO, 2NC				F	
<b>F25ASRL551</b>	\$104.00	3 inch stainless steel lever with metal roller	1NO, 1NC				Figure 3	G
<b>F25BSRL551</b>	\$126.00		2NO, 2NC				H	
<b>F25ASRL548</b>	\$104.00	3 inch stainless steel lever with Nylatron roller	1NO, 1NC				Figure 3	I
<b>F25BSRL548</b>	\$126.00		2NO, 2NC					
<b>F25ASRL539</b>	\$107.00	Adjustable stainless steel lever with ball bearing roller	1NO, 1NC				Figure 4	
<b>F25BSRL539</b>	\$129.00		2NO, 2NC					
<b>F25ASRL201</b>	\$103.00	Side rotary adjustable stainless steel lever with Nylatron roller	1NO, 1NC				Figure 5	
<b>F25BSRL201</b>	\$125.00		2NO, 2NC					
<b>F25ASRL421</b>	\$103.00	Adjustable spring stainless steel rod	1NO, 1NC	Figure 6				
<b>F25BSRL421</b>	\$125.00		2NO, 2NC					
<b>F25ASRL142</b>	\$103.00	6 inch Nylatron loop	1NO, 1NC	Figure 7				
<b>F25BSRL142</b>	\$125.00		2NO, 2NC					



E



F



G



I

H



# Eaton Limit Switches Dimensions

## Dimensions

inches [mm]

**Figure 1**

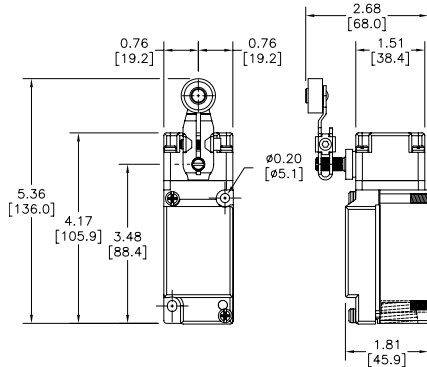

**Figure 2**

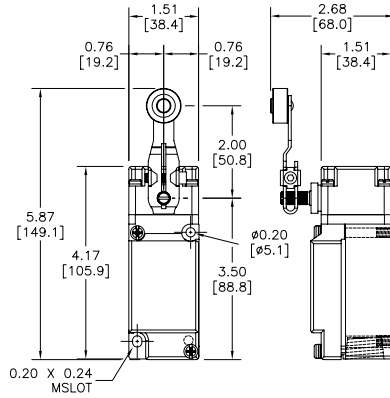

**Figure 3**

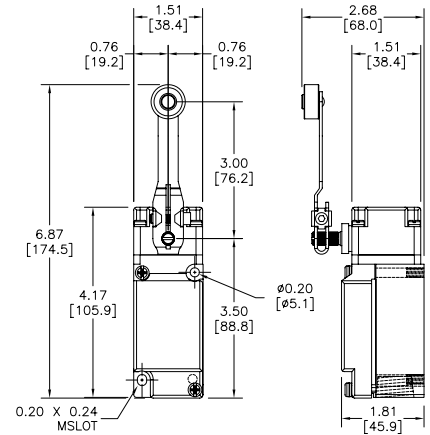

**Figure 4**

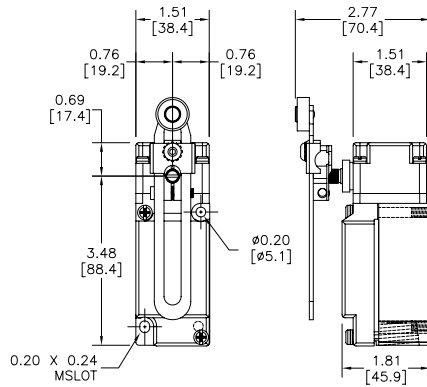

**Figure 5**

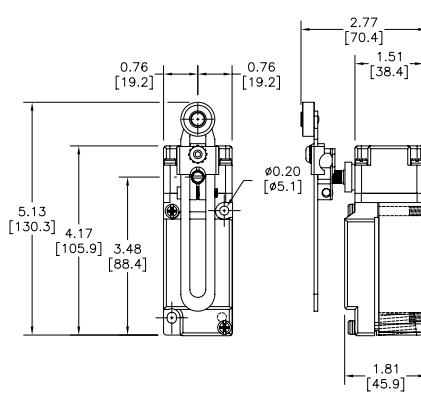

**Figure 6**

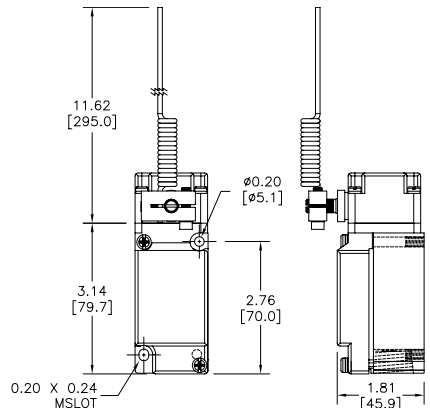

**Figure 7**

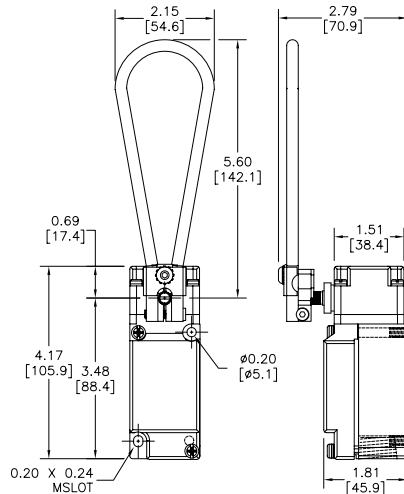

# Eaton Limit Switches

## F25 Series NEMA Limit Switches

- 6 push and 3 wobble heads available
- 90-degree adjustable head
- Die cast zinc housing for industrial applications
- Fully assembled out of box
- SPDT and DPTD snap action configurations available
- 1/2 in NPT conduit opening
- Contact patterns similar to those of leading competitors

F25 Series								
Part Number	Price	Actuator Type	Snap Action Contacts	Travel to Operate Contacts	Total Travel	Force to Operate Contacts	Diagram	Photo
<b>Side Push</b>								
F25ASP1	\$98.00	Side metal plunger	1NO, 1NC	0.065 in (1.651 mm)	0.290 in (7.366 mm)	4 lbs (1.81 kg)	Figure 1	A
F25BSP1	\$124.00		2NO, 2NC					
F25ASP2	\$111.00	Side metal plunger adjustable	1NO, 1NC					
F25BSP2	\$136.00		2NO, 2NC					
F25ASP3	\$111.00	Side metal plunger with metal roller	1NO, 1NC				Figure 3	C
F25BSP3	\$133.00		2NO, 2NC					
<b>Top Push</b>								
F25ATP1	\$92.00	Metal plunger	1NO, 1NC	0.040 in (1.00 mm)	0.280 in (7.366 mm)	4 lbs (1.81 kg)	Figure 4	D
F25BTP1	\$117.00		2NO, 2NC					
F25ATP2	\$111.00	Metal plunger adjustable	1NO, 1NC					
F25BTP2	\$136.00		2NO, 2NC					
F25ATP3	\$98.00	Metal plunger with metal roller	1NO, 1NC				Figure 6	F
F25BTP3	\$124.00		2NO, 2NC					
<b>Wobble Head</b>								
F25AW2	\$90.00	360 degree nylon rod	1NO, 1NC	10°	15°	2 in-lbs (1.23 Nm)	Figure 7	G
F25BW2	\$127.00		2NO, 2NC					
F25AW3	\$90.00	360 degree stainless steel rod	1NO, 1NC					
F25BW3	\$127.00		2NO, 2NC					
F25AW4	\$92.00	360 degree stainless steel spring	1NO, 1NC				Figure 9	I
F25BW4	\$127.00		2NO, 2NC					



A



B



C



D



E



F



G



H



I

# Eaton Limit Switches Dimensions

## Dimensions

inches [mm]

**Figure 1**

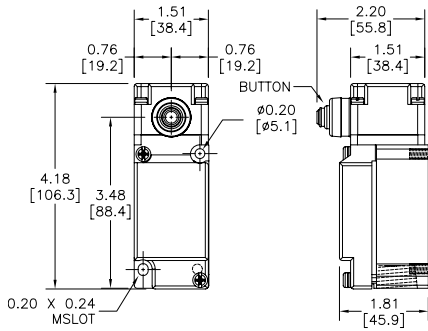

**Figure 2**

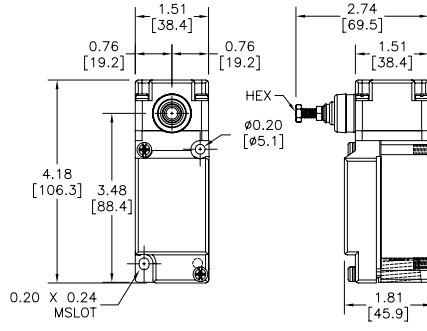

**Figure 3**

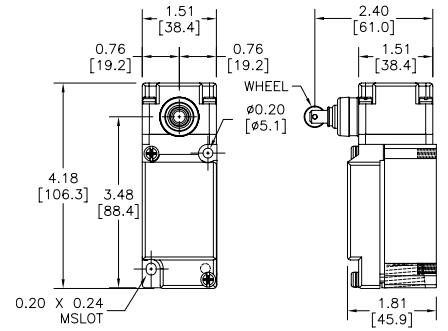

**Figure 4**

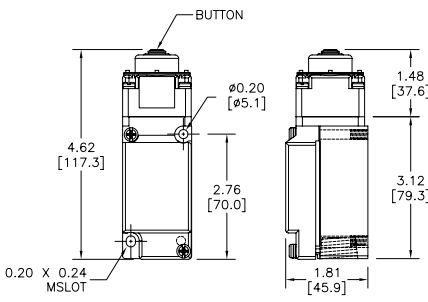

**Figure 5**

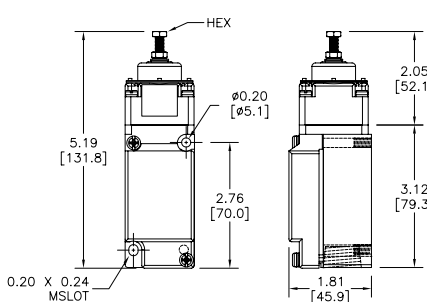

**Figure 6**

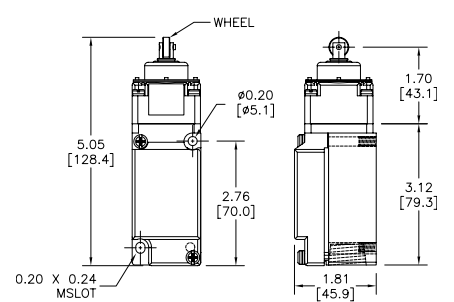

**Figure 7**

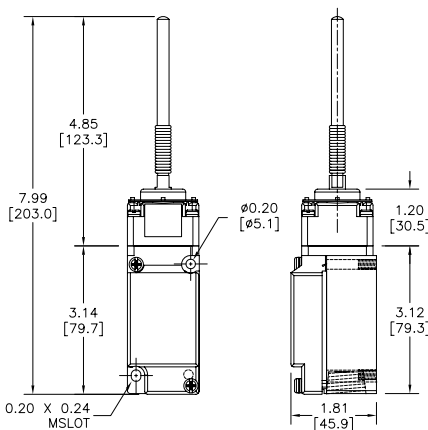

**Figure 8**

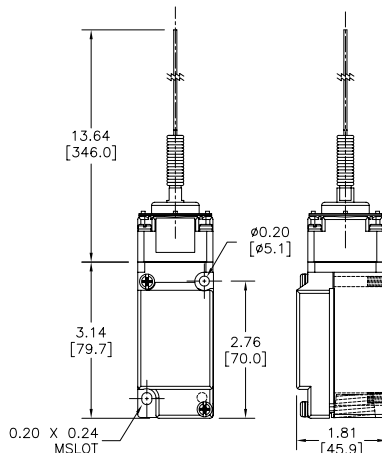

**Figure 9**

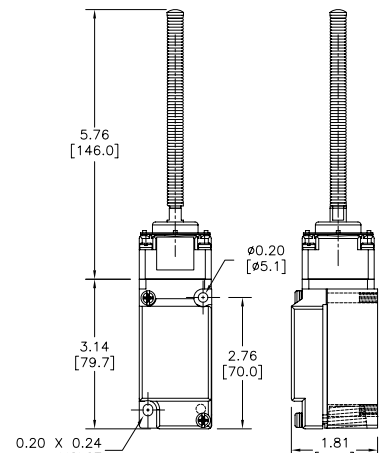

# Eaton Limit Switches General Specifications

Environmental		
<b>Degree of Protection</b>	NEMA 3, 3S, 4, 4X, 6, 6P, 13 IP67	
<b>Temperature Range</b>	Side Rotary 10°F (-12°C) to 200°F (94°C) Side Push 14°F (-10°C) to 200°F (94°C) Wobble 14°F (-10°C) to 250°F (121°C)	
Mechanical Ratings		
<b>Repeat Accuracy</b>	Side Operated: Within 0.0012in. (0.0305mm) Side Push: Within 0.003in. (0.076mm) Top Push: Within 0.002in. (0.051mm)	
<b>Mechanical Life</b>	Side Rotary: 13 million operations minimum Side and Top Push: 10 million operations minimum Wobble: 10 million operations minimum	
<b>Conduit Entrance</b>	1/2 in NPT	
<b>Enclosure Material</b>	Die-cast zinc alloy	
Contact Blocks Rating		
<b>Contact Rating</b>	NEMA A600 R300	
<b>Electrical Ratings</b>	<b>AC</b>	Make: 60A at 120VAC; 30A at 240VAC; 15 A at 480 VAC; 12 A at 600VAC Break: 6A at 120VAC; 3A at 240VAC; 1.5 A at 480 VAC; 1.2 A at 600VAC Continuous: 10A at 480VAC
	<b>DC</b>	Make: 0.25 at 120VDC; 0.125 A at 240VDC
<b>Maximum Switching Frequency</b>	8000 operations per hour	
<b>Electrical Life</b>	Single Pole: 1,000,000 operations typical at full load Double Pole: 100,000 operations typical at full load	
<b>Wiring Connections</b>	AWG #12 through #18 AWG Wire	
<b>Torque Requirements</b>	Switch Body Screws 25 - 30 in-lb (2.8 - 3.4 Nm) Operating Head Screws 14 - 18 in-lb (1.6 - 2.0 Nm)	
Agency Approvals		
cULus 170645 all versions		
F25Ax versions have CE, All units are Reach compliant		



## Connection Diagram

Connection diagram - SPDT, DPDT

The following connection diagram appears on the switch body nameplate.

1 N.O. - 1 N.C.

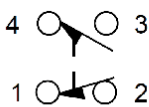

Must be same polarity

2 N.O. - 2 N.C.

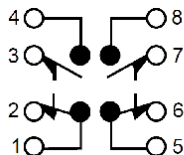

Same polarity each pole

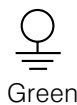

Green

Grounding: Each wiring receptacle contains a green screw terminal providing a GRD connection point for the metal enclosure.