

Fiberglass In-Line Pushbutton



Construction

- Hot compression molded fiberglass reinforced thermoset polyester
- Poured polyurethane seamless gasket provides watertight, dust-tight environmental seal
- Recessed captive stainless steel screws
- 300 Series stainless steel used on all external hardware
- Workable material cuts, drills, punches and saws with ease and accuracy
- Optional mounting feet
- Rounded edges, minimal protrusions or exposed pocket area for accumulation of dust or debris
- Metal grounding strap
- Submersible, non-corrosive environmental design
- Lift off cover with four cover screws
- Non-conductive, impact resistant, UV resistant
- Temperature Range: -40°F to 250°F (-40°C to 120°C)
- Non-flame propagating
- Subpanel not required
- Smooth surface, no color variations, swirls or color pockets, no voids
- Color: Gray

Listings

- UL/cUL 50/508, Types 1, 3, 4X, 6P, 12 [UL File E64791]
- CSA Standard C22.2 Types 1, 3, 4X, 6P, 12 [CSA File 222873]
- NEMA Standard 250 Types 1, 3, 4X, 6P, 12
- Flammability Rating: UL94-5V

30mm Fiberglass In-Line Pushbutton with Lift-off Cover

30mm Fiberglass In-Line Pushbutton with Lift-off Cover			
Part Number	Price	PB Cutouts	Enclosure Overall Size HxWxD
HW-N4X1PB	\$33.50	1	6.63 x 3.81 x 3.89 [168 x 97 x 99]
HW-N4X2PB	\$34.00	2	6.63 x 3.81 x 3.89 [168 x 97 x 99]
HW-N4X3PB	\$37.00	3	8.88 x 3.81 x 3.89 [226 x 97 x 99]
HW-N4X4PB	\$38.00	4	11.13 x 3.81 x 3.89 [283 x 97 x 99]
HW-N4X5PB	\$44.00	5	13.78 x 3.63 x 3.14 [350 x 92 x 80]
HW-N4X6PB	\$51.00	6	17.35 x 3.63 x 3.14 [441 x 92 x 80]

*Notes: Subpanels not required.
Dimensions in inches [millimeters].
Letters in table correspond to letters on dimensional drawings.
Mounting foot kit (HW-N4XMTGFTKIT) must be ordered separately.*



Enclosure Shipping Schedule

Same day	1- 15 days
----------	------------

Color indicates shipping lead time in business days.

22mm Fiberglass In-Line Pushbutton with Lift-off Cover

22mm In-Line Pushbutton with Lift-off Cover			
Part Number	Price	PB Cutouts	Enclosure Overall Size HxWxD
HW-N4X1PB-22	\$33.50	1	6.63 x 3.81 x 3.89 [168 x 97 x 99]
HW-N4X2PB-22	\$34.00	2	6.63 x 3.81 x 3.89 [168 x 97 x 99]
HW-N4X3PB-22	\$37.00	3	6.63 x 3.81 x 3.89 [168 x 97 x 99]
HW-N4X4PB-22	\$38.00	4	8.88 x 3.81 x 3.89 [226 x 97 x 99]
HW-N4X5PB-22	\$44.00	5	11.13 x 3.81 x 3.89 [283 x 97 x 99]
HW-N4X6PB-22	\$51.00	6	11.13 x 3.81 x 3.89 [283 x 97 x 99]
HW-N4X7PB-22	No Match!	7	13.78 x 3.63 x 3.14 [350 x 92 x 80]

*Notes: Subpanels not required.
Dimensions in inches [millimeters].
Letters in table correspond to letters on dimensional drawings.
Mounting foot kit (HW-N4XMTGFTKIT) must be ordered separately.*



Fiberglass In-Line Pushbutton



30mm dimensions



HW-N4X3PB

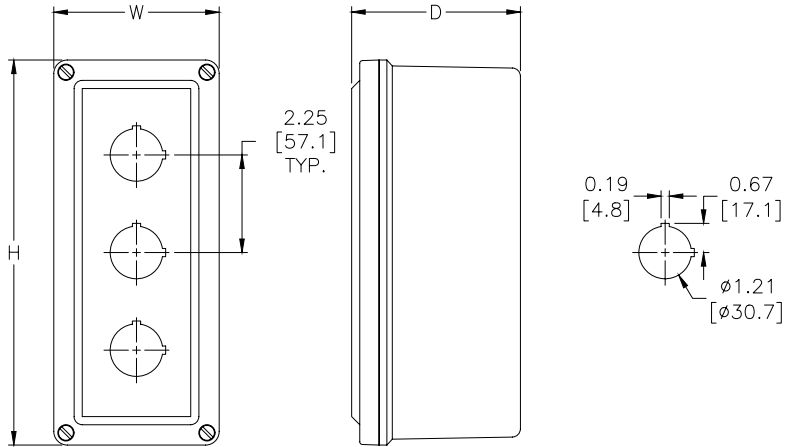

22mm dimensions



HW-N4X3PB-22

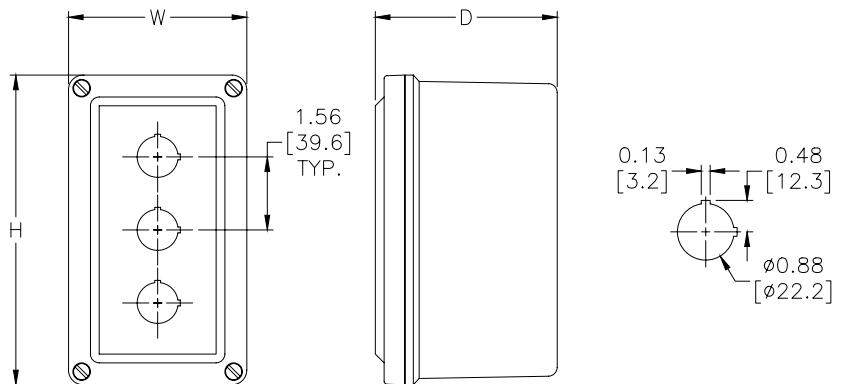

See our website: www.AutomationDirect.com for complete engineering drawings.