

NEMA 12 and 13 Pushbutton Wall Mount



Applications

- Designed to accept standard heavy duty oil-tight pushbuttons, switches and pilot lights.
- Provides protection from dirt, dust, oil and water.

Construction

- Smooth continuously welded seams.
- Welded brackets provide for enclosure mounting.
- Captive cover screws thread into sealed wells.
- Larger enclosures provide internally hinged removable covers, designed to hold the cover open during wiring (see table).
- Oil-resistant gasket and adhesive.
- A bonding stud is provided on the door and a grounding stud is provided on the enclosure.

Finish

- Cover and enclosure are phosphatized and finished in ANSI 61 gray powder coating.

Listings

- UL 508A Type 12 and 13 [UL File E65324]
- CSA Type 12 and 13 [CSA File LR21001]
- Complies with
 - NEMA Type 12 and 13
 - IEC 60529, IP54
- All appropriate components are required to maintain these standards.



Shipping Schedule	
Same day	1 - 15 days
Color indicates shipping lead time in business days.	

NEMA 12 and 13 Pushbutton Wall Mount							
22mm	Price	30mm	Price	Size HxWxD	# Holes	Steel Gauge	Hinged
1435MA	\$49.00	1435A	\$51.00	3.81 x 3.56 x 2.91 [97 x 90 x 74]	1	16	No
1435MB	\$56.00	1435B	\$58.00	6.06 x 3.56 x 2.91 [154 x 90 x 74]	2		No
1435MC	\$63.00	1435C	\$65.00	8.31 x 3.56 x 2.92 [211 x 90 x 74]	3	14	No
1435MF	\$82.00	1435F	\$84.00	7.56 x 6.56 x 3.22 [192 x 167 x 82]	4		Yes
1435MD	\$70.00	1435D	\$74.00	10.56 x 3.56 x 2.92 [268 x 90 x 74]	4		No
1435MH	\$92.00	1435H	\$95.00	9.81 x 6.56 x 3.22 [249 x 167 x 82]	6		Yes
1435MK	\$127.00	1435K	\$111.00	9.81 x 8.81 x 3.22 [249 x 224 x 82]	9		
1435MO	\$121.00	1435O	\$125.00	12.06 x 8.81 x 3.22 [306 x 224 x 82]	12		Yes
1435MS	\$139.00	1435S	\$143.00	12.06 x 11.06 x 3.22 [306 x 281 x 82]	16		

Note: Dimensions in inches [millimeters].

NEMA 12 and 13 Pushbutton Wall Mount



Dimensions

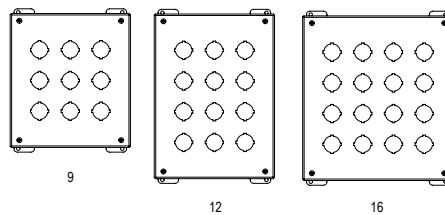
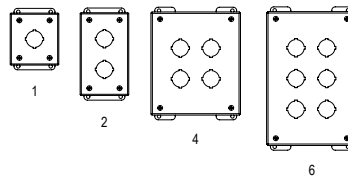
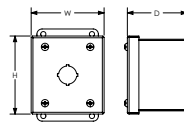
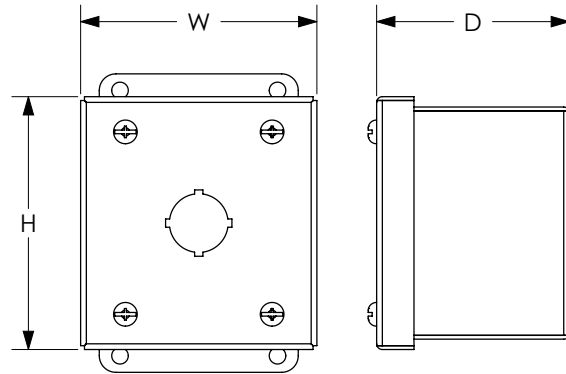

See our website: www.AutomationDirect.com for complete engineering drawings.