



# Ecoline Enclosure LED Lights: Magnet, Clip or Screw Mounted

## Applications

- Suitable for all types of panels and enclosures, especially where space is at a premium
- Suitable for daisy-chaining
- Allows for up to 10 lights to be connected to each other
- No special cables or connectors needed, just connect your wiring to the 2-pole dual cage clamps

## Features

- Energy saving LED technology
- Available with magnet, clip, or screw mounts allowing them to be easily positioned in any enclosure.
- Magnet mount has powerful non-slip rubberized magnets and work on ferrous steel only
- Clip mount has specifically designed clip holders for clip mount of the LED 025. The light is snapped into the clip holders and can be rotated 180°.
- Wide voltage range.
- Dual cage clamp for quick wiring.



## Listings

- UL File No. E234324
- CE, VDE, EAC

Ecoline Enclosure LED Lights							
Magnet Mount	Price	Screw Mount	Price	Clip Mount	Price	Operating Voltage	Switch Type
<b>025403-10</b>	\$53.00	<b>025403-11</b>	\$44.00	<b>025403-13</b>	\$44.00	AC 100 - 240V, 50/60 Hz (min. 90V, max. 265V) DC 90 - 110V (min. 80V, max. 125V)	On/Off
<b>025413-10</b>	\$102.00	<b>025413-11</b>	\$93.00	<b>025413-13</b>	\$93.00	AC 100 - 240V, 50/60 Hz (min. 90V, max. 265V) DC 90 - 110V (min. 80V, max. 125V)	PIR motion sensor
<b>025423-10</b>	\$51.00	<b>025423-11</b>	\$43.00	<b>025423-13</b>	\$43.00	AC 100 - 240V, 50/60 Hz (min. 90V, max. 265V) DC 90 - 110V (min. 80V, max. 125V)	N/A
<b>025401-10</b>	\$70.00	<b>025401-11</b>	\$61.00	<b>025401-13</b>	\$61.00	DC 24-48 (min. 20V, max. 60V)	On/Off switch
<b>025411-10</b>	\$128.00	<b>025411-11</b>	\$119.00	<b>025411-13</b>	\$119.00	DC 24-48 (min. 20V, max. 60V)	PIR motion sensor
<b>025421-10</b>	\$68.00	<b>025421-11</b>	\$60.00	<b>025421-13</b>	\$60.00	DC 24-48 (min. 20V, max. 60V)	N/A

Ecoline Enclosure LED Lights Specifications	
<b>Power Consumption</b>	Max. 5W (~75 W incandescent bulb)
<b>Luminosity</b>	400 Lm at 120° (1,200 Lm at 360° or equivalent 95 W light bulb)
<b>Lamp Type</b>	LED, 120° angle of radiation light color – daylight, color temperature – 6,000 to 7,000 K
<b>Service Life</b>	60,000 hrs. at 68°F [20°C]
<b>Connection</b>	2-pole dual cage clamp for 14 AWG [2.5 mm <sup>2</sup> ] solid wire and 16 AWG [1.5 mm <sup>2</sup> ] stranded wire wire end ferrule
<b>Housing</b>	plastic, transparent
<b>Mounting</b>	Magnet mount Screw mount (M5 screws not included) Clip mount (M6 screws not included)
<b>Operating / Storage Temperature</b>	-22 to 140°F [-30 to 60°C] / -40 to 185°F [-40 to 85°C]
<b>Operating / Storage Humidity</b>	max. 90% RH (non-condensing)
<b>Protection Class</b>	II (double insulated)
<b>Protection Type</b>	IP20
<b>Approvals</b>	CE, UL Recognized File No.: E234324, VDE, EAC, RoHS 2 compliant
<b>Weight</b>	approx. 7 oz. [200 g]



**Connection End**



# Ecoline Enclosure LED Lights: Magnet, Clip or Screw Mounted

## Dimensions

Inches [mm]

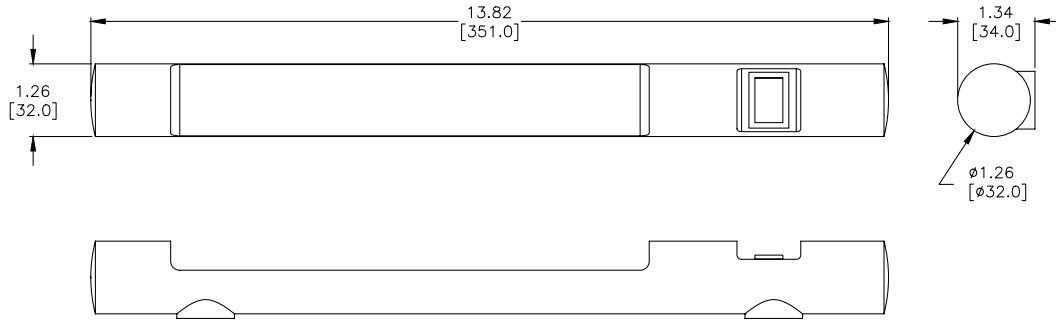

**Magnet Mount**

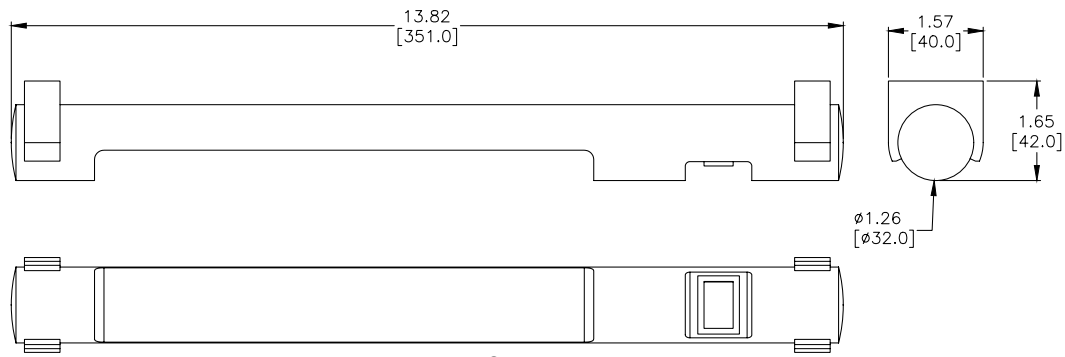

**Clip Mount**

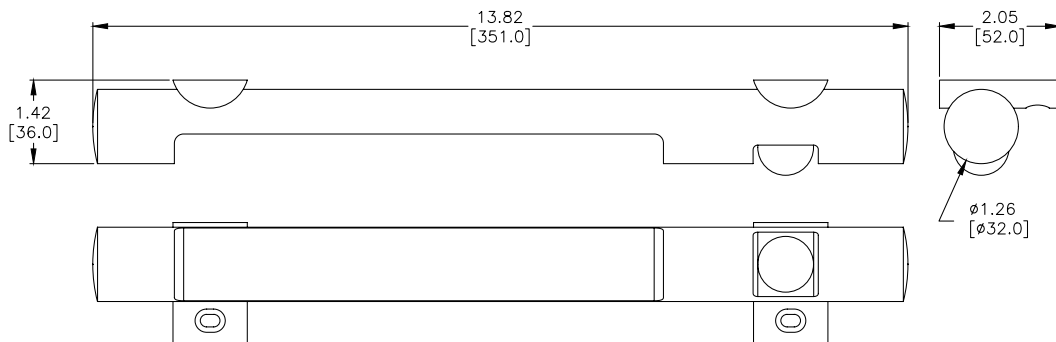

**Screw Mount**

Please see our website [www.AutomationDirect.com](http://www.AutomationDirect.com) for complete engineering drawings.