

HMX1-TMC-OR Cut Sheet

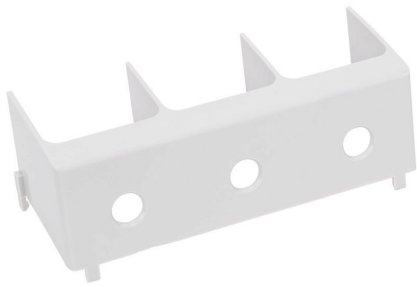

IronHorse terminal shroud, load side, 3-pole. For use with HTOR225 thermal overload relays.

For complete product information, please see this item on our store at the following link:



<https://www.automationdirect.com/pn/HMX1-TMC-OR>

Technical Specifications

Brand	IronHorse
Item	Terminal shroud
Cover Type	Load side
Number of Poles	3
For Use With	HTOR225 thermal overload relays

Agency Approvals

UL Listed File #	None
CE	None
CSA File #	None
RoHS Status	No
EU REACH	View EU REACH document