

DC-JAC20-05 Cut Sheet

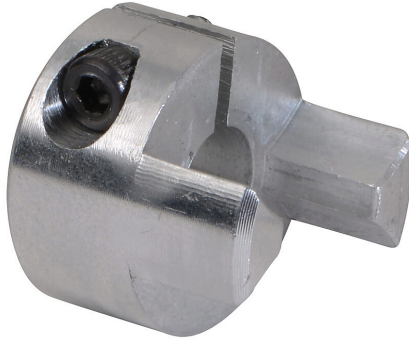

SureMotion drive coupling hub, jaw type, aluminum alloy, clamp, size 20, 5/16in bore. Requires DC-JS20 series spiders.

For complete product information, please see this item on our store at the following link:



<https://www.automationdirect.com/pn/DC-JAC20-05>

Technical Specifications

Brand	SureMotion
Item	Drive coupling hub
Coupling Type	Jaw type
Material	Aluminum alloy
Maximum Angular Misalignment	1.0 degrees
Maximum Parallel Misalignment	0.05mm
Maximum RPM	19040
Attachment Style	Clamp
Coupling Size	20
Bore Diameter	5/16in
Outside Diameter	20mm
Requires	DC-JS20 series spiders

Agency Approvals

UL Listed File #	None
UL Recognized File #	None
UL Hazardous File #	None
CE	None
CSA File #	None
RoHS Status	No
EU REACH	View EU REACH document