

# 25.09.06.00131 Cut Sheet

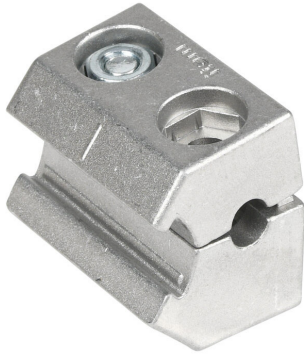

Schmalz PXT series rail connector, threaded, aluminum alloy. For use with D30-I profile.

For complete product information, please see this item on our store at the following link:



<https://www.automationdirect.com/pn/25.09.06.00131>

---

## Technical Specifications

<b>Brand</b>	Schmalz
<b>Series</b>	PXT
<b>Item</b>	Rail connector
<b>Connector Type</b>	Threaded
<b>Internal Vacuum Capable</b>	No
<b>Material</b>	Aluminum alloy
<b>For Use With</b>	D30-I profile
<b>Additional Information</b>	M6 x 1 tapped hole

---

## Agency Approvals

<b>RoHS Status</b>	No
<b>EU REACH</b>	<a href="#">View EU REACH document</a>