

# Achieve™ Wire Duct - Slotted

## Rigid PVC - Open Slot - Wide Finger Wall WDW Series

### Overview

Rugged wire duct made of rigid PVC that carries a UL 94 V0 flammability rating for your wire containment needs. All WDW series wire duct comes in lengths of 6.56 ft [2m], complete with cover.

### Features

- Additional holes on the side walls to be used with cable tie
- Flame-retardant PVC material, self-extinguishing according to UL 94 V0
- Upper and lower score lines for breaking off individual fingers
- Open slot wide finger form factor
- Cover included
- Standard length: 2m [6.56 ft]
- Color option: RAL 7030 Stone Gray
- Complies with RoHS regulations
- Complies with EN 50085-2-3 standards and UL 1565-C22.2No.18.5-02 standards
- Operating temperature range -5 to 50°C [23 to 122°F]



**WDW-1530G-1**



Gray Rigid PVC - Open Slot - Wide Finger Wall - WDW Series						
Part Number	Qty	Price	Actual Size [W x H] inches [mm]	Dimension A inches [mm]	Dimension B inches [mm]	Drawing Link
<a href="#">WDW-1522G-1</a>	1	\$15.00	1.57 x 2.36 [40 x 60]	0.315 [8.0]	0.787 [20.0]	<a href="#">PDF</a>
<a href="#">WDW-1530G-1</a>	1	\$18.00	1.57 x 3.15 [40 x 80]			<a href="#">PDF</a>
<a href="#">WDW-1540G-1</a>	1	\$21.00	1.57 x 3.94 [40 x 100]			<a href="#">PDF</a>
<a href="#">WDW-2222G-1</a>	1	\$15.00	2.36 x 2.36 [60 x 60]			<a href="#">PDF</a>
<a href="#">WDW-2230G-1</a>	1	\$19.00	2.36 x 3.15 [60 x 80]			<a href="#">PDF</a>
<a href="#">WDW-2240G-1</a>	1	\$21.00	2.36 x 3.94 [60 x 100]			<a href="#">PDF</a>
<a href="#">WDW-3022G-1</a>	1	\$20.00	3.15 x 2.36 [80 x 60]			<a href="#">PDF</a>
<a href="#">WDW-3030G-1</a>	1	\$23.00	3.15 x 3.15 [80 x 80]			<a href="#">PDF</a>
<a href="#">WDW-3040G-1</a>	1	\$26.00	3.15 x 3.94 [80 x 100]			<a href="#">PDF</a>
<a href="#">WDW-4030G-1</a>	1	\$26.00	3.94 x 3.15 [100 x 80]			<a href="#">PDF</a>
<a href="#">WDW-4040G-1</a>	1	\$31.00	3.94 x 3.94 [100 x 100]			<a href="#">PDF</a>
<a href="#">WDW-6040G-1</a>	1	\$42.00	5.91 x 3.94 [150 x 100]			<a href="#">PDF</a>

Cover included.

### Dimensions

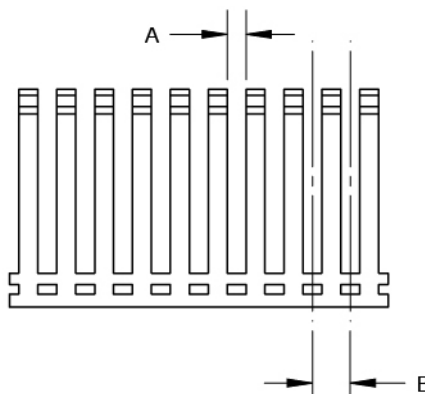
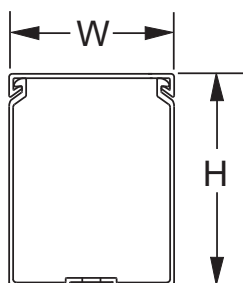



# Wire Duct - Slotted

## Wire Fill Capacity

Rigid PVC - Open Slot - Wide Finger Wall - WDW Series																			
Application	Electrical															Communication			
Conductor Size	8 AWG	10 AWG	12 AWG			14 AWG			16 AWG			18 AWG			22 AWG	23 AWG	23/24 AWG	24 AWG	Fiber Cable
Wire/Cable	0.22"	0.16"	0.13"	0.14"	0.15"	0.11"	0.12"	0.13"	0.10"	0.11"	0.12"	0.08"	0.10"	0.11"	0.08"	0.33"	0.25"	0.19"	0.12"
Insulation Type	THHN	THHN	THHN	MTW	MTW	THHN	MTW	MTW	TFFN	MTW	MTW	TFFN	MTW	MTW	MTW	Cat. 6A	Cat. 6	Cat. 5E	3.0 mm
Duct Size Inches [mm]	Recommended Maximum Number of Wires/Cables per Wire Duct (based on 50% fill capacity)																		
<b>WDW-1522G-1</b> 1.57 x 2.36 [40x60]	41	71	114	97	83	156	125	108	209	156	138	272	192	171	267	17	30	53	137
<b>WDW-1530G-1</b> 1.57 x 3.15 [40x80]	55	95	152	129	111	208	167	145	279	208	184	364	257	228	355	23	41	71	184
<b>WDW-1540G-1</b> 1.57 x 3.94 [40x100]	73	127	202	172	148	278	222	193	372	278	246	485	342	305	474	31	54	94	245
<b>WDW-2222G-1</b> 2.36 x 2.36 [60x60]	62	107	170	145	125	235	187	163	314	235	208	409	289	257	400	26	46	79	207
<b>WDW-2230G-1</b> 2.36 x 3.15 [60x80]	82	143	227	194	167	313	250	217	419	313	277	546	385	343	533	35	61	106	276
<b>WDW-2240G-1</b> 2.36 x 3.94 [60x100]	108	189	303	258	222	417	333	288	558	417	369	726	513	456	711	45	81	141	366
<b>WDW-3022G-1</b> 3.15 x 2.36 [80x60]	82	143	227	194	167	313	250	217	419	313	277	546	385	343	533	35	61	106	276
<b>WDW-3030G-1</b> 3.15 x 3.15 [80x80]	108	189	303	258	222	417	333	288	558	417	369	726	513	456	711	45	81	141	366
<b>WDW-3040G-1</b> 3.15 x 3.94 [80x100]	144	252	404	344	296	556	444	384	744	556	492	968	684	608	948	60	108	188	488
<b>WDN-4030G-1</b> 3.94 x 3.15 [100x80]	144	252	404	344	296	556	444	384	744	556	492	968	684	608	948	60	108	188	488
<b>WDW-4040G-1</b> 3.94 x 3.94 [100x100]	192	336	539	459	395	741	592	512	992	741	656	1291	912	811	1264	80	144	251	651
<b>WDW-6040G-1</b> 5.91 x 3.94 [150x100]	288	504	808	688	592	1112	888	768	1488	1112	984	1936	1368	1216	1896	120	216	376	976

Cover included.

# Achieve™ Wire Duct - Slotted

Rigid PVC - Open Slot - Narrow Finger Wall WDN Series and Wide Finger Wall WDW Series

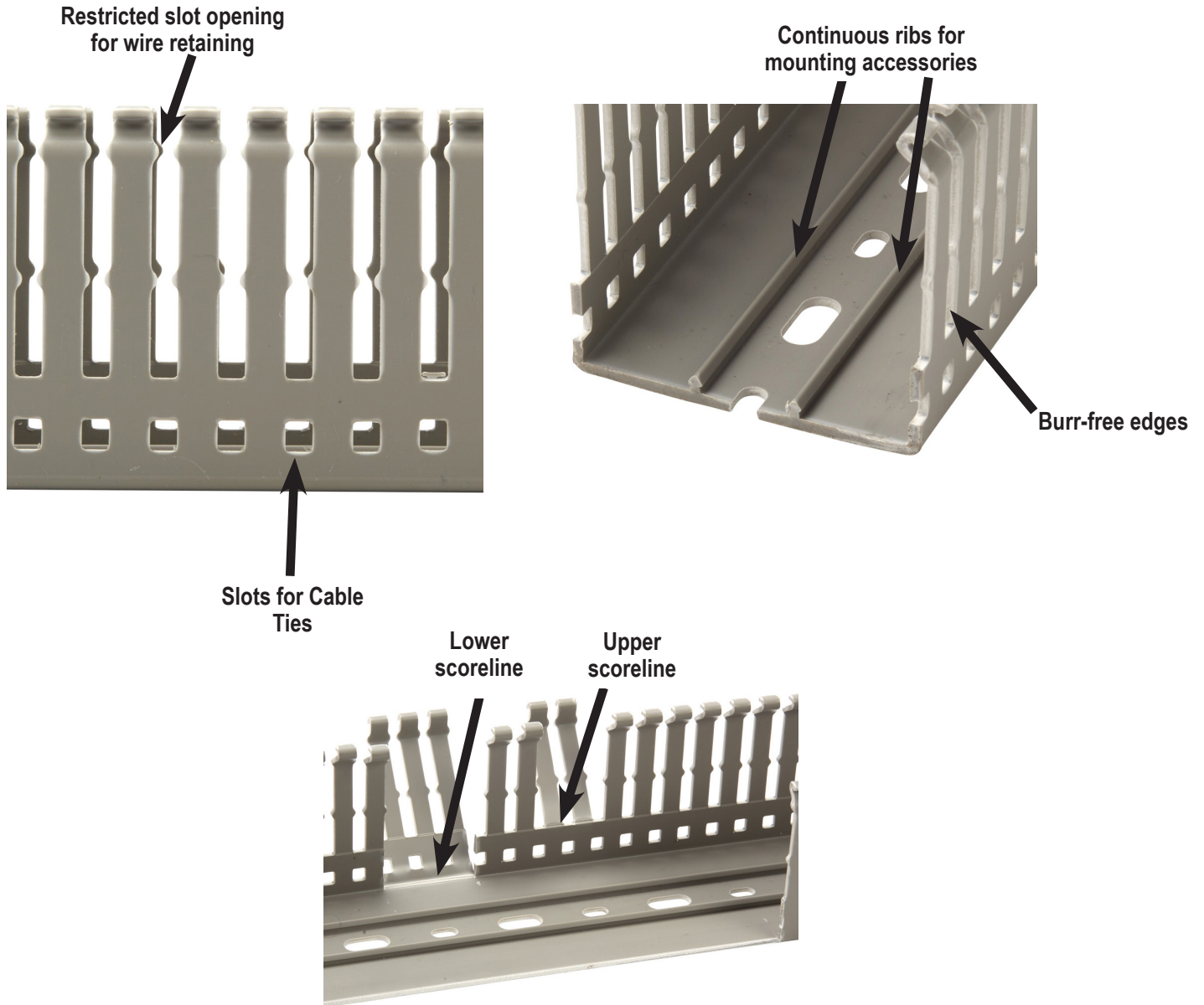

# AchieVe™ Wire Duct - Accessories

## Cable Tie Attachment

### Overview

The AchieVe cable tie attachment is for use along with a cable tie to group wires together inside the wire duct. The **WD-CTCLAMP** snaps onto either of the continuous ribs and can be easily repositioned once installed.



### Features

- Material: Polyamid (PA), flammability rating of UL94 V-2
- Operating Temperature Range: -55 to 120°C [-67 to 248°F]
- CE



Cable Tie Attachment					
Part Number	Price	Description	Color	Qty	Drawing Link
<b>WD-CTCLAMP</b>	\$9.00	AchieVe cable tie attachment for use with AchieVe wire duct 1.5" width or larger.	Black	50	<a href="#">PDF</a>

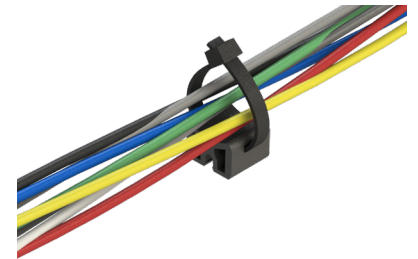

### Dimensions inches [mm]

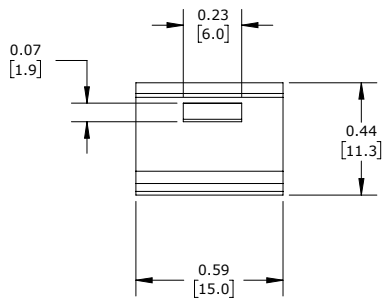

## Wire Retainers

### Overview

For holding wires during wiring operations, these retainers are essential. They allow easy access to the interior of the wire duct during maintenance or alterations, or for isolating specific wires/cables, while assuring that wiring bundles will not fall out when the duct cover is removed. Installed by snapping into the two continuous ribs on the inside bottom face of the wire duct.



### Features

- Material: Polyamid (PA), flammability rating of UL94 V-2
- Operating Temperature Range: -40 to 120°C [-40 to 248°F]
- CE



Wire Retainers					
Part Number	Price	Description	Color	Qty	Drawing Link
<b>WD-RET-1515</b>	\$8.00	AchieVe wire retainer for use with AchieVe wire duct 1.5 x 1.5 in or larger.	Black	10	<a href="#">PDF</a>
<b>WD-RET-1522</b>	\$9.00	AchieVe wire retainer for use with AchieVe wire duct 1.5 x 2.25 in or larger.	Black	10	<a href="#">PDF</a>
<b>WD-RET-2230</b>	\$12.00	AchieVe wire retainer for use with AchieVe wire duct 2.25 x 3.0 in or larger.	Black	10	<a href="#">PDF</a>

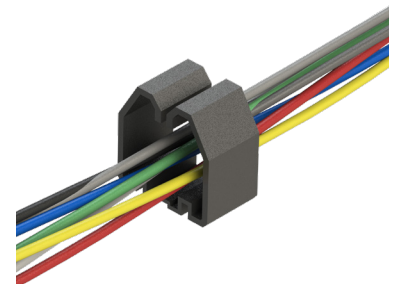

# AchieVe™ Wire Duct - Accessories

## Wire Separator

### Overview

The AchieVe wire separator easily clips onto wire duct fingers and is used to separate wires within the duct. Score lines to break off for compatibility with multiple wire duct widths adjustable for 1.5" or larger width duct.



### Features

- Material: Polyamid (PA), flammability rating of UL94 V-2
- Operating Temperature Range: -55 to 120°C [-67 to 248°F]
- CE



Wire Separator					
Part Number	Price	Description	Color	Qty	Drawing Link
<a href="#">WD-CHOLDER</a>	<a href="#">\$4.00</a>	AchieVe wire separator for use with AchieVe wire duct 1.5" width or larger.	Black	10	<a href="#">PDF</a>

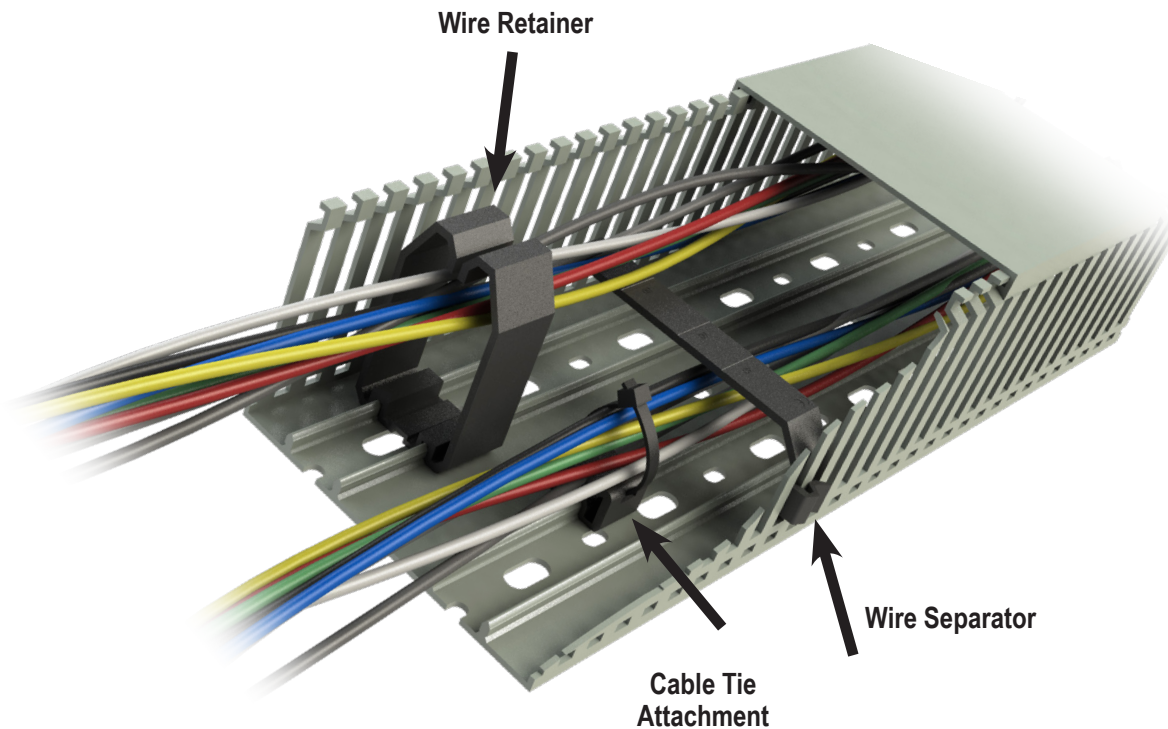

# Wire Duct - Accessories

## Rivets and Rivet Tools

Wire duct rivets install quickly and easily with the companion rivet tool, offering good temperature resistance and excellent mechanical properties. They can be used to install all types of wire duct with standard mounting holes.

Wire Duct Rivets and Rivet Tools			
Part Number	Price	Description	Qty
<b>R4*</b>	\$19.00	Blue polyamide rivet used to install all types of wire duct with standard 4.5 mm [0.17 in] mounting holes.	250
<b>B4</b>	\$50.00	Red polyamide rivet tool used to install R4 rivets.	1
<b>R6*</b>	\$22.00	Natural polyamide rivet used to install all types of wire duct with standard 6.5 mm [0.26 in] mounting holes.	250
<b>B6</b>	\$50.00	Yellow polyamide rivet tool used to install R6 rivets.	1

\* R4 drill hole size - 5/32" (4mm), R6 drill hole size - 7/32" [5.5 mm]

