

Roxburgh RES90 Series EMI Filters

Single-phase Drive Rated EMI Filters

The Roxburgh RES90 Series filters feature excellent attenuation performance suitable for noisy applications where increased filter performance is required. They are specifically designed as line filters for single-phase 120/240V AC and DC drives.

RES90 Series are a multi-stage EMC filter with very high differential and common mode attenuation rated up to 250V. The filters can be integrally mounted in cabinet or chassis hardware. Available in 1/4" quick disconnect type (RES90F) and screw terminal type (RES90S).

Features

- 0-240VAC/DC, 0-400 Hz, single-phase
- 1A - 30A models
- Very high performance type in a metal case
- 1/4" quick connect or screw terminals
- Panel mount

Filter performance curves are available on item page at www.AutomationDirect.com

Applications

- Ideally suited for products that must conform to part 15, FCC regulations
- Single-phase AC and DC drives
- Digital electronics
- Personal computers and peripherals
- Office automation
- Building automation
- Monitors and display units
- Household and consumer devices
- Machinery design

Standards and Certifications



| RES90 EMI Filters | | |
|--------------------------|-----------|--|
| Part Number | Price | Description |
| RES90F01 | \$10ka: | EMI Input filter, 1-phase 120/240VAC, multi-stage drive grade, 1A |
| RES90F03 | \$10kb: | EMI Input filter, 1-phase 120/240VAC, multi-stage drive grade, 3A |
| RES90F06 | \$10kc: | EMI Input filter, 1-phase 120/240VAC, multi-stage drive grade, 6A |
| RES90F10 | \$10kd: | EMI Input filter, 1-phase 120/240VAC, multi-stage drive grade, 10A |
| RES90F16 | \$010ke: | EMI Input filter, 1-phase 120/240VAC, multi-stage drive grade, 16A |
| RES90S20 | \$;010kf: | EMI Input filter, 1-phase 120/240VAC, multi-stage drive grade, 20A |
| RES90S30 | \$010kg: | EMI Input filter, 1-phase 120/240VAC, multi-stage drive grade, 30A |

| General Specifications | |
|------------------------------------|---|
| Voltage Rating | 0-240V AC/DC, 0-400 Hz |
| Voltage Max. | 250V |
| Voltage Withstand | 3000VDC/2 sec |
| Phase | 1 |
| UL/IEC Pollution Class | Degree II |
| Humidity | 93% RH (non-condensing) |
| Overload Current | 135% 2Hrs, 150% 60s |
| Insulation Resistance | 500VDC >3.5 MΩ |
| Climate Class (IEC 60068-1) | 25/100/21 |
| Temperature Rise | 60°C |
| Temperature Rating | -13 to 212°F (-25 to 100°C) |
| Flammability (UL94) | V-2 |
| Case Material | Nickel Plated Steel |
| Altitude* | 1000m (3000m with derating) |
| Mounting Clearance | >50mm Gap |
| Agency Approval** | cURus: File# E191581 (Standard: UL1283 & C22.2 No.8) |

* Derate 1% per 100m after 1000m; Max 3000m.

**To obtain the most current agency approval information, see the Agency Approval Checklist section on the specific component part number web page.

Roxburgh RES90 Series EMI Filters

| Specifications | | | | | | | |
|--------------------------------------|-----------------------|-------------|----------|------------|-------------|------------|------------|
| Parameter | RES90F01 | RES90F03 | RES90F06 | RES90F10 | RES90F16 | RES90S20 | RES90S30 |
| Max. Power (kW) | 0.25 | 0.75 | 1.5 | 2.5 | 4 | 5 | 7.5 |
| Current Rating (A) | 1 | 3 | 6 | 10 | 16 | 20 | 30 |
| SCCR Rating (kA) | 5 | | | | | | |
| Ingress Protection | IP20 | | | | | | |
| Terminal Style | 1/4" Quick Disconnect | | | | | M4 Stud | |
| Torque (lb-in [N·m]) | N/A | | | | | 11.5 [1.3] | |
| Operational Leakage Current (mA) | 0.5 | | 0.67 | | 1.02 | | |
| Total Resistance (Line to Load) (mΩ) | 750 | 250 | 100 | 500 | 15 | 50 | 300 |
| Residual Voltage (V@5s) | 1V@5s | | | | | | |
| Heat Dissipation (W) | 0.75 | 2.25 | 3.6 | 5 | 12.8 | 20 | 7.2 |
| Weight (lb [kg]) | 0.18 [0.08] | 0.44 [0.20] | | 1.0 [0.45] | 0.92 [0.42] | | 1.2 [0.55] |

Dimensions

mm [inches]

RES90F01

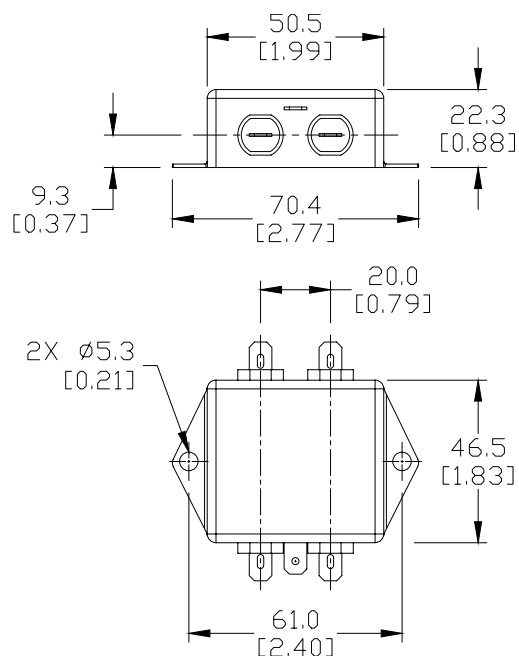

**RES90F03
RES90F06**

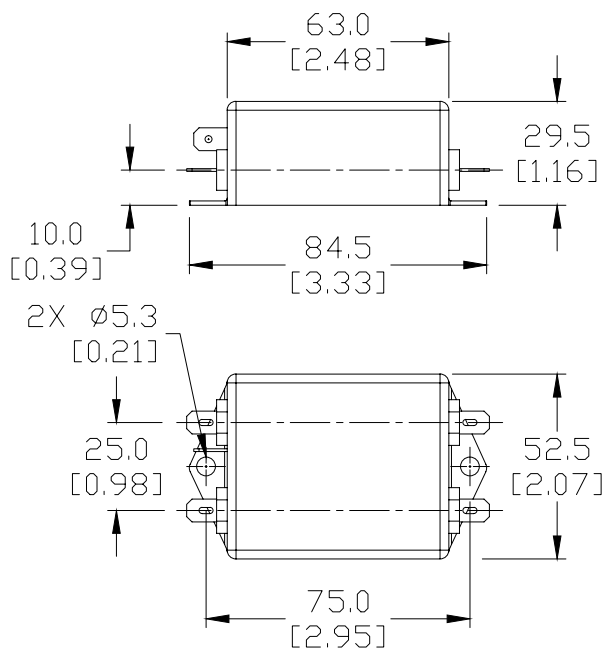

Roxburgh RES90 Series EMI Filters

Dimensions

mm [inches]

RES90F10

RES90F16

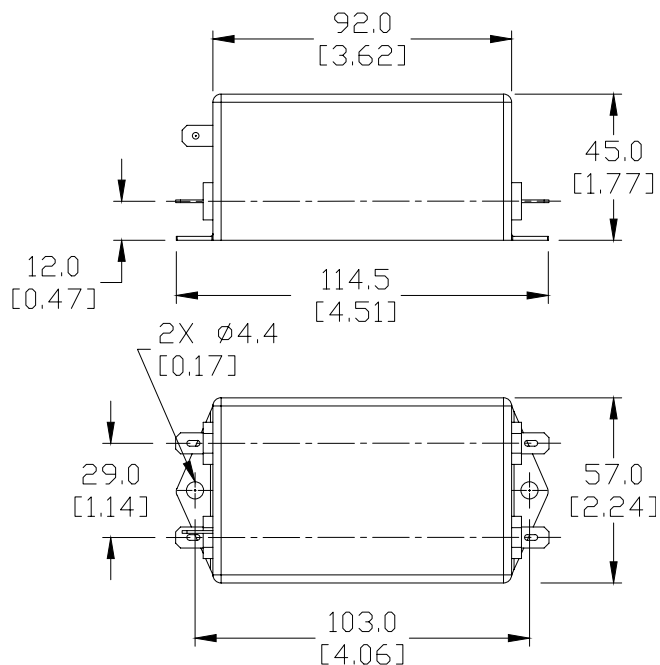

RES90S20

RES90S30

