



Pneumatic Check Valve Fittings

Union Check Valves

These high quality check valves work well in pneumatic circuits requiring free flow in one direction and no flow in the opposite direction. All valve bodies are nickel-plated brass.

Features

- Multiple porting options
- Durable brass construction
- Low cracking pressure (less than 1 psi)
- Compact in-line or port mounting styles
- Made in USA



NITRA™ Pneumatic Check Valve Fittings				
Part No.	Price	Description	Parts Per Pkg	Weight (lbs)
<u>CVU10N</u>	\$;3,a3:	NITRA pneumatic threaded fitting, check valve, nickel-plated brass body, nickel-plated brass threads, (2) #10-32 female threaded connection(s).	1	0.2
<u>CVU18N</u>	\$;3,a4:	NITRA pneumatic threaded fitting, check valve, nickel-plated brass body, nickel-plated brass threads, (2) 1/8in female NPT connection(s).	1	0.7
<u>CVF18N-M18N</u>	\$;3,a5:	NITRA pneumatic threaded fitting, check valve, nickel-plated brass body, nickel-plated brass threads, (1) 1/8in female NPT to (1) 1/8in male NPT connection(s).	1	0.7
<u>CVM18N-F18N</u>	\$;3,a6:	NITRA pneumatic threaded fitting, check valve, nickel-plated brass body, nickel-plated brass threads, (1) 1/8in male NPT to (1) 1/8in female NPT connection(s).	1	0.7



Part No. [CVU10N](#)



Part No. [CVU18N](#)



Part No. [CVF18N-M18N](#)



Part No. [CVM18N-F18N](#)

Dimensions

inches [mm]

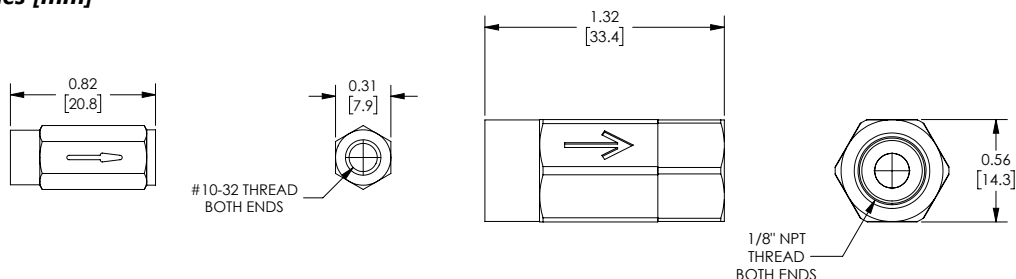

Part No. [CVU10N](#)

Part No. [CVU18N](#)

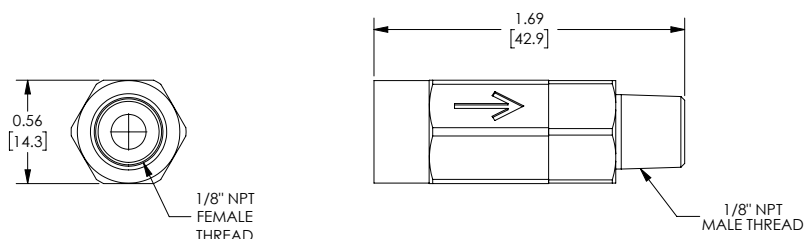

Part No. [CVF18N-M18N](#)

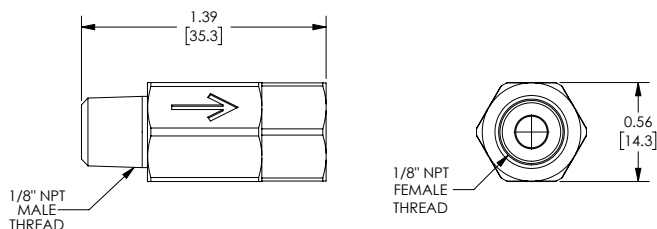

Part No. [CVM18N-F18N](#)

See our website www.AutomationDirect.com for complete Engineering drawings.