

# Hazardous Area Thermostats



011850-00

## Applications

Compact, small mechanical thermostat offering a high response accuracy, small switching difference, and a very long service life (switching cycles). This thermostat of temperature class T6 (185°F/85°C max.) is utilized for the regulation of heaters deployed in hazardous areas. High current performance allows direct control of a heater.

## Features

- For use in hazardous areas
- High switching capacity
- Compact design
- "Pre-set" temperatures
- Ready to use with strain relief
- Temperature class T6
- DIN rail mounting



## Dimensions

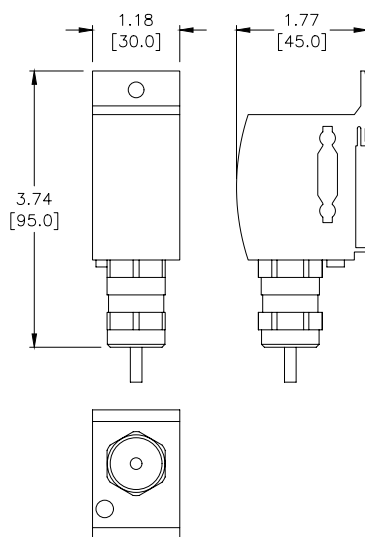

## Hazardous Area Thermostat Specifications

|   |  |
|---|--|
| <b>Temperature Class</b>  | T6   |
| <b>Ex Protection Type Ex 11 2 GD Gases</b>                        | Ex db IIC T6 Gb  |
| <b>Dusts</b>  | Ex tb IIIC T85 °C Db IP66  |
| <b>Ambient Temperature</b>  | -76 to 185°F [-60 to 85°C]   |
| <b>Sensor Element</b>   | Thermostatic bimetal   |
| <b>Service Life</b>   | > 100 000 cycles   |
| <b>Max. Switching Capacity</b>                                    | AC 250V 10A* DC 24V 1A   |
| <b>Min. Switching Capacity</b>                                    | DC 1.5V 5mA  |
| <b>Max. Inrush Current</b>  | AC 16A for 12 sec.   |
| <b>Connection</b>   | Silicone cable (halogen-free) 3 x 18 AWG (0.82 mm²), length 3ft [1m]           |
| <b>Housing</b>  | aluminum, silver anodized  |
| <b>Mounting</b>   | Clip for 35mm DIN rail, EN 60715 M5 screw mounting, optional sideways mounting |
| <b>Mounting Position</b>  | Variable   |
| <b>Operating / Storage Humidity</b>                               | max. 90 % RH (non-condensing)  |
| <b>Storage Temperature</b>  | -76 to 185°F [-60 to 85°C]   |
| <b>Weight</b>   | 0.66 lb [300 g]  |
| <b>Protection Type / Protection Class</b>                         | IP66 / I (grounded)  |
| <b>Approvals</b>  | EPS 16 ATEX 1 118 X<br>IECEx EPS 16.0054X<br>EAC, CE 0081 Ex 11 2 GD           |
| <b>Note:</b> *Currents above 4 A affect the switching difference. |  |

## Hazardous Area Thermostat

| PartNumber       | Price    | Contact Type    | Switch Temperature        | Switching Difference (Hysteresis)   |
|------------------|----------|-----------------|---------------------------|-------------------------------------|
| <b>011850-00</b> | \$010q4: | Normally Closed | 59°F ± 5°F<br>[15°C ± 3K] | 9°F ± 5°F / tolerance<br>[5°C ± 3K] |
| <b>011851-00</b> | \$010q5: | Normally Closed | 77°F ± 5°F<br>[25°C ± 3K] | 9°F ± 5°F / tolerance<br>[5°C ± 3K] |