

ZL-RTB40-1 Specifications	
Description*	40-Pole Feedthrough Connector Module
Maximum Voltage	36VAC/VDC
UL Voltage Rating**	0-30 VAC/VDC
Maximum Current per Circuit	500mA
Maximum Current Module	32A (all conductors combined including commons)
Number of Terminal Block Positions	48
Operating Temperature Range	32 to 140°F (0 to 60°C)
Terminal Block Contacts	Copper alloy, tin-lead plated
Wire Range (Rated Cross Section)**	12-24 AWG Solid or Stranded Copper Conductor (2.5 mm ²)
Wire Strip Length	0.24-0.27 in (6-7 mm)
Screw Torque	4.4 in-lbs (0.5 Nm)
Connector Type	3M 34000 Series IDC Connector, strain relief is required to latch header. Example: Socket 3417-7640, Strain relief 3448-3040
Cable/Wire Clearance	0.5 in (12.7 mm) Required
Mounting Restrictions	None
Weight	206g (7.3 oz)
Approvals	UL508 File E139594, Canada & USA CE (EN61131-2*)

*Connecting cables are for internal wiring only.

**Use Class 2 power supply. Use conductors rated 60°/75°C.

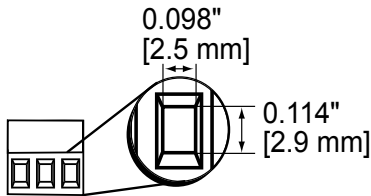
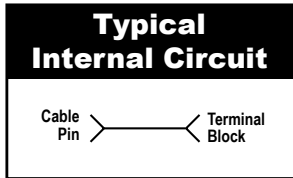

Terminal Block Insertion Point Opening Dimension

ZL-RTB40-1 Pinouts																
TOP ROW																
P1 Connector Pin	25	5	30	10	35	15	40	20								
TB1 Terminal	A1, A2	A3, A4	A5, A6	A7, A8	A9, A10	A11, A12	A13, A14	A15, A16								
MIDDLE ROW																
P1 Connector Pin	1	2	3	4	6	7	8	9	11	12	13	14	16	17	18	19
TB1 Terminal	B1	B2	B3	B4	B5	B6	B7	B8	B9	B10	B11	B12	B13	B14	B15	B16
BOTTOM ROW																
P1 Connector Pin	21	22	23	24	26	27	28	29	31	32	33	34	36	37	38	39
TB1 Terminal	C1	C2	C3	C4	C5	C6	C7	C8	C9	C10	C11	C12	C13	C14	C15	C16

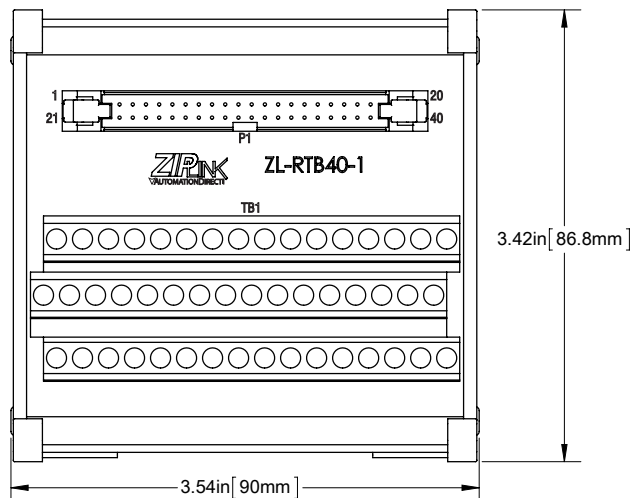
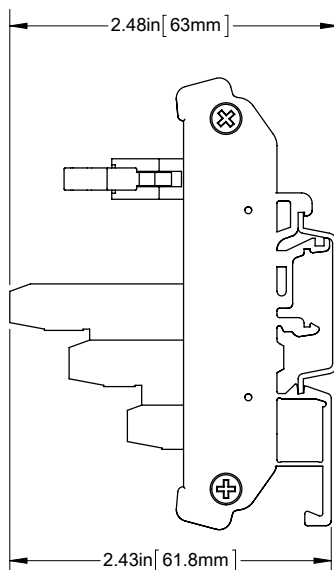

Feedthrough Connector Module Installation Instructions

Apply ZIPLink Labels

(Supplied with ZIPLink cables)

1

Find correct label and remove from sheet

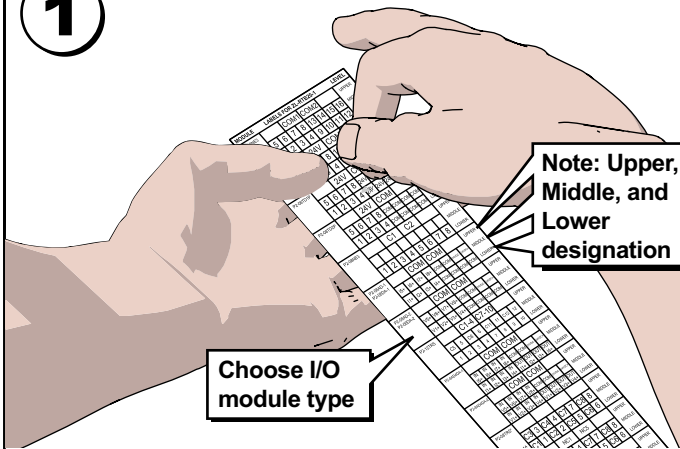

2

Apply label to designated position

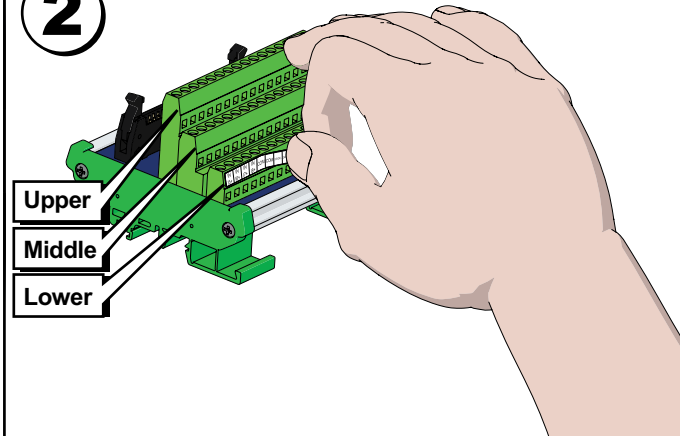

DIN Rail Installation and Removal

To install ZIPLink module, insert upper tab into DIN rail.

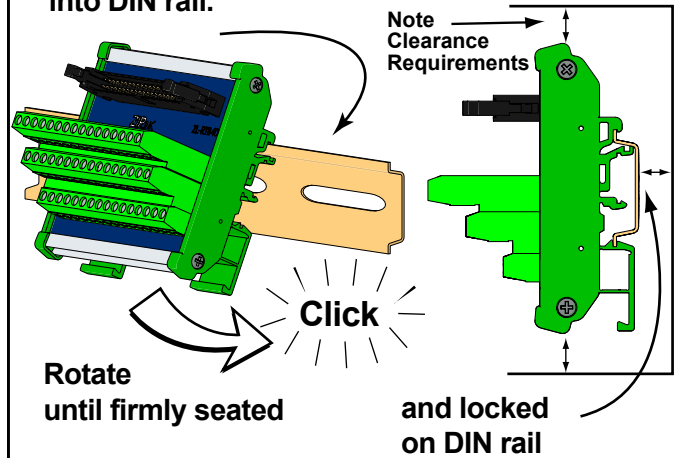

To remove ZIPLink module, insert screwdriver between Tab 1 and module.

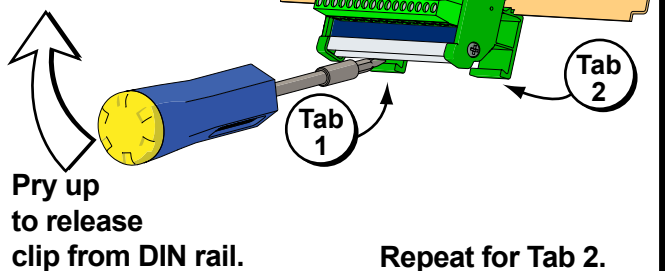

WARNING: To minimize the risk of potential safety problems, you should follow all applicable local and national codes that regulate the installation and operation of your equipment. These codes vary from area to area and it is your responsibility to determine which codes should be followed, and to verify that the equipment, installation, and operation are in compliance with the latest revision of these codes.

Equipment damage or serious injury to personnel can result from the failure to follow all applicable codes and standards. We do not guarantee the products described in this publication are suitable for your particular application, nor do we assume any responsibility for your product design, installation, or operation.

If you have any questions concerning the installation or operation of this equipment, or if you need additional information, please call Technical Support at 770-844-4200.

This publication is based on information that was available at the time it was printed. At AutomationDirect.com® we constantly strive to improve our products and services, so we reserve the right to make changes to the products and/or publications at any time without notice and without any obligation. This publication may also discuss features that may not be available in certain revisions of the product.

ZIPLink Cable Removal

1

Push tab on raised tip and hold.

2

Pull connector from socket.

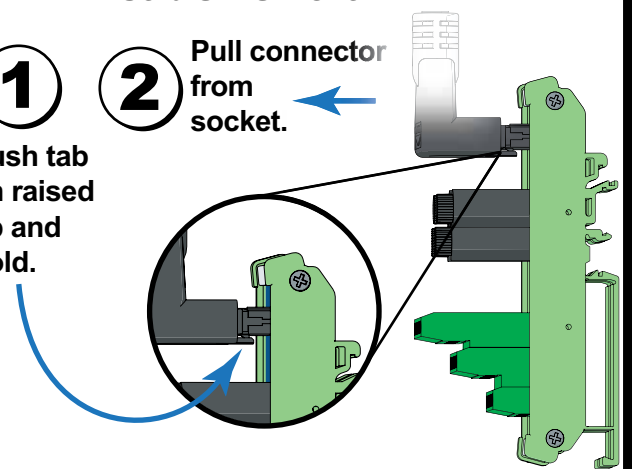

Part Number	Revision	Date
ZL-RTB40-1-DS	2nd Ed., Rev. A	10/11/2016