

ZL-RTB20-1 Specifications	
Description*	20-Pole Feedthrough Connector Module
Maximum Voltage	300VAC/VDC
UL Voltage Rating**	0-250 VAC/VDC
Maximum Current per Circuit	2A
Maximum Current per Common Circuit †	4A
Maximum Current	40A (all conductors combined including commons)
Number of Terminal Block Positions	24
Operating Temperature Range	32 to 140°F (0 to 60°C)
Terminal Block Contacts	Copper alloy, tin-lead plated
Wire Range (Rated Cross Section)**	12-24 AWG Solid or Stranded Copper Conductor (2.5 mm ²)
Wire Strip Length	0.24-0.27 in (6-7mm)
Screw Torque	4.4 in-lbs (0.5 Nm)
Connector Type	Molex Micro-Fit 3.0, 24 pin connector Example: Receptacle 43020-2400 Pins 43031 Series, Male
Cable/Wire Clearance	0.5 in (12.7 mm) Required
Mounting Restrictions	None
Weight	114g (4.0 oz)
Approvals	UL508 File E139594, Canada & USA CE (EN61131-2)

† The 4 common circuits are at terminal block positions (A1, A2), (A3, A4), (A5, A6) and (A7, A8). Each common circuit has 2 cable wires per terminal.

*Connecting cables are for internal wiring only.

**Use class 2 power supply. Use conductors rated 60°/75°C

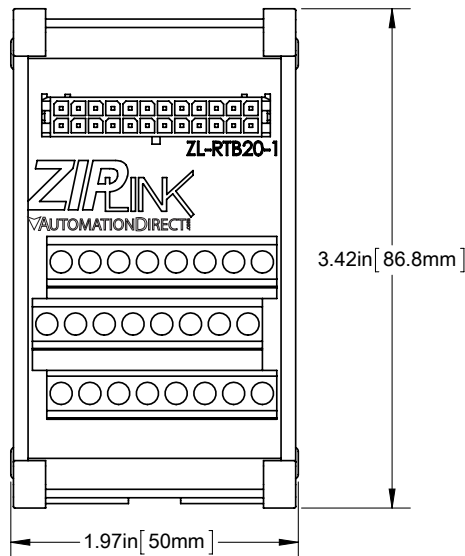
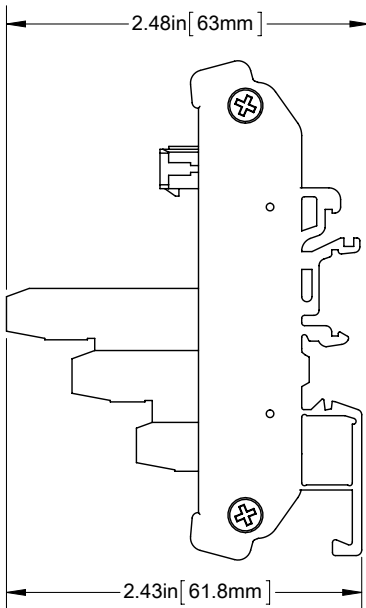

ZL-RTB20-1 Pinouts		
	P1 Connector Pin	P2 Terminal
TOP ROW	1,13	A1,A2
	2,14	A3, A4
	7,19	A5, A6
	8,20	A7,A8
MIDDLE ROW	15	B1
	16	B2
	17	B3
	18	B4
	21	B5
	22	B6
	23	B7
	24	B8
BOTTOM ROW	3	C1
	4	C2
	5	C3
	6	C4
	9	C5
	10	C6
	11	C7
	12	C8

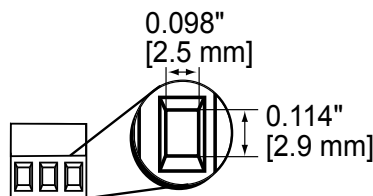
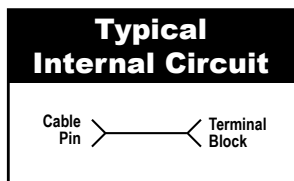

Terminal Block Insertion Point Opening Dimension

Feedthrough Connector Module Installation Instructions

Apply ZIPLink Labels

(Supplied with ZIPLink cables)

- 1 Find correct label and remove from sheet

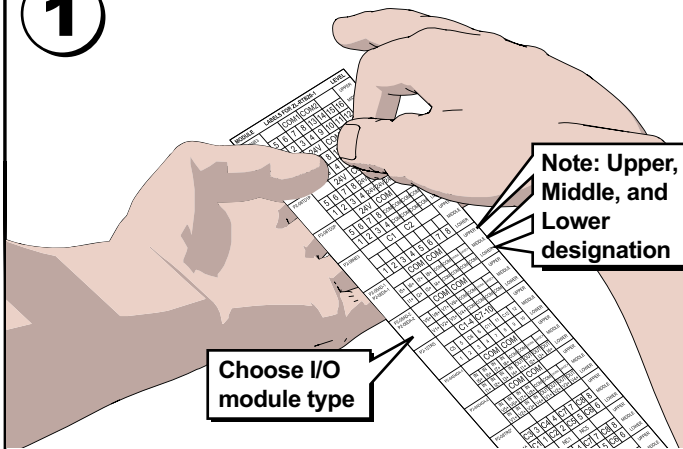

- 2 Apply label to designated position

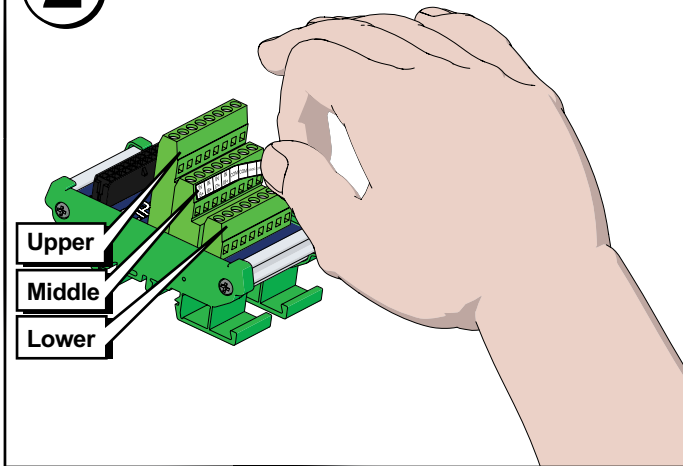

DIN Rail Installation and Removal

To install ZIPLink module, insert upper tab into DIN rail.

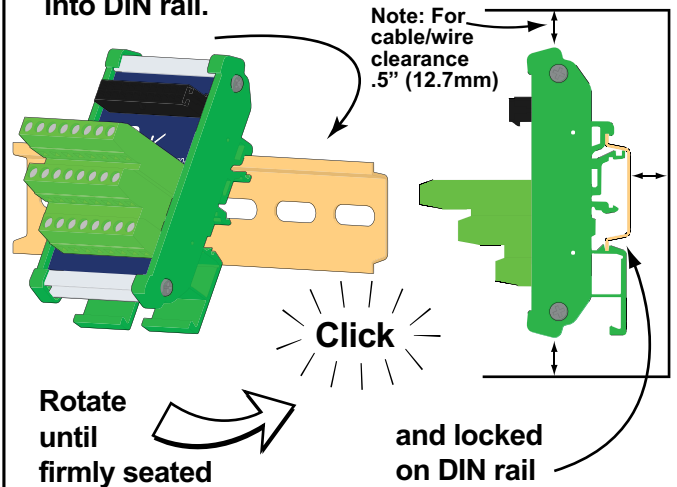

Rotate until firmly seated

To remove ZIPLink module, insert screwdriver between Tab 1 and module.

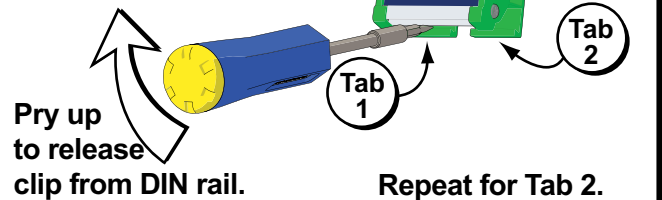

WARNING: To minimize the risk of potential safety problems, you should follow all applicable local and national codes that regulate the installation and operation of your equipment. These codes vary from area to area and it is your responsibility to determine which codes should be followed, and to verify that the equipment, installation, and operation are in compliance with the latest revision of these codes.

Equipment damage or serious injury to personnel can result from the failure to follow all applicable codes and standards. We do not guarantee the products described in this publication are suitable for your particular application, nor do we assume any responsibility for your product design, installation, or operation.

If you have any questions concerning the installation or operation of this equipment, or if you need additional information, please call Technical Support at 770-844-4200.

This publication is based on information that was available at the time it was printed. At AutomationDirect.com® we constantly strive to improve our products and services, so we reserve the right to make changes to the products and/or publications at any time without notice and without any obligation. This publication may also discuss features that may not be available in certain revisions of the product.

ZIPLink Cable Removal

- 1
- 2 Pull connector from socket.

Push tab on raised tip and hold.

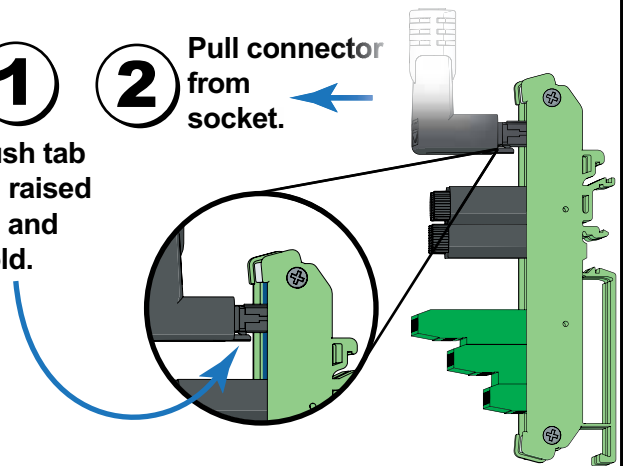

Part Number	Revision	Date
ZL-RTB20-1-DS	1st Ed.	8/29/2016