



To download fullsize color .pdf Ziplink Wiring Diagrams go to [www.Automationdirect.com](http://www.Automationdirect.com) website

**ZIPLINK™**  
Automationdirect.com  
800-633-0405

## Relay Connector Module ZL-RS1-120

### Mounting Orientation:

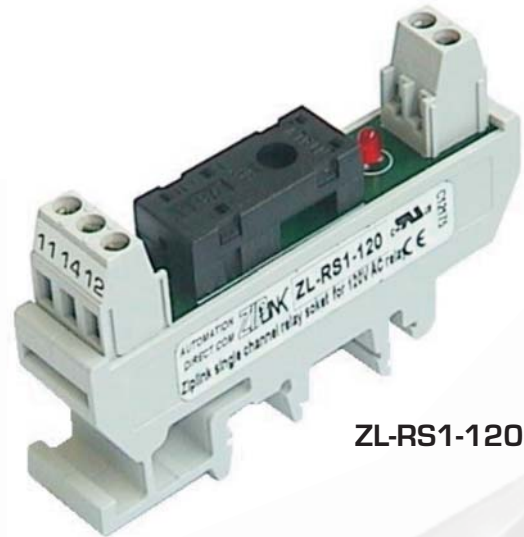
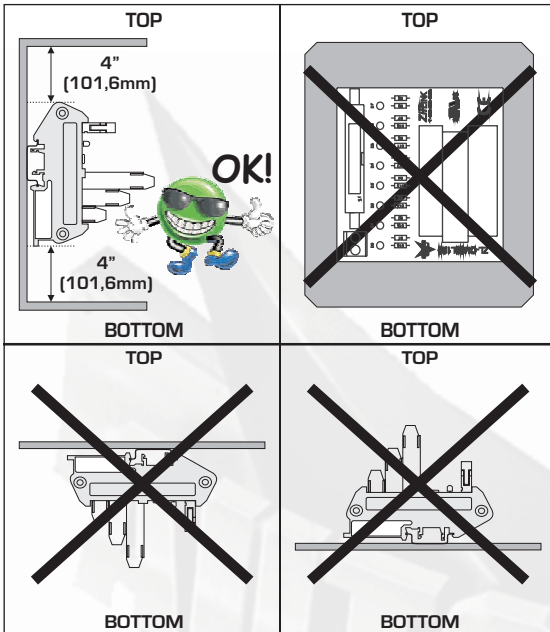

**ZL-RS1-120**

**NOTE: USE FINDER 10A, 120VAC RELAY TYPE 40.31, OR OTHER BRAND WITH EQUIVALENT UL RATINGS (NLDX2).**

**WARNING : WIRE ONLY ACCORDING TO WIRING DIAGRAMS SHOWN BELOW TO AVOID CAUSING DAMAGE TO ELECTRICAL EQUIPMENT OR THE RELAY MODULE.**

	Part#	Pcs/Pkg	Price/Pkg
<b>AC Relay Module</b>	<b>ZL-RS1-120</b>	<b>1</b>	
<b>Description</b>	Ziplink single channel relay socket for 120VAC relays		
<b>Approvals</b>	UL CSA CE		
<b>Input Voltage</b>	120VAC		
<b>Current per Channel</b>	With capacitor 50mA / Without capacitor 15mA		
<b>Coil Supply Voltage</b>	120VAC +-10%		
<b>OFF to ON response</b>	15ms		
<b>ON to OFF response</b>	10ms		
<b>Connection</b>	Terminal Block 0,10" (2,5mm)		
<b>Contact Type</b>	1 Form C		
<b>Mechanical Life, Contacts</b>	2X 10 <sup>6</sup>		
<b>Maximum Operating Voltage</b>	400VAC 125VDC		
<b>Maximum Current</b>	10A 230VAC 25°C		
<b>Wire Range (Rated Cross Section)</b>	14-22 AWG (0.2-2.5mm <sup>2</sup> ) 75°C min.		
<b>Maximum Power, Inductive</b>	AC 1500VA DC 150W		
<b>Maximum Power, Resistive</b>	AC 2500VA DC 300W		
<b>Minimum Load</b>	100mA 5VDC		
<b>Isolation, Coil to Contacts</b>	2,5K VAC / 60Sec		
<b>Isolation, Channel to Channel</b>	1KVAC / 60sec		
<b>LED Indicator Status, Relay</b>	Red (On: relay on. Off: relay off)		
<b>Operating Temperature</b>	-10°C to +40°C		
<b>Storage Temperature</b>	-10°C to +50°C		
<b>Protection</b>	IPO0		
<b>Mounting</b>	DIN Rail EN 50.022  EN50.035		
<b>Dimensions</b>	0,67"(17mm) x 3,00" (76,4mm) x 2,67"(68mm) (With Relay)		

## Wiring Diagram: For PLC Modules with Electromechanical Relay Outputs

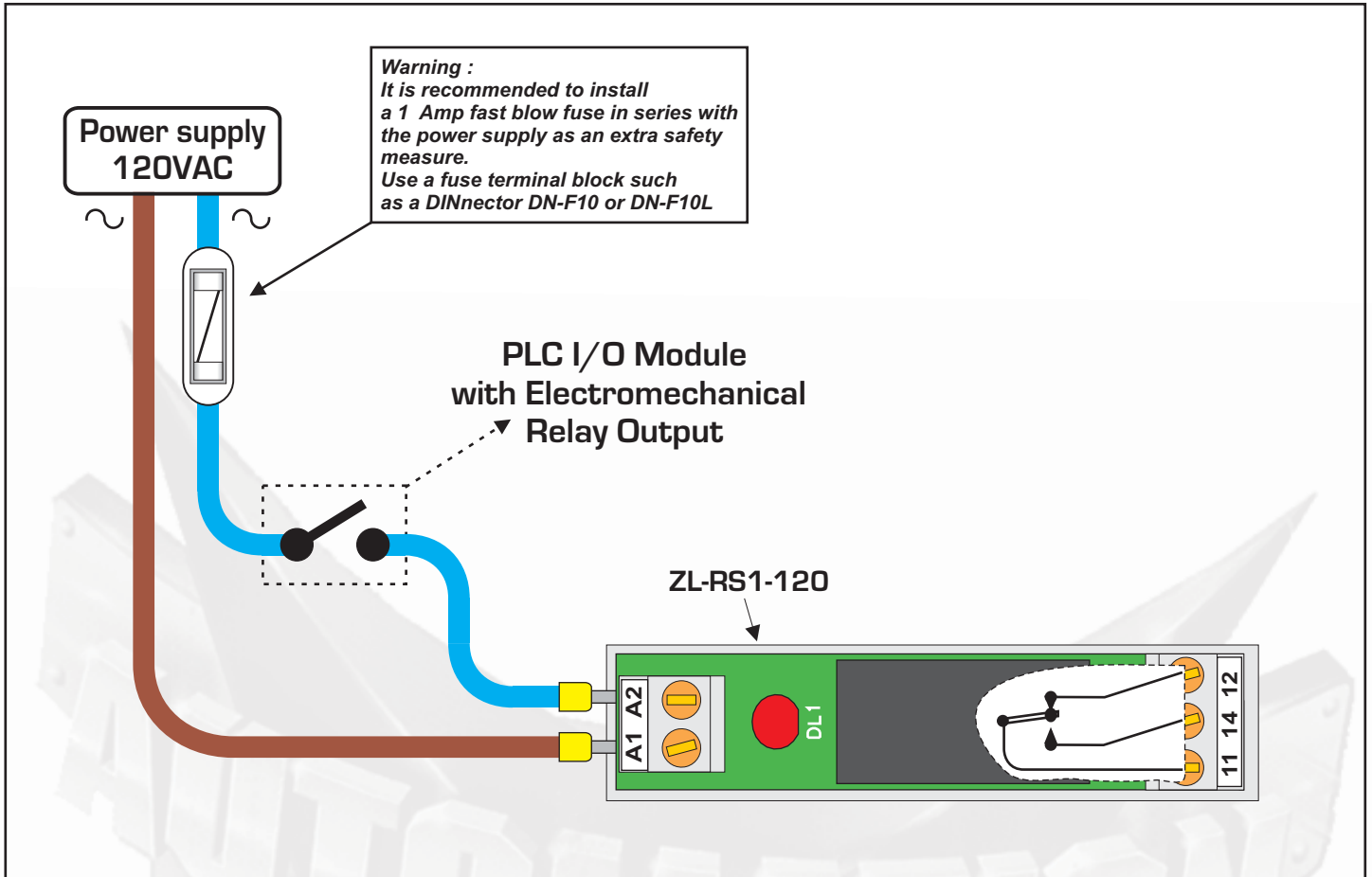

## Wiring Diagram: For PLC Modules with SSR (Triac) relay outputs

