



To download fullsize color .pdf Ziplink Wiring Diagrams go to www.Automationdirect.com website

ZIPLINK™
Automationdirect.com
800-633-0405

Relay Connector Module ZL-RS4-120

Mounting Orientation:

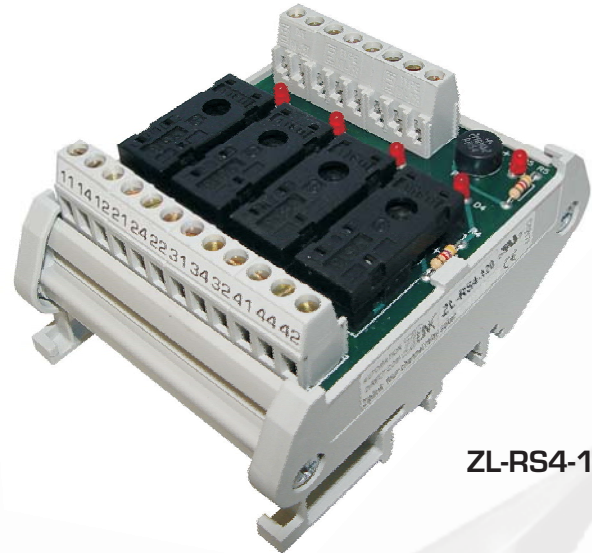
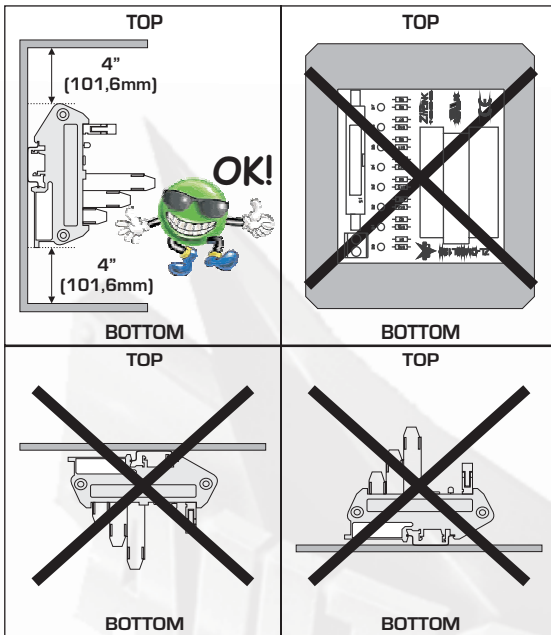

ZL-RS4-120

NOTE: USE FINDER 10A, 120VAC RELAY TYPE 40.31, OR OTHER BRAND WITH EQUIVALENT UL RATINGS (NLDX2).

WARNING : WIRE ONLY ACCORDING TO WIRING DIAGRAMS SHOWN BELOW TO AVOID CAUSING DAMAGE TO ELECTRICAL EQUIPMENT OR THE RELAY MODULE.

	Part#	Pcs/Pkg	Price/Pkg
AC Relay Module	ZL-RS4-120	1	
Description	Ziplink four channel, 120VAC relay socket		
Approvals	UL CSA CE		
Input Voltage	120VAC		
Current per Channel	With capacitor 50mA / Without capacitor 15mA		
Coil Supply Voltage	120VAC +-10%		
OFF to ON response	15ms		
ON to OFF response	10ms		
Connection	Terminal Block 0,10" (2,5mm)		
Contact type	1 Form C		
Mechanical Life, Contacts	2X 10 ⁶		
Maximum Operating Voltage	400VAC 125VDC		
Maximum Current	10A 230 VAC (25°C)		
Wire Range (Rated Cross Section)	14-22 AWG (0.2-2.5mm ²) 75°C min.		
Maximum Power, Inductive	AC 1500VA DC 150W		
Maximum Power, Resistive	AC 2500VA DC 300W		
Minimum Load	100mA 5VDC		
Isolation, Coil to Contacts	2,5K VAC / 60Sec		
Isolation, Channel to Channel	1KVAC / 60sec		
LED Indicator Status, Relay	Red (On: Relay on; Off: Relay off)		
Operation Temperature	-10°C to +40°C		
Storage Temperature	-10°C to +50°C		
Protection	IP00		
Mounting	DIN Rail EN 50.022 EN50.035		
Dimensions	3,03"(77mm) x 3,66" (93mm) x 2,87"(73mm) (With Relay)		

Wiring Diagram: For PLC Modules with Electromechanical Relay Outputs

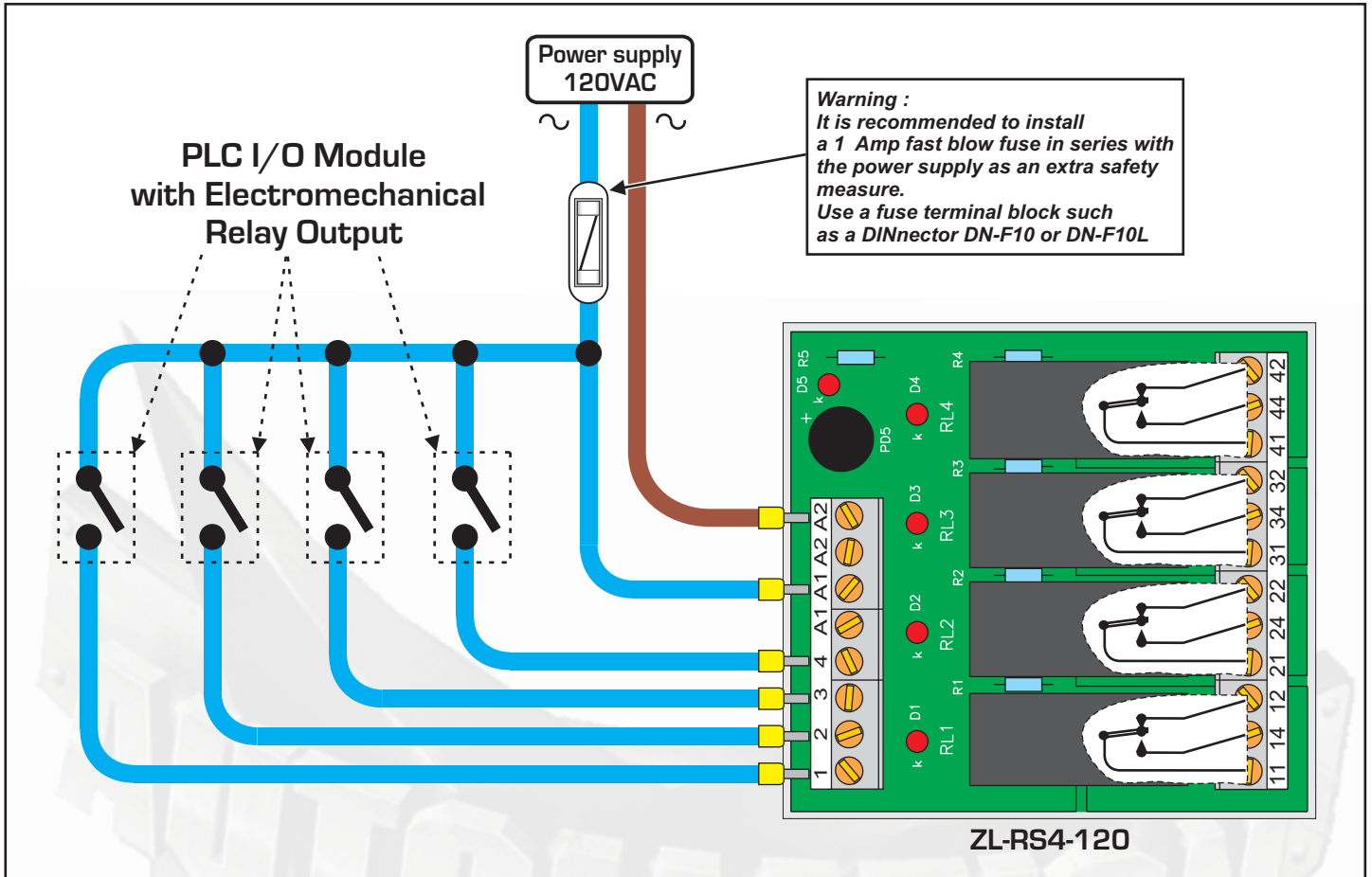

Wiring Diagram: For PLC Modules with SSR (Triac) relay outputs

