



To download fullsize color .pdf Ziplink Wiring Diagrams go to www.Automationdirect.com website

ZIPLINK™
Automationdirect.com
800-633-0405

Relay Connector Module ZL-RS1-24

Mounting Orientation:

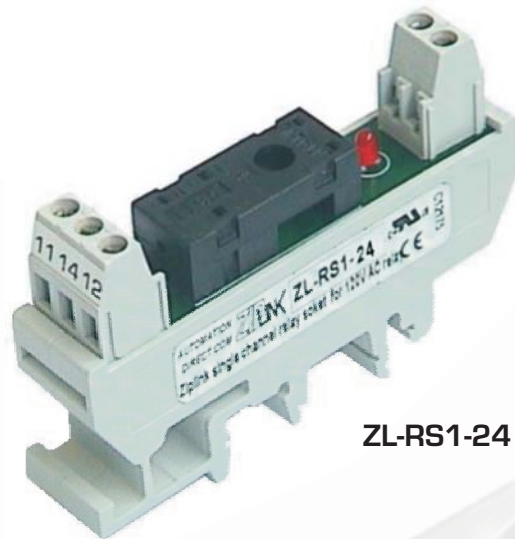
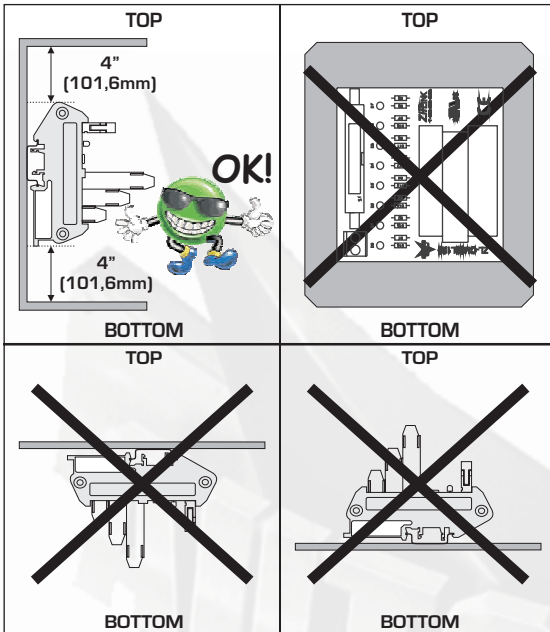

ZL-RS1-24

NOTE: USE FINDER 10A, 24VDC RELAY TYPE 40.31, OR OTHER BRAND WITH EQUIVALENT UL RATINGS (NLDX2).

WARNING : WIRE ONLY ACCORDING TO WIRING DIAGRAMS SHOWN BELOW TO AVOID CAUSING DAMAGE TO ELECTRICAL EQUIPMENT OR THE RELAY MODULE.

	Part#	Pcs/Pkg	Price/Pkg
DC Relay Module	ZL-RS1-24	1	
Description	Ziplink single channel relay socket for 24VDC relays		
Approvals	UL CSA CE		
Input Voltage	24VDC		
Current per Channel	25mA +- 5%		
Coil Supply Voltage	24VDC +-5%		
OFF to ON response	15ms		
ON to OFF response	10ms		
Connection	Terminal Block 0,10" (2,5mm)		
Contact Type	1 Form C		
Mechanical Life, Contacts	2X10 ⁶		
Maximum Operating Voltage	400VAC 125VDC		
Maximum Current	10A 230VAC 25°C		
Wire Range (Rated Cross Section)	14-22 AWG (0.2-2.5mm ²) 75°C min.		
Maximum Power, Inductive	AC 1500VA DC 150W		
Maximum Power, Resistive	AC 2500VA DC 300W		
Minimum Load	100mA 5V DC		
Isolation, Coil to Contacts	2,5K VAC / 60Sec		
Isolation, Channel to Channel	1KVAC / 60sec		
LED Indicator Status, Relay	Red (On: relay on. Off: relay off)		
Operating Temperature	-10°C to +40°C		
Storage Temperature	-10°C to +50°C		
Protection	IPO0		
Mounting	DIN Rail EN 50.022 EN50.035		
Dimensions	0,67"(17mm) x 3,00" (76,4mm) x 2,67"(68mm) (With Relay)		

Wiring Diagram: Sourcing (Positive Logic) PLC I/O Modules

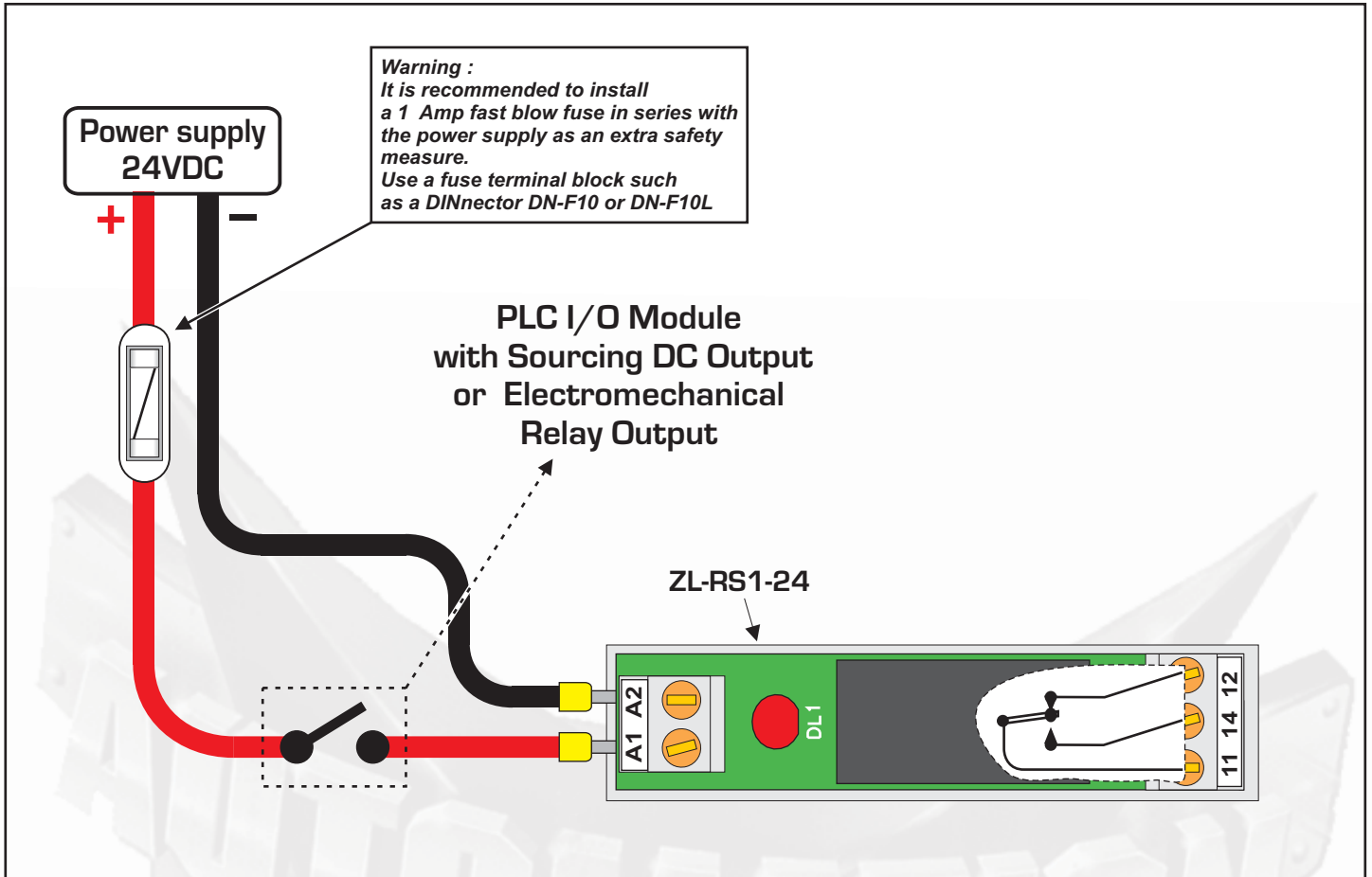

Wiring Diagram: Sinking (Negative Logic) PLC I/O Modules

