

- D** Anschluss **ausschließlich** durch ausgebildete Elektro-Fachkräfte.
- GB** Electrical connection is to be made by trained electrical specialists **only**.
- F** Le branchement doit **uniquement** être effectué par des professionnels.
- I** Il collegamento deve essere eseguito **solo** da elettricisti specializzati.
- E** La conexión **sólo** debe ser realizada por electricistas debidamente formados.
- PT** A ligação deve ser feita **exclusivamente** por profissional elétrico especializado.
- NL** De aansluiting mag **enkel** gebeuren door erkende vakmensen.
- CZ** Připojení smí **provádět** pouze kvalifikovaný personál.
- PL** Podłączenie **wyłącznie** przez specjalistów-elektryków.
- FI** Liittäminen kuuluu **ainoastaan** koulutettujen sähköalan ammattilaisten tehtäviin.
- RUS** Подключение проводится только специалистом-электриком.
- TR** Bağlantı **sadece** eğitimli elektrik teknisyenleri tarafından yapılmalıdır.
- CN** 布线需由专业电工执行

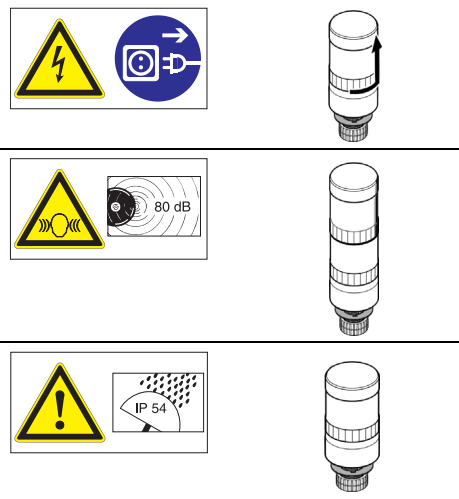

845 000 00	12 – 240 V=
845 010 00	12 – 240 V=
846 x00 00	12 – 240 V=
848 x10 75	24 V~, <25 mA
848 x10 67	115 V~, <25 mA
848 x10 68	230 V~, <25 mA
848 x20 55	24 V=, 45 mA
848 x00 55	24 V=, 45 mA
848 x00 67	115 V~, 25 mA
848 x00 68	230 V~, 25 mA
849 000 75	80 dB, 24 V=, max. 25 mA
849 000 77	80 dB, 115 V~, max. 25 mA
849 000 68	80 dB, 230 V~, max. 25 mA
	BA 15 d
956 x00 75	24 V=, 45 mA
956 x00 67	115 V~, 15 mA
956 x00 68	230 V~, 15 mA
	BA 15 d, < 42 mm
955 840 34	12 V, 5 W
955 840 35	24 V, 5 W
955 840 38	230 V, 5 W
955 840 57	115 V, 5 W

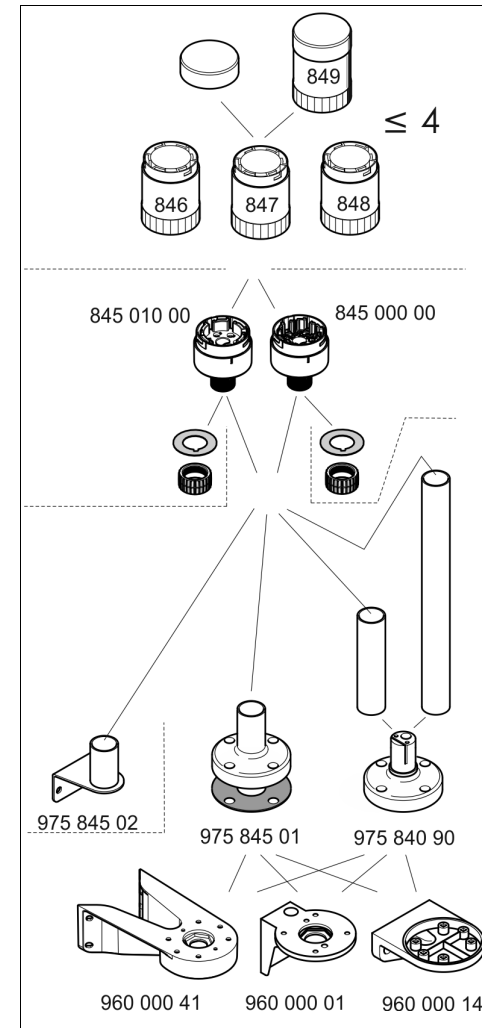



- 1**
- 1a - 845 000 00 / 845 010 00
 - 1b - 975 845 01 / 975 840 90
 - 1c - 975 845 01, ..., + 960 000 01
 - 1d - 975 845 02
 - 1e - 975 845 01, ..., + 960 000 41

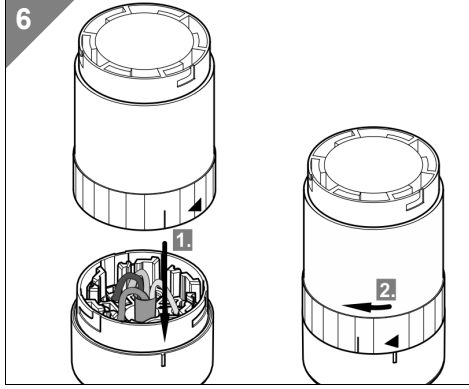
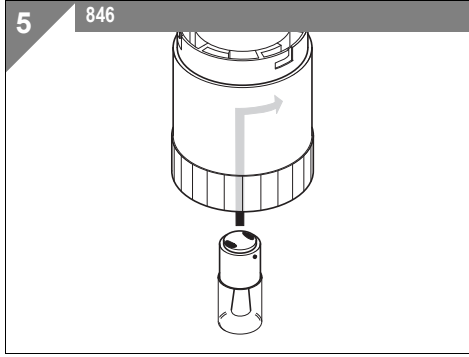
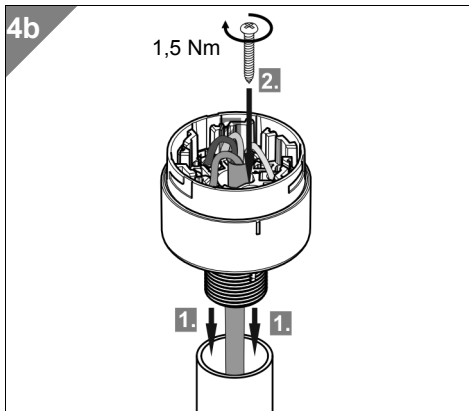
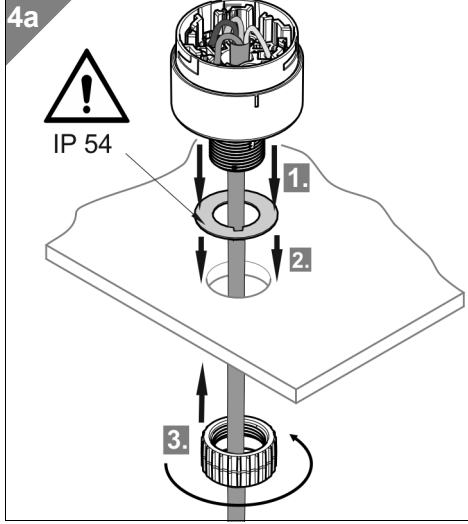
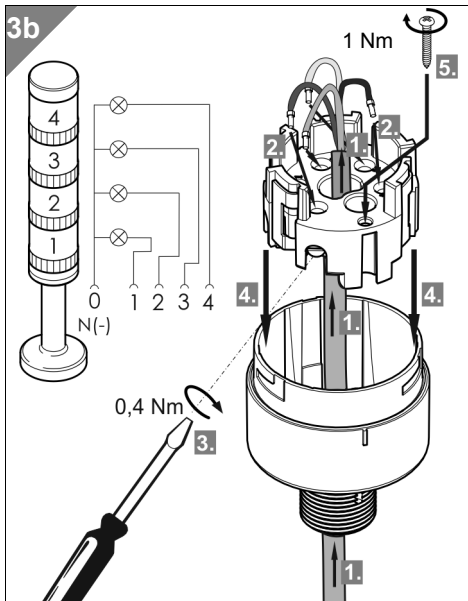
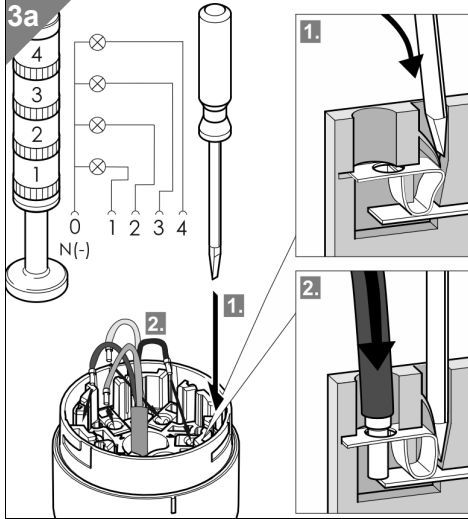
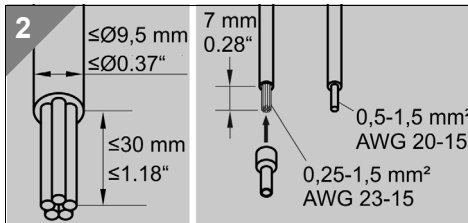
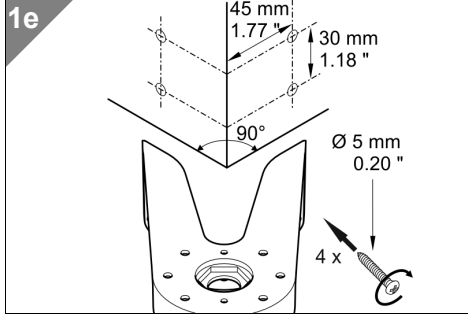
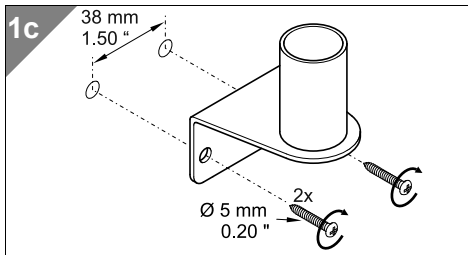
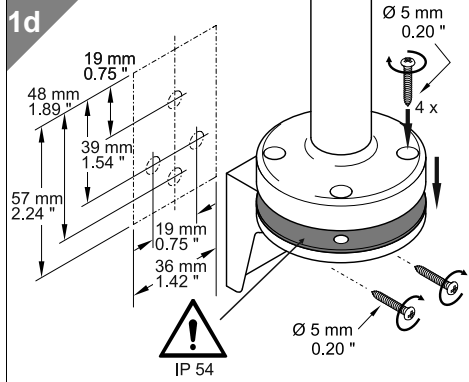
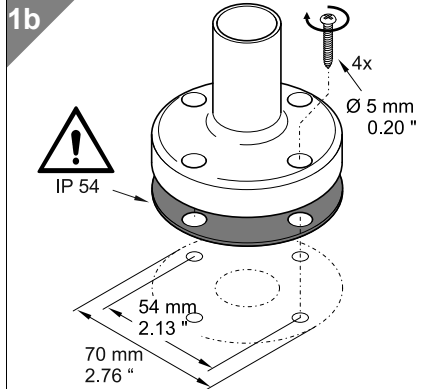
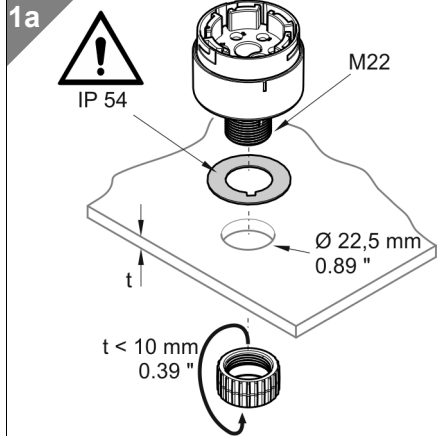

310.845.005.0714

© D

WERMA
SIGNALTECHNIK