

- Ⓓ Anschluss **ausschließlich** durch ausgebildete Elektro-Fachkräfte.
- ⒼⒷ Electrical connection is to be made by trained electrical specialists **only**.
- Ⓕ Le branchement doit **uniquement** être effectué par des professionnels.
- Ⓜ Il collegamento deve essere eseguito **solo** da elettricisti specializzati.
- Ⓔ La conexión **sólo** debe ser realizada por electricistas debidamente formados.
- Ⓟ A ligação deve ser feita **exclusivamente** por profissional eléctrico especializado.
- ⒸⓏ Připojení smí **provádět** pouze kvalifikovaný personál.
- Ⓟ Podłączenie **wyłącznie** przez specjalistów-elektryków.
- Ⓕ Liittäminen kuuluu **ainoastaan** koulutettujen sähköalan ammattilaisten tehtäviin.
- ⓇⓊⓈ Подключение проводится только специалистом-электриком.
- ⓉⓇ Bağlantı **sadece** eğitimli elektrik teknisyenleri tarafından yapılmalıdır.
- ⒸⓃ 布线需由专业电工执行

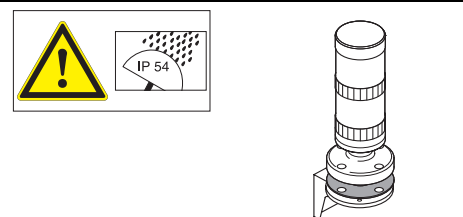

846 x00 00	12 – 240 V \approx
848 x10 75	24 V \approx , <25 mA
848 x10 67	115 V \sim , <25 mA
848 x10 68	230 V \sim , <25 mA
848 x00 55	24 V \approx , 45 mA
848 x00 67	115 V \sim , 25 mA
848 x00 68	230 V \sim , 25 mA
849 000 75	80 dB, 24 V \approx , max. 25 mA
849 000 77	80 dB, 115 V \sim , max. 25 mA
849 000 68	80 dB, 230 V \sim , max. 25 mA
BA 15 d	
956 x00 75	24 V \approx , 45 mA
956 x00 67	115 V \sim , 15 mA
956 x00 68	230 V \sim , 15 mA
BA 15 d, < 42 mm	
955 840 34	12 V, 5 W
955 840 35	24 V, 5 W
955 840 37	115 V, 7 W
955 840 38	230 V, 5 W
955 840 57	115 V, 5 W

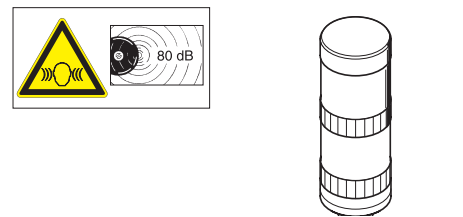

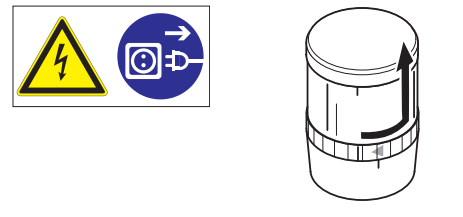
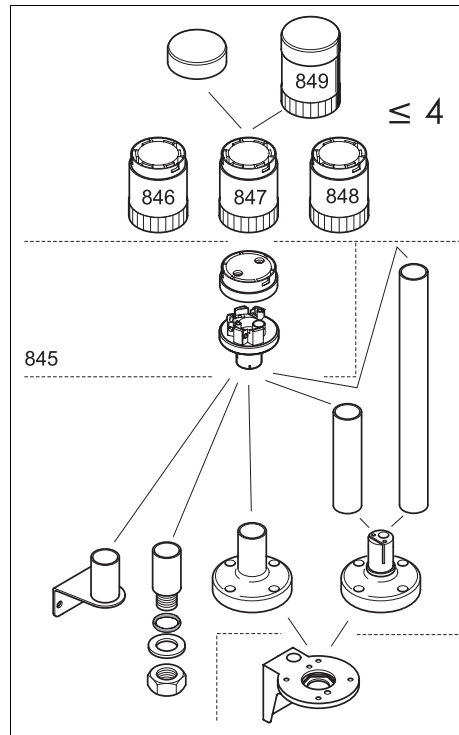

- 1**
 1a - 975 845 01 + 975 840 90
 1b - 975 845 03
 1c - 975 845 02
 1d - 975 845 01, ..., + 960 000 01

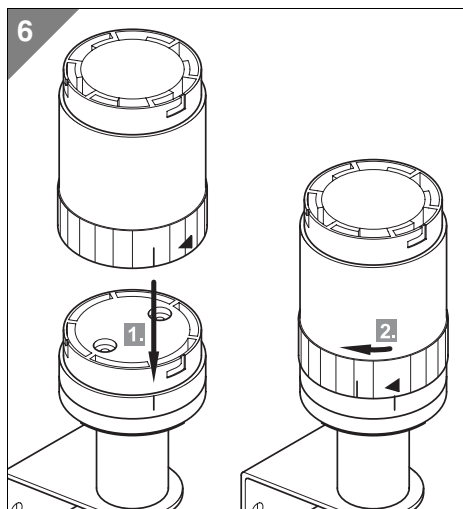
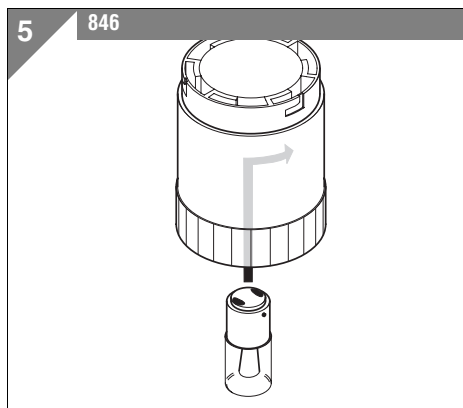
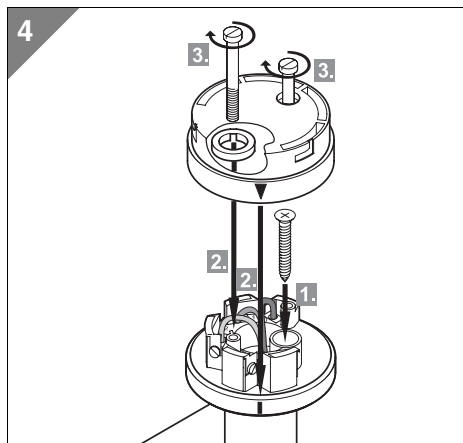
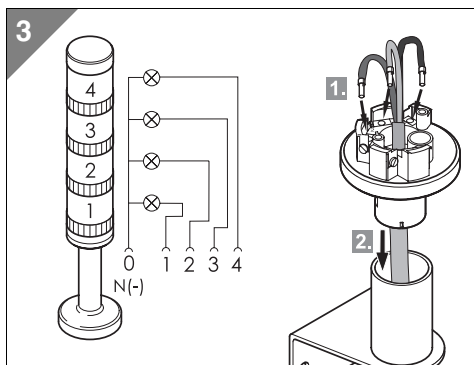
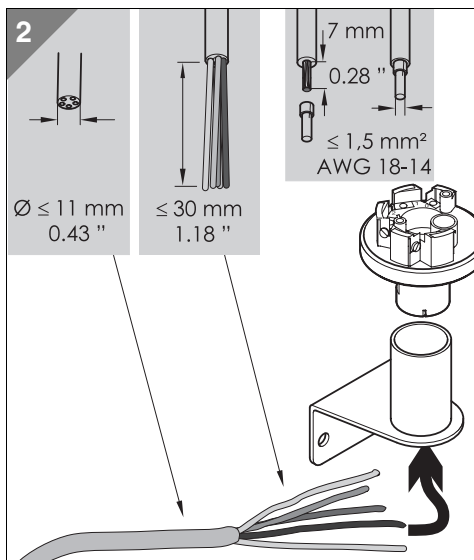
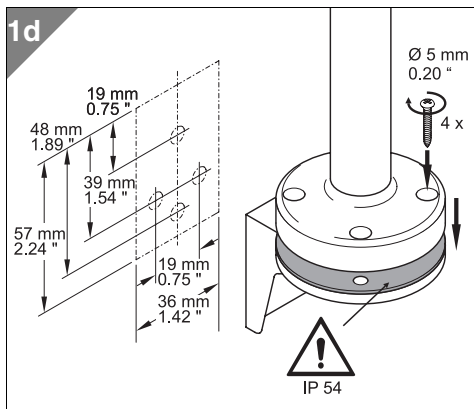
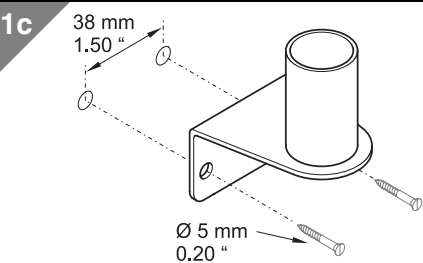
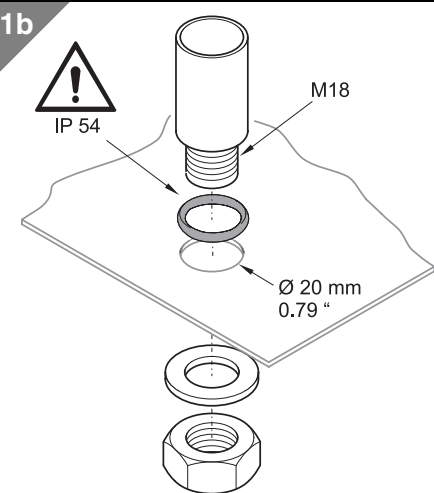
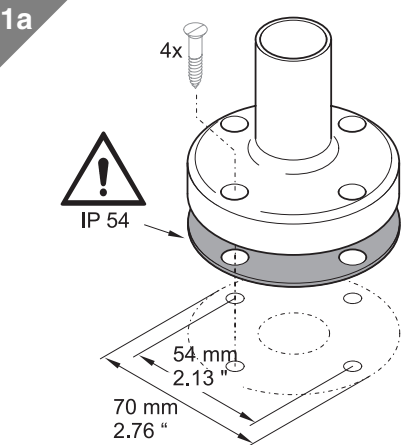

310.845.001.0807

© D

WERMA
 SIGNALTECHNIK