

- 8 - 60 N.m
- 20 - 100 N.m
- 40 - 200 N.m
- 60 - 300 N.m
- 60 - 330 N.m
- 80 - 400 N.m

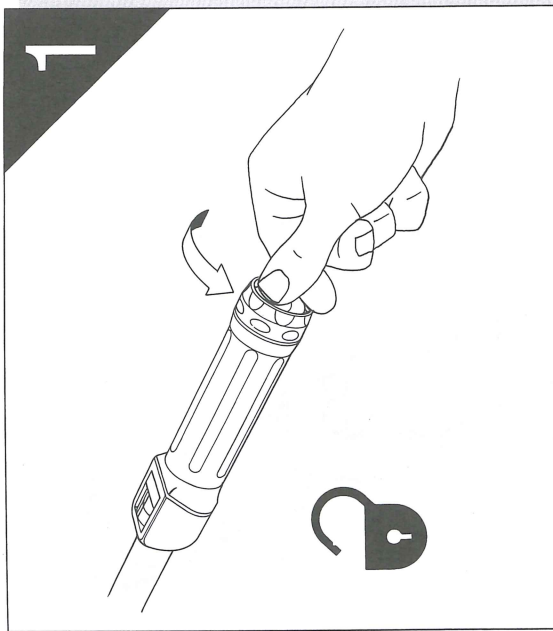

1
 Unlock • Déverrouiller la molette • Entsichern
 Sbloccare • Desbloquear

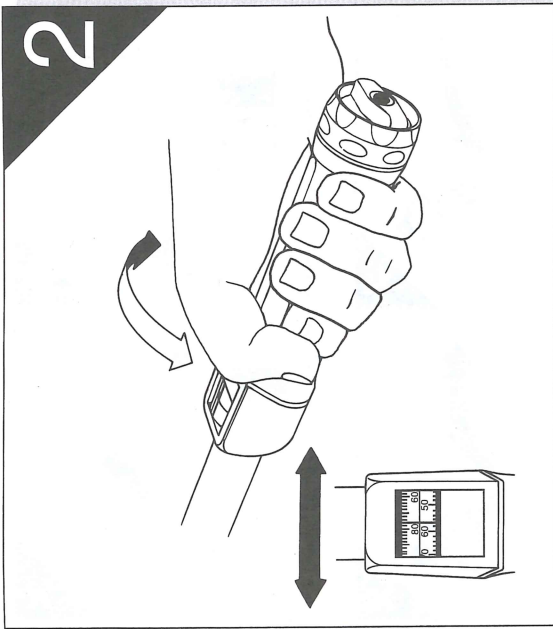

2
 Adjust • Régler • Einstellen
 Regolare • Ajustar

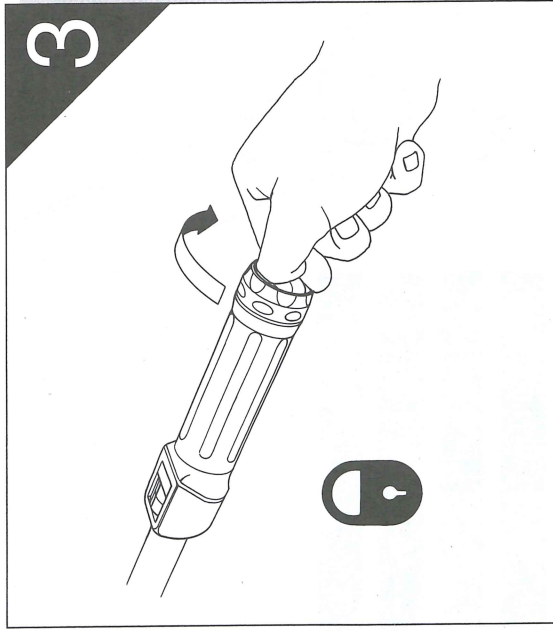

3
 Lock • Verrouiller la molette • Sichern
 Bloccare • Bloquear

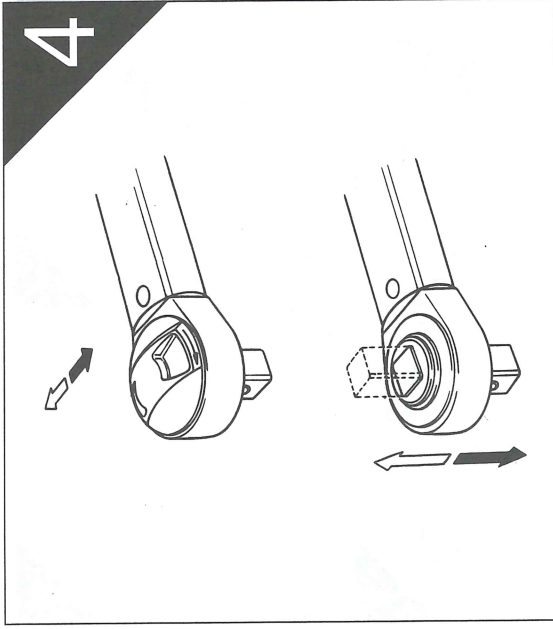

4
 Set ratchet direction • Régler la direction de serrage • Wahl der
 Arbeitsrichtung • Fissare direzione cricchetto • Seleccionar

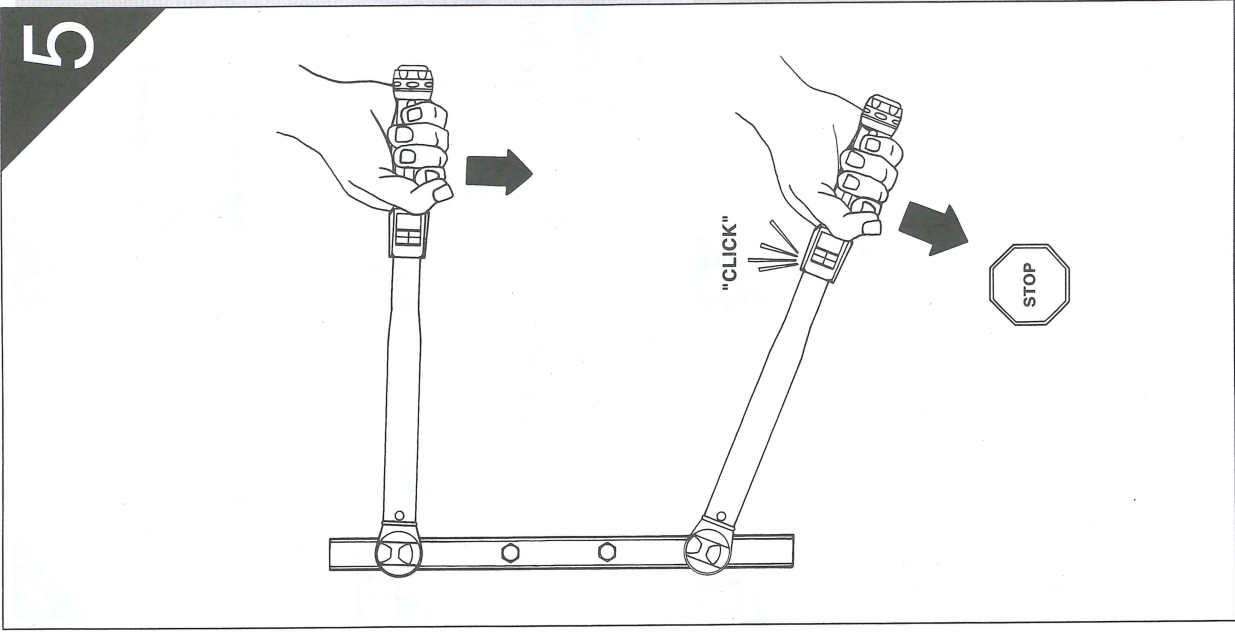

5
 Apply torque • Serrer jusqu'au déclenchement du couple
 Drehmoment Anwendung • Applicare la coppia
 Aplicar el par de apriete