

TK120.705 Wall Mounted Module

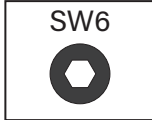

The product can rotate to $\pm 90^\circ$ angles as follows when first out of the box
Ürün kutudan ilk çıktığında aşağıdaki gibi $\pm 90^\circ$ açılara dönebilir

1

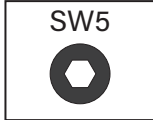
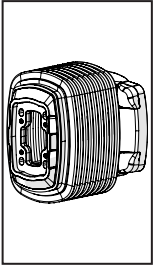
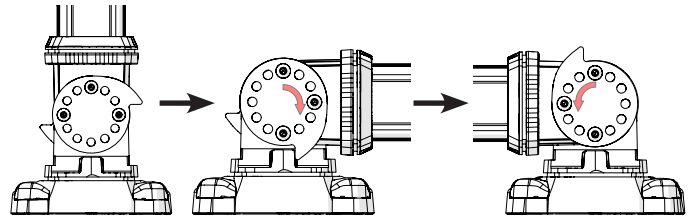

Angle can be set with M8x12 bolts (30° between two holes)
M8x12 civatalar ile açı ayarı yapılabilir (iki delik arası 30°)

2

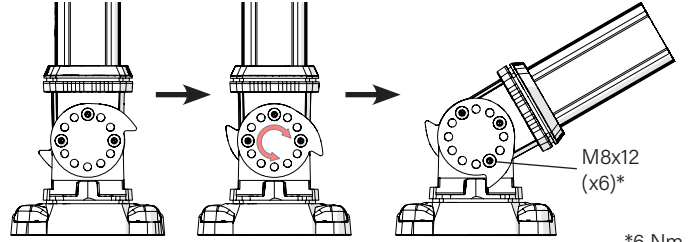

*6 Nm

Mounting View Montaj Görünümü

This part will be positioned as in the figure
Bu kısım şekildeki gibi konulacaktır

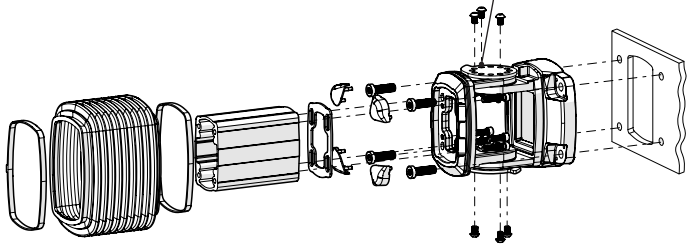

Box Contents Kutu İçeriği

4x M8x40

2x M8x20

4x J8.4 (M8)

2x

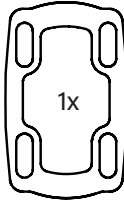

1x

1x

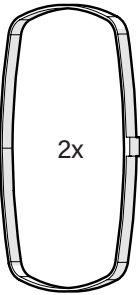
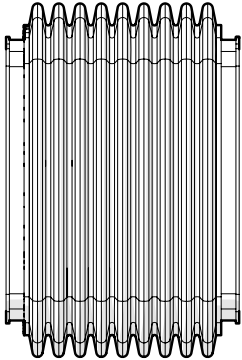

2x



Scan for the installation manual
Kurulum kılavuzu için tarayın

7

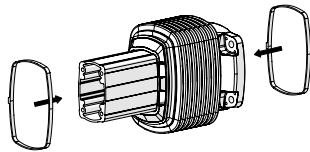

8

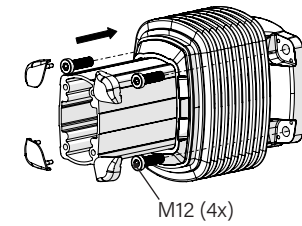

M12 (4x)

Mounting dimensions
Montaj ölçüleri

9

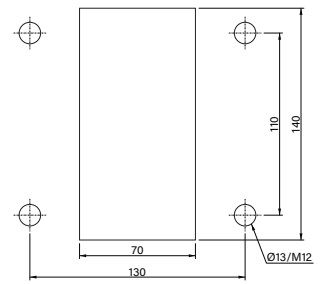

*M12 bolts in the image number 8 are not included in the box contents.
*8 numaralı görselde bulunan M12 civatalar kutu içeriğine dahil değildir.



ENCL.ACC.
E510113