

LAHP-SNS-PX-N AND LAHP-SNS-PX-P INSTALLATION



SENSOR INSTALLATION

Sensors can be attached to the actuators using the rail on the side of the actuator. See below for illustrations on how to attach each sensor to an actuator.



NOTE: The sensor kits each come with three sensors and hardware to attach to each actuator series.

INSTALLATION ON LAHP-25 SERIES

- 1) Slide the supplied hex nut into the channel on the side of the actuator. Secure the sensor to the nut using the supplied BHCS and washer.
- 2) Secure the **shorter** flag to the carriage using the two (2) supplied BHCS and two (2) washers.

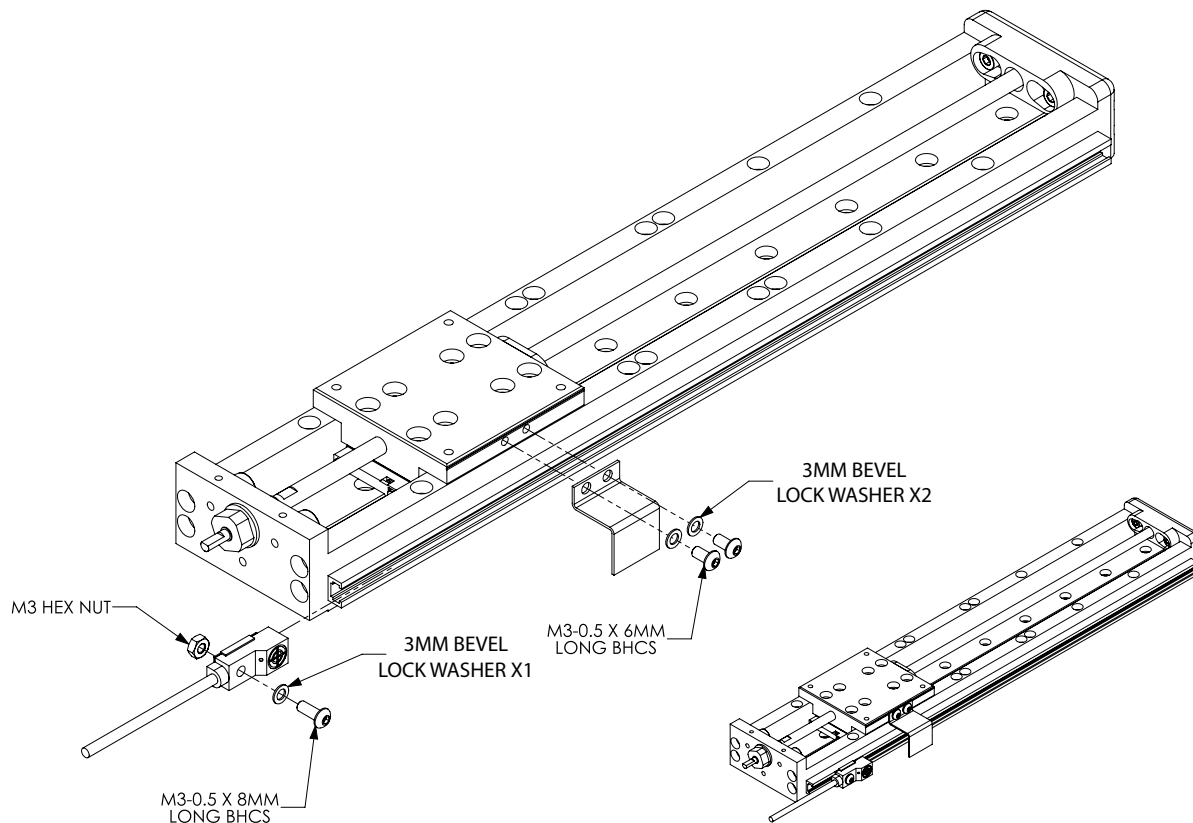

INSTALLATION ON LAHP-33/33W SERIES

- 1) Slide the supplied hex nut into the channel on the side of the actuator. Secure the sensor to the nut using the supplied BHCS and washer.
- 2) Secure the **longer** flag to the carriage using the two (2) supplied BHCS and two (2) washers.

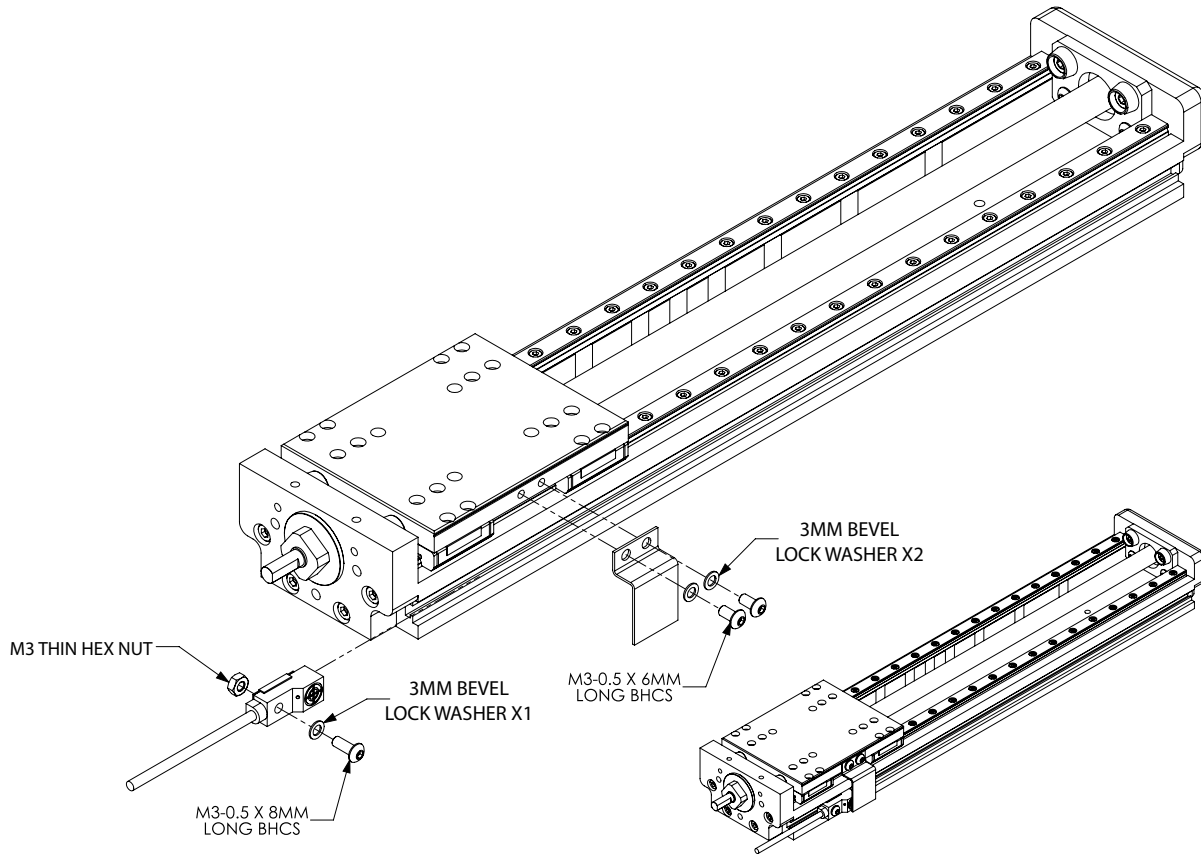

PROXIMITY SENSOR CONFIGURATION

Three PNP or NPN proximity sensors are included in the kit with the following controls intention:

- Use 2 Normally Closed (NC) sensors to detect 'End of Stroke'
- Use 1 Normally Open (NO) sensor to detect 'Home Position'.

PROXIMITY SENSOR WIRING

Operating voltage range	12-24 VDC
Black wire	Output Signal
Blue wire	0 V
Brown wire	+ V

For complete sensor specifications please refer to Omron's E2S series documentation.

- [LAHP-SNS-PX-N](#): Omron ES2W241M (NC) and ES2W23B1M (NO)
- [LAHP-SNS-PX-P](#): Omron ES2W261M (NC) and ES2W25B1M (NO)