

# LAHP-SNS-PH-N AND LAHP-SNS-PH-P INSTALLATION



## SENSOR INSTALLATION

Sensors can be attached to the actuators using the rail on the side of the actuator. The following pages illustrate how to attach each sensor to an actuator.



*NOTE: The sensor kits each come with three sensors and hardware to attach to each actuator series.*

### INSTALLATION ON LAHP-25 SERIES

- 1) Attach the cable to the photo sensor. Secure the photo sensor to the bracket using the two (2) supplied SHCS and two (2) washers.

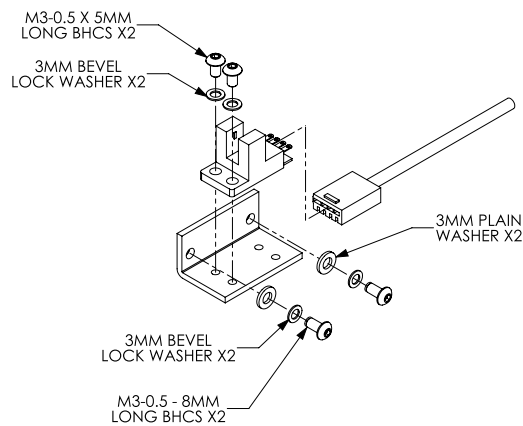

- 2) Slide the supplied hex nuts into the channel on the side of the actuator. Secure the bracket to the nuts using the two (2) supplied SHCS and two (2) washers.
- 3) Secure the **shorter** flag to the carriage using the two (2) supplied SHCS and two (2) washers.

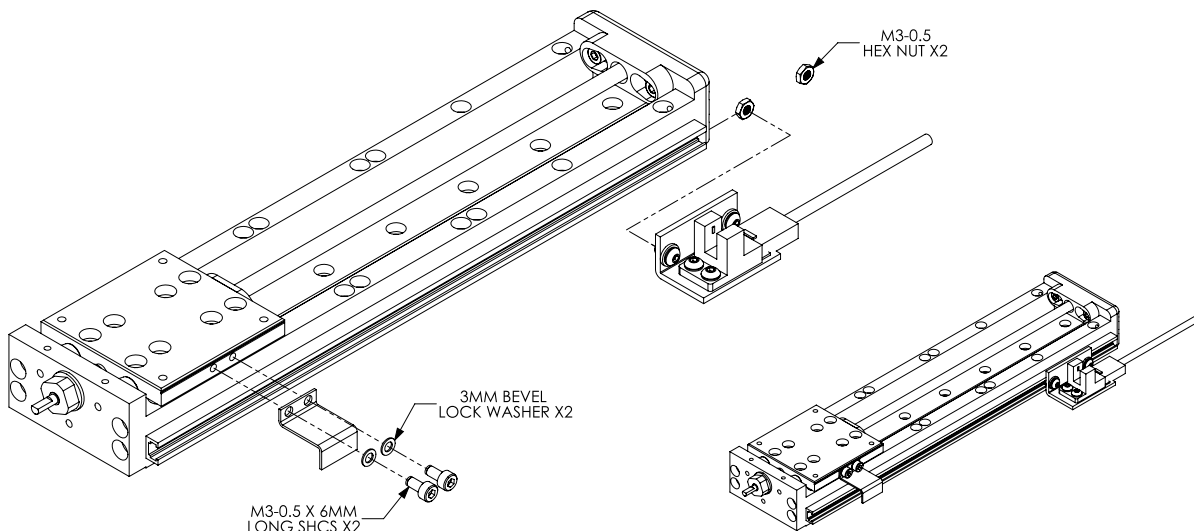

**INSTALLATION ON LAHP-33/33W SERIES**

- 1) Attach the cable to the photo sensor. Secure the photo sensor to the bracket using the two (2) supplied SHCS and two (2) washers.

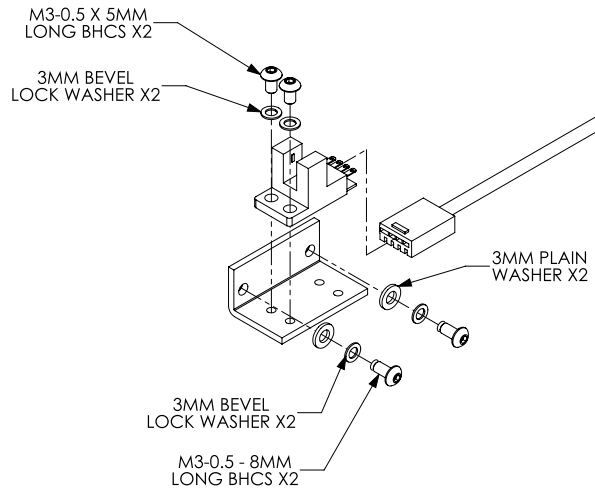

- 2) Slide the supplied hex nuts into the channel on the side of the actuator. Secure the bracket to the nuts using the two (2) supplied SHCS and two (2) washers.
- 3) Secure the **longer** flag to the carriage using the two (2) supplied SHCS and two (2) washers.

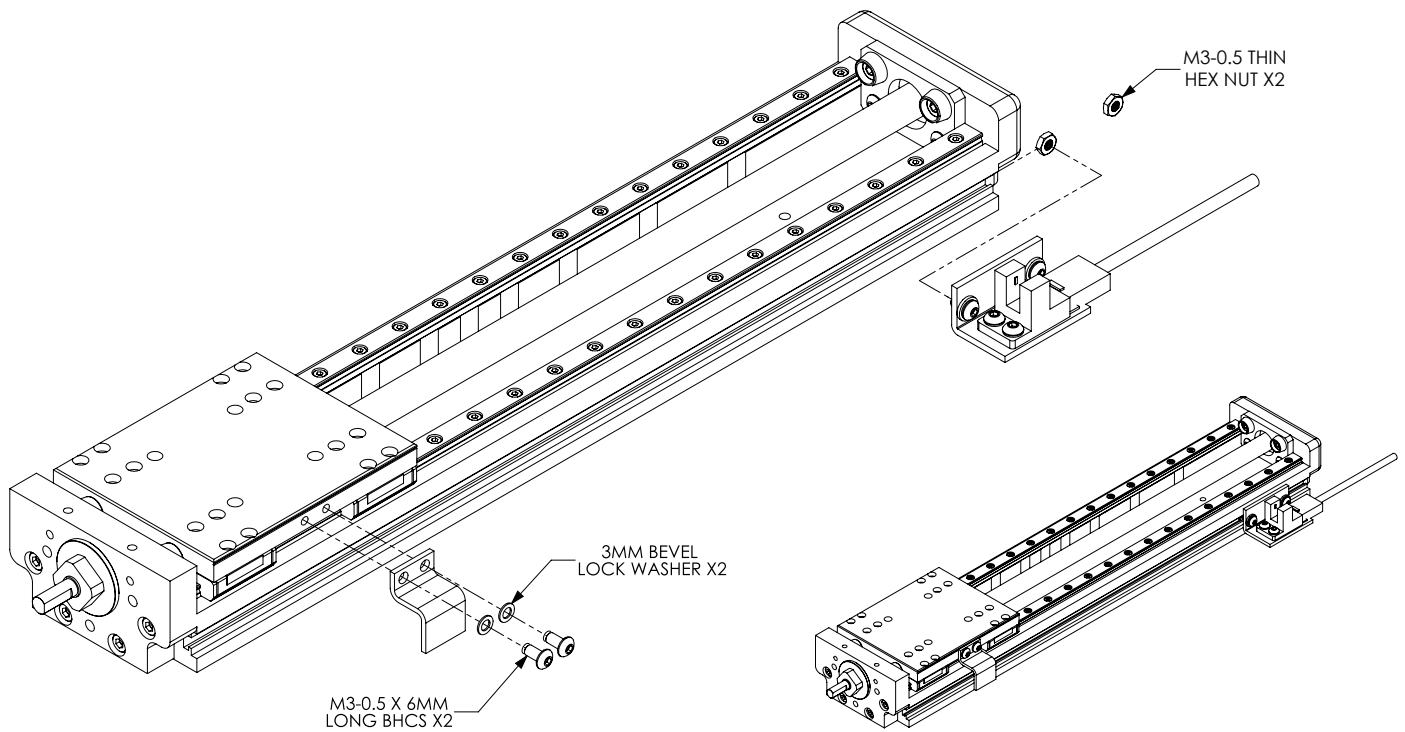

**PHOTOELECTRIC SENSOR WIRING**

<b>Operating voltage range</b>	5–24 VDC
<b>Black wire</b>	Output Signal
<b>Blue wire</b>	0 V
<b>Brown wire</b>	+ V
<b>Pink wire</b>	L
<i>For complete sensor specifications please refer to Omron's EE-SX674/P series documentation.</i>	