



# LAHP-N23-33WRPBKT ASSEMBLY

## MOUNT COMPATIBILITY

| Mount Compatibility |            |                                   |
|---------------------|------------|-----------------------------------|
| Motor Frame Size    | Motor Type | LAHP-33(W) Series                 |
| <b>N23</b>          | Stepper    | <a href="#">LAHP-N23-33WRPBKT</a> |

The parallel mount can be attached vertically or horizontally as shown below\*. These steps only apply to LAHP-33/33W series actuators. Your exact model may not be shown.

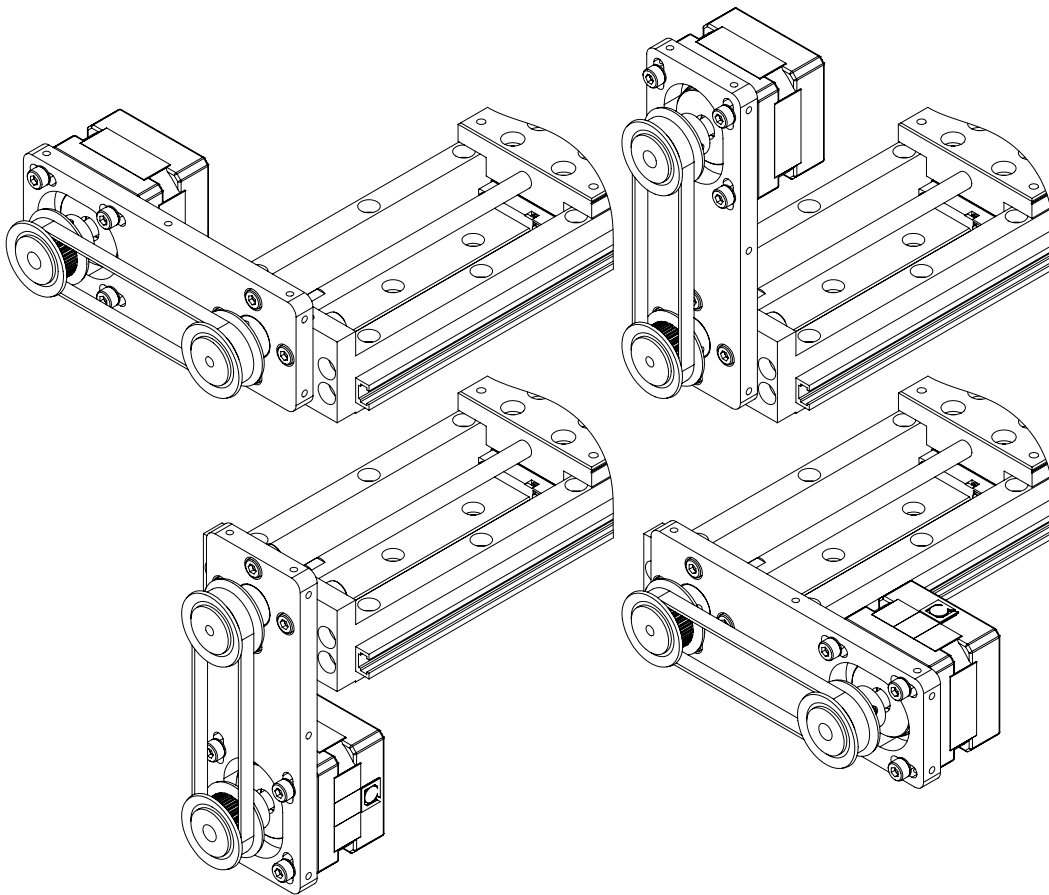

*\*NOTE: The parallel motor mount can only be configured in the two vertical positions on the LAHP-33W series actuators.*



*NOTE: Belt guards not available from ADC. Mounting holes are available for user designed belt guards.*

**ASSEMBLY INSTRUCTIONS**

- 1) Secure the mount to the actuator using the three (3) supplied bolts and washers.

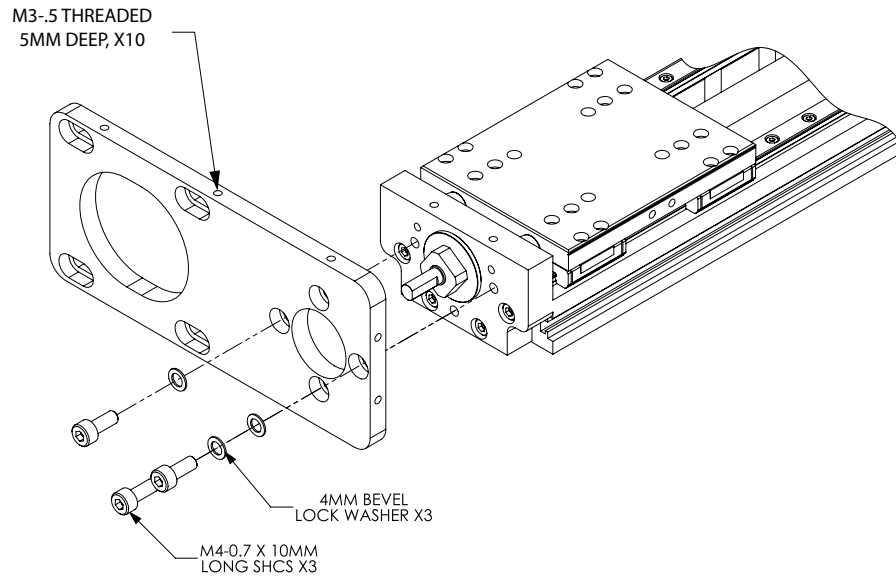

- 2) Secure the NEMA 23 stepper motor to the mount using the four (4) supplied bolts and washers.

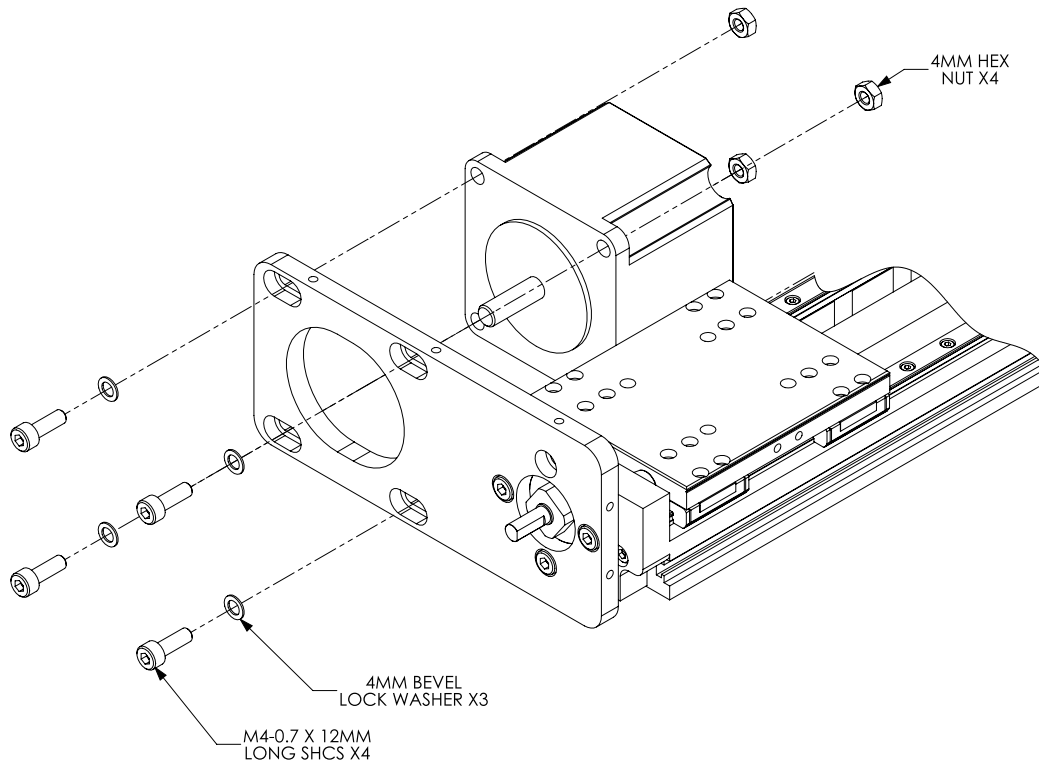

**NOTE:** When mounting motor, orient so that motor cables are directed for best cable management in final overall installation.

- 3) Slide the two (2) pulleys on the motor and actuator shafts.
- 4) Using a straight edge, ensure that the pulleys are flush. For each pulley, align 1 set screw with flat on input shaft and tighten. Then, tighten 2nd set screw.

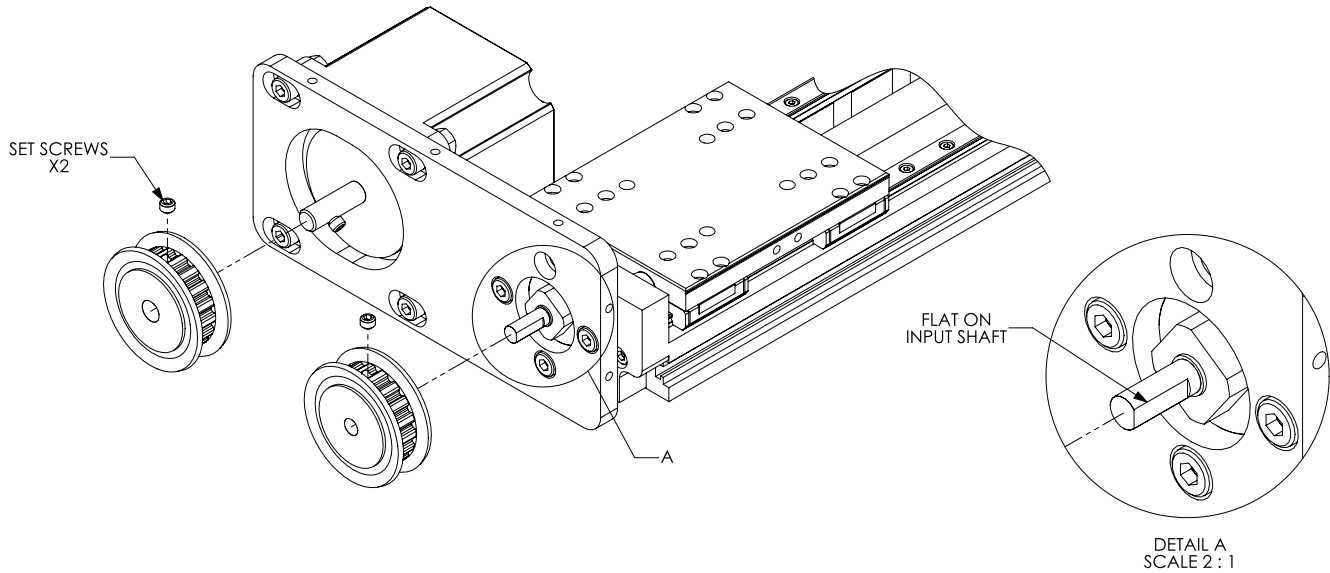

- 5) Attach the belt to the pulleys. If needed, loosen the bolts on the motor, adjust the motor position to change the tension on the belt, and re-tighten the bolts.

