

LAHP-N23-33MTRBKT ASSEMBLY



MOUNT COMPATIBILITY

Mount Compatibility			
Motor Frame Size	Motor Type	LAHP-33/33W Series	
		Motor Bracket PN	Coupling PN
NEMA 23	Stepper	LAHP-N23-33MTRBKT	LAHP-33CPL-N23

ASSEMBLY INSTRUCTIONS

The following illustrations show how to install the motor mount to the actuator. These steps only apply to LAHP-33 series actuators.

- 1) Slide the motor mount frame onto the shaft on the end of the actuator.
- 2) Secure the mount using the three (3) supplied SHCS and three (3) washers.

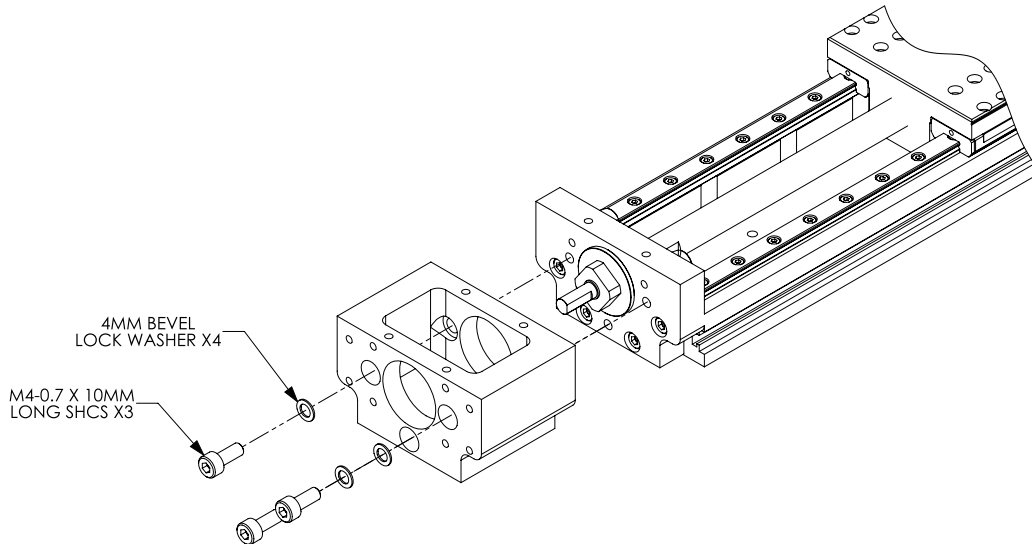

- 3) Secure the plate to the end of the mount using the four (4) supplied SHCS and four (4) washers.

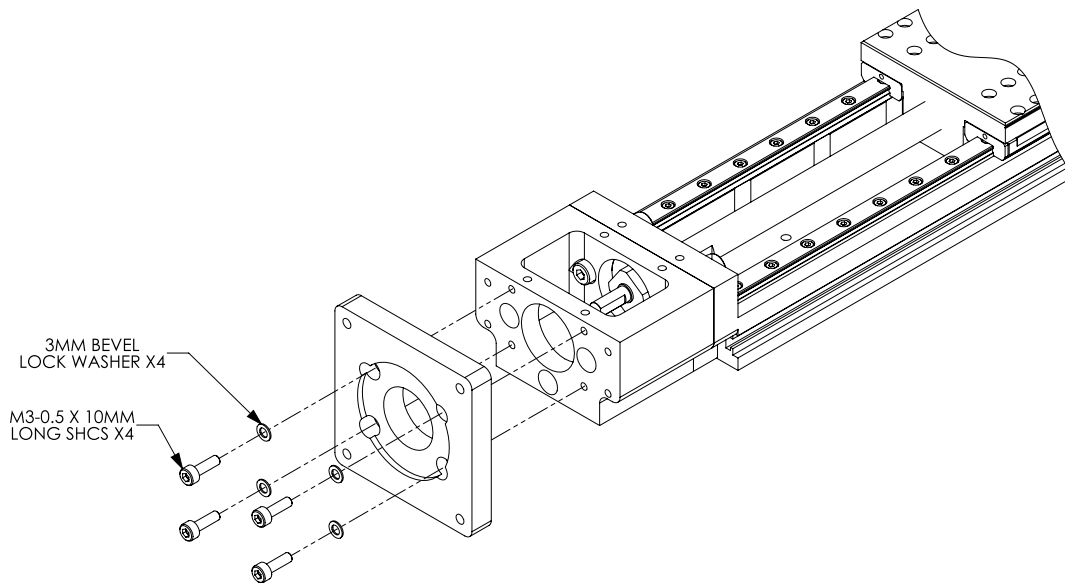

- 4) Slide the coupling (sold separately, see table) through the plate, into the mount frame and onto the shaft of the actuator.
- 5) Slide the motor shaft through the plate and into the coupling and secure to the plate using the four (4) supplied SHCS and four (4) washers. Tighten the 2 screws on the coupling to a torque of 0.5 Nm (4.4 in-lbs) to secure to the actuator and motor shafts.

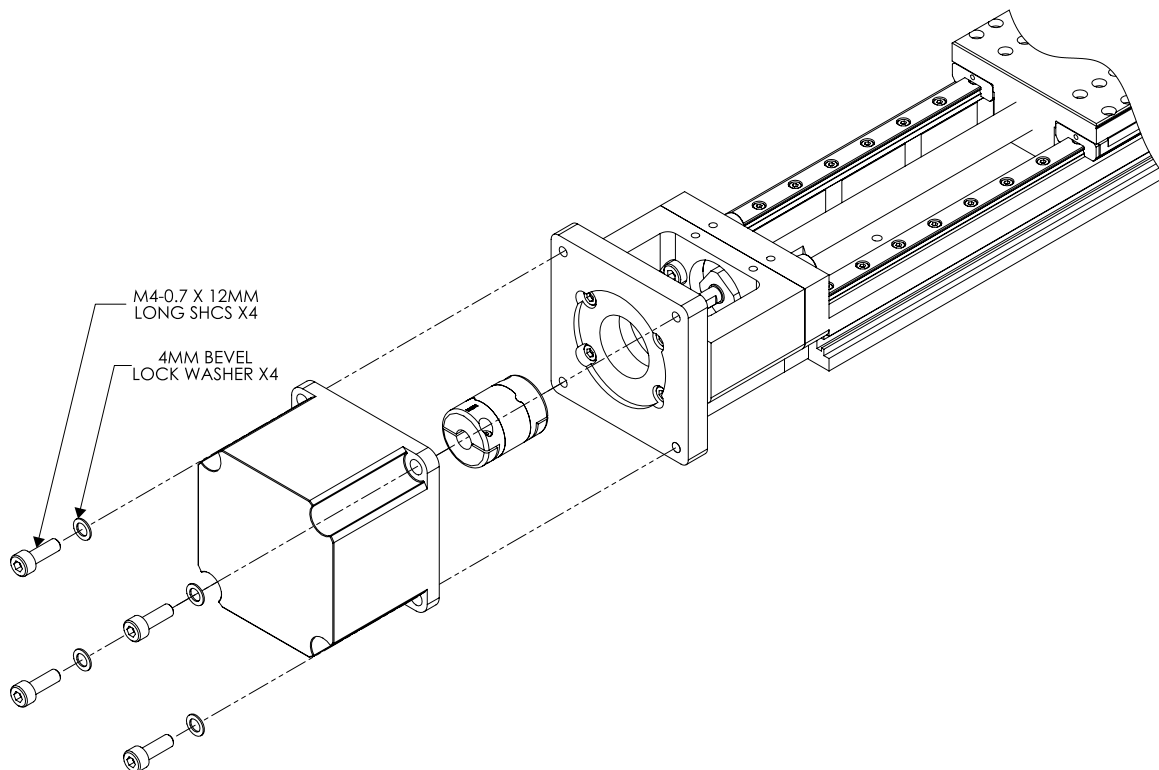

NOTE: Ensure Actuator Shaft and Motor Shaft are clean of grease and debris prior to installing coupling.



NOTE: When mounting motor, orient so that motor cables are directed for best cable management in final overall installation.



NOTE: Perform these steps with the actuator shaft in the vertical position to minimize axial misalignment of the motor.

- 6) Place the cover over the mount and secure using the four (4) supplied SHCS and four (4) washers.

